



[Manuals.plus](#) /

› [PrimeCables](#) /

› PrimeCables Dual-Motor Standing Desk Frame User Manual

PrimeCables Cab-PC-08399-WH

PrimeCables Dual-Motor Standing Desk Frame User Manual

Model: Cab-PC-08399-WH

INTRODUCTION

Thank you for choosing the PrimeCables Dual-Motor Standing Desk Frame. This ergonomic electric desk frame is designed to provide a versatile and comfortable workspace, allowing seamless transitions between sitting and standing positions. This manual provides detailed instructions for assembly, operation, maintenance, and troubleshooting to ensure optimal performance and longevity of your desk frame.



Image: The PrimeCables Dual-Motor Standing Desk Frame in white, showing the two legs, crossbar, and control panel.

SAFETY INFORMATION

Please read all safety instructions carefully before assembly and operation. Failure to follow these instructions may result in injury or damage to the product.

- Ensure the desk is not loaded with more than 100kg (220lbs) to maintain stability and safety. Overloading can cause damage to the motors and frame.
- Keep children and pets away from the desk during operation.
- Ensure there are no obstructions in the desk's path during height adjustment.
- Do not disassemble or modify the desk frame. Contact customer support for any issues.
- This product complies with safety standards: UL, CE, FCC, GS, UL, CUL, RCM, KC, UKCA, and PSE certified.

PACKAGE CONTENTS

Verify that all components are present before beginning assembly. If any parts are missing or damaged, please contact PrimeCables customer support.

- Left Leg Assembly
- Right Leg Assembly
- Crossbar (Telescopic Beam)
- Left Foot
- Right Foot

- Control Panel with Cable
- Power Adapter
- Cable Management Clips
- Assembly Hardware (Screws, Allen Keys, etc.)
- Instruction Manual (this document)

Note: Tabletop is not included with this desk frame.

SETUP AND ASSEMBLY

Follow these steps to assemble your PrimeCables Dual-Motor Standing Desk Frame. It is recommended to have two people for assembly.

1. **Attach the Feet to the Legs:** Securely fasten the left and right feet to their respective leg assemblies using the provided screws.
2. **Connect the Crossbar:** Extend the telescopic crossbar to your desired width. Attach the crossbar to both leg assemblies. Ensure all screws are tightened.
3. **Mount the Control Panel:** Attach the control panel to the underside of the desk frame, typically on the right side, using the provided screws.
4. **Connect Cables:** Connect the motor cables from each leg to the control box. Connect the control panel cable to the control box. Finally, connect the power adapter to the control box and plug it into a power outlet.
5. **Attach Tabletop (Not Included):** Carefully place your chosen tabletop onto the assembled frame. Align it properly and secure it to the frame using appropriate screws (ensure screws are not too long to penetrate the tabletop). Recommended tabletop sizes: length of 42.7" to 70.9" (108.5cm to 180cm), width of 23.6" to 31.5" (60cm to 80cm).
6. **Cable Management:** Use the provided cable management clips to organize and secure all cables, preventing them from dangling or getting caught.

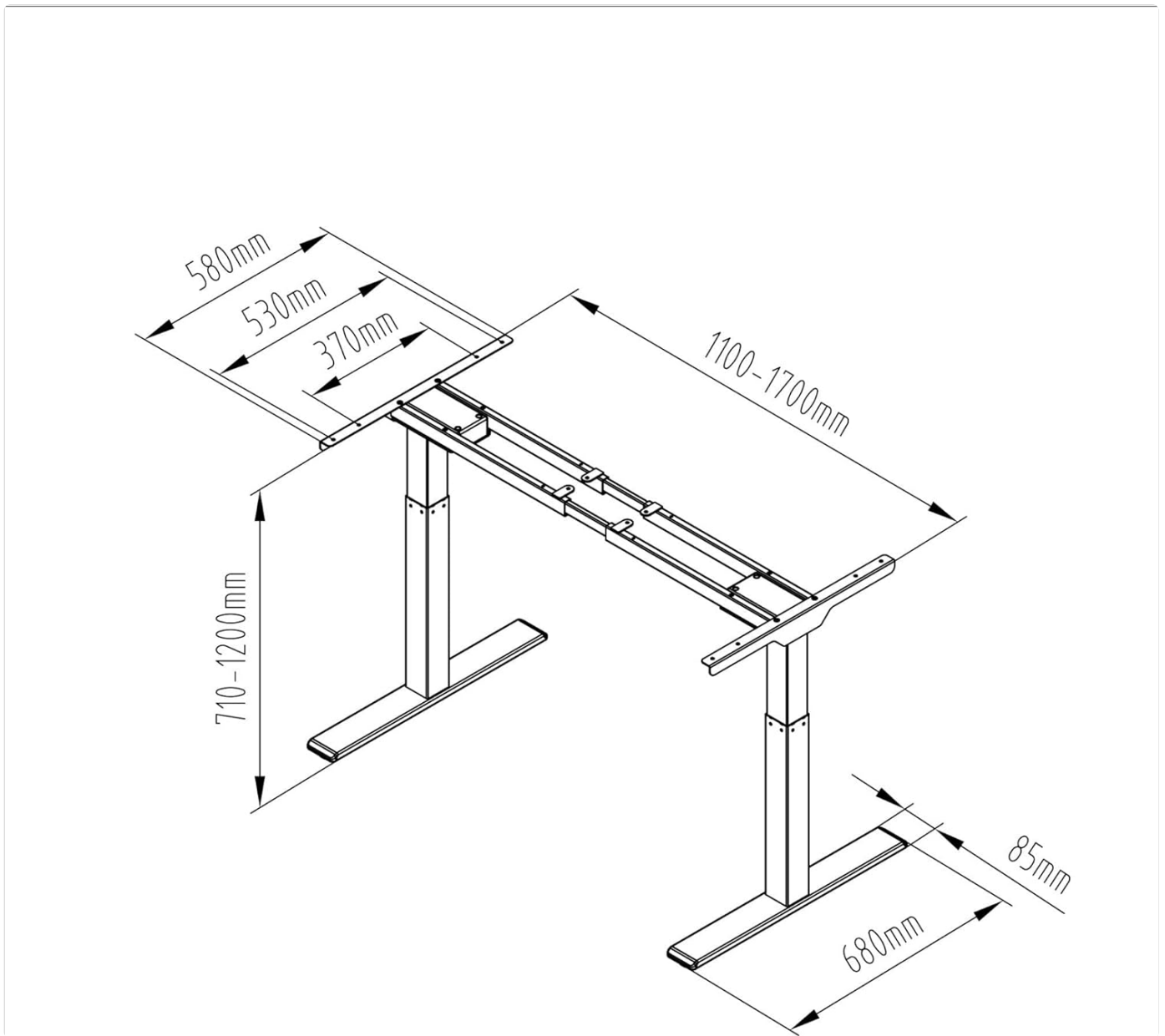

Image: Technical drawing illustrating the dimensions of the desk frame, including adjustable width (1100-1700mm) and height (710-1200mm).

RECOMMENDED TABLETOP DIMENSIONS

47.2"-70.9"/1200-1800mm(Width)
23.6"-31.5"/600-800mm(Depth)



Image: Visual guide showing recommended tabletop dimensions: 47.2"-70.9" (1200-1800mm) width and 23.6"-31.5" (600-800mm) depth.

OPERATING INSTRUCTIONS

Your PrimeCables standing desk frame features an intuitive control panel for easy height adjustment and memory functions.

ADVANCED CONTROL PANEL

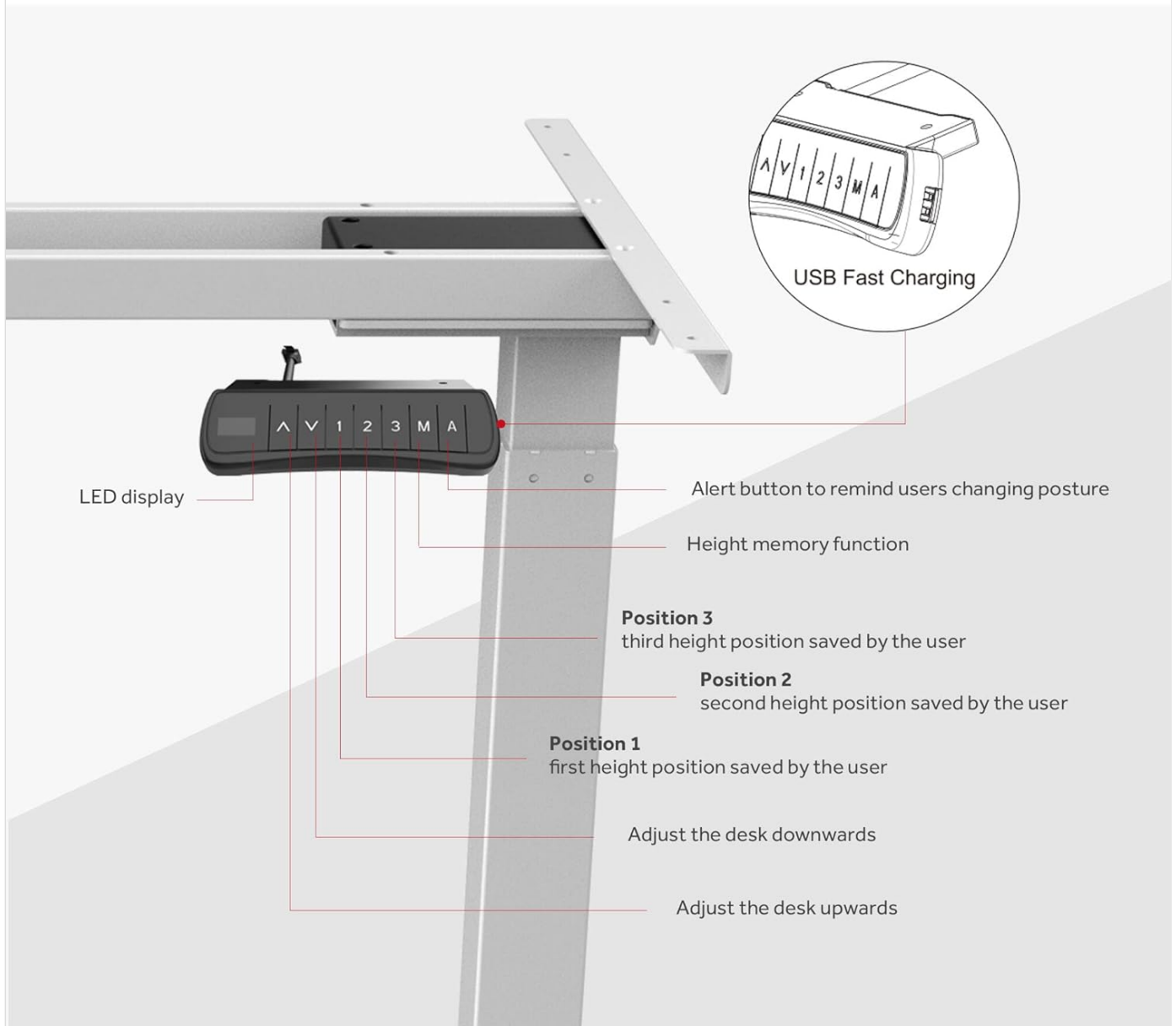

Image: Detailed view of the advanced control panel, highlighting the LED display, up/down arrows, memory presets (1, 2, 3), 'M' button, and 'A' (alert) button, along with USB fast charging port.

Control Panel Functions:

- **Up (^) / Down (v) Buttons:** Press and hold to continuously adjust the desk height upwards or downwards. Release to stop at the desired height.
- **Memory Presets (1, 2, 3):** These buttons allow you to save and recall up to three preferred height settings.
 - **To Save a Preset:** Adjust the desk to your desired height. Press the 'M' button, then immediately press the desired preset button (1, 2, or 3). The LED display will show "S-" followed by the number, confirming the height is saved.
 - **To Recall a Preset:** Simply press the corresponding preset button (1, 2, or 3). The desk will automatically move to the saved height.
- **'A' Button (Alert/Memory Set):** This button can function as an alert to remind you to change posture or as part of the memory setting process. Refer to the specific control panel instructions for detailed alert setup.
- **USB Fast Charging Port:** Located on the side of the control panel, this port allows you to charge your mobile devices.

Key Features:

- **Dual Motor System:** Ensures smooth, stable, and quiet height transitions.
- **Ultra-Silent Operation:** The desk operates at less than 50dB, ensuring a quiet working environment.
- **Load Capacity:** Supports up to 100kg (220lbs).

ULTRA-SILENT OPERATION LOWER THAN 50DB



Image: A PrimeCables standing desk with a computer setup and a pug resting underneath, emphasizing its ultra-silent operation (less than 50dB).

MAINTENANCE

Regular maintenance helps ensure the longevity and smooth operation of your desk frame.

- **Cleaning:** Wipe the desk frame with a soft, damp cloth. Avoid harsh chemicals or abrasive cleaners.
- **Check Connections:** Periodically check all screws and cable connections to ensure they are secure.
- **Lubrication:** The internal mechanisms are pre-lubricated and generally do not require additional lubrication.
- **Avoid Overloading:** Do not exceed the maximum load capacity of 100kg (220lbs).

TROUBLESHOOTING

If you encounter issues with your desk frame, refer to the following common problems and solutions:

Problem	Possible Cause	Solution
Desk does not move.	Power cable disconnected, motor cables loose, overload protection activated.	Check all power and motor connections. Unplug and replug the power cable. Reduce load if overloaded.
Desk moves unevenly or makes unusual noise.	Uneven load, loose connections, obstruction.	Distribute weight evenly on the tabletop. Check all assembly screws for tightness. Ensure no obstructions.
Control panel display shows an error code.	Specific error (e.g., overheating, sensor issue).	Refer to the specific error code in the full manual (if available) or contact customer support. Often, unplugging for 10 minutes and replugging can reset the system.
Memory presets not working.	Presets not saved correctly.	Re-save the memory presets following the "To Save a Preset" instructions in the Operating section.

If the problem persists after attempting these solutions, please contact PrimeCables customer support for further assistance.

SPECIFICATIONS

Feature	Detail
Brand	PrimeCables
Model Number	Cab-PC-08399-WH
Colour	White
Product Dimensions (Min)	58D x 110W x 71H cm (approx.)
Product Dimensions (Max)	58D x 170W x 120H cm (approx.)
Height Adjustment Range	710-1200mm (28-47.2 inches)
Width Adjustment Range	1100-1700mm (43.3-67 inches)
Material	Metal (Powder Coated Finish)
Max. Load Capacity	100kg (220lbs)
Motor System	Dual Motor
Noise Level	< 50dB
Certifications	UL, CE, FCC, GS, CUL, RCM, KC, UKCA, PSE
Recommended Tabletop Width	108.5cm - 180cm (42.7" - 70.9")
Recommended Tabletop Depth	60cm - 80cm (23.6" - 31.5")

WARRANTY AND SUPPORT

PrimeCables stands behind the quality of its products. This desk frame comes with a standard manufacturer's warranty. For specific warranty details, including coverage period and terms, please refer to the warranty card included with your product or visit the official PrimeCables website.

For technical support, troubleshooting assistance, or to inquire about replacement parts, please contact PrimeCables customer service:

- **Website:** www.primecables.ca (or relevant regional website)
- **Email:** Refer to website for contact email.
- **Phone:** Refer to website for contact phone number.

Please have your model number (Cab-PC-08399-WH) and purchase date ready when contacting support.