

Manuals+

[Q & A](#) | [Deep Search](#) | [Upload](#)

Manuals.plus /

- › [Pawfly](#) /
- › Pawfly Internal Aquarium Filter AP-300L User Manual (3-10 Gallon)

Pawfly AP-300L

Pawfly Internal Aquarium Filter AP-300L User Manual

Model: AP-300L | For 3-10 Gallon Aquariums

1. INTRODUCTION

This manual provides detailed instructions for the installation, operation, and maintenance of your Pawfly Internal Aquarium Filter, model AP-300L. This submersible power filter is designed to provide mechanical and biological filtration, water circulation, and oxygenation for aquariums ranging from 3 to 10 gallons.



Image 1: Pawfly Internal Aquarium Filter AP-300L, showing its compact design and water output options.

2. PRODUCT COMPONENTS

The Pawfly Internal Aquarium Filter AP-300L includes the following parts:

- Filter Unit (Pump Body, Filter Box, Bio Sponge, Filter Box Cover)
- Water Spraying Pipe
- Water Drenching Pipe
- Air Intake Valve with Tubing
- Suction Cups
- Cleaning Brush

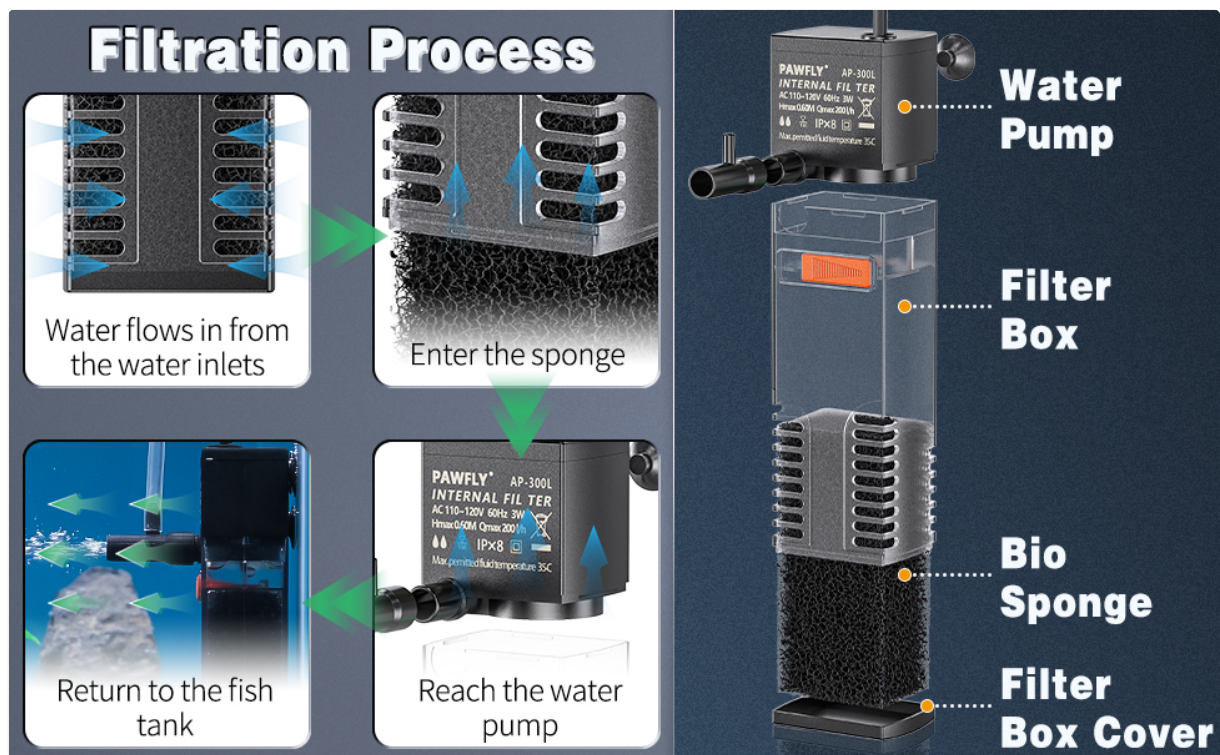

Image 2: Diagram illustrating the main components of the Pawfly Internal Aquarium Filter, including the water pump, filter box, bio sponge, and filter box cover.

3. SETUP INSTRUCTIONS

- 1. Assemble the Filter:** Ensure all components are securely attached. The bio sponge should be placed inside the filter box.
- 2. Choose Water Outlet:**
 - For **Water Spraying Pipe**: Attach the spraying pipe to the pump outlet. Ensure the entire filter unit is completely submerged in water during operation.
 - For **Water Drenching Pipe**: Attach the drenching pipe to the pump outlet. This pipe can be raised above the water surface to enhance oxygenation. It can be rotated 360 degrees for directional flow.



Image 3: Illustration of the water spraying pipe (submerged) and water drenching pipe (above water for oxygenation).

3. Install Air Intake Valve (Optional for Oxygenation):

- Connect one end of the clear airline tubing to the air inlet on the filter.
- Link the other end of the tubing to the air intake valve.
- Position the air intake valve outside the aquarium.
- **Note:** The air intake valve only functions with the water spraying pipe. It does not work with the drenching pipe.

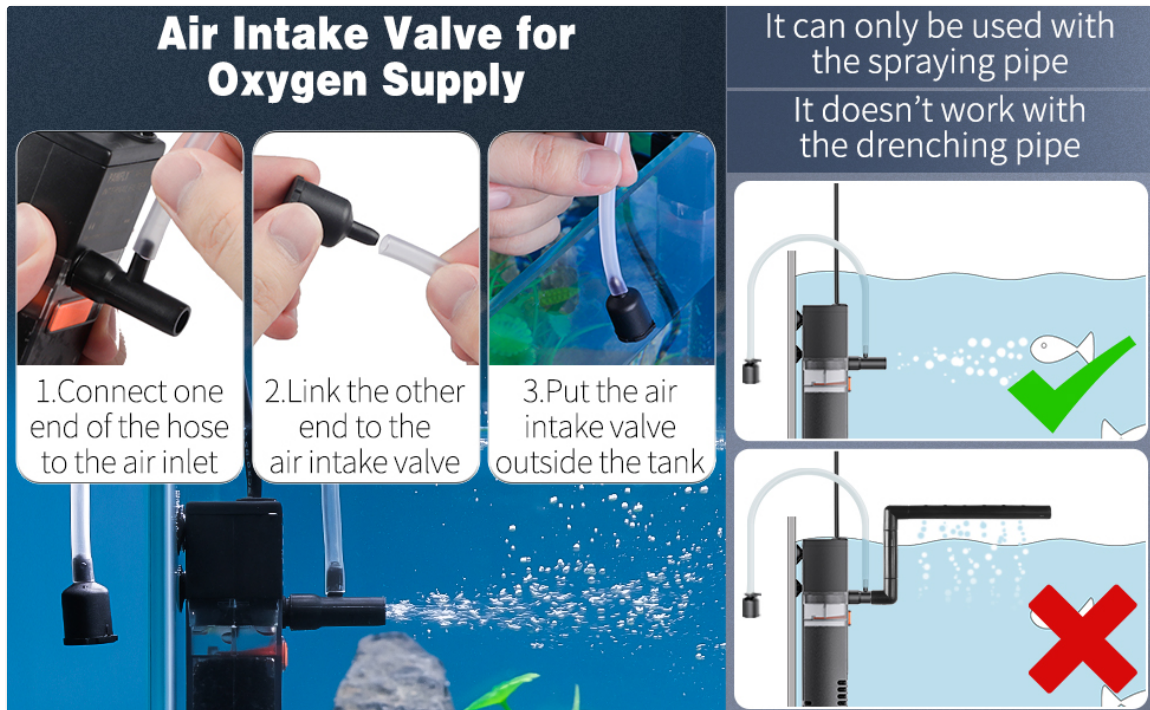

Image 4: Step-by-step guide for connecting the air intake valve for oxygen supply.

4. **Mount the Filter:** Use the strong suction cups to securely attach the filter to the inside wall of your aquarium. Ensure it is fully submerged if using the spraying pipe.

4. OPERATING INSTRUCTIONS

1. **Power On:** Once the filter is correctly installed and submerged (if applicable), plug the power cord into a suitable electrical outlet.
2. **Adjust Water Flow:** Locate the knob on the filter unit. Slide this knob to adjust the water flow rate according to your aquarium's needs and the preferences of your aquatic inhabitants.
3. **Oxygenation:** If you have installed the air intake valve with the spraying pipe, air bubbles will be produced, increasing oxygen solubility in the water.



Image 5: The Pawfly filter operating in an aquarium, demonstrating filtration, oxygenation, and circulation.

5. MAINTENANCE

Regular maintenance ensures optimal performance and longevity of your filter.

1. Sponge Cleaning:

- Unplug the filter from the power outlet.
- Carefully detach the filter from the aquarium wall.
- Separate the pump from the filter box.
- Remove the bottom cover of the filter box to access and remove the bio sponge.
- Rinse the sponge every 2-4 weeks. **Important:** Only wash the sponge with aquarium water to preserve beneficial bacteria. Avoid using tap water, as chlorine can kill these bacteria.



Image 6: Visual guide for detaching the filter and cleaning the bio sponge.

2. Pump Cleaning:

- After separating the pump from the filter box, remove the impeller cover.
- Carefully remove the impeller and clean it thoroughly with a small brush (a cleaning brush is included).

- Clean the impeller housing to remove any debris or buildup.
- Reassemble the pump and filter components.

3. **Filter Box Cleaning:** Use the provided small brush to clean the interior of the filter box.

6. TROUBLESHOOTING

Problem	Possible Cause	Solution
Filter not running / No water flow	Not plugged in Power outage Impeller jammed or dirty Air in pump (struggles to start)	Check power connection. Verify power supply. Clean impeller and housing (refer to Maintenance). Ensure filter is fully submerged and gently shake to release trapped air.
Weak water flow	Clogged sponge or filter media Dirty impeller Water flow adjustment knob set too low	Clean or replace sponge (refer to Maintenance). Clean impeller (refer to Maintenance). Adjust the flow knob to a higher setting.
Excessive noise	Impeller dirty or damaged Air trapped in pump Filter not securely attached	Clean or inspect impeller for damage. Gently shake filter to release air. Re-secure suction cups to the aquarium wall.
Poor water clarity	Sponge needs cleaning Overfeeding fish Insufficient filtration for tank size (unlikely for 3-10 gal)	Clean sponge regularly (refer to Maintenance). Reduce feeding amounts. Ensure proper tank maintenance (water changes).

7. SPECIFICATIONS

Feature	Detail
Model	AP-300L
Recommended Tank Size	3-10 Gallons
Max Flow Rate	55 GPH (200 L/h)
Power Consumption	3 W
Max Lift Height	2 ft (0.6 m)
Voltage	AC 110-120V
Frequency	60 Hz
Noise Level	< 30 dB
Dimensions (W x H)	1.4" x 4.9" (approximate)
Ingress Protection (IP) Rating	IPX8 (Submersible)

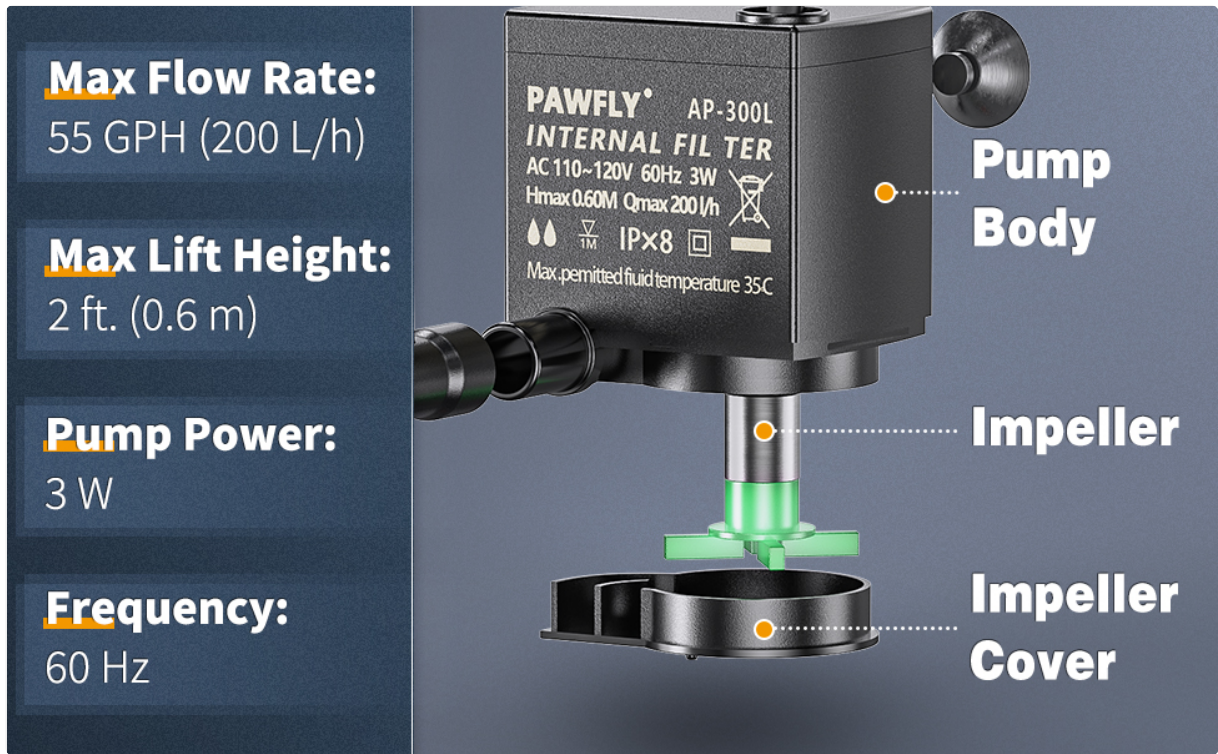

Image 7: Detailed specifications and pump diagram for the Pawfly Internal Aquarium Filter.

8. WARRANTY AND SUPPORT

For warranty information or technical support, please refer to the product packaging or contact Pawfly customer service directly. Keep your purchase receipt for warranty claims.

You can often find contact information on the official Pawfly website or through the retailer where the product was purchased.