



Manuals.plus /

› Amiroko /

› Universal TV Remote Control User Manual

Amiroko RC-G008

Universal TV Remote Control User Manual

Model: RC-G008

1. INTRODUCTION

This manual provides comprehensive instructions for the setup, operation, and maintenance of your Amiroko Universal TV Remote Control, Model RC-G008. This remote is designed to be compatible with a wide range of smart TVs from various brands, offering a convenient replacement for your original remote.

Compatible brands include LG, Samsung, Sony, Philips, Panasonic, Sharp, Toshiba, Hitachi, Vizio, TCL, JVC, Hisense, Sanyo, Insignia, RCA, Haier, Vestel, Seiki, Magnavox, and Westinghouse Smart TVs. Please note that this remote is not designed to work with other brands.



Figure 1.1: Amiroko Universal TV Remote Control (Front View)



Figure 1.2: Amiroko Universal TV Remote Control (Front and Side View)

2. SAFETY INFORMATION

- Do not mix old and new batteries, or different types of batteries.
- Remove batteries if the remote control will not be used for an extended period to prevent leakage.
- Keep the remote control away from water, direct sunlight, and high temperatures.
- Do not attempt to disassemble or modify the remote control.

3. PACKAGE CONTENTS

Please check the package contents upon opening:

- 1 x Amiroko Universal TV Remote Control (Model RC-G008)
- 1 x Instruction Manual

Note: 2 x AAA batteries are required for operation and are not included in the package.

4. SETUP

The Amiroko Universal TV Remote Control offers two easy methods for setup:

4.1. Easy Brand Setting Method

This method allows for quick setup by aligning the remote with your TV and pressing the corresponding brand button.

1. Ensure your TV is powered on.
2. Point the remote control directly at your TV.
3. Press and hold the button on the remote that corresponds to your TV's brand (e.g., LG, Samsung, Sony, Philips, Panasonic, Sharp, Toshiba, Hitachi, Vizio, TCL, JVC, Hisense, Sanyo, Insignia, RCA, Haier, Vestel, Seiki, Magnavox, Westinghouse).
4. Continue holding the button for approximately 5 seconds. The indicator light on the remote will flash three times, indicating that the setting is complete.
5. Release the button and test the remote's functions. If it does not work, repeat the process or try the Easy Code Setting Method.

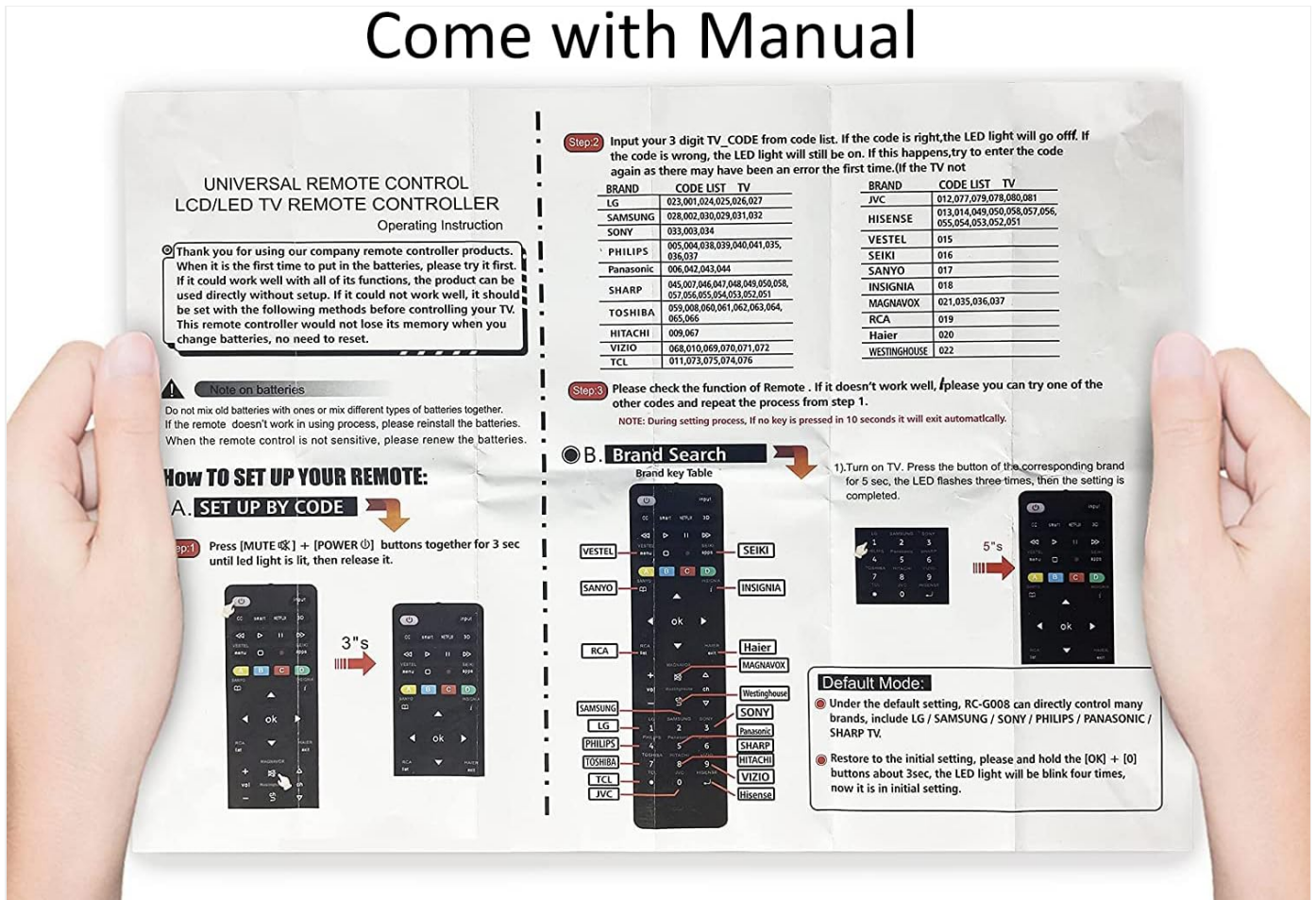

Figure 4.1: Easy Brand Setting Method Diagram

4.2. Easy Code Setting Method

If the brand setting method does not work, you can manually input a 3-digit code for your TV brand.

1. Ensure your TV is powered on.
2. Press and hold the **MUTE** button and the **POWER** button simultaneously for 3 seconds until the LED indicator light on the remote turns on.
3. Release both buttons. The LED light will remain on.
4. Refer to the TV Code List (usually provided with the remote or found online) and locate the 3-digit code for your TV brand.
5. Input the 3-digit TV code using the number buttons on the remote.
6. If the code is correct, the LED light will turn off. If the code is incorrect, the LED light will remain on, indicating an error. Re-enter the code or try another code from the list.
7. Test the remote's functions.

Note: If no key is pressed for 10 seconds during code input, the setting mode will automatically exit.

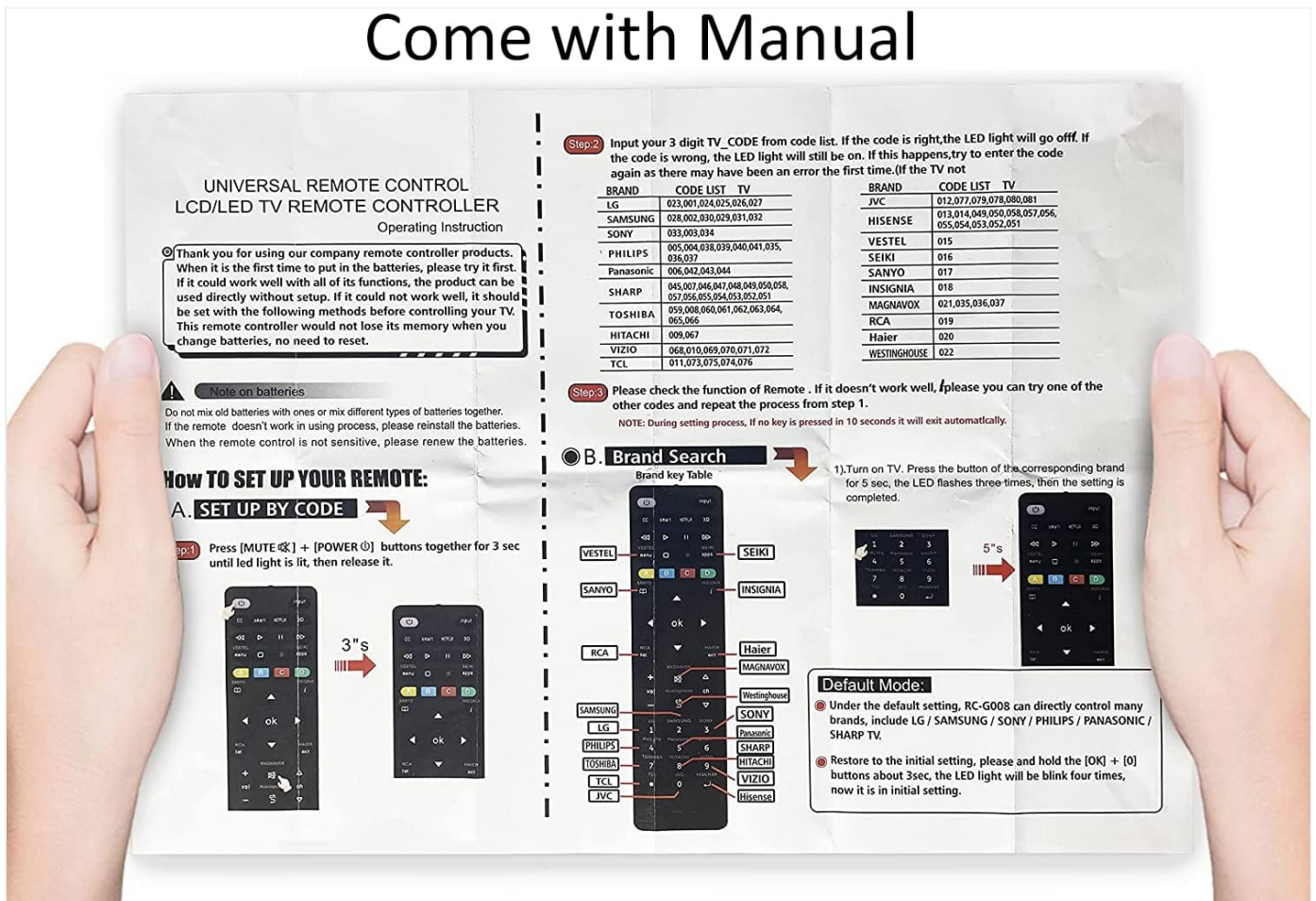

Figure 4.2: Easy Code Setting Method and Code List Example

5. OPERATING INSTRUCTIONS

Once successfully set up, your Amiroko Universal TV Remote Control functions similarly to your original TV remote. Below are common button functions:

- **Power Button ():** Turns the TV on or off.
- **Input Button:** Cycles through video input sources (HDMI, AV, etc.).
- **CC (Closed Caption):** Toggles closed captions on/off.
- **Smart/Netflix/3D Buttons:** Direct access to smart TV features, Netflix, or 3D mode (if supported by your TV).
- **Navigation Pad (Up, Down, Left, Right, OK):** Used to navigate menus and confirm selections.
- **Vol +/-:** Adjusts the volume up or down.

- **Ch +/-:** Changes the channel up or down.
- **Mute Button ():** Mutes or unmutes the TV sound.
- **Number Buttons (0-9):** Direct channel input.
- **Playback Controls (Play, Pause, Fast Forward, Rewind, Stop):** Controls media playback.
- **Color Buttons (Red, Green, Yellow, Blue):** Functions vary by TV and application, often used for interactive features.
- **Exit Button:** Exits current menu or application.



**A remote control
can let you relax and enjoy
a good life**

Figure 5.1: Remote Control in Use with a Smart TV

6. MAINTENANCE

6.1. Battery Replacement

The remote control requires two AAA batteries. When the remote's performance degrades or the indicator light does not respond, it's time to replace the batteries.

1. Locate the battery compartment on the back of the remote control.
2. Slide the battery cover open.
3. Remove the old AAA batteries.
4. Insert two new AAA batteries, ensuring the correct polarity (+ and -) as indicated inside the compartment.
5. Slide the battery cover back into place until it clicks securely.

Note: Replacing batteries will not erase the remote's settings.



Figure 6.1: Remote Control Back View (Battery Compartment)

6.2. Cleaning

To clean the remote control, use a soft, dry cloth. Do not use abrasive cleaners or solvents, as they may damage the surface.

7. TROUBLESHOOTING

| Problem | Possible Cause | Solution |
|--|---|---|
| Remote does not work after setup. | Incorrect setup method or code; batteries are dead or inserted incorrectly; remote is not compatible with TV. | <ul style="list-style-type: none">◦ Ensure batteries are fresh and correctly inserted.◦ Try the other setup method (Brand Setting or Code Setting).◦ Verify your TV brand is listed as compatible.◦ If using Code Setting, try alternative codes for your brand. |
| Some buttons do not work. | Partial code match; TV does not support the function. | <ul style="list-style-type: none">◦ Re-perform the setup process to ensure a complete code match.◦ Some advanced functions may not be supported by all TV models or universal remotes. |
| LED indicator light stays on after code input. | Incorrect 3-digit code entered. | Re-enter the correct 3-digit code. Refer to the code list. |

8. SPECIFICATIONS

- **Model:** RC-G008
- **Brand:** Amiroko
- **Compatible Devices:** Universal TV Remote Control for Smart TVs (LG, Samsung, Sony, Philips, Panasonic, Sharp, Toshiba, Hitachi, Vizio, TCL, JVC, Hisense, Sanyo, Insignia, RCA, Haier, Vestel, Seiki, Magnavox, Westinghouse)
- **Power Source:** 2 x AAA Batteries (not included)
- **Dimensions:** Approximately 6.93 x 1.78 x 0.71 inches (17.6 x 4.5 x 1.8 cm)
- **Weight:** Approximately 1.76 ounces (50 grams) without batteries
- **Color:** Black

9. WARRANTY AND SUPPORT

This Amiroko Universal TV Remote Control comes with a 3-year quality warranty.



Figure 9.1: 3-Year Quality Warranty

If you encounter any quality problems or require assistance with setting up your remote control, please do not hesitate to contact Amiroko customer support. Refer to the contact information provided with your purchase or on the official Amiroko website for the most up-to-date support channels.

For further assistance, please visit: [Amiroko Brand Store on Amazon](#)

