

iPort 72350

IPOINT 72350 Connect PRO WallStation Instruction Manual

Model: 72350

INTRODUCTION

The IPOINT Connect PRO WallStation provides a contactless charging and magnetic mounting solution for your iPad. Designed for seamless integration into various environments, it ensures your iPad is always powered and accessible. This manual provides instructions for installation, operation, and maintenance of your WallStation.

FEATURES

- **Contactless Charging:** Delivers wireless USB-C power to your iPad when docked, eliminating the need for cables.
- **Magnetic Docking:** Features a one-touch magnetic attachment for secure and easy iPad placement and removal.
- **360° Rotation:** Allows for flexible orientation of your iPad (portrait or landscape) to achieve the optimal viewing angle.
- **Sleek Design:** Ultra-slim profile designed to blend discreetly into any modern interior.
- **Connect PRO Case Compatibility:** Specifically designed to work with the IPOINT Connect PRO Case for a secure fit and continuous power.

PACKAGE CONTENTS

Verify that all items are present in the package:

- 1 x IPOINT Connect PRO WallStation

Note: The IPOINT Connect PRO Case for iPad is sold separately and is required for use with the WallStation.

SETUP AND INSTALLATION

The IPORT Connect PRO WallStation is designed for installation into a standard 1G electrical box. Professional installation is recommended.

1. Prepare the Installation Location

Ensure the power to the electrical box is turned off at the circuit breaker before beginning installation. The WallStation requires a 12V DC power source, which can be supplied via a CAT5 cable or 2-conductor wire, or an optional PoE+ upgrade.



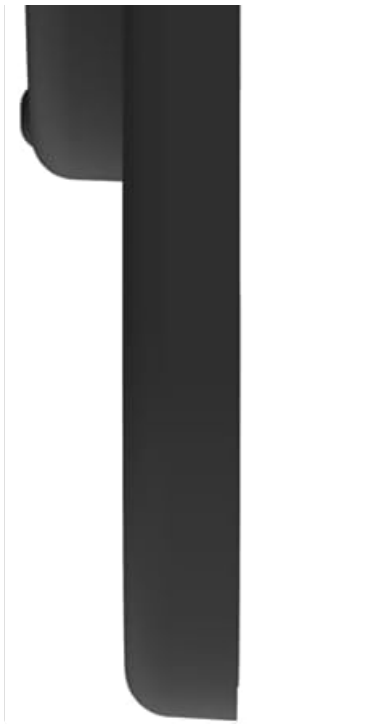

Image: Side view of the IPORT Connect PRO WallStation, highlighting its slim design.

2. Wiring the WallStation

Connect the power wires to the appropriate terminals on the back of the WallStation. Refer to the wiring diagram provided with your specific power supply or PoE+ module. Ensure all connections are secure.

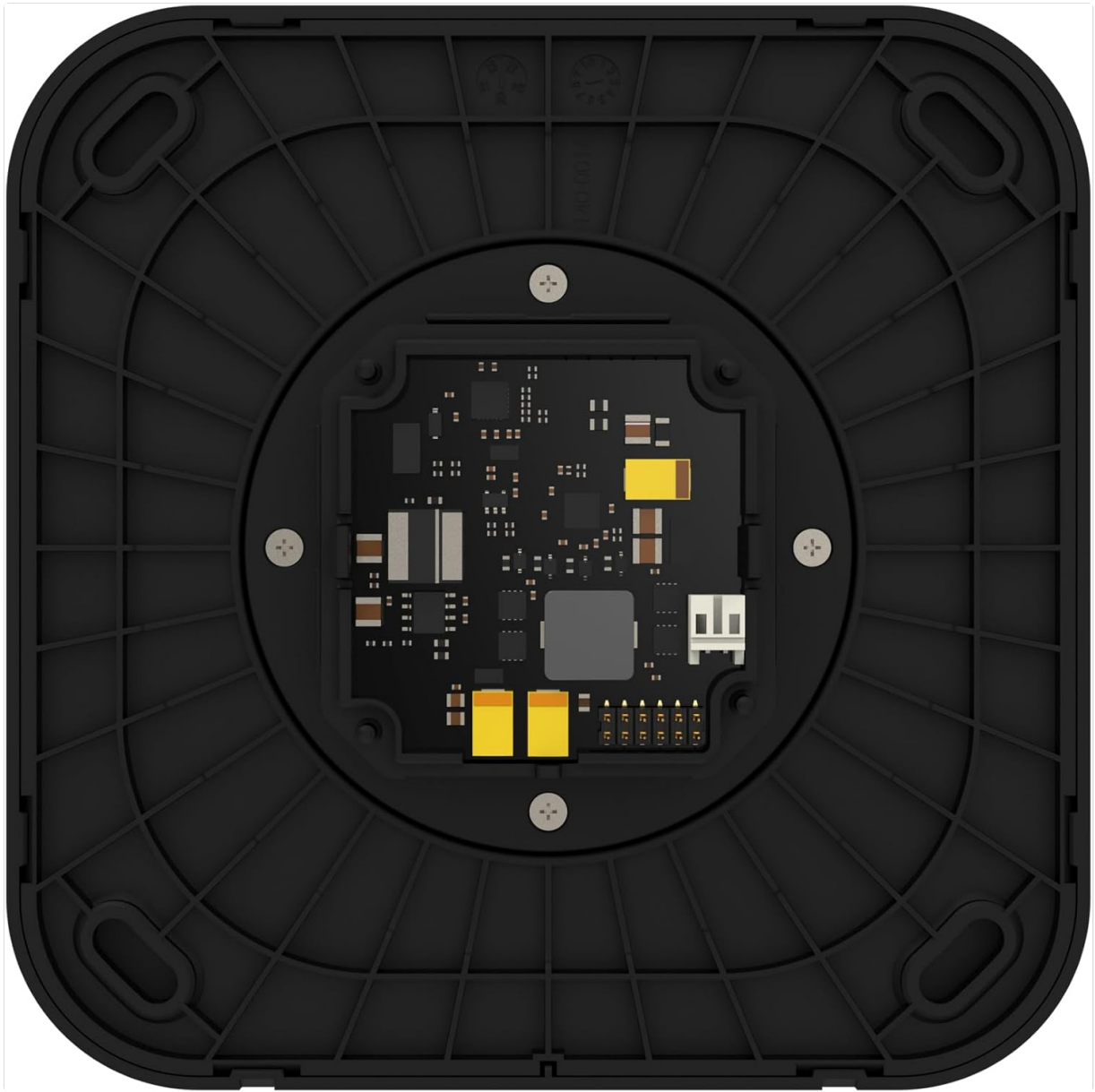

Image: Rear view of the WallStation, showing the internal components and screw holes for mounting.

3. Mounting the WallStation

Carefully align the WallStation with the 1G electrical box and secure it using the provided screws. Ensure the WallStation is flush with the wall surface.



Image: Back view of the WallStation, showing the mounting holes and product information label.

4. Power On and Test

Once the WallStation is securely mounted and wired, restore power at the circuit breaker. The WallStation is now ready for use.

OPERATING INSTRUCTIONS

1. Preparing Your iPad

Ensure your iPad is enclosed in an IPORT Connect PRO Case. The WallStation is designed to work exclusively with this case for proper magnetic docking and contactless charging.



**MOUNT IPAD IN PORTRAIT
OR LANDSCAPE**

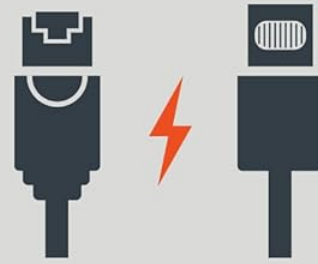

**EASY INSTALLATION
WITH CAT5 CABLE OR
2 CONDUCTOR WIRE**



**MAGNETIC MOUNTING
FOR IPAD**



**WIRELESS CHARGING FOR
IPAD WHEN MOUNTED TO
A WALLSTATION**



**FITS INTO ANY 1G
ELECTRICAL BOX
WORLDWIDE**

PoE+

**POWER VIA POE+ WITH
OPTIONAL UPGRADE**

**Case and WallStation sold separately.*

Image: An iPad, housed in an IPORT Connect PRO Case, magnetically docked to the WallStation on a wall.

2. Docking the iPad

Gently bring the iPad (in its Connect PRO Case) close to the WallStation. The powerful magnets will align the iPad and securely attach it to the WallStation. The charging pins on the WallStation will engage with the case to initiate contactless charging.



Image: Front view of the WallStation, displaying the central charging pins.

3. Adjusting Orientation

The WallStation allows for 360-degree rotation of the docked iPad. Simply rotate the iPad to your desired portrait or landscape orientation without removing it from the WallStation.

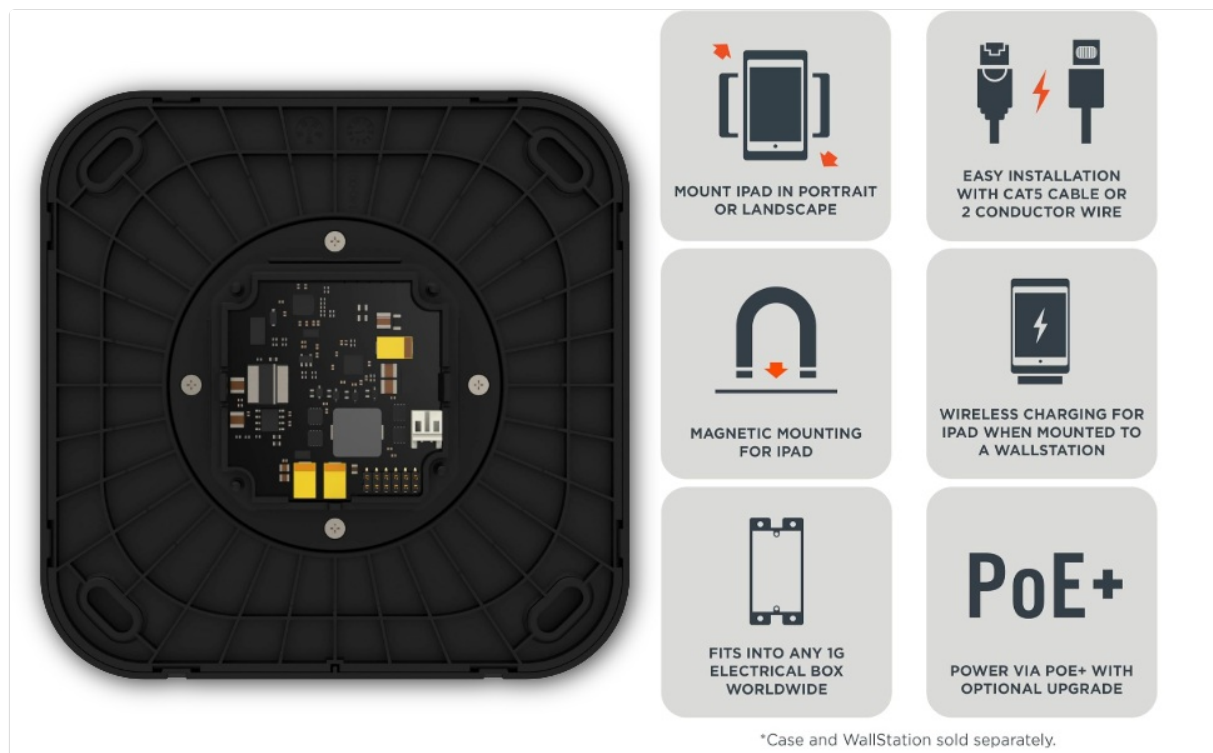

Image: Diagram detailing the WallStation's features, including its ability to mount an iPad in portrait or landscape orientation, contactless charging pins, power input options, and installation details.

4. Undocking the iPad

To remove the iPad, simply pull it away from the WallStation. The magnetic attachment allows for a quick and easy release.

MAINTENANCE

- **Cleaning:** Use a soft, dry cloth to clean the surface of the WallStation. Avoid abrasive cleaners or solvents.
- **Inspection:** Periodically check the WallStation for any signs of damage or loose connections.
- **Charging Pins:** Ensure the charging pins on the WallStation and the corresponding contacts on the Connect PRO Case are free from dust and debris.

TROUBLESHOOTING

Problem	Possible Cause	Solution
iPad not charging.	<ul style="list-style-type: none">◦ iPad not properly docked.◦ Power to WallStation is off.◦ Charging pins/contacts are dirty.◦ iPad not in Connect PRO Case.	<ul style="list-style-type: none">◦ Re-dock the iPad, ensuring a secure magnetic connection.◦ Check circuit breaker and power connections to the WallStation.◦ Clean charging pins on WallStation and contacts on Connect PRO Case.◦ Ensure iPad is in an IPORT Connect PRO Case.

Problem	Possible Cause	Solution
iPad not docking securely.	<ul style="list-style-type: none">◦ Obstruction between iPad and WallStation.◦ iPad not in Connect PRO Case.	<ul style="list-style-type: none">◦ Remove any foreign objects.◦ Ensure iPad is in an IPORT Connect PRO Case.
iPad rotation is stiff.	Dust or debris in the rotation mechanism.	Gently clean around the rotating mechanism with a soft, dry cloth.

SPECIFICATIONS

Model Number	72350
Brand	iPort
Product Dimensions	3.98 x 7.32 x 7.8 inches
Item Weight	1.61 pounds
Color	Black
Connector Type	USB (for power input)
Compatible Devices	Tablets (specifically iPad models with IPORT Connect PRO Case)
Compatible iPad Models	iPad Mini 6th Gen, iPad Air, iPad Pro (when used with Connect PRO Case)
Input Voltage	12 Volts
Amperage	3 Amps
Special Feature	Magnetic, Contactless Charging, 360° Rotation

WARRANTY AND SUPPORT

For warranty information and technical support, please refer to the official iPort website or contact iPort customer service directly. Keep your purchase receipt for warranty claims.

Manufacturer: IPORT

Website: www.iportproducts.com