

## HopeRock HR557732A1

# HopeRock Indoor Basketball Hoop with LED Light and Scoreboard Instruction Manual

Model: HR557732A1

## PRODUCT OVERVIEW

The HopeRock Indoor Basketball Hoop is designed for children to enjoy basketball indoors. It features an electronic scoreboard with LED lights and multiple game modes to enhance the playing experience. The hoop is designed for easy installation over most standard doors.

- **LED Lights and Automatic Scoreboard:** Features upgraded LED light effects and an automatic scoring function. The cool lights and cheering sounds activate upon scoring, providing an engaging experience.
- **3 Game Modes:** Offers single practice mode, double competition mode, and extreme challenge mode to cater to different play styles and skill levels.
- **Easy to Install and Portable:** Designed for quick setup and disassembly, making it convenient to move and store. Requires 3 AA batteries (not included).
- **High Quality and Durable:** Constructed with strong, durable materials, including a high-strength backboard and reinforced steel sides. Includes protective foam padding to reduce noise and protect doors.

## WHAT'S INCLUDED

Verify that all components are present before beginning assembly:

- 1x Backboard with electronic scoreboard
- 1x Basketball Rim
- 1x Net (red, white, and blue)
- 3x Mini Basketballs
- 1x Ball Pump
- Mounting Hooks and Screws
- Protective Foam Padding



Image: All components included in the HopeRock Indoor Basketball Hoop package.



Image: Detailed view of the backboard, rim, net, and various screws for assembly.

## SETUP INSTRUCTIONS

1. **Attach the Rim:** Secure the basketball rim to the designated area on the backboard using the provided screws.

Ensure it is firmly attached.

2. **Install the Net:** Attach the net to the rim.
3. **Insert Batteries:** Locate the battery compartment on the back of the scoreboard unit. Insert 3 AA batteries (not included), ensuring correct polarity.
4. **Apply Foam Padding:** Attach the protective foam padding to the back of the backboard, especially on the corners and edges that will contact the door. This helps reduce noise and prevents damage to the door.
5. **Mount Over the Door:** Place the mounting hooks over the top edge of a standard door. Ensure the backboard hangs securely and is level. The hooks should be positioned behind the board, with screws passing through the board and then through the hooks for correct installation.

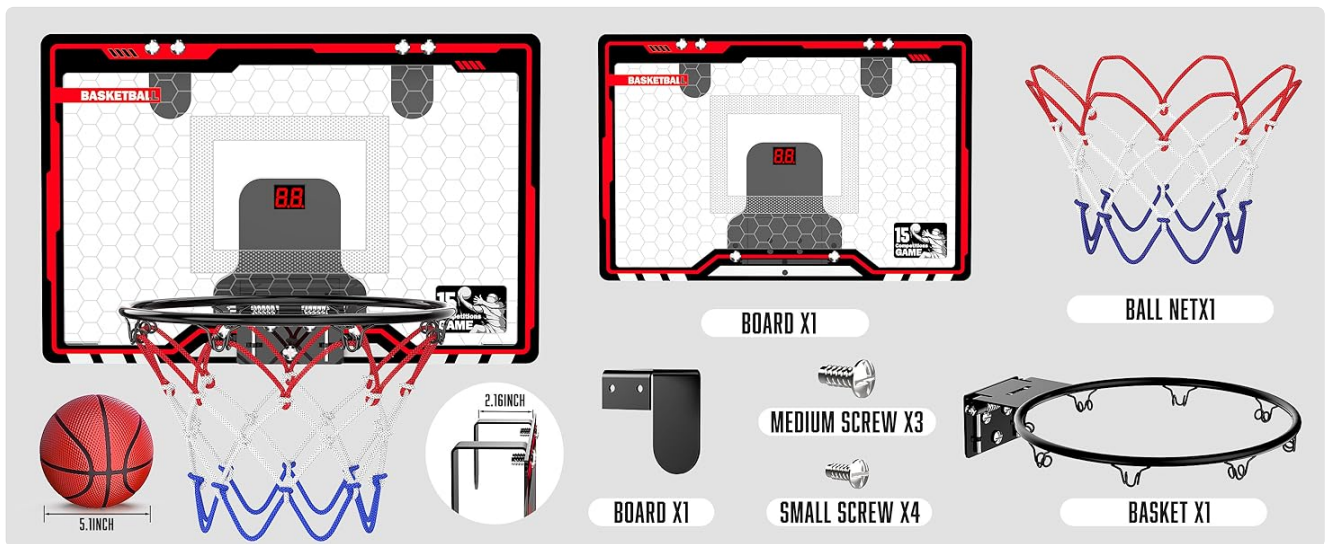

Image: Correct installation method for mounting hooks and screws.

6. **Inflate Basketballs:** Use the provided pump to inflate the mini basketballs to the recommended pressure.





Image: The backboard with mounting hooks installed over a door.



Image: Battery compartment for the electronic scoreboard.



## OPERATING INSTRUCTIONS

1. **Power On/Off:** Locate the Power ON/OFF button on the control panel (usually at the bottom of the backboard). Press to turn the unit on or off.
2. **Select Game Mode:** Use the "MODE" button to cycle through the available game modes:
  - **Single Practice Mode:** For individual play, focusing on shooting practice.
  - **Double Competition Mode:** For two players to compete, with the scoreboard tracking scores.
  - **Extreme Challenge Mode:** A timed mode for high-intensity play.



Image: The three available game modes for the basketball hoop.

3. **Adjust Volume:** Use the "Vol+" and "Vol-" buttons to adjust the sound level of the scoreboard.
4. **Automatic Scoring and LED Lights:** The electronic scoreboard will automatically detect successful shots and update the score. The LED lights on the backboard will illuminate and flash with sound effects when a basket is made, enhancing the playing experience.





Image: LED lights and automatic scoreboard during play.



Image: The LED lights on the hoop's backboard.

## MAINTENANCE

- **Cleaning:** Wipe the backboard and rim with a soft, damp cloth. Avoid using abrasive cleaners or solvents.
- **Battery Replacement:** Replace batteries when the scoreboard display dims or stops functioning. Ensure to use 3 new AA batteries.
- **Net Care:** Periodically check the net for wear and tear. Replace if damaged to ensure continued play.
- **Storage:** When not in use for extended periods, store the hoop in a dry place away from direct sunlight.

## TROUBLESHOOTING

- **Scoreboard Not Working:**
  - Check if the batteries are correctly inserted and not depleted. Replace if necessary.
  - Ensure the Power ON/OFF button is pressed.
- **Inaccurate Scoring:**



- Ensure the ball passes cleanly through the hoop without obstruction.
- Verify the sensor area is clean and free from debris.
- **Hoop Stability:**
  - Confirm that the mounting hooks are securely placed over the door and the screws are tightened.
  - Ensure the protective foam padding is correctly positioned to prevent movement and noise.

SPECIFICATIONS

Brand	HopeRock
Model Name	Basketball Hoop
Part Number	HR557732A1
Material	Acrylic (Backboard), Metal (Frame)
Color	Black and Red
Product Dimensions (LxWxH)	15.95"D x 3.54"W x 10.83"H
Item Weight	3 Pounds
Mounting Type	Door Mount
Special Feature	Portable, LED Lights, Automatic Scoreboard
Assembly Required	Yes
Power Source	3 AA Batteries (not included)

WARRANTY INFORMATION

Please retain your proof of purchase for any warranty claims. For specific warranty details, refer to the product packaging or contact HopeRock customer support.

CUSTOMER SUPPORT

For further assistance, questions, or to report any issues, please contact HopeRock customer support through the retailer's platform or visit the official HopeRock website.