

Camgeet KC-KVM212DH

Camgeet MST Displayport KVM Switch User Manual

Model: KC-KVM212DH

1. INTRODUCTION

This manual provides detailed instructions for the installation, operation, and maintenance of your Camgeet MST Displayport KVM Switch, Model KC-KVM212DH. This device allows you to control two computers using a single set of keyboard and mouse, while sharing two monitors and up to four USB 3.0 devices.

Please read this manual thoroughly before using the product to ensure proper functionality and to prevent damage.

2. PACKAGE CONTENTS

Verify that all items are present in the package:

- 1x Camgeet Dual Monitor Displayport 1.4 USB 3.0 KVM Switch
- 2x DP1.4 Cables (1.5m)
- 2x USB 3.0 Cables (1.5m)
- 1x Wired Remote (1.52m)
- 1x USB-C Power Cable
- 1x User Manual

PACKING LIST:

- 1x Displayport KVM Switch
- 2x USB3.0 Cable (1.5m)
- 2x 8K DP1.4 Cable (1.5m)
- 1x Wired Remote(1.5m)
- 1x Power Cable
- 1x User Manua

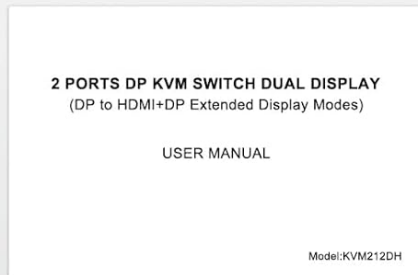

13.68cm/5.38in

6.55cm
/2.58in



1.9cm/
0.75in

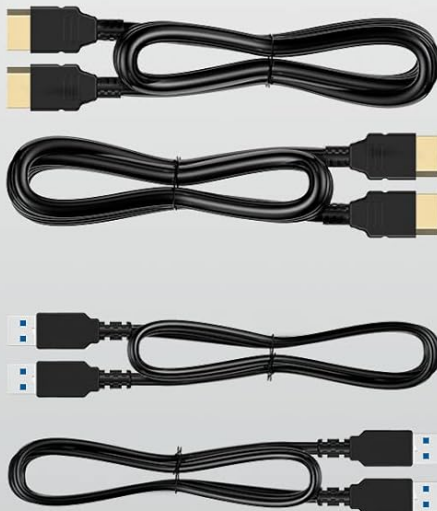

Image: Contents of the Camgeet KVM switch package, including the main unit, two DisplayPort cables, two USB 3.0 cables, a wired remote, a USB-C power cable, and the user manual.

3. PRODUCT FEATURES

- **Dual Monitor Support:** Connects two computers to two monitors (extended or mirrored display modes).
- **High Resolution:** Supports up to 8K@30Hz for a single monitor, or 4K@100Hz for dual monitors.
- **USB 3.0 Hub:** Features 4 integrated USB 3.0 ports (3 USB-A + 1 USB-C) for high-speed data transfer up to 5Gbps.
- **Simplified Connectivity:** Each PC requires only one DisplayPort 1.4 cable and one USB 3.0 cable for dual-screen output (DP1.4 + HDMI2.0).
- **Operating System Compatibility:** Driver-free for Windows 11/10/8/7/XP and Mac OS. Plug and play.
- **Switching Modes:** Switch between computers using the front panel button or the included wired remote.
- **Power Management:** Includes a power adapter for stable operation with high-power USB devices and an ON-OFF switch.

4. SPECIFICATIONS

Model Number	KC-KVM212DH
Product Dimensions	5.31 x 2.56 x 0.79 inches
Item Weight	1.49 Pounds
Video Input	DisplayPort 1.4 (1 per PC)
Video Output	DisplayPort 1.4, HDMI 2.0 (2 monitors total)
Max Resolution (Single Monitor)	8K@30Hz, 4K@144Hz
Max Resolution (Dual Monitors)	4K@100Hz
USB Ports	4x USB 3.0 (3x USB-A, 1x USB-C)
Data Transfer Speed	Up to 5Gbps (USB 3.0)
Operation Mode	ON-OFF
Operating Voltage	5 Volts
Current Rating	2 Amps

5. SETUP INSTRUCTIONS

Follow these steps to connect your Camgeet KVM switch:

5.1. Connection Diagram

Each PC only needs 1*DP+1*USB cable to connect with the KVM to get dual-screen DP+HDMI output

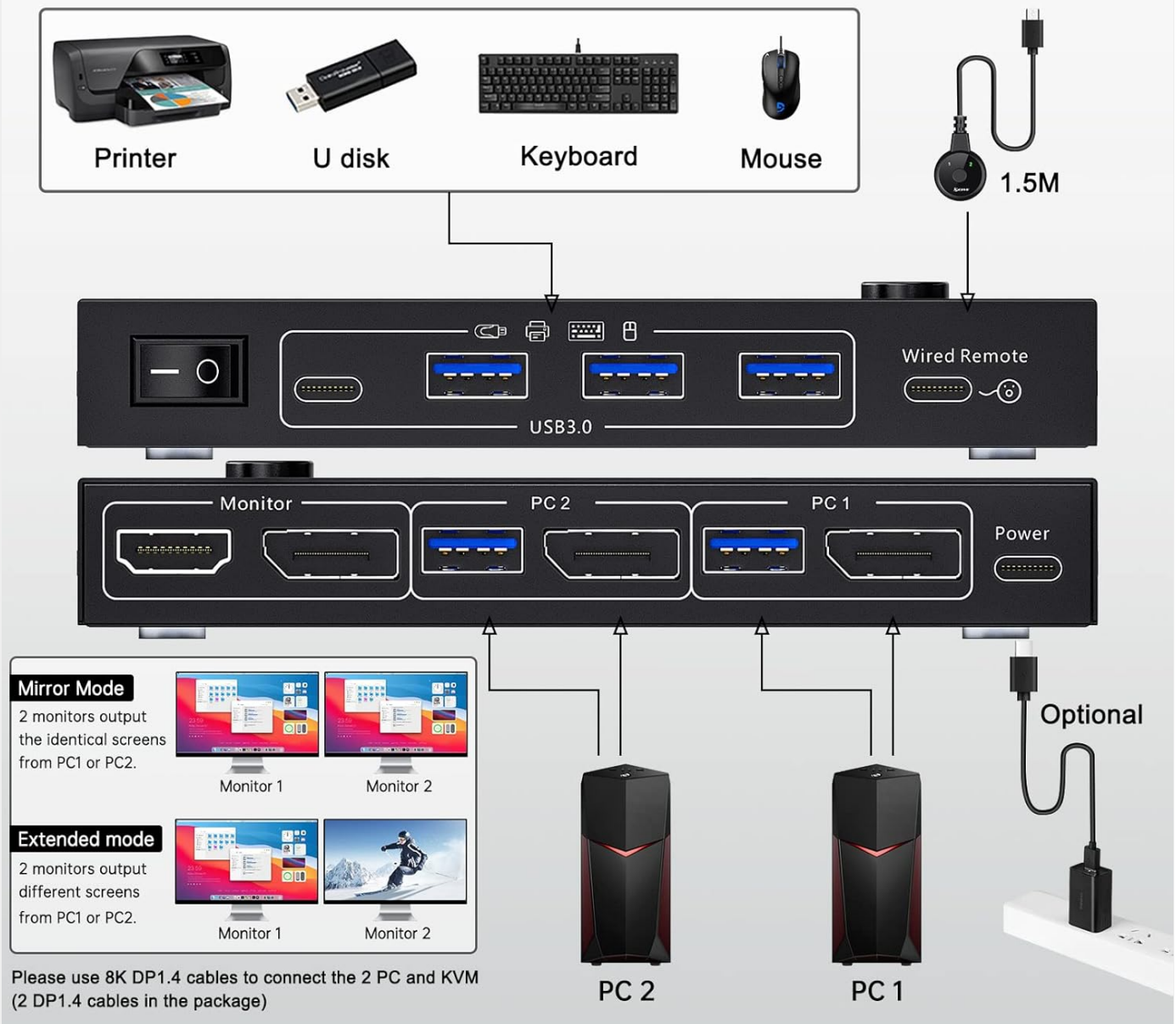

Image: A detailed diagram illustrating how to connect two PCs to the KVM switch, and how the KVM switch connects to two monitors and various USB peripherals like a printer, U disk, keyboard, and mouse. It also shows the power connection and the wired remote.

5.2. Step-by-Step Connection

- 1. Power Connection:** Connect the provided USB-C power cable to the "DC/5V" port on the KVM switch and to a 5V power adapter (not included, or use a USB port on one of your computers if not using high-power USB devices). Ensure the ON-OFF switch is in the OFF position before connecting.
- 2. Monitor Connection:**
 - Connect your primary monitor to the "Monitor DP" output port on the KVM switch using a DisplayPort cable.
 - Connect your secondary monitor to the "Monitor HDMI" output port on the KVM switch using an HDMI cable.
- 3. Computer 1 Connection:**
 - Connect one end of a provided DP1.4 cable to the DisplayPort output of PC 1 and the other end to the "PC 1 DP" input on the KVM switch.
 - Connect one end of a provided USB 3.0 cable to a USB 3.0 port on PC 1 and the other end to the "PC 1" input on the KVM switch.

USB3.0" input on the KVM switch.

4. **Computer 2 Connection:**

- Connect one end of a provided DP1.4 cable to the DisplayPort output of PC 2 and the other end to the "PC 2 DP" input on the KVM switch.
- Connect one end of a provided USB 3.0 cable to a USB 3.0 port on PC 2 and the other end to the "PC 2 USB3.0" input on the KVM switch.

5. **Peripheral Connection:** Connect your keyboard, mouse, printer, U disk, or other USB 3.0 devices to the "USB3.0" ports on the front panel of the KVM switch.

6. **Wired Remote Connection:** Plug the wired remote into the dedicated "Wired Remote" port on the KVM switch.

7. **Power On:** Flip the ON-OFF switch to the ON position. The KVM switch will power on, and the LED indicators will show the active computer.

Important Notes:

- Ensure you use the provided DP1.4 cables for optimal performance and resolution support.
- The input only supports DisplayPort (DP, mini DP to DP, or USB C to DP adapter). It does not support HDMI/VGA to DP input.
- The output supports DP to HDMI when connected to an HDMI monitor.
- For higher resolutions (e.g., 8K@30Hz), ensure your DisplayPort cables are DP1.4 compliant.
- If using high-power USB devices, an external 5V power adapter is recommended for stable operation.

6. OPERATING INSTRUCTIONS

6.1. Switching Between Computers

The Camgeet KVM switch offers two methods for switching between connected computers:

1. **Front Panel Button:** Press the "Switch" button on the front panel of the KVM device. The LED indicators will change to show which computer is currently active.
2. **Wired Remote Control:** Press the button on the wired remote control. This provides a convenient way to switch computers from your desk without reaching for the KVM unit.

Ultra-fast USB 3.0 Data Transfer Rates Up to 5Gb/s (10 Times Faster Than USB 2.0)

4 USB3.0 ports for USB devices



Image: Two methods of switching between computers: directly pressing the button on the KVM switch or using the included wired remote control.

6.2. Display Modes (Extended/Mirrored)

The KVM switch supports both extended and mirrored display modes for your monitors. The configuration is managed by your computer's operating system.

Easily Switch with One Button, Enjoy Immediately



Button Switch



Wired Remote Control (1.5m)

Image: Visual representation of extended mode, where two monitors display different content, and mirror mode, where both monitors show identical content. Instructions for Windows users to press "Window + P" to access display settings are also shown.

For Windows OS: Press "**Window + P**" on your keyboard. A small window will appear, allowing you to choose between "Duplicate" (Mirrored) or "Extend" (Extended) display modes.

For Mac OS: Mac systems typically support extended mode for two different screens. However, some configurations may only allow two identical screens (mirrored) depending on the specific Mac model and software version. Adjust display settings in System Preferences.

6.3. USB 3.0 Port Usage

The KVM switch includes four USB 3.0 ports (three USB-A and one USB-C) for connecting peripherals. These ports support data transfer speeds up to 5Gbps, making them suitable for keyboards, mice, printers, scanners, and USB storage devices.

8K Ultra HD Enjoyment

Single monitor output up to 8K@30Hz, 4K@144Hz
Simultaneous output of dual monitors up to 4K@100Hz



Note: Please be sure to use 8K DP1.4 cable at the input end to obtain higher resolution.

Image: A close-up view of the KVM switch highlighting the USB 3.0 ports, indicating ultra-fast data transfer rates up to 5Gbps, which is 10 times faster than USB 2.0.

7. MAINTENANCE

- Keep the KVM switch in a dry, well-ventilated area, away from direct sunlight and heat sources.
- Clean the device with a soft, dry cloth. Do not use liquid or aerosol cleaners.
- Avoid placing heavy objects on the KVM switch.
- When not in use for extended periods, you can use the ON-OFF switch to power down the device.

8. TROUBLESHOOTING

If you encounter issues with your Camgeet KVM switch, please refer to the following common solutions:

- **No Display/Flickering Screen:**

- Ensure all DisplayPort and HDMI cables are securely connected to both the KVM switch and your monitors/computers.
- Verify that the correct input source is selected on your monitors.
- Check if the KVM switch is properly powered. If using high-power USB devices, ensure an external 5V power adapter is connected.
- Try restarting the KVM switch by cycling its power using the ON-OFF switch.
- Ensure your computer's graphics drivers are up to date.
- If experiencing issues with multiple screens on Linux, try plugging the desktop directly into the screen first, then through the KVM switch.

- **Keyboard/Mouse Not Responding:**

- Ensure the USB 3.0 cables from your computers to the KVM switch are securely connected.
- Try connecting the keyboard/mouse to a different USB port on the KVM switch.
- If using a high-power keyboard, ensure the KVM switch is powered by an external 5V adapter.
- Some specialized gaming keyboards or mice may require direct connection to the computer or may have specific power requirements that exceed the KVM's capabilities.
- Restart the KVM switch and the connected computers.

- **Switching Issues:**

- Ensure the wired remote is properly connected.
- Check the LED indicators on the KVM switch to confirm which computer is active.
- Allow a few seconds for the operating system to detect and configure the displays after switching.

- **Resolution/Refresh Rate Limitations:**

- Ensure all DisplayPort cables are DP1.4 compliant and of high quality, especially for 4K@100Hz or 8K@30Hz resolutions.
- Verify that your graphics card and monitors support the desired resolution and refresh rate.
- Note that 1440p resolution may be limited to 144Hz.

For further assistance, please refer to the [Troubleshooting Guide \(PDF\)](#) or contact customer support.

9. WARRANTY INFORMATION

The Camgeet MST Displayport KVM Switch comes with a **1-year warranty** from the date of purchase. This warranty covers manufacturing defects and malfunctions under normal use.

The warranty does not cover damage caused by misuse, accidents, unauthorized modifications, or improper installation. Please retain your proof of purchase for warranty claims.

10. CUSTOMER SUPPORT





If you have any questions, require technical assistance, or need to make a warranty claim, please contact Camgeet customer support.

You can visit the official Camgeet store on Amazon for more information and contact options: [Camgeet Store](#)

Please have your product model number (KC-KVM212DH) and purchase details ready when contacting support.

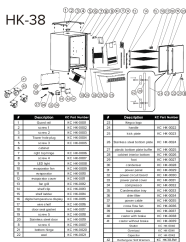
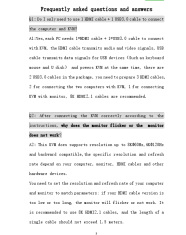

Related Documents - KC-KVM212DH

	<p>Kegco HK-38 Parts Diagram and Identification</p> <p>Detailed parts diagram and list for the Kegco HK-38 commercial beverage dispenser, including part numbers and descriptions for all components.</p>
	<p>Camgeet KVM Switch FAQ and Troubleshooting Guide</p> <p>Comprehensive FAQ and troubleshooting guide for the Camgeet 8K USB 3.0 KVM Switch (model KC-KVM8201). Covers connectivity, resolution support (8K@60Hz, 4K@120Hz), HDMI 2.1 features, USB 3.0 sharing, and solutions for common issues like monitor flickering and wireless device interference.</p>
	<p>Koncai Rolling Nail Workstation User Manual - Setup and Operation Guide</p> <p>Comprehensive user manual for the Koncai Rolling Nail Workstation. Includes safety instructions, specifications, package contents, setup guide, operation details, and FCC compliance information.</p>
	<p>KEBA KeContact M20 Technical Data</p> <p>Technical specifications for the KEBA KeContact M20 charging controller, detailing product variants, general specifications, power supply, connectivity, environmental conditions, dimensions, and certifications.</p>
	<p>KeContact M20 Hoja de Datos Técnicos - KEBA</p> <p>Especificaciones técnicas detalladas para el controlador de gestión de carga KEBA KeContact M20, cubriendo diseño, variantes de producto, especificaciones generales, fuente de alimentación, condiciones ambientales, opciones de conectividad, certificaciones y dimensiones.</p>
	<p>KEBA KeContact M20 Charging Management Controller Technical Data</p> <p>Technical specifications and product details for the KEBA KeContact M20 charging management controller, including design, variants, general specifications, power supply, environmental conditions, interfaces, dimensions, weight, and country-specific features.</p>

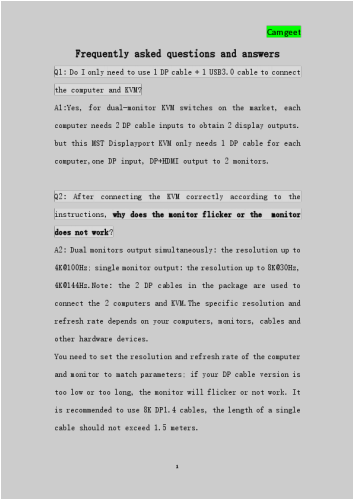

[\[pdf\]](#) Instructions Frequently Asked Questions Troubleshooting Guide Guide

Admin MST Displayport KVM Switch 2 Monitors Computers 4K@144Hz 1 DP in HDMI Out Camgeet Dual Monitor 4 with USB 3 0 Port for Device Wired Remote and Cables Included KC KVM212DH Troubleshooting Guide camgeet 61tJDcYQjrL m media amazon images I |||

Camgeet Frequently asked questions and answers Q1: Do I only need to use 1 DP cable 1 USB3.0 cable to connect the computer and KVM A1:Yes, for dual-monitor KVM switches on the market, each computer needs 2 DP cable inputs to obtain 2 display outputs. but this MST Displayport KVM only needs 1 DP c... lang:en score:43 filesize: 77.96 K page_count: 5 document date: 2023-06-16



[\[pdf\]](#) User Manual

Admin MST Displayport KVM Switch 2 Monitors Computers 4K@144Hz 1 DP in HDMI Out Camgeet Dual Monitor 4 with USB 3 0 Port for Device Wired Remote and Cables Included KC KVM212DH User Manual camgeet 91km9AN08 L m media amazon images I ||| 2 PORTS DP KVM SWITCH DUAL DISPLAY DP to HDMI DP Extended Display Modes Camgeet USER MANUAL 1 Model:KVM212DH Camgeet 1. Description This USB displayport dual monitor KVM switch can control 2 desktops or laptops with 1 set of wired or wireless keyboard, mouse and 2 monitors.Support extended di... lang:en score:39 filesize: 594.07 K page_count: 12 document date: 2023-07-11



[\[pdf\]](#) Borchure

Admin MST Displayport KVM Switch 2 Monitors Computers 4K@144Hz 1 DP in HDMI Out Camgeet Dual Monitor 4 with USB 3 0 Port for Device Wired Remote and Cables Included KC KVM212DH Brochure camgeet 81rT1oIV8ML m media amazon images I ||| Camgeet MST Dual Monitor KVM Do you have such troubles: 1.The desktop is too small to accommodate two computers and two monitors. Need to unplug and plug cables back and forth. 2. You want to extend your computer screen, but the computer has only one DP or one USB-C interface 3. You want to add a ... lang:en score:33 filesize: 341.19 K page_count: 5 document date: 2023-07-11