

## BURBERRY BE2334 ELM 3024

# BURBERRY Eyeglasses BE 2334 3024 Elm Transparent - User Manual

Model: BE2334 ELM 3024

## INTRODUCTION

Thank you for choosing BURBERRY Eyeglasses BE 2334 3024 Elm Transparent. These eyeglasses are crafted with precision, designed for both comfort and fashion, and represent a blend of functionality and aesthetics. This manual provides essential information for the proper setup, operation, maintenance, and care of your new eyeglasses.

## SETUP AND INITIAL USE

Upon receiving your new Burberry eyeglasses, please follow these steps for initial setup:

- Unboxing and Inspection:** Carefully remove the eyeglasses from their packaging. Inspect the frames for any visible damage or imperfections. Ensure all components, including the frame and demo lenses, are present.
- Professional Lens Fitting:** These eyeglasses come with demo lenses. It is crucial to have prescription lenses fitted by a qualified optician. The optician will also ensure the frame is properly adjusted to your face for optimal comfort and vision.
- Initial Adjustment:** While your optician will perform the primary fitting, minor adjustments to the temple arms (ear pieces) may be needed for a secure and comfortable fit. Avoid attempting significant adjustments yourself, as this can damage the frame.



Image: Front view of the Burberry BE 2334 3024 Elm Transparent eyeglasses, showcasing the clear plastic frame and rectangular shape.

## OPERATING AND WEARING

---

Proper handling and wearing of your eyeglasses will extend their lifespan and maintain their appearance.

- **Putting On/Taking Off:** Always use both hands to put on or take off your eyeglasses. Grasping both temple arms prevents bending or misalignment of the frame.
- **Proper Fit:** Eyeglasses should sit comfortably on your nose bridge without slipping or causing pressure marks. The temple arms should extend straight back to your ears, with a slight curve to hold them securely.
- **Handling:** Avoid placing your eyeglasses face down on hard surfaces to prevent scratching the lenses. When not in use, store them in their protective case.



Image: Angled view of the eyeglasses, highlighting the design details on the temple arms.

## MAINTENANCE AND CARE

---

Regular cleaning and proper care are essential to keep your Burberry eyeglasses in excellent condition.

- **Cleaning Lenses:**
  - a. Rinse your lenses under lukewarm running water to remove dust and debris. Avoid hot water, which can damage lens coatings.
  - b. Apply a small drop of mild dish soap to each lens.
  - c. Gently rub the lenses with your fingertips.
  - d. Rinse thoroughly to remove all soap.

e. Dry the lenses with a clean, lint-free microfiber cloth specifically designed for eyeglasses.

*Do not use paper towels, tissues, or clothing, as these can scratch the lenses. Avoid harsh cleaning chemicals.*

- **Cleaning Frames:** Wipe the frame with a damp, soft cloth. For plastic frames, a mild soap solution can be used.
- **Storage:** When not wearing your eyeglasses, always store them in the provided protective case to prevent scratches, bending, or breakage.
- **Temperature Exposure:** Avoid exposing your eyeglasses to extreme temperatures, such as leaving them in a hot car, as this can warp the plastic frame or damage lens coatings.



Image: Side view of the eyeglasses, illustrating the temple arm and hinge mechanism.

## TROUBLESHOOTING

If you encounter any issues with your eyeglasses, consider the following common solutions:

- **Eyeglasses Feel Crooked or Lopsided:** This is a common issue that can occur from normal wear or accidental bending.
  - **Solution:** Minor adjustments can sometimes be made by gently bending the temple arms. However, for significant or persistent crookedness, it is highly recommended to visit a professional optician. They have specialized tools and expertise to adjust the frame without causing damage.
- **Loose Screws:** Over time, the small screws holding the hinges or lenses in place may loosen.
  - **Solution:** Use a small optical screwdriver to gently tighten any loose screws. Do not overtighten, as this can strip the screw or damage the frame. If you don't have the correct tool, an optician can assist.
- **Discomfort or Pressure Points:** If your eyeglasses are causing discomfort on your nose, behind your ears, or on your temples.
  - **Solution:** This indicates the frame needs adjustment. Consult your optician for a professional fitting. They can reshape the temple arms or adjust nose pads (if applicable) for a comfortable fit.
- **Scratched Lenses:** While proper care minimizes scratches, they can still occur.
  - **Solution:** Unfortunately, scratches on lenses cannot be repaired. If scratches impair your vision, new lenses will be required.

## SPECIFICATIONS

Detailed specifications for your BURBERRY Eyeglasses BE 2334 3024 Elm Transparent:

Brand	BURBERRY
-------	----------

Model	BE2334 ELM 3024
Item Model Number	8056597640596
Frame Color	Clear / Transparent-3024
Frame Material	Plastic
Frame Type	Full Rim Rectangle Shape
Gender	Men's
Lens Type	Demo (for prescription fitting)
Lens Width	55mm
Lens Height (B)	38.5mm
Bridge Width	18mm
Temple Length	145mm
Origin	Italy
Product Dimensions	6 x 2 x 2 inches; 8 ounces
Model Year	2022

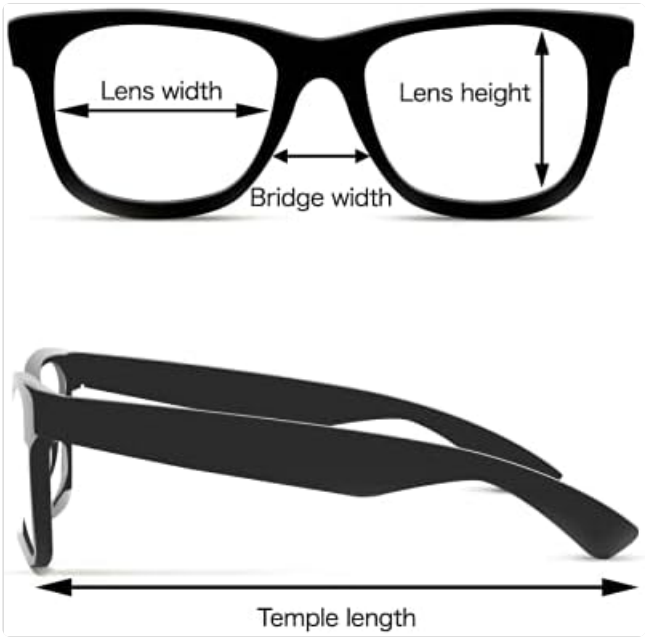



Image: A diagram showing key measurement points for eyeglasses, including lens width, lens height, bridge width, and temple length.

## WARRANTY AND SUPPORT

Your BURBERRY Eyeglasses BE 2334 3024 Elm Transparent come with a Manufacturer 2-Year Warranty. This warranty covers manufacturing defects. Please retain your proof of purchase for warranty claims.

For warranty service, product support, or any questions not covered in this manual, please contact the authorized Burberry eyewear dealer or the point of purchase. They will be able to provide assistance or direct you to the appropriate service center.

## Related Documents - BE2334 ELM 3024

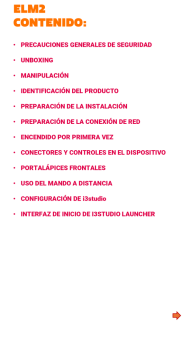
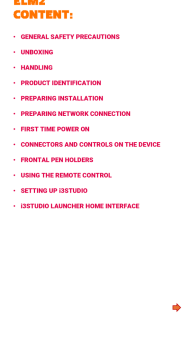
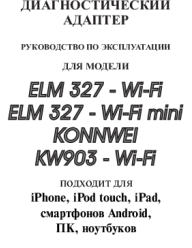
	<p><a href="#">Burberry Classic White Shirt with Blue Plaid Detail</a></p> <p>Explore the refined aesthetic of the Burberry classic white shirt, distinguished by its iconic blue and black plaid accents on the collar and placket. This piece offers a blend of timeless style and contemporary design, perfect for sophisticated casual or formal wear.</p>
	<p><a href="#">ELM-Series Electrolyte Level Monitor - Eagle Eye Power Solutions</a></p> <p>Eagle Eye Power Solutions' ELM-Series Electrolyte Level Monitor provides reliable monitoring of electrolyte levels and temperature in flooded batteries. This system features low-cost, auto-calibrating sensors, alarm contacts, visual LED indicators, and easy installation, helping to reduce maintenance costs and comply with NERC standards. Includes technical specifications, system components, and ordering information for models supporting up to 240 cells.</p>
	<p><a href="#">i3CONNECT ELM User Manual</a></p> <p>User manual for the i3CONNECT ELM interactive display, covering setup, operation, connections, and maintenance.</p>
	<p><a href="#">i3CONNECT ELM2 User Manual and Setup Guide</a></p> <p>Comprehensive guide for the i3CONNECT ELM2 interactive display, covering safety precautions, unboxing, handling, product identification, installation, network connection, first-time power-on, connectors, remote control usage, i3STUDIO setup, and end-of-life information.</p>
	<p><a href="#">ELM 327 Wi-Fi OBD II Diagnostic Adapter User Manual</a></p> <p>Comprehensive guide for ELM 327 Wi-Fi, ELM 327 Wi-Fi mini, and KONNWEI KW903 Wi-Fi OBD II diagnostic adapters. Covers setup, connection, supported vehicles, software configuration, and technical specifications for various devices including iPhone, iPad, Android, and PCs.</p>

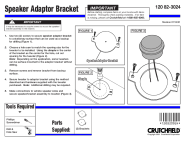

[Speaker Adaptor Bracket Installation Guide](#)

Concise guide for installing a speaker adaptor bracket, including tools required, parts supplied, and step-by-step instructions. Features Crutchfield product information and compatibility details.