

VPFET 2023050018

VPFET Dual Monitor HDMI KVM Switch (Model: 2023050018)

User Manual

INTRODUCTION

The VPFET Dual Monitor HDMI KVM Switch allows two computers to share two monitors, one keyboard, one mouse, and other USB 3.0 peripherals. This device supports high-resolution video output up to 4K@60Hz and offers flexible display modes including replication and extension. It is designed to streamline your workspace by eliminating the need for multiple sets of peripherals for different computers.

PACKAGE CONTENTS

Please verify that all items are present in your package:

- 1 x HDMI KVM Switcher
- 1 x External Controller Kit (1.5m cable)
- 2 x USB 3.0 A-A Cables
- 1 x DC12V Power Adapter
- 1 x User Manual

Package Contents

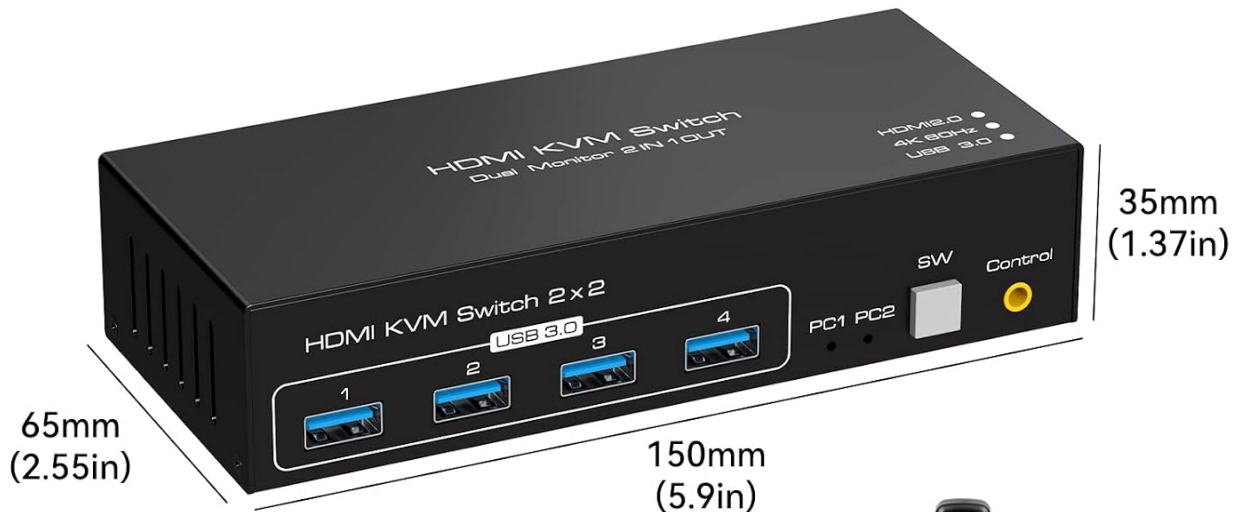

1. HDMI KVM Switcher



4. DC12V power adapter



2. External controller kits



3. USB 3.0 A-A cable

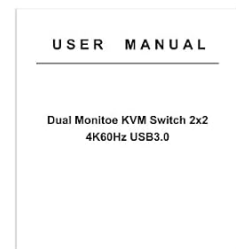

5. User manual

Image: Contents of the VPFET Dual Monitor HDMI KVM Switch package, including the KVM unit, external switch, USB cables, power adapter, and user manual.

PRODUCT FEATURES

- **2-Port Dual Monitor KVM Switch:** Connects 2 host computers to share 1 keyboard, 1 mouse, and 2 monitors.
- **High Resolution Support:** Supports resolutions up to 4096x2160@60Hz (4K@60Hz), backward compatible with lower resolutions like 1080p@120Hz.
- **USB 3.0 Connectivity:** Features four USB 3.0 ports with data transfer rates up to 5Gbps, backward compatible with USB 2.0 and USB 1.1 devices.
- **Multiple Switching Methods:** Switch between computers using the front panel button or the included external control line.
- **Display Modes:** Supports both Copy Mode (displaying identical content on two screens) and Extend Mode (displaying different content across two screens).
- **Wide Compatibility:** Compatible with Windows, Vista, XP, Mac OS, Linux, and Unix operating systems.

SETUP INSTRUCTIONS

Follow these steps to connect your KVM switch:

1. **Power Connection:** Connect the DC12V power adapter to the KVM switch and then to a power outlet.
2. **Monitor Connections:** Connect your two monitors to the KVM switch's OUT1 and OUT2 HDMI ports.
3. **Computer 1 Connection:**
 - Connect two HDMI cables from your first computer's HDMI outputs (HDMI1 and HDMI2) to the KVM switch's PC1 HDMI1 and HDMI2 IN ports.
 - Connect one USB 3.0 A-A cable from your first computer's USB port to the KVM switch's PC1 USB IN port.
4. **Computer 2 Connection:**
 - Connect two HDMI cables from your second computer's HDMI outputs (HDMI1 and HDMI2) to the KVM switch's PC2 HDMI1 and HDMI2 IN ports.
 - Connect one USB 3.0 A-A cable from your second computer's USB port to the KVM switch's PC2 USB IN port.
5. **Peripheral Connections:** Connect your keyboard, mouse, and other USB 3.0 devices (e.g., U disk, printer) to the USB 3.0 ports (1, 2, 3, 4) on the front of the KVM switch.
6. **External Switch (Optional):** Connect the external switch kit to the 'Control' port on the KVM switch for remote switching.

Important Note: For dual monitor functionality (both Copy and Extend modes), your host computer's graphics card must have two HDMI outputs. If your computer only supports a single monitor, this KVM switch will not enable dual monitor functionality.

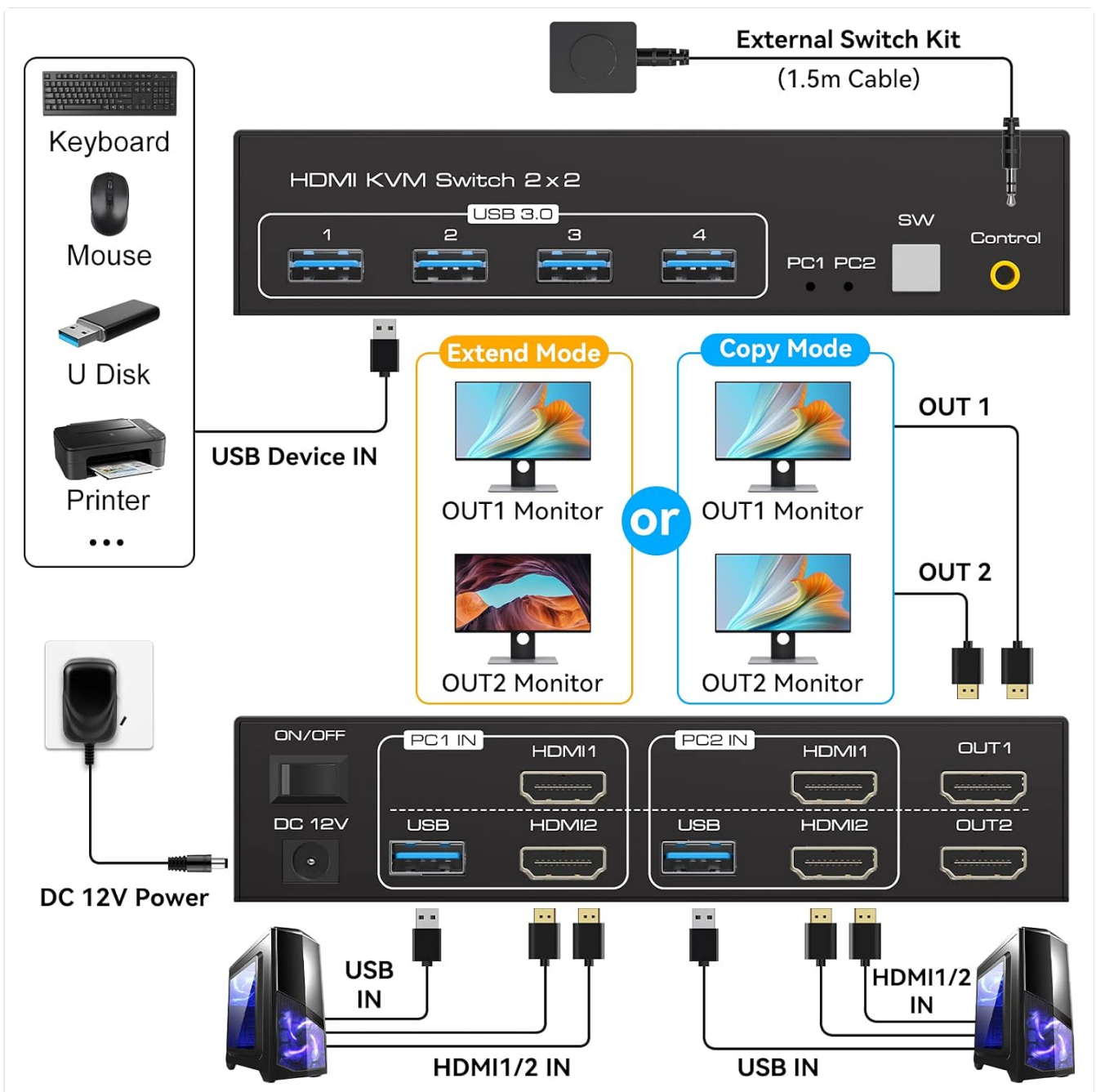

Image: Detailed connection diagram showing how to connect two computers, two monitors, keyboard, mouse, and other USB devices to the KVM switch.

OPERATING INSTRUCTIONS

Once all connections are made and the KVM switch is powered on, you can switch between the connected computers using one of two methods:

- **Front Panel Button:** Press the 'SW' button on the front panel of the KVM switch to toggle between PC1 and PC2. The LED indicators (PC1, PC2) will illuminate to show which computer is currently active.
- **External Switch Button:** Press the button on the external control line to switch between PC1 and PC2. This allows for convenient switching if the KVM unit is not easily accessible.

2 Switching Modes

1



Panel switch button

2



External switch button

Image: Illustration of the two switching methods: using the 'SW' button on the KVM switch's front panel and using the external switch button.

DISPLAY MODES

The KVM switch supports two primary display modes, provided your computer's graphics card supports dual monitor output:

- **Copy Mode (Replication):** In this mode, both connected monitors display identical content from the active computer. This is useful for presentations or mirroring your primary display.
- **Extend Mode (Extension):** In this mode, the two connected monitors act as a single, continuous desktop, allowing you to extend your workspace across both screens. This is ideal for multitasking and increased productivity.

You can configure these display modes through your computer's operating system display settings.

Dual Monitor HDMI KVM Switch

Using only 1 set of keyboard, mouse to control 2 computer devices and 2 monitor.



Copy Mode



Extend Mode

Image: Visual representation of Copy Mode, where both monitors show the same content, and Extend Mode, where monitors display different content to expand the desktop.

Up to 4K60Hz Resolution

Support resolution up to 3840*2160@60Hz.



Image: Demonstrates the KVM switch supporting 4K@60Hz resolution and the convenience of mouse movement across screens in extended mode.

TROUBLESHOOTING

If you encounter issues, please refer to the following common troubleshooting steps:

- **No Display on Monitors:**

- Ensure the KVM switch is powered on and the power adapter is securely connected.
- Verify all HDMI cables are securely connected between computers, KVM switch, and monitors.
- Check that the correct input source is selected on your monitors.
- Confirm your computer's graphics card supports dual HDMI output for dual monitor functionality.

- **Keyboard/Mouse Not Responding:**

- Ensure the USB 3.0 A-A cables are securely connected from your computers to the KVM switch's PC USB IN ports.
- Verify your keyboard and mouse are connected to the USB 3.0 ports on the front of the KVM switch.
- Try connecting the keyboard and mouse to different USB ports on the KVM switch.

- Some specialized gaming keyboards/mice may require direct connection to the computer or specific drivers.
- **Resolution or Image Quality Issues:**
 - Ensure all HDMI cables used are high-speed and support 4K@60Hz.
 - Update your computer's graphics drivers to the latest version.
 - Adjust display settings in your operating system.
- **Switching Delays:**
 - Ensure all cables are of good quality and properly connected.
 - Some systems may take a few seconds to detect the new display configuration after switching.

SPECIFICATIONS

Model Number	2023050018
Dimensions (L x W x H)	14.5 x 13.1 x 4.1 cm (5.7 x 5.16 x 1.61 inches)
Weight	540 grams (1.19 lbs)
HDMI Version	HDMI 2.0
Max Resolution	4096x2160@60Hz (4K@60Hz)
USB Ports	4 x USB 3.0
USB Data Transfer Rate	Up to 5Gbps
Control Method	Push Button (Panel), External Control Line
Power Supply	DC 12V
Operating Systems	Windows, Vista, XP, Mac OS, Linux, Unix

MAINTENANCE

To ensure the longevity and optimal performance of your KVM switch, follow these maintenance guidelines:

- **Cleaning:** Use a soft, dry cloth to clean the exterior of the device. Avoid using liquid cleaners or abrasive materials.
- **Storage:** Store the KVM switch in a cool, dry place away from direct sunlight and extreme temperatures.
- **Ventilation:** Ensure the device has adequate ventilation and is not covered, to prevent overheating.
- **Cable Management:** Keep cables organized and avoid sharp bends or excessive tension to prevent damage.

WARRANTY AND SUPPORT

For warranty information, technical support, or further assistance, please refer to the manufacturer's official website or contact their customer service department. Keep your purchase receipt as proof of purchase for warranty claims.