

Manuals+

[Q & A](#) | [Deep Search](#) | [Upload](#)

manuals.plus /

› [GoveeLife](#) /

› [GoveeLife WiFi Water Leak Detector User Manual](#)

GoveeLife H5043+H5058

GoveeLife WiFi Water Leak Detector User Manual

Model: H5043+H5058

1. PRODUCT OVERVIEW

The GoveeLife WiFi Water Leak Detector system is designed to provide comprehensive protection against water damage in your home. This smart system includes a central gateway and multiple highly sensitive sensors that detect water leaks and drips, sending instant alerts to your smartphone via the Govee Home app, email, and an audible alarm. Utilizing advanced LoRa technology, the system offers an extended transmission range, ensuring reliable monitoring across large areas.



Image: The GoveeLife WiFi Water Leak Detector system, including the gateway and multiple sensors, alongside a smartphone showing the monitoring app.

Key Features

- **App & Email Real-time Alerts:** Connect the gateway to Wi-Fi for instant notifications to your phone and email when a water leak occurs, even when you are away from home.
- **Voice Assistant Reminder:** Compatible with Alexa Voice Assistant, allowing for audible alerts and status checks through voice commands.
- **Extremely Long Range:** Powered by LoRa technology, the system offers an industry-leading transmission range of up to 1968 feet (600 meters) in open-air conditions, ideal for basements and large properties.
- **High Sensitivity:** Each water leak sensor is equipped with 2 top sensor probes and 4 bottom sensor probes to accurately detect both leaks and drips. Upon detection, a loud alarm up to 100dB is activated.
- **IP66 Waterproof & Durable:** The sensors feature an IP66 waterproof rating, ensuring long-term use in wet or damp areas. Each sensor battery can last over 5 years under normal usage.

2. WHAT'S IN THE BOX

- 1 x GoveeLife WiFi Smart Gateway (Model H5043)
- 6 x GoveeLife Water Leak Sensors (Model H5058)
- 12 x AAA Batteries (2 per sensor)
- 1 x User Manual

3. SETUP GUIDE

3.1 Initial Setup and App Connection

1. **Download the Govee Home App:** Search for "Govee Home" on the App Store (iOS) or Google Play (Android) and install it on your smartphone.

Connecting to Wi-Fi Gateway & Sensor

*Only Support 2.4G Wi-Fi

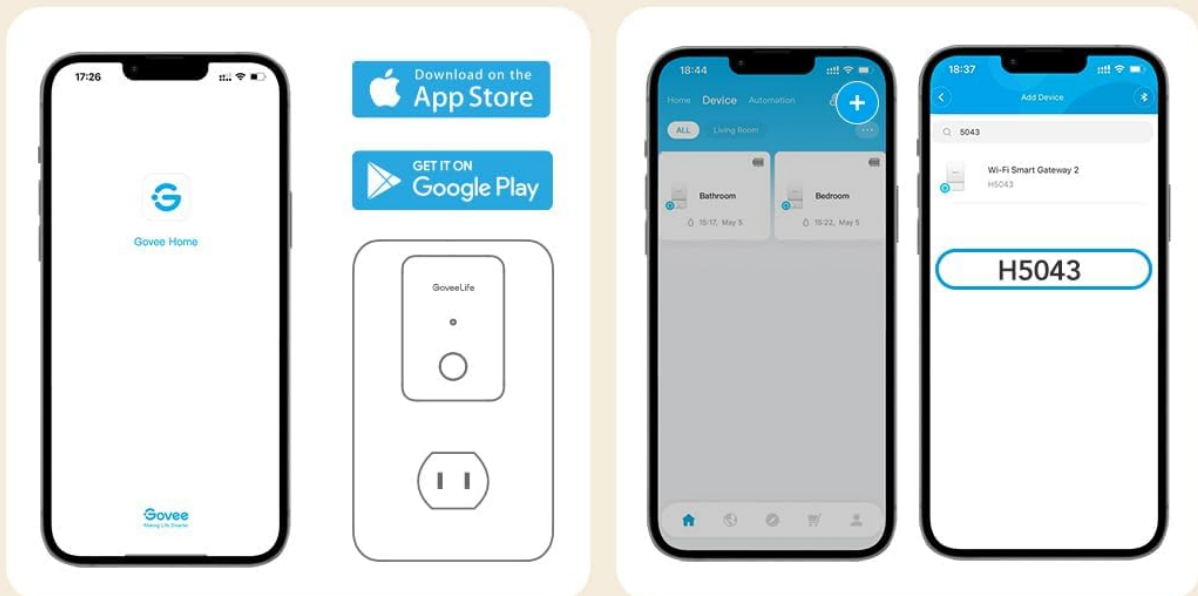

1 Download GoveeHome App and plug in the gateway.

2 Add the gateway model H5043 and connect to Wi-Fi.

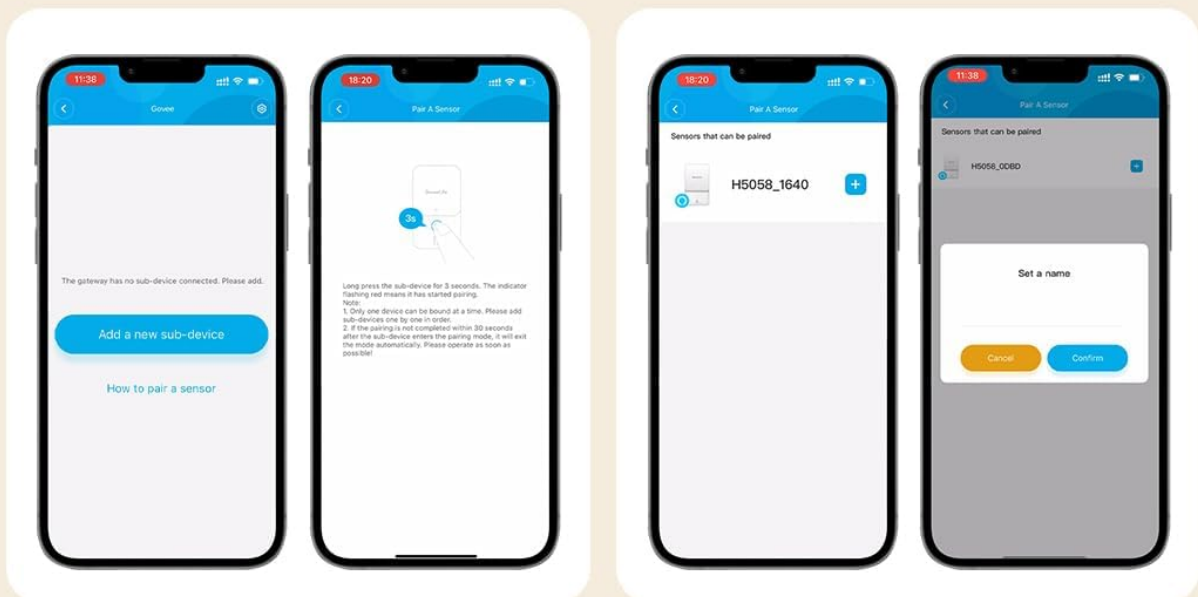

3 Tap "Add a new sub- Device" and Long press 3 seconds to start pairing.

4 Tap the "+" icon and enter a name.

Image: Visual guide for downloading the Govee Home App and plugging in the gateway.

2. **Connect to 2.4GHz Wi-Fi Network:** Ensure your phone is connected to a 2.4GHz Wi-Fi network. 5GHz Wi-Fi networks are not supported for the initial setup of the Water Leak Detector. Power up your Water Leak Detector gateway by plugging it into a power outlet.
3. **Add Gateway to App:** Open the Govee Home App, tap the "+" icon in the top right corner, search for "H5043" (the gateway model), and select it. Follow the in-app instructions to connect the gateway to your Wi-Fi network.

4. **Pair Sensors:** Once the gateway is successfully connected, click "Add a new sub-device" within the app. For each sensor, long-press the pairing button for 3 seconds. The indicator light will flash red, indicating it's in pairing mode.
Note: Only one device can be paired at a time. Please add sub-devices one by one. If pairing is not completed within 30 seconds, the mode will exit automatically. Please operate as soon as possible.
5. **Name Your Sensors:** After successful pairing, you will be prompted to name each sensor (e.g., "Kitchen Sink," "Basement," "Bathroom"). This helps in identifying the exact location of a leak when an alert is received.

3.2 Video Guide: How to Connect H5043 Water Detector to Wi-Fi

Your browser does not support the video tag.

Video: A step-by-step guide on connecting your GoveeLife H5043 Water Detector to your Wi-Fi network using the Govee Home app.

4. OPERATING INSTRUCTIONS

4.1 Placement of Sensors

Place the water leak sensors in areas prone to water leaks or where water damage could occur. Ensure the sensor probes are in direct contact with the surface where water might accumulate.

- Under sinks (kitchen, bathroom)
- Near water heaters
- By washing machines and dishwashers
- In basements or crawl spaces
- Near sump pumps
- Under refrigerators with ice makers

Drip and Leak Alerts

Extra sensitive probes with faster alert times

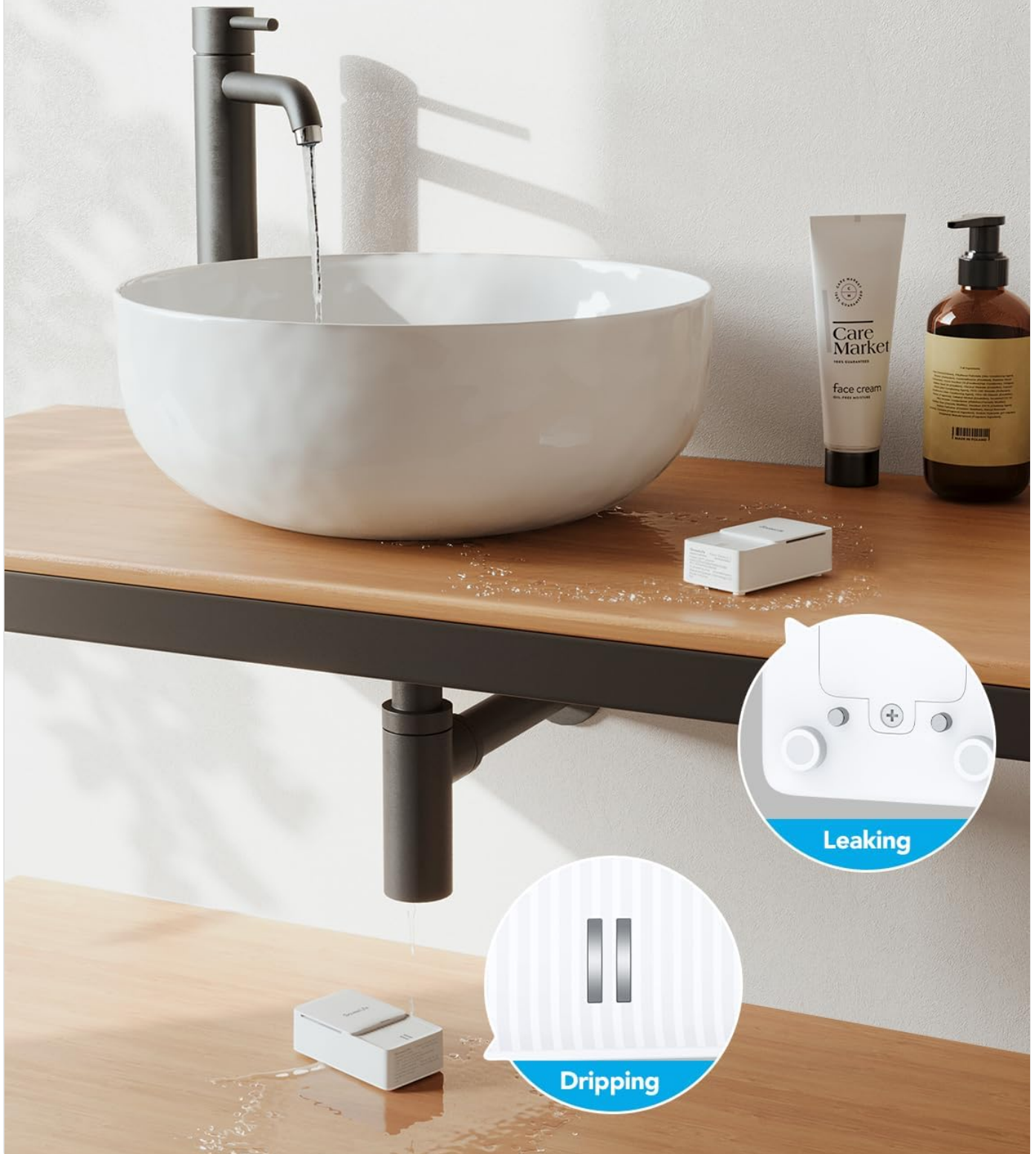

Image: Illustration of the sensor detecting both dripping and leaking water.

4.2 Alerts and Notifications

When water is detected by a sensor, the system will trigger multiple alerts to ensure you are promptly informed:

- **Audible Alarm:** The sensor will emit a loud alarm up to 100dB. The alarm volume can be adjusted or muted via the Govee Home app.

- **App Notifications:** Receive instant push notifications on your smartphone through the Govee Home app, indicating the specific sensor that detected water.
- **Email Alerts:** The system can send email notifications to your registered email address, providing details about the detected leak.
- **Voice Assistant:** If linked with Amazon Alexa or Google Assistant, your voice assistant will announce the water leak, specifying the location if the sensor is named.

Protect Your Home

Monitor for water leaks remotely even while away

*Only Support 2.4G Wi-Fi

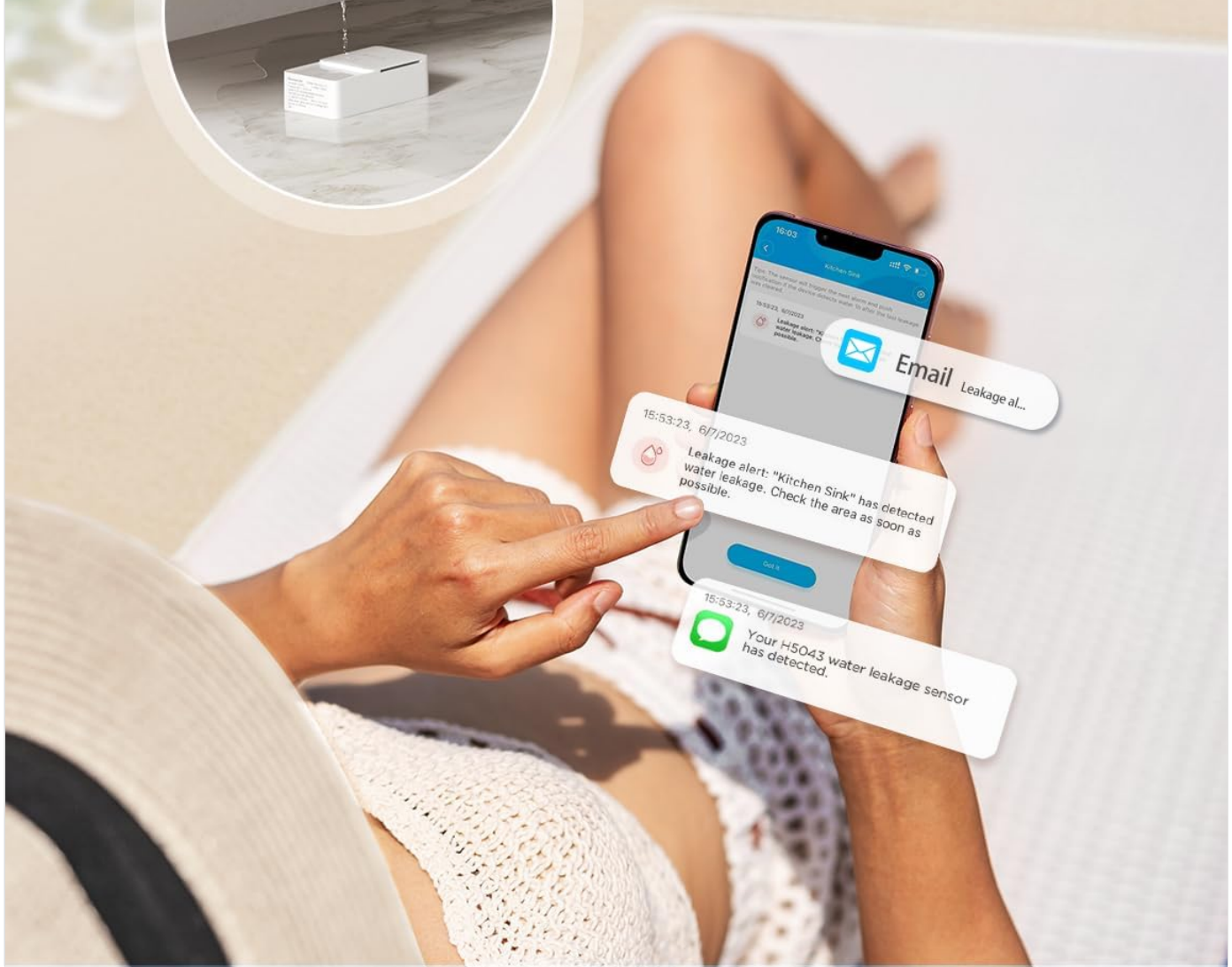

Image: Remote monitoring and alert notifications on a smartphone.

Voice Assistant Reminder

Know right away when water leaks happen

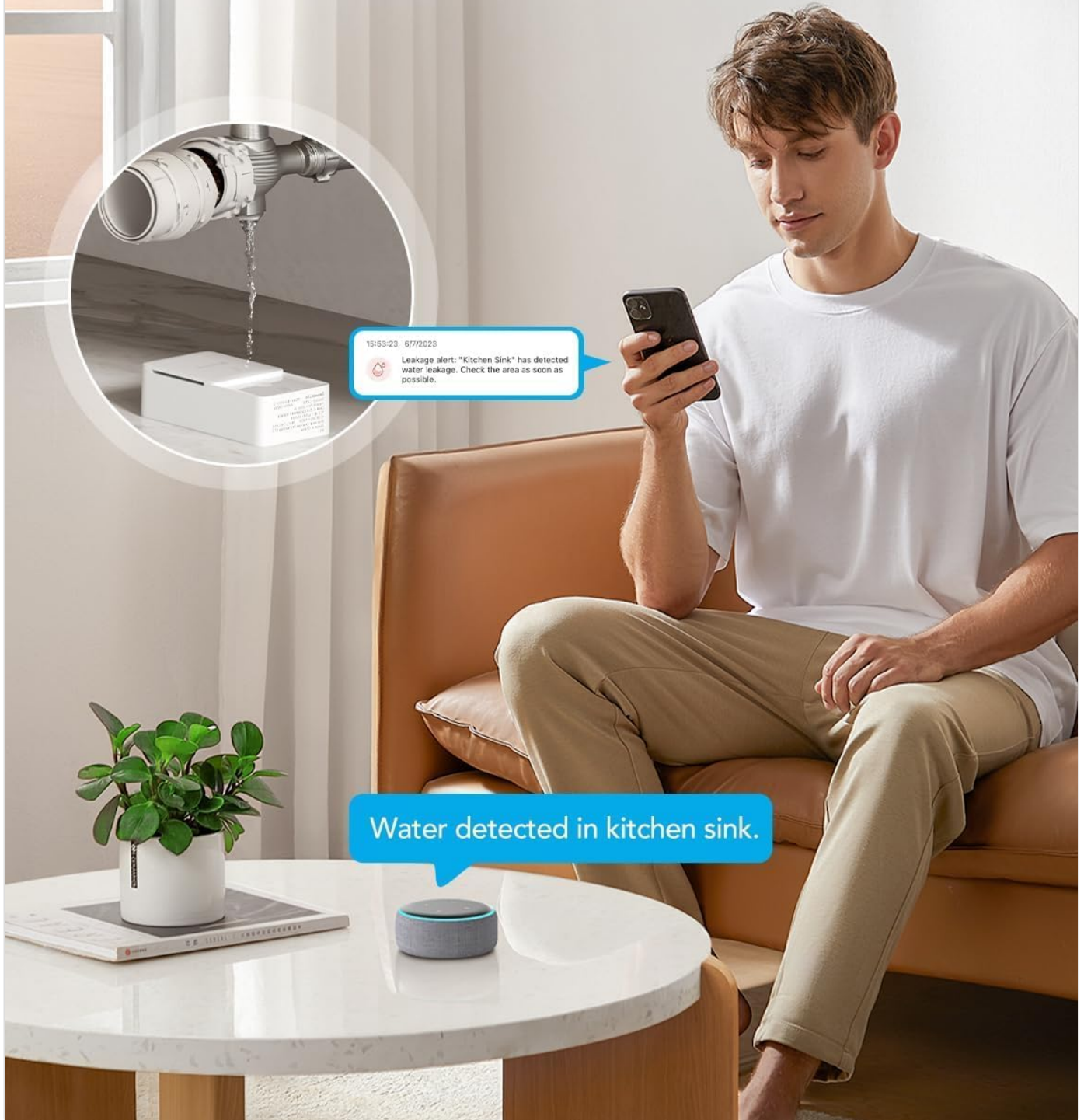

Image: Voice assistant reminder for water leaks.

4.3 LoRa Technology and Range

The GoveeLife Water Leak Detector utilizes LoRa (Long Range) wireless technology, which provides a significantly extended transmission range compared to standard Wi-Fi or Bluetooth. This allows the gateway to communicate with sensors up to 1968 feet (600 meters) away in open-air conditions, ensuring reliable coverage even in large homes or properties with multiple buildings.

Monitor 1968ft Range

Connect with the latest GoveeLife **LoRa** wireless technology

 **GoveeLife LoRa Sensor**
600m/1968ft Range*

Zigbee
150m/492ft Range*

Bluetooth
60m/196ft Range*

 **LoRa Gateway**

*Under open-air and optimal conditions with no repeaters or boosters

Image: LoRa technology range comparison.

4.4 Multiple Sensor Support

One GoveeLife Smart Gateway can support up to 100 individual water leak sensors. This capability allows for comprehensive monitoring of numerous potential leak points throughout your entire property, providing extensive peace of mind.

Suport Connects Up to 100 Sensors

Name each sensor to easily monitor water leaks

1 Smart Gateway

100 Water Sensors



Adjustable Volume Alerts



Image: One gateway supporting up to 100 sensors.

5. MAINTENANCE

5.1 Battery Replacement

Each GoveeLife water leak sensor is powered by 2 AAA batteries. Under normal usage conditions, the battery life can exceed 5 years. The Govee Home app provides real-time battery level monitoring for each sensor, allowing you to replace batteries proactively when they are low to ensure continuous protection.

5.2 Cleaning

The sensors have an IP66 waterproof rating, making them resistant to water and suitable for humid environments. To clean the sensors, gently wipe the exterior and the metal probes with a dry, soft cloth. Do not use abrasive cleaners, solvents, or immerse the entire gateway unit in water.

IP66 Waterproof and Durable

Allows for extended use in humid areas



IP66 Waterproof



2-Year Battery Life



Image: IP66 Waterproof and Durable design.

6. TROUBLESHOOTING

6.1 No Alerts Received

- **Check Wi-Fi Connection:** Ensure the GoveeLife gateway is connected to a stable 2.4GHz Wi-Fi network. Verify the network status in the Govee Home app.
- **App Notifications:** Confirm that push notifications are enabled for the Govee Home app in your smartphone's system settings.
- **Sensor Battery:** Check the battery level of all sensors in the app. Replace batteries if they are low or depleted.
- **Sensor Placement:** Ensure the sensor probes are in direct contact with the surface where water might be detected.

6.2 Sensor Not Pairing

- **Power Cycle:** Try unplugging and replugging the gateway. For sensors, remove and reinsert the AAA batteries.
- **Proximity:** Ensure the sensor is within close proximity to the gateway during the pairing process.
- **One at a Time:** Remember to pair sensors one by one as instructed in the setup guide.
- **2.4GHz Network:** Verify that your smartphone and the gateway are connected to a 2.4GHz Wi-Fi network during the pairing process.

6.3 False Alarms

- **Sensor Cleanliness:** Ensure the sensor probes are clean and free from any residual moisture, dust, or debris when not in use.
- **Placement:** Re-evaluate the sensor's placement. Avoid areas where condensation, minor splashes, or high humidity might trigger a false alarm without an actual leak.

7. SPECIFICATIONS

Feature	Detail
Model Number	H5043+H5058
Power Source	Battery Powered (12 AAA batteries included)
Voltage	1.5 Volts (DC)
Control Method	App
Noise Level	100 dB
Mounting Type	Floor Mount
Maximum Range	1968 Feet (LoRa)
Sensor Technology	LoRa
Material	ABS+PC
Product Dimensions	7.6 x 3.5 x 2.5 inches
Item Weight	1.5 pounds
Compatible Devices	IFTTT, Alexa, Google Assistant

8. WARRANTY AND SUPPORT

For detailed warranty information, technical support, and customer service inquiries, please refer to the official GoveeLife website. You can also find additional resources, FAQs, and contact options directly within the Govee Home App under the "User Guide" section.

An official User Manual (PDF) is also available for download: [Download PDF](#)