



[Manuals.plus](#) /

› [Hamile](#) /

› Hamile Wireless Detachable Keyboard Case User Manual for iPad 10th Generation (10.9-inch 2022) and iPad 11th Generation (11-inch 2025)

Hamile A2696/A2757/A2777

Hamile Wireless Detachable Keyboard Case User Manual

For iPad 10th Generation (10.9-inch 2022) and iPad 11th Generation (11-inch 2025)

INTRODUCTION

Thank you for choosing the Hamile Wireless Detachable Keyboard Case. This manual provides detailed instructions for setting up, operating, and maintaining your new keyboard case. Please read this manual thoroughly before use to ensure optimal performance and longevity of your product.



Figure 1: The Hamile keyboard case with an iPad securely inserted, demonstrating the protective design.

COMPATIBILITY

This keyboard case is compatible with the following iPad models:

- **iPad 11th Generation 11-inch 2025:** Models A3354, A3355, A3356
- **iPad 10th Generation 10.9-inch 2022:** Models A2696, A2757, A2777, A3162

Please verify the model number on the back of your iPad before use.

Compatible With

✓ iPad A16 11th Generation 11inch 2025

Models: A3354/A3355/A3356

✓ iPad 10th Generation 10.9inch 2022

Models: A2696/A2757/A2777/A3162



⚠ Please check the model number starting with "A" on the back of your tablet

Figure 2: Visual guide for identifying compatible iPad models and their corresponding model numbers.

PACKAGE CONTENTS

Ensure all items are present in your package:

- 1 x Hamile Keyboard Case for iPad (A16) 11th/10th Generation
- 1 x Wireless Keyboard
- 1 x Type-C Charging Cable
- 1 x User Manual (this document)

Note: iPad and stylus are not included.

SETUP INSTRUCTIONS

1. Inserting the iPad into the Case

1. Gently align your iPad with the case, ensuring the camera cutout and port openings match.
2. Press the iPad firmly into the flexible TPU interior case until it is securely seated.

2. Charging the Wireless Keyboard

1. Locate the Type-C charging port on the side of the wireless keyboard.
2. Connect the provided Type-C charging cable to the keyboard and a suitable USB power adapter (not included).
3. The charging indicator light will illuminate. A full charge typically takes approximately 2 hours.
4. Once fully charged, the indicator light will change or turn off, indicating the keyboard is ready for extended use (up to 230 hours).

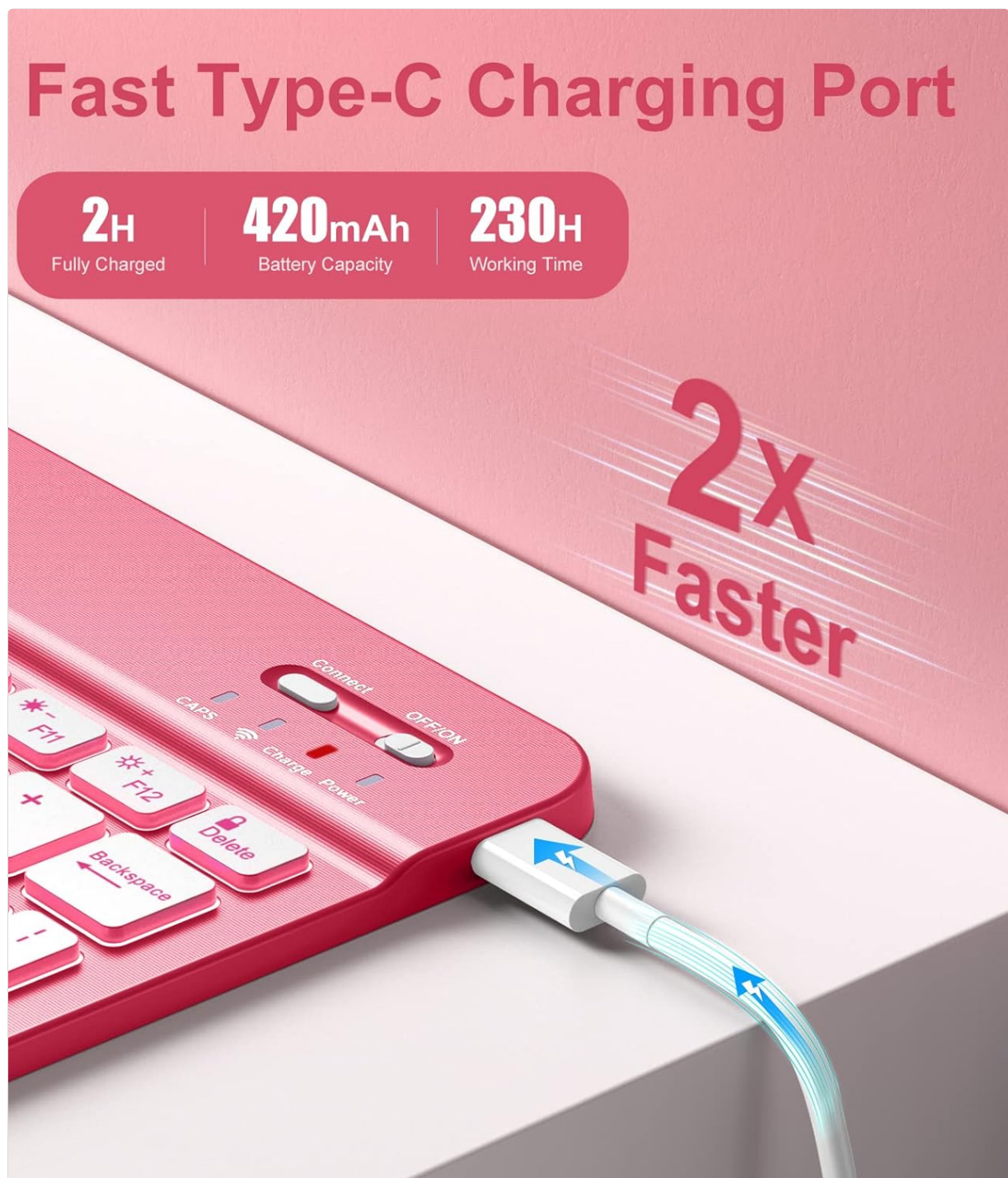

Figure 3: The keyboard's Type-C charging port and indicators for battery status and connection.

3. Pairing the Wireless Keyboard via Bluetooth

1. Turn on the keyboard by sliding the ON/OFF switch to the "ON" position. The Power indicator light will briefly illuminate.
2. Press the "Connect" button on the keyboard. The Bluetooth indicator light will start blinking, indicating it is in pairing mode.
3. On your iPad, go to **Settings > Bluetooth** and ensure Bluetooth is turned on.
4. Your iPad will search for available devices. Select "Bluetooth 3.0 Keyboard" from the list.
5. Once connected, the Bluetooth indicator light on the keyboard will stop blinking.

OPERATING INSTRUCTIONS

1. Detachable Keyboard Functionality

The keyboard is magnetically attached to the case, allowing for easy removal and repositioning. This feature provides flexibility for various usage scenarios.

Magnetically Detachable Keyboard



Figure 4: The keyboard magnetically detaches from the case, offering versatile use.

2. Multiple Viewing Angles

The case features three distinct grooves, allowing you to adjust the iPad to comfortable viewing angles (110°, 120°, 130°) for typing, watching videos, or drawing.

Multiple Viewing Angles

Adjust comfortable position



Figure 5: The case supports multiple viewing angles for enhanced user comfort and versatility.

3. Adjustable 7-Color Backlit Keyboard

The keyboard features laser-etched backlit keys with 7 vibrant color options. Press the **light bulb icon** key to cycle through the colors or turn the backlight off. Press the **sun icon** key to adjust brightness levels.

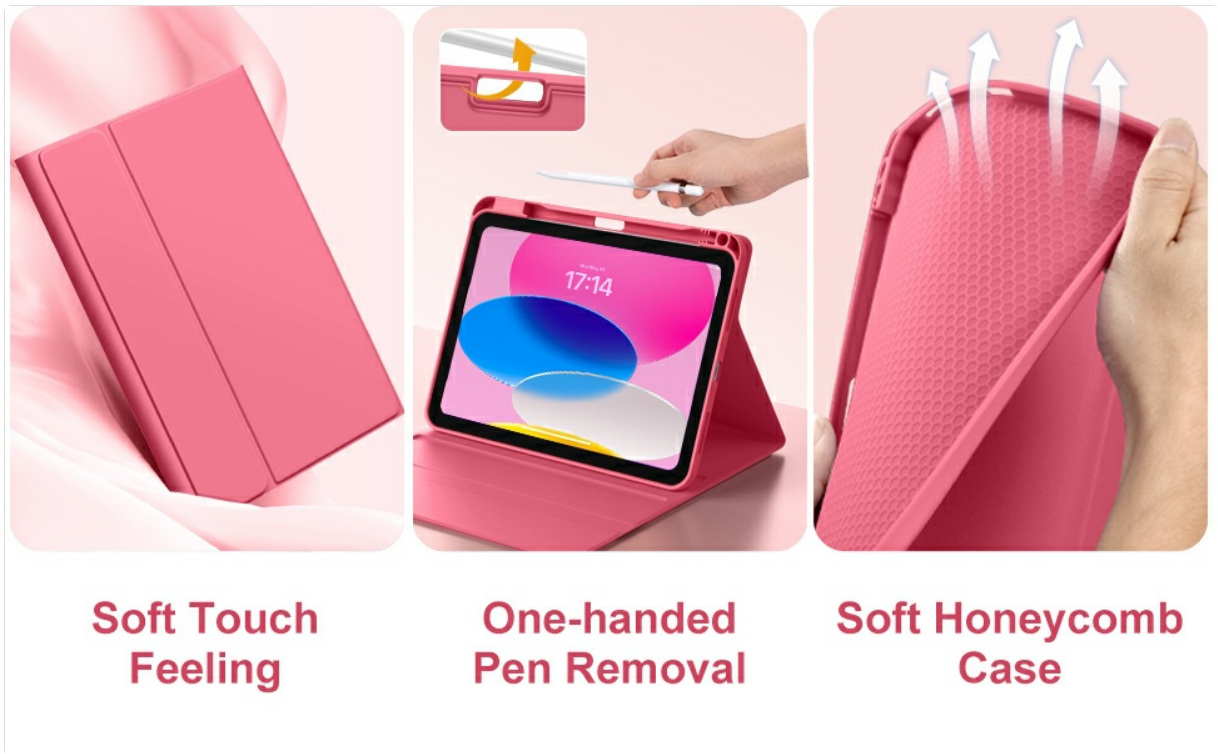

Soft Touch Feeling

One-handed Pen Removal

Soft Honeycomb Case

Figure 6: The keyboard features adjustable backlighting with 7 color options for improved visibility in various lighting conditions.

4. Shortcut Keys and System Compatibility

The keyboard includes useful shortcut keys for iOS, Windows, and Android systems. Use the Fn key in combination with other keys for specific functions:

- **Fn + E:** Match to iOS system
- **Fn + Q:** Match to Android system
- **Fn + W:** Match to Windows system

Refer to the keyboard layout for additional shortcut functions like volume control, media playback, and screen lock.



Figure 7: Detailed keyboard layout highlighting system compatibility and various function keys.

5. Convenient Pencil Holder

The case features a dedicated pencil holder and a pen slot on top, with a cutout in the back for easy stylus removal. This design ensures your stylus is secure and readily accessible.

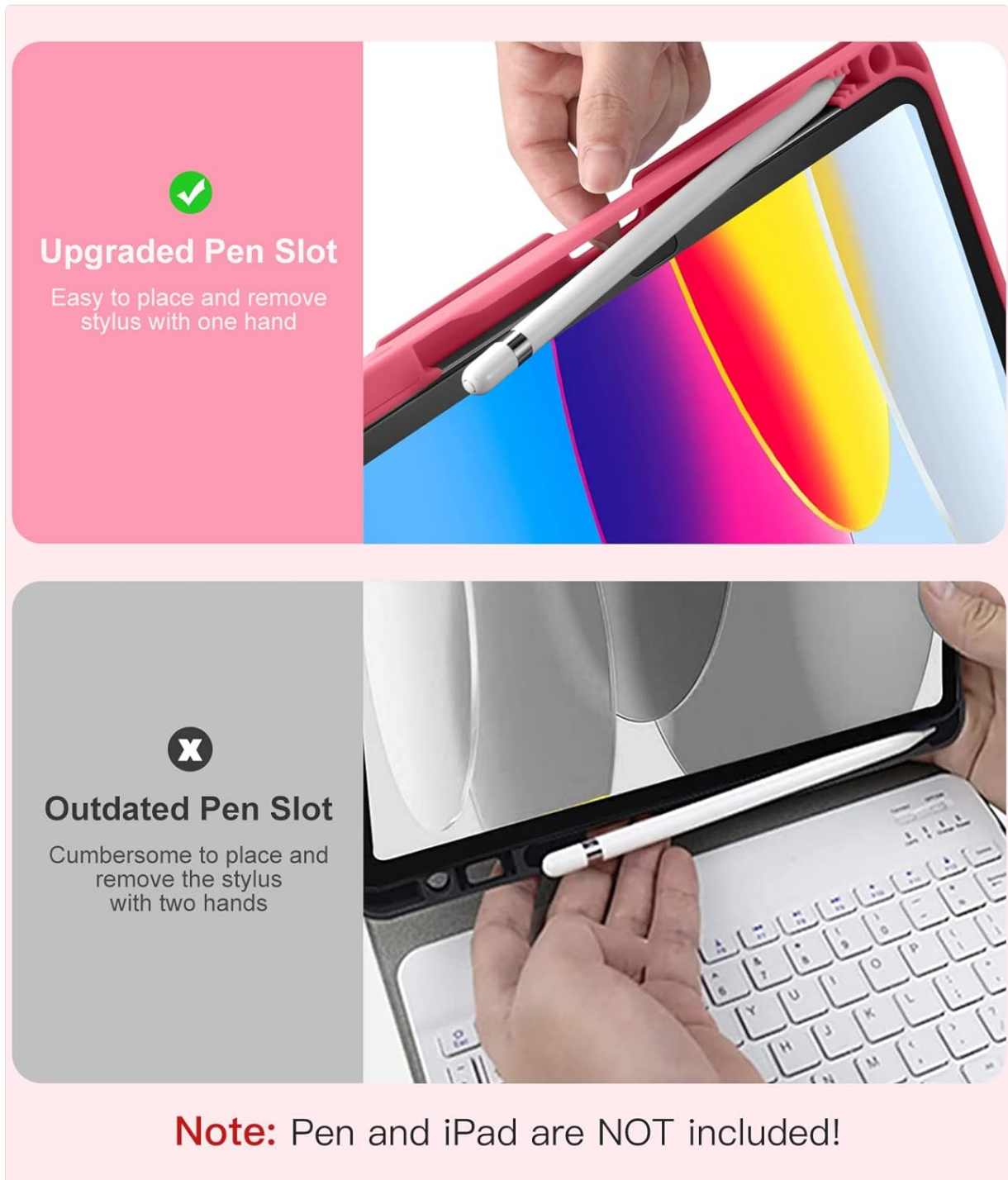

Figure 8: The integrated pencil holder allows for secure storage and easy access to your stylus.

MAINTENANCE

- **Cleaning the Case:** Wipe the PU leather case with a soft, damp cloth. Avoid harsh chemicals or abrasive cleaners.
- **Cleaning the Keyboard:** Use a soft, dry cloth to clean the keyboard keys. For stubborn dirt, a slightly damp cloth can be used, ensuring no liquid enters the key gaps.
- **Storage:** When not in use, keep the keyboard case closed to protect both the iPad and the keyboard

from dust and scratches. Store in a cool, dry place.

- **Battery Care:** To prolong battery life, avoid fully discharging the keyboard battery frequently. Charge it regularly, even if not completely depleted.

TROUBLESHOOTING

Keyboard Not Connecting

- Ensure the keyboard is turned on and fully charged.
- Verify Bluetooth is enabled on your iPad.
- Make sure the keyboard is in pairing mode (Bluetooth indicator blinking). If not, press the "Connect" button.
- Forget the device on your iPad's Bluetooth settings and attempt to re-pair.
- Restart both your iPad and the keyboard.

Keys Not Responding

- Check if the keyboard is connected via Bluetooth.
- Ensure the keyboard battery is not low.
- Try restarting the keyboard and your iPad.

Backlight Not Working

- Press the light bulb icon key to ensure the backlight is not turned off.
- Check the keyboard's battery level. Low battery might disable backlighting.

SPECIFICATIONS

Product Dimensions	10.24 x 8.23 x 1.06 inches
Item Weight	1.61 pounds
Battery Capacity	420mAh Lithium Polymer (included)
Charging Time	Approx. 2 hours
Working Time	Up to 230 hours
Connectivity Technology	Wireless (Bluetooth 3.0)
Keyboard Backlighting	7 Colors RGB
Special Feature	Magnetic Detachable Keyboard, Pencil Holder, Multiple Viewing Angles
Material	High-quality PU Leather (exterior), Flexible TPU (interior)

WARRANTY AND SUPPORT

Hamile is committed to providing quality products and excellent customer service. If you encounter any issues or have questions regarding your keyboard case, please do not hesitate to contact us.

- **Customer Service:** We offer 24/7 friendly customer service. Please contact us via Amazon message for assistance.
- **Returns:** This product is subject to Amazon's return policy, which typically allows for refunds or replacements within a specified period.

Your satisfaction is our priority.