

## Manuals+

[Q & A](#) | [Deep Search](#) | [Upload](#)

manuals.plus /

› [LVWIT](#) /

› [LVWIT E26 Dimmable & Color-Tunable LED Track Spotlights User Manual \(6-Pack\)](#)

## LVWIT E26 Dimmable/Color-Tunable LED Track Spotlights

# LVWIT E26 Dimmable & Color-Tunable LED Track Spotlights User Manual

Model: E26 Dimmable/Color-Tunable LED Track Spotlights (6-Pack)

## 1. INTRODUCTION

---

Thank you for purchasing the LVWIT E26 Dimmable & Color-Tunable LED Track Spotlights. This manual provides essential information for the safe and efficient use of your new lighting system. Please read these instructions carefully before installation and retain them for future reference.

## 2. PRODUCT OVERVIEW

---

### 2.1 Product Specifications

- **Fixture:** E26 base, adjustable range: approx. 90 degrees up/down, approx. 350 degrees rotation.
- **Usable Bulb:** E26 base, up to 150W (maximum weight 200g).
- **LED Bulb:** E26 base, 550 lumens (dimmable), 6W power consumption (equivalent to 40W incandescent).
- **Color Temperature:** 2700K (warm white) to 6500K (daylight) - color tunable.
- **Bulb Size:** Diameter 63mm \* Height 84mm.
- **Certification:** PSE certified for Japanese domestic standards.

### 2.2 Package Contents

- 6 x LVWIT E26 LED Track Spotlights
- 1 x Remote Control (batteries not included)
- 1 x Instruction Manual

# E26 ダクトレール用 照明器具



Figure 1: Components of the LVWIT E26 LED Track Spotlight, showing the fixture, E26 base, and the included LED bulb.

# ハロゲン電球 40形相当

明るさ  
(全光束) **550**ルーメン  
**Lm**

調光  
調色

消費電力  
**6W**

口金サイズ: **E26**

日本国内規格の品質、安全性が  
担保されるPSE認証取得済み、  
安心してご利用頂けます。



外径: 63MM



長さ:  
84mm



Figure 2: Detailed specifications of the included LED bulb, highlighting its energy efficiency and brightness.

### 3. SAFETY INFORMATION

- Ensure the power is OFF before installation or maintenance.
- Do not exceed the maximum wattage (150W) or weight (200g) for the bulb.
- This product is designed for indoor use only.
- Do not disassemble or modify the product.
- Keep out of reach of children.
- Remote control requires batteries (sold separately). Ensure correct polarity when inserting batteries.

### 4. SETUP AND INSTALLATION

#### 4.1 Installing the Track Spotlight

The LVWIT track spotlights are designed for easy, tool-free installation on standard Japanese lighting duct rails. Follow these steps:

1. Ensure the power to the track rail is turned OFF.

2. Align the spotlight's adapter with the track rail.
3. Insert the adapter into the track rail and rotate it until it clicks into place, securing the spotlight.

## 4.2 Removing the Track Spotlight

To remove the spotlight:

1. Ensure the power to the track rail is turned OFF.
2. Rotate the spotlight in the opposite direction of installation to release it from the track rail.
3. Gently pull the spotlight out of the track rail.

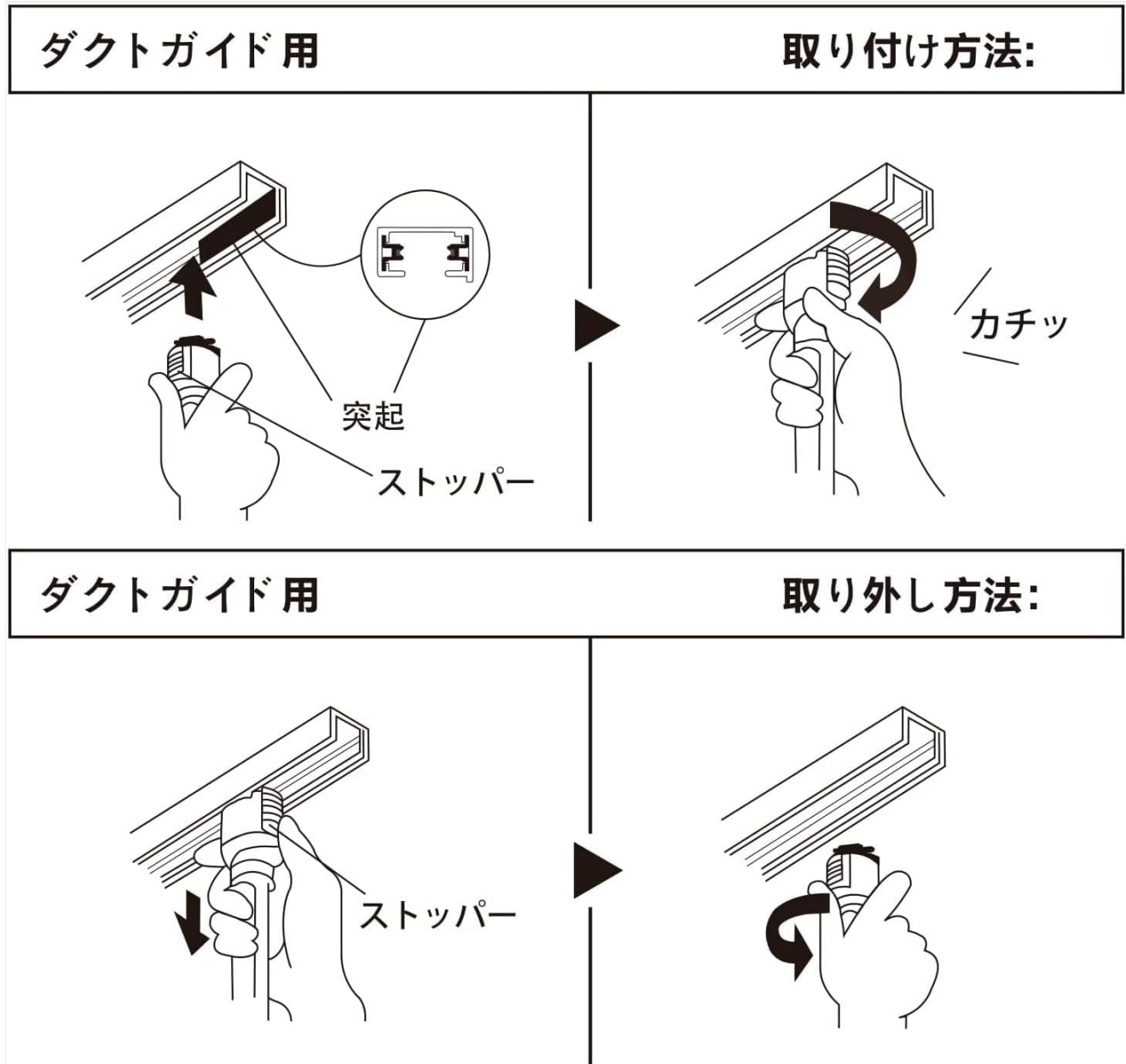

Figure 3: Visual guide for installing and removing the track spotlight on a duct rail.

## 4.3 Adjusting the Spotlight Angle

The spotlight offers flexible angle adjustment to suit your lighting needs:

- **Vertical Adjustment:** Approximately 90 degrees up and down.
- **Horizontal Rotation:** Approximately 350 degrees.

# 照射角度もお好みの、角度に調節出来ます



回転方向に約350度



上下方向に約90度

Figure 4: The spotlight's adjustable head allows for precise light direction.

## 5. OPERATING INSTRUCTIONS

### 5.1 Remote Control Functions

The included 2.4GHz wireless remote control allows for stepless dimming, color tuning, and group management.

- **Stepless Dimming:** Adjust brightness from 10% to 100%.
- **Color Tuning:** Seamlessly switch between warm white (2700K), neutral white, and daylight (6500K).
- **Night Light Mode:** Provides a soft, low-level light.
- **Group Control:** Manage multiple spotlights by assigning them to different groups (1-4).

室内にアンティークな雰囲気醸し出します。

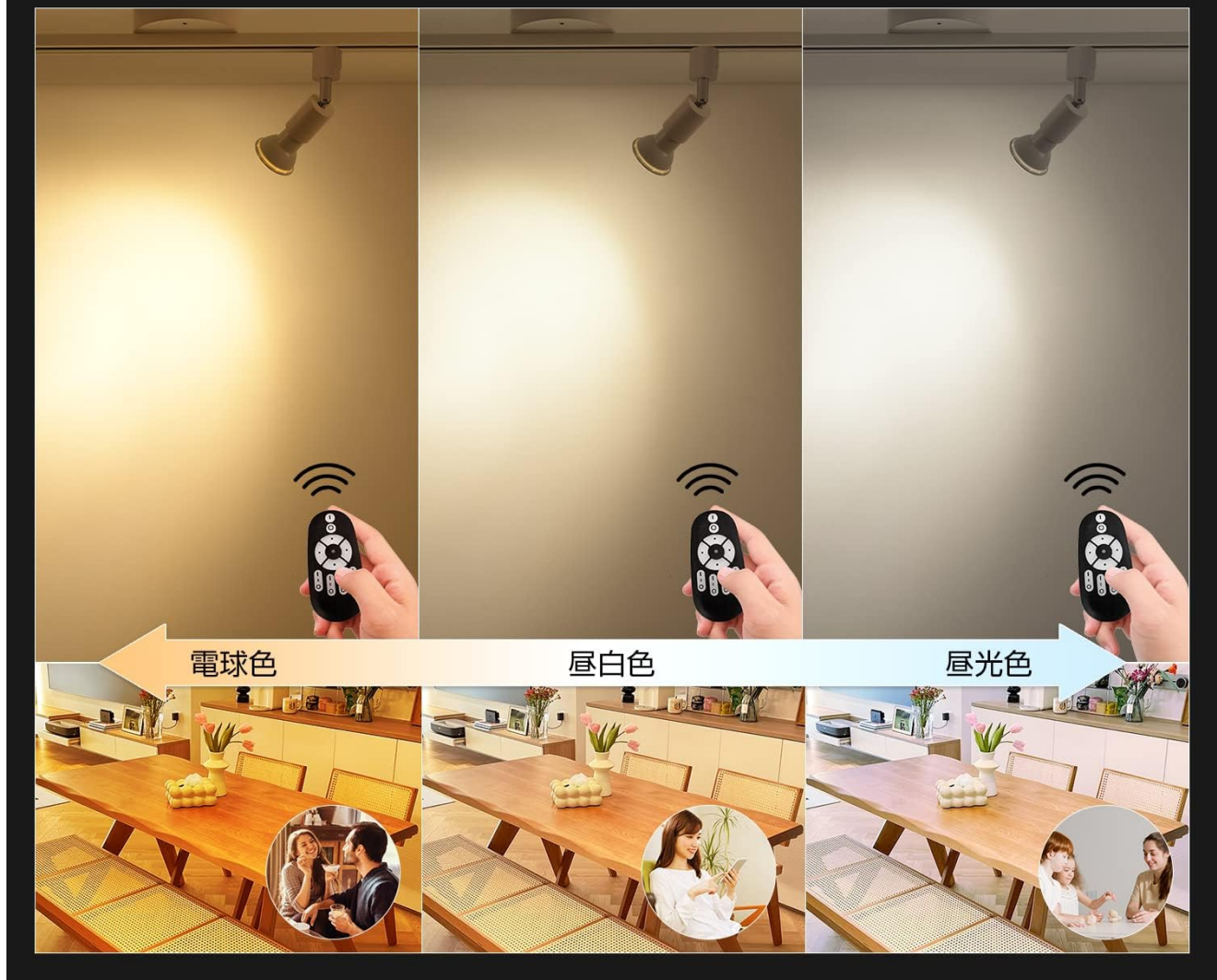

Figure 5: The remote control enables easy adjustment of color temperature to create different ambiances.

# 「無段階調光」

明るさは10% から100 %の間で調節可能、部屋に個性的な雰囲気を作らせます。

100% ← → 10%



# 「調色機能付き」

温かみのある電球色、清々しい昼白色、その中間の白色にも調整でき、お好みに合わせて思いのままに灯りをコントロールできます。

電球色 ← → 昼白色



Figure 6: Adjust brightness from 10% to 100% and fine-tune the color temperature with the remote.

## 5.2 Wall Switch Operation (Without Remote)

If the remote control is not used, the wall switch can cycle through four light states:

1. **1st ON:** Cool White
2. **2nd ON:** Warm White
3. **3rd ON:** Daylight
4. **4th ON:** Night Light
5. **5th ON:** Bulb OFF

## 6. PAIRING AND UNPAIRING INSTRUCTIONS

### 6.1 Pairing Procedure

To pair a bulb with the remote control:

1. Install the bulb and turn on the power.
2. Within 3 seconds of turning on the power, long-press the corresponding 'Group Switch - ON' button on the remote.
3. The bulb will flash 3 times to indicate successful pairing.

**Note:** If the 3-second window is missed, the pairing will be invalid. Wait for more than 10 seconds after restarting the bulb before attempting to pair again.

**For multiple bulbs:** It is recommended to group bulbs into up to 4 groups. Install bulbs sequentially and long-press the corresponding '1', '2', '3', or '4' 'Group Switch - ON' buttons to complete pairing for each group.

### How to check if a bulb is paired:

After attempting to pair, press the 'ALL OFF' button on the remote. If the bulb turns off, it is successfully paired with the remote.

## 6.2 Unpairing Procedure

To unpair a bulb from the remote control:

1. First, turn off the bulb's power for more than 10 seconds.
2. Turn the power back on.
3. Press the 'Group Switch - ON' button corresponding to that bulb 5 times consecutively.
4. Wait for the bulb to flash 6 times to confirm unpairing.

**For multiple bulbs:** If you need to unpair specific bulbs while keeping others paired, first remove the bulbs that do not need unpairing. Then, perform the unpairing procedure for the desired bulb. After unpairing, reinstall the previously removed bulbs; they will retain their original group settings.

### How to check if a bulb is unpaired:

After attempting to unpair, press the 'ALL OFF' button on the remote. If the bulb does not turn off, it is successfully unpaired from the remote.



Figure 7: Pairing instructions for the LED bulbs with the remote control.



Figure 8: Unpairing instructions for the LED bulbs from the remote control.

## 7. MAINTENANCE

- Always turn off the power before cleaning.
- Wipe the spotlight and bulb with a soft, dry cloth. Do not use abrasive cleaners or solvents.
- Regularly check for any loose connections or damage.

## 8. TROUBLESHOOTING

Problem	Possible Cause	Solution
Light does not turn on.	No power to the track rail; Bulb not properly installed; Remote control batteries are dead.	Check power supply; Reinstall bulb securely; Replace remote control batteries.
Remote control not working.	Bulb not paired; Remote control batteries are dead; Obstruction between remote and bulb.	Perform pairing procedure; Replace remote control batteries; Ensure clear line of sight.
Light color/brightness changes unexpectedly.	Interference; Bulb malfunction.	Try unpairing and re-pairing the bulb; Contact customer support if issue persists.

## 9. VIDEO DEMONSTRATION

Your browser does not support the video tag.

Video 1: This short video demonstrates the dimming and color-tuning capabilities of the LVWIT LED Track Spotlights. Observe how the light transitions between different brightness levels and color temperatures (warm white, neutral white, daylight).

## 10. WARRANTY AND SUPPORT

This LVWIT product comes with a **3-year warranty** from the date of purchase. If you encounter any issues or have questions regarding the product, please do not hesitate to contact our customer support. We are committed to providing prompt and helpful assistance.

For support, please refer to the contact information provided on your purchase receipt or the LVWIT official website.

