

Manuals+

[Q & A](#) | [Deep Search](#) | [Upload](#)

manuals.plus /

› [MEDEHOO](#) /

› [MEDEHOO Large Chicken Coop Instruction Manual - Model B0C338F3QB](#)

MEDEHOO B0C338F3QB

MEDEHOO Large Chicken Coop Instruction Manual

Model: B0C338F3QB

Brand: MEDEHOO

1. INTRODUCTION

This manual provides detailed instructions for the assembly, operation, and maintenance of your MEDEHOO Large Chicken Coop. Please read this manual thoroughly before assembly and use to ensure proper function and safety.

The MEDEHOO Large Chicken Coop is designed to provide a spacious and secure habitat for chickens, rabbits, ducks, and other small animals. It features a large living area, nesting boxes, and multiple access points for ease of use and cleaning.

2. SAFETY INFORMATION

- Always assemble the coop on a flat, stable surface.
- Ensure all screws and fasteners are securely tightened during assembly. Periodically check for loose connections.
- Keep small parts away from children and pets during assembly.
- Wear appropriate safety gear, such as gloves, during assembly to prevent injury.
- Do not overload the coop with more animals than its recommended capacity (8-10 adult chickens).
- Position the coop in a sheltered area to protect animals from extreme weather conditions.
- Regularly inspect the coop for any damage or wear that could compromise its structural integrity or animal safety.

3. PRODUCT FEATURES

- **Extra Large Living Space:** Approximately 33 sq ft of space, suitable for 8-10 adult chickens.
- **Easy Cleaning Design:** Features 7 access areas and a removable, leakproof pull-out tray for convenient waste removal.
- **Dual Nesting Boxes:** Two large nesting boxes, divided into four compartments, designed for clean egg collection.
- **Comfortable Roosting Bars:** Round-edged perches conform to chickens' natural standing posture.
- **Weather Protection:** Waterproof PVC cover over nesting boxes and UV-resistant roof panels prevent leaks and offer protection from elements.

- **Enhanced Security:** Custom locks on egg nests and the pull-out tray deter predators.
- **Automatic Door Compatibility:** Two sliding doors support the attachment of an automatic door opener (opener not included).
- **Durable Construction:** Frame made of FSC-Certified wood with upgraded metal corner braces for increased stability.

4. SETUP AND ASSEMBLY

Assembly requires two adults and basic tools (not included). Follow the included graphical instructions for step-by-step guidance. Ensure all components are present before beginning assembly.



Figure 4.1: Fully assembled MEDEHOO Large Chicken Coop, showcasing its overall structure and integrated run area.



Fearless of Bad Weather

The full area of the roof is covered with asphalt and newly upgraded PVC waterproof curtains to protect the nesting boxes from the wind and rain.

Figure 4.2: Illustration of the new upgraded metal corner braces, which enhance the structural integrity and stability of the coop.

4.1 Component Identification

Before starting, identify all parts using the provided parts list in your packaging. Verify that all pieces are accounted for and undamaged.

4.2 Assembly Steps Overview

1. Assemble the main coop structure, ensuring all panels are correctly oriented.
2. Attach the nesting boxes to the main coop.
3. Install the roof panels, ensuring the waterproof PVC covers are correctly positioned over the nesting boxes.
4. Assemble the outdoor run section and securely attach it to the main coop.
5. Insert the removable leakproof tray into its designated slot.
6. Install all access doors and ensure their locking mechanisms function correctly.
7. Place the round-edged roosting bars inside the coop.

5. OPERATING INSTRUCTIONS

5.1 Animal Placement

Once assembled, introduce your chickens or other small animals to the coop. Ensure they have access to food, water, and adequate ventilation.

5.2 Nesting Box Usage

LARGE NESTING BOXES & PERCH DESIGN



The nesting box keeps eggs clean & easy collection.

Design with six perches for chickens to roost.

Figure 5.1: Close-up view of the two large nesting boxes, each divided into two compartments, designed for easy egg collection. Also visible are the round-edged roosting bars.

The two large nesting boxes are designed for egg laying. Access them by lifting the hinged roofs for easy and clean egg collection. Ensure the locks are engaged after collection to prevent predator access.

5.3 Access Doors

EASY FOR CLEANING

7 access areas and removable leakproof tray are easy cleaning for chicken poop and urine.

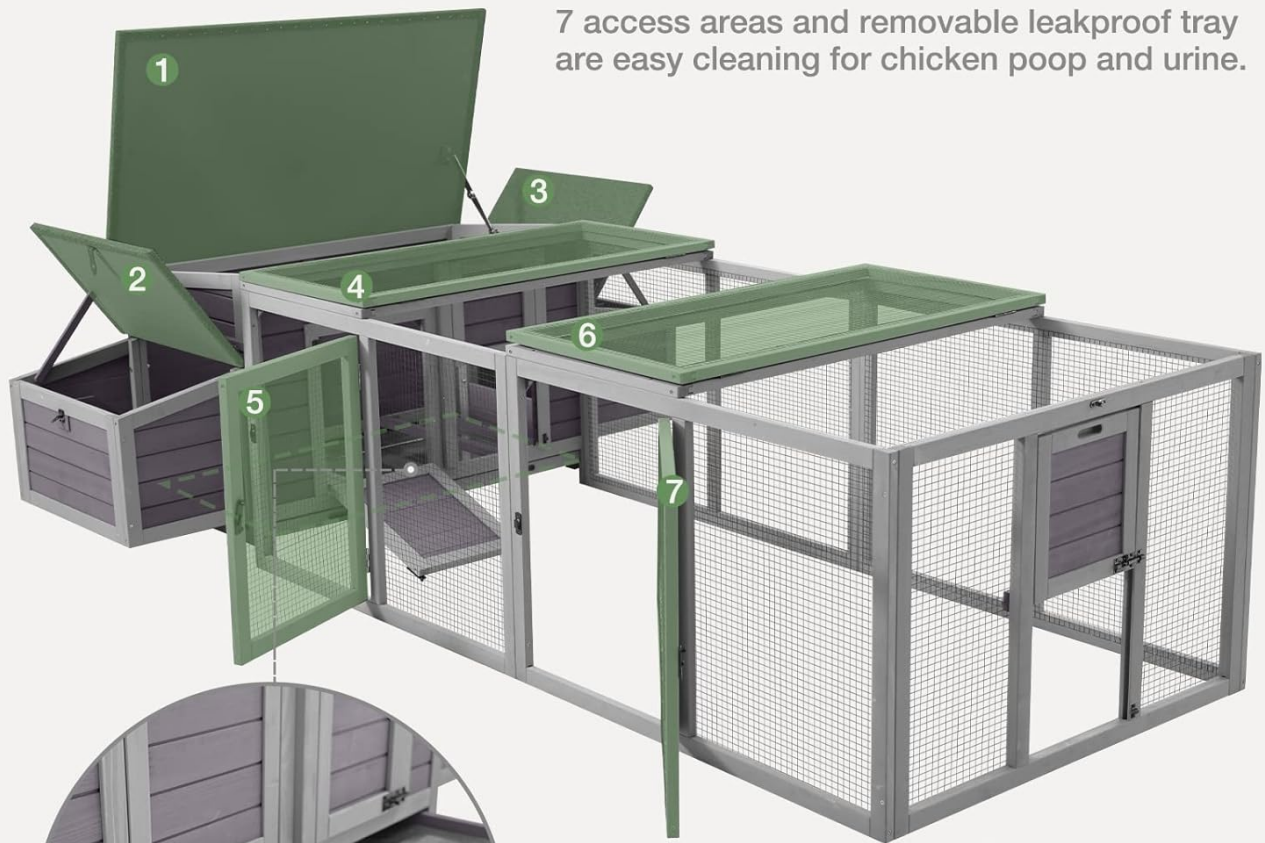

Deep Leakproof Tray



Figure 5.2: Diagram highlighting the 7 access areas on the chicken coop, including hinged roofs and doors, facilitating cleaning and animal access. The removable leakproof tray is also shown.

The coop features 7 access points, including hinged roofs and doors, for convenient interaction with your animals and for cleaning. Always secure these access points when not in use to protect your animals.

5.4 Automatic Door Opener (Optional)



Figure 5.3: Detail of the two sliding doors within the coop and run, designed for compatibility with an automatic door opener (not included).

The two sliding doors are compatible with most automatic door openers. Refer to the automatic door opener's instructions for installation. Ensure the doors operate smoothly after installation.

6. MAINTENANCE

6.1 Cleaning

Regular cleaning is essential for animal health. Utilize the removable leakproof tray (refer to Figure 5.2) for easy removal of droppings. The multiple access points facilitate thorough cleaning of all areas within the coop and run. Use animal-safe cleaning solutions.

6.2 Material Care

DURABLE MATERIAL

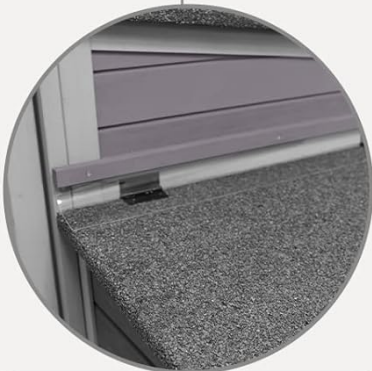

PVC Strip No-Leak Design



Weatherproof UV Panel



Durable Spring Latch

Figure 6.1: Close-up details of the coop's durable features, including the PVC strip for no-leak design, weatherproof UV panel, and a durable spring latch.

The coop is constructed from FSC-Certified wood and features UV-resistant roof panels and waterproof PVC covers. To prolong the life of the coop, periodically inspect the wood for signs of weathering or damage. Apply a non-toxic, animal-safe wood sealant if necessary. Ensure all latches and hinges are functioning correctly.

7. TROUBLESHOOTING

- **Loose Components:** If any part feels unstable, re-check all screws and fasteners in that area and tighten them securely.
- **Difficulty with Tray Removal:** Ensure the tray is free of debris and not obstructed. Clean the runners if necessary.
- **Door Malfunction:** Check hinges and sliding tracks for obstructions or damage. Lubricate if needed with an animal-safe lubricant.
- **Water Leakage:** Inspect roof panels and PVC covers for proper seating and damage. Ensure all seals are intact.

8. SPECIFICATIONS

EXTRA LARGE ACTIVITY SPACE

Capacity: 8-10 adult chickens.

Also suitable for chickens, rabbits, ducks and other small animals.

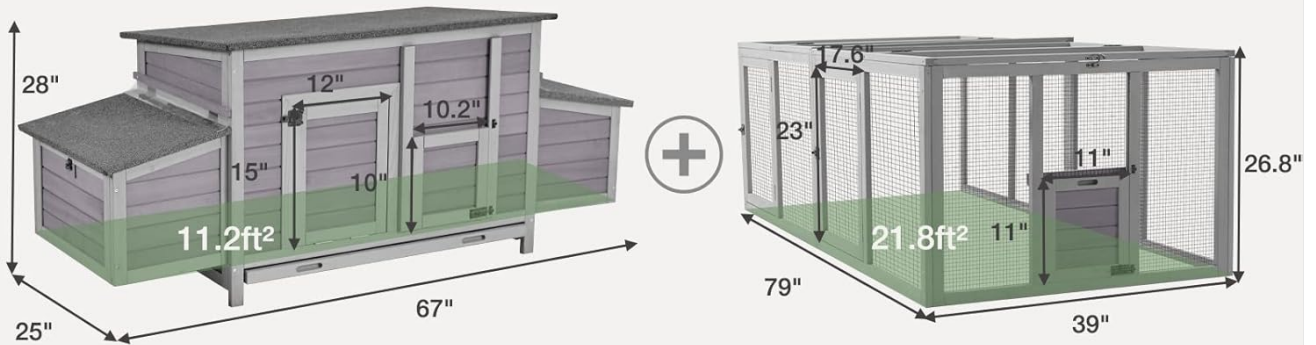

Figure 8.1: Detailed dimensions of the MEDEHOO Large Chicken Coop, including the main house and integrated run.

Feature	Detail
Model	B0C338F3QB
Brand	MEDEHOO
Dimensions (L x W x H)	103 x 67 x 28 inches (261.6 cm x 170.2 cm x 71.1 cm)
Material	FSC-Certified Wood, Polyvinyl Chloride (PVC)
Color	Grey
Breed Recommendation	Large Breeds (suitable for 8-10 adult chickens)
Special Features	Lockable, Waterproof, Removable Tray, Two Nesting Boxes, Round Edge Roosting Bars, Automatic Door Opener Compatible

Included Components	Nesting Box, Removable Tray
Specific Uses	Outdoor Poultry Habitat

9. WARRANTY AND SUPPORT

For warranty information, replacement parts, or technical support, please contact MEDEHOO customer service. Refer to your purchase documentation for specific contact details or visit the official MEDEHOO website.

Please retain your proof of purchase for any warranty claims.

