

LUXRITE LR23415

LUXRITE 2 Inch LED Recessed Lighting with Junction Box

INSTRUCTION MANUAL - MODEL: LR23415

1. Introduction

Welcome to your new LUXRITE 2-inch LED recessed lighting fixture. This manual provides detailed instructions for the safe installation, operation, and maintenance of your lighting product. Please read these instructions thoroughly before installation and retain them for future reference.



The LUXRITE 2-inch LED recessed light fixture, shown with its integrated junction box and white trim.

2. Important Safety Information

To reduce the risk of fire, electric shock, or injury to persons, please observe the following safety precautions:

- Always turn off the power supply at the circuit breaker before beginning installation or performing any maintenance.
- Consult a qualified electrician if you are unsure about the installation process.
- This product is suitable for wet locations and is IC rated, meaning it can be in direct contact with insulation.
- Ensure all electrical connections are made in accordance with local codes and ordinances.

- Do not alter or modify the fixture in any way.
- Verify that the supply voltage is 120V AC.

3. Package Contents

Carefully unpack your product and ensure all items are present and undamaged:

- LUXRITE 2 Inch LED Recessed Light Fixture
- Integrated Junction Box
- Interchangeable Trim (White, included)

4. Specifications

Model Number	LR23415
Wattage	15W
Voltage	120V
Brightness	1000 Lumens
Color Temperature	2700K, 3000K, 3500K, 4000K, 5000K Selectable
Lifetime	50,000 hours
Beam Angle	38°
Certifications	ETL Listed, Wet Location Rated, IC Rated
Product Dimensions	3.13"L x 3.13"W x 4.96"H
Cutout Size	2.88"

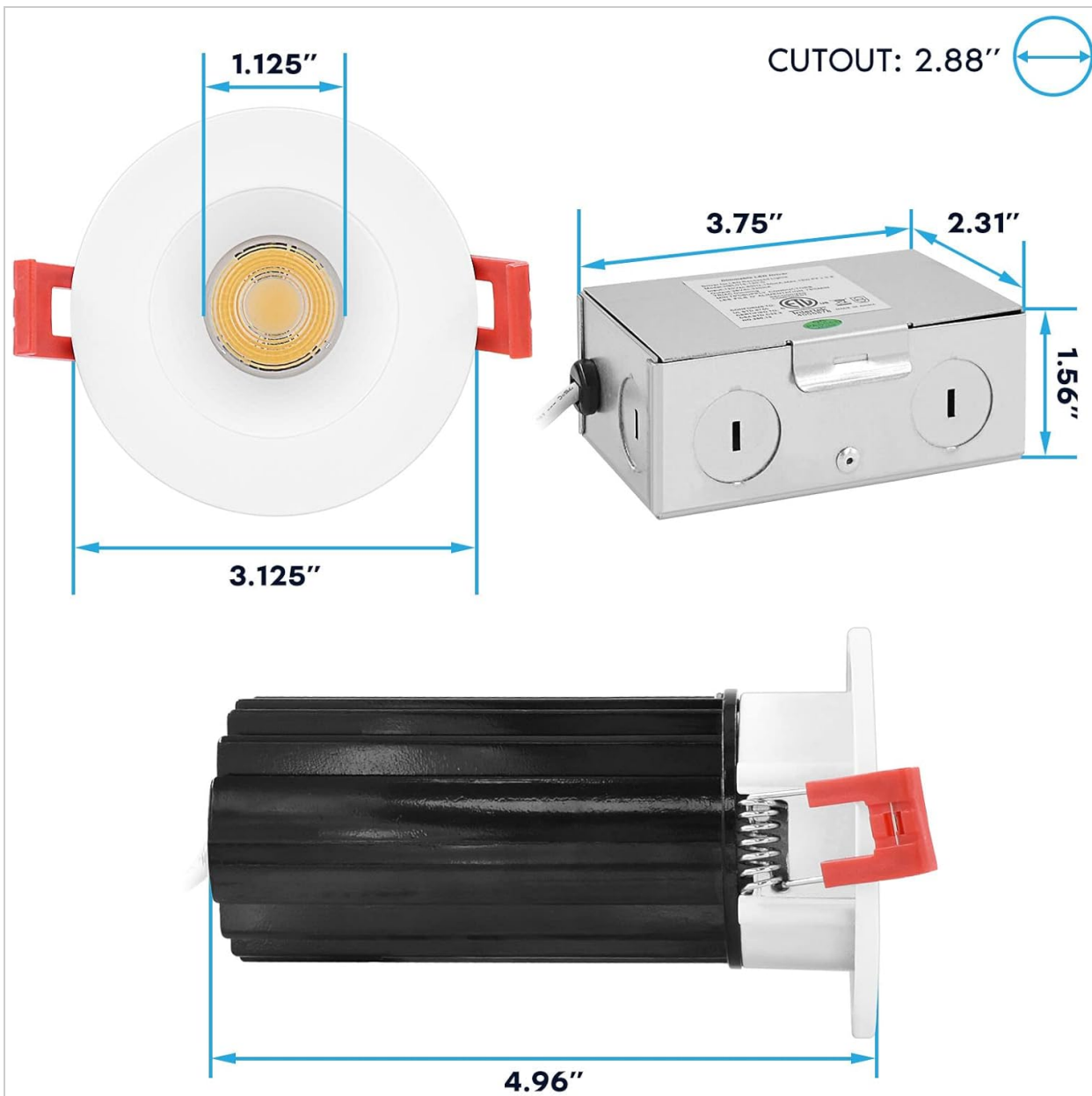

Technical drawing displaying the dimensions of the 2-inch LED recessed light fixture and its accompanying junction box, including the required 2.88-inch cutout size.

5. Setup and Installation

5.1 Pre-Installation

- Ensure power is OFF at the circuit breaker.
- Gather necessary tools: measuring tape, drywall saw, wire strippers, screwdriver.

5.2 Installation Steps

1. **Cut Hole:** Using a 2.88-inch hole saw or drywall saw, cut a circular opening in the desired ceiling location. Refer to the dimensions diagram for accuracy.
2. **Attach Trim:** If using an alternative trim (not the pre-installed white trim), align the desired interchangeable trim with the fixture and twist to securely lock it into place.
3. **Wiring Connections:** Open the integrated junction box. Connect the household electrical wires to the corresponding wires in the junction box (black to black, white to white, ground to ground) using wire nuts. Ensure all connections are secure.

4. **Insert Junction Box:** Place the junction box into the ceiling opening.
5. **Insert Fixture:** Squeeze the spring-loaded clips on the sides of the recessed light fixture and insert the fixture into the ceiling opening. Release the clips to secure the fixture flush against the ceiling.

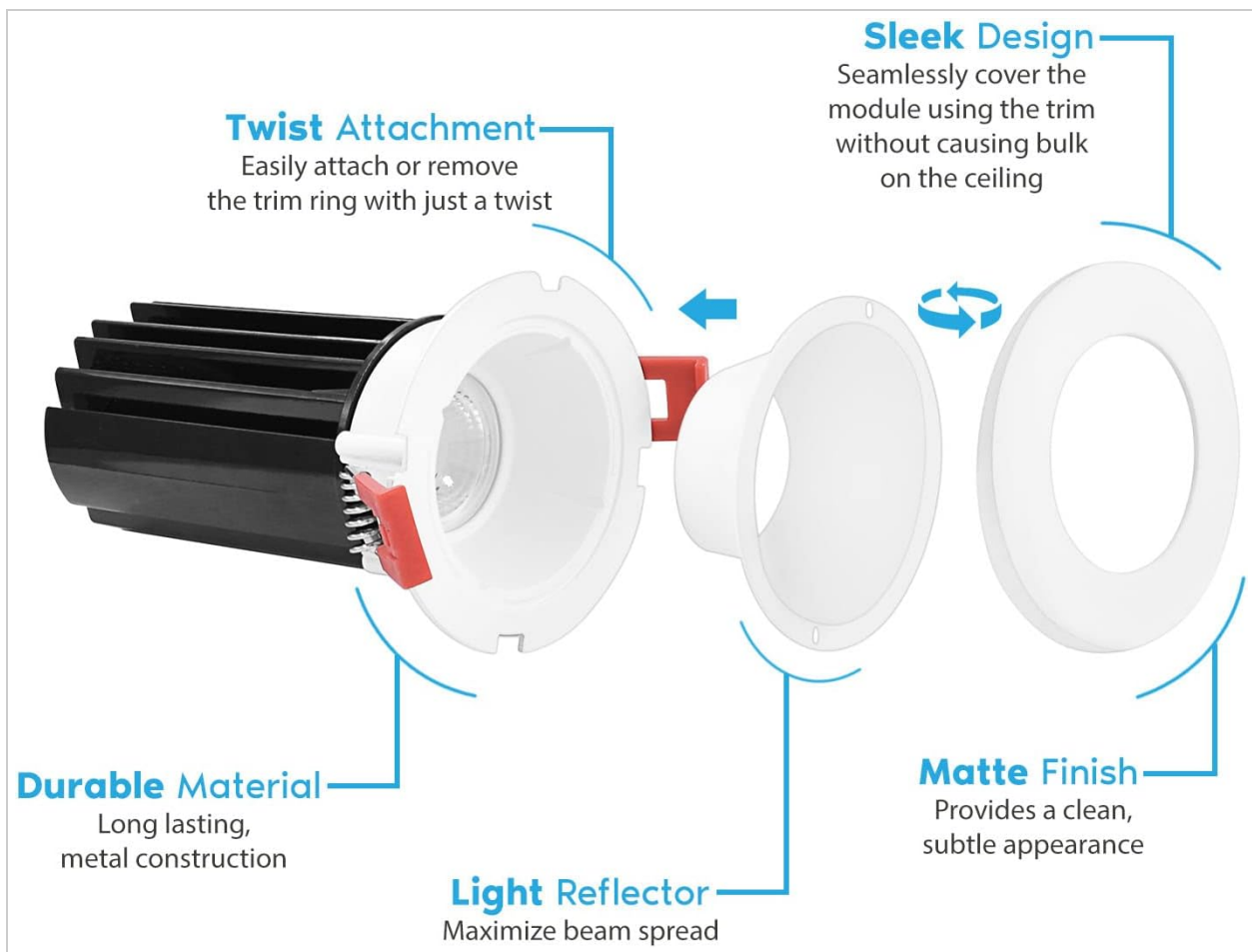

An exploded view showing the light fixture, twist-lock interchangeable trim, and key design elements like durable material, light reflector, sleek design, and matte finish.

INTERCHANGEABLE REFLECTOR & TRIM OPTIONS

REFLECTOR OPTIONS



ROUND TRIM OPTIONS



SQUARE TRIM OPTIONS



TRIM OPTIONS



A display of various reflector and trim options available for the LUXRITE recessed light, including different finishes and shapes like round, square, slot aperture, wall washer, pin hole, and waterproof trims.

6. Operating Instructions

6.1 Color Temperature Selection

Your LUXRITE recessed light features a selectable color temperature switch located on the junction box. Before final installation into the ceiling, or by carefully accessing the junction box, you can choose from five color temperature options:

- **2700K:** Warm White
- **3000K:** Soft White
- **3500K:** Natural White
- **4000K:** Cool White
- **5000K:** Bright White

Slide the switch to your desired color temperature setting. The selected setting will apply to the fixture once power is restored.



An illustration demonstrating the five selectable color temperatures (2700K, 3000K, 3500K, 4000K, 5000K) and the switch used to select them.

6.2 Dimming Functionality

This fixture is dimmable from 100% down to 10% output. For optimal performance, use with compatible LED dimmers. Refer to the list of compatible dimmers below.

6.3 Compatible Dimmers

The following dimmer brands and models are compatible with your LUXRITE recessed light:

LUTRON

AYCL-153P

DV-600PR

DVCL-153P

MACL-153MH

MRF2-6CL

D-600P

NTELV-300P

S-600P

CT-600P

CTCL-153P

TG-600P

TGCL-153P

LEVITON

6633

6674

6602

IPL06

LEGRAND

ADTP703TU

H703PTW

COOPER

9540

DAL06P



COMPATIBLE DIMMERS

LUTRON

AYCL-153P
DV-600PR
DVCL-153P
MACL-153MH
MRF2-6CL
D-600P
NTELV-300P
S-600P
CT-600P
CTCL-153P
TG-600P
TGCL-153P

LEVITON

6633
6674
6602
IPL06

LEGRAND

ADTP703TU
H703PTW

COOPER

9540
DAL06P

A visual list of compatible dimmer models from brands like Lutron, Leviton, Legrand, and Cooper, ensuring proper dimming functionality.

7. Maintenance

The LUXRITE LED recessed light fixture requires minimal maintenance. To clean the fixture:

- Ensure power is turned off at the circuit breaker before cleaning.
- Use a soft, dry, or slightly damp cloth to wipe the surface of the fixture.
- Do not use abrasive cleaners or solvents, as these may damage the finish or electrical components.

8. Troubleshooting

If you encounter issues with your LUXRITE recessed light, refer to the following common problems and solutions:

- **Light does not turn on:**
 - Check if the power supply at the circuit breaker is on.
 - Verify all wiring connections are secure and correct.
 - Ensure the light switch is in the ON position.
- **Light flickers:**
 - Confirm that the dimmer switch (if installed) is compatible with LED lighting.
 - Check for loose wiring connections.
- **Incorrect color temperature:**
 - Access the junction box and verify the 5-CCT switch is set to your desired color temperature.

If these steps do not resolve the issue, please contact customer support.



9. Warranty and Support

This LUXRITE LED recessed light fixture comes with a **3-year manufacturer's warranty** from the date of purchase. This warranty covers defects in materials and workmanship under normal use.

For warranty claims, technical assistance, or any questions regarding your product, please refer to the contact information provided with your purchase documentation or visit the official LUXRITE website.

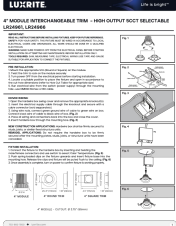
Related Documents - LR23415

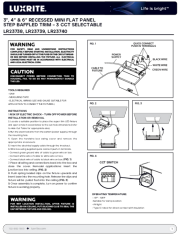
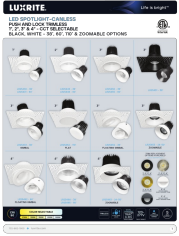
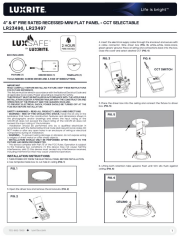
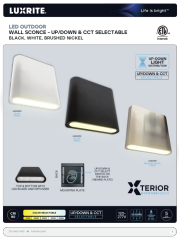
	<p>Luxrite 4" Module Interchangeable Trim Installation Guide - LR24961, LR24966</p> <p>Detailed installation instructions and specifications for the Luxrite 4" Module Interchangeable Trim, High Output 5CCT Selectable LED downlight (models LR24961, LR24966). Learn how to safely install and wire this versatile lighting fixture.</p>
---	---

	<p>Luxrite 3", 4", & 6" Recessed Mini Flat Panel Trim Installation Guide</p> <p>Comprehensive installation guide for Luxrite's 3, 4, and 6-inch recessed mini flat panel step baffled LED trims with 3 CCT selectable options (LR23738, LR23739, LR23740). Includes safety warnings, tools required, step-by-step instructions, and product specifications.</p>
	<p>Luxrite LED Spotlight-Canless: Push and Lock Trimless Installation Guide</p> <p>Comprehensive guide to Luxrite's LED Spotlight-Canless series, featuring push and lock trimless installation, CCT selectable options, and various beam angles. Includes detailed specifications, photometric data, and trim replacement options.</p>
	<p>Luxrite 4" & 6" Fire Rated Recessed Mini Flat Panel Light - CCT Selectable Installation Guide</p> <p>Installation guide for the Luxrite LR23496 and LR23497 4-inch and 6-inch fire-rated recessed mini flat panel lights. Learn how to safely install your CCT selectable fixture.</p>
	<p>Luxrite LED Outdoor Wall Sconce - Up/Down & CCT Selectable LR40300, LR40301, LR40302</p> <p>Detailed specifications for the Luxrite LED Outdoor Wall Sconce. Features up/down light distribution, 5-step CCT selectable (2700K-5000K), available in Black, White, and Brushed Nickel finishes. Includes electrical, photometric, and dimensional data.</p>
	<p>Luxrite LED Lay-In Backlit Flat Panel: 5CCT & Wattage Selectable</p> <p>Explore the Luxrite LED Lay-In Backlit Flat Panel series, featuring 5CCT color temperature and wattage selectability. Available in 1x4', 2x2', and 2x4' sizes, these sensor-ready fixtures offer energy efficiency, dimmability, and are IC rated for damp locations, backed by a 5-year warranty.</p>