

ANRAN Q03

ANRAN Solar Security Camera Outdoor User Manual

Model: Q03

1. PRODUCT OVERVIEW

The ANRAN Solar Security Camera Outdoor is a high-performance wireless surveillance solution designed for outdoor use. It features 5MP HD resolution, 360° pan and tilt capabilities, and is powered by a solar panel for continuous operation. The camera offers advanced features such as color night vision, PIR human detection, two-way audio, and smart siren alerts, ensuring comprehensive security for your property.



Figure 1: ANRAN Solar Security Camera Outdoor with solar panel.

Key features include:

- **5MP Crisp Image & 360° View:** Provides 355° horizontal and 140° vertical panoramic shooting with 5MP HD resolution.
- **Solar Powered, Energy Efficient:** Equipped with a solar panel for constant power in sunny conditions, reducing the need for manual charging.
- **HD Colour Night Vision:** Offers clear color night vision up to 15 meters, activated by four powerful spotlights upon human movement detection.

- **Two-Way Talk:** Built-in microphone and speaker enable real-time two-way audio communication via the mobile app.
- **Smart Home Enabled:** Compatible with Alexa/Google Assistant for voice control and live video streaming.
- **PIR Human Detection:** Intelligent AI human detection triggers alerts and siren.
- **IP65 Weatherproof:** Designed to withstand various outdoor weather conditions.

2. WHAT'S IN THE BOX

Verify that all components are present in the package before proceeding with installation.

What's in the Box



Package List

5MP Camera
USB Cable
Pack of Screws

Solar Panel
User Manual
Mounting Template

Bracket
Surveillance Sticker

Figure 2: Package contents of the ANRAN Solar Security Camera.

- 1 x 5MP Camera
- 1 x Solar Panel
- 1 x USB Cable
- 1 x User Manual
- 1 x Pack of Screws
- 1 x Mounting Template
- 1 x Bracket

- 1 x Surveillance Sticker

3. SETUP

3.1 Initial Charging

Before first use, fully charge the camera's internal battery using the provided USB cable. Connect the USB cable to the camera's charging port and a 5V/2A USB power adapter (not included). A full charge ensures optimal performance, especially during initial setup and periods of low sunlight.

3.2 App Installation and Account Creation

Download the official ANRAN app from the App Store (iOS) or Google Play Store (Android). Follow the on-screen instructions to create an account and log in.

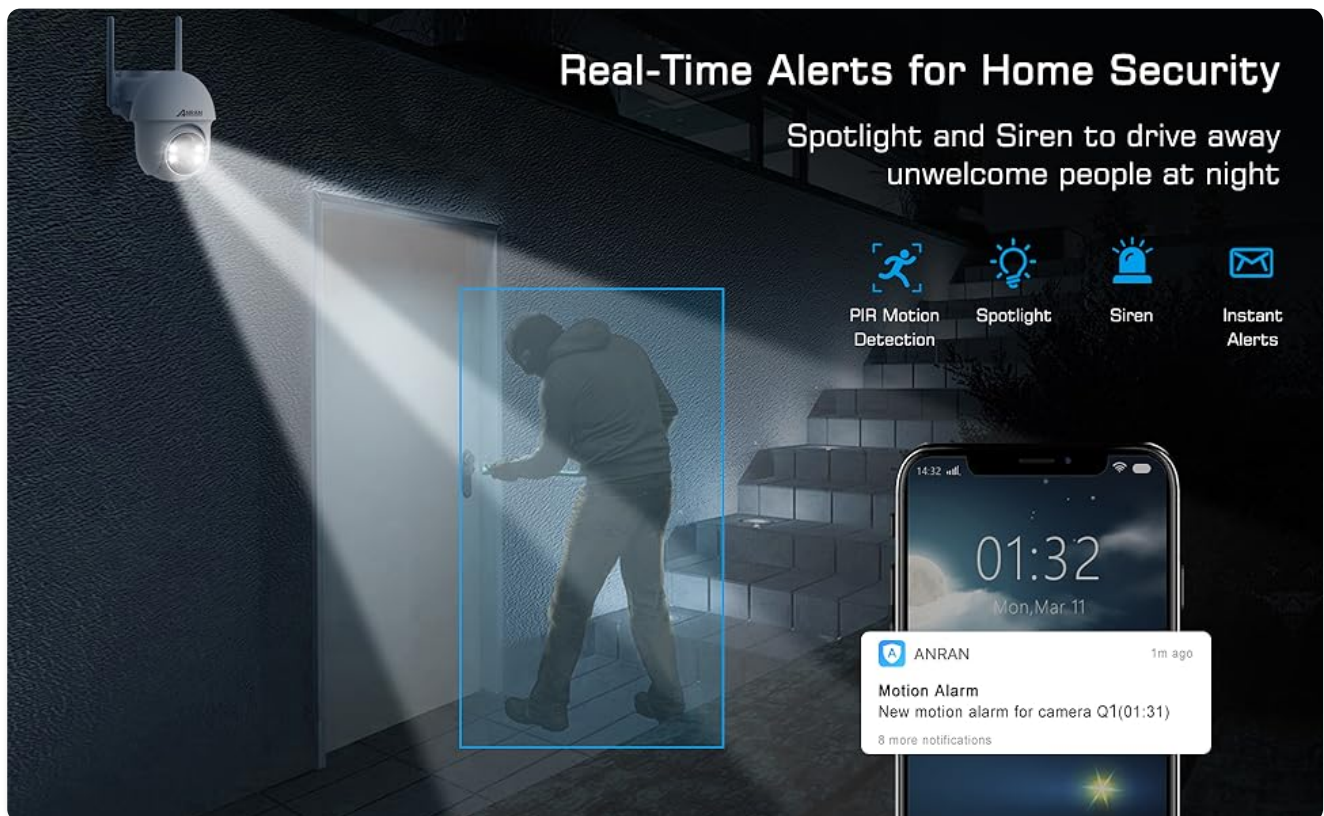

Figure 3: ANRAN app availability and key features.

3.3 Camera Pairing

Within the ANRAN app, select "Add Device" and follow the prompts to connect your camera to your 2.4GHz Wi-Fi network. Ensure your mobile device is connected to the same 2.4GHz Wi-Fi network during the pairing process. The camera supports 2.4GHz Wi-Fi only.

3.4 Mounting the Camera and Solar Panel

Choose a mounting location that provides a clear view of the area you wish to monitor and receives ample direct sunlight for the solar panel. Use the provided mounting template and screws to securely attach the camera and solar panel to a wall or other stable surface. Ensure the solar panel is positioned to maximize sun exposure throughout the day.

No Wiring No Hassle

2.4GHz

WiFi Connection

Non-Stop

Solar Charging



Figure 4: Illustrates the wireless setup and solar charging capability.

Connect the solar panel cable to the camera's charging port. The IP65 rating ensures the connection is protected from outdoor elements.

4. OPERATING THE CAMERA

4.1 Live View and Recording

Open the ANRAN app to access the live view of your camera. You can manually record video or capture screenshots directly from the live feed. The camera supports local storage via Micro SD card (up to 128GB, not included) and cloud storage (free 7-day trial available).



Figure 5: Cloud service and Micro SD card storage options.

4.2 Pan and Tilt Control

Use the directional controls within the app to remotely adjust the camera's viewing angle. The camera offers 355° horizontal pan and 140° vertical tilt for comprehensive coverage without blind spots.

No Blind Angle View



Figure 6: Demonstrates the camera's 360° pan and tilt capabilities.

4.3 Night Vision Modes

The camera automatically switches between day and night vision modes. It supports both infrared (IR) night vision for clear black and white images in complete darkness and 2.5K color night vision, enabled by its four powerful spotlights, which illuminate the scene for full-color recording.

5MP Super HD Resolution Day and Night

Capture clearer&smoother videos



5MP
2560×1920

Figure 7: Comparison of day and night vision clarity.

4.4 Two-Way Audio

Utilize the two-way audio feature to communicate with visitors or deter intruders. Tap the microphone icon in the app's live view to speak through the camera's speaker, and listen through its built-in microphone.

Clear Two-Way Audio



Figure 8: Demonstrates the two-way audio feature via the app.

4.5 PIR Human Detection and Alerts

The camera employs Passive Infrared (PIR) technology for accurate human detection, minimizing false alarms. When human motion is detected, the camera can automatically trigger a smart siren, activate spotlights, and send instant alerts to your mobile device. You can adjust the detection sensitivity in the app settings.

Smart Siren Alarm & Instant Alert

Accurate PIR Humanoid detection

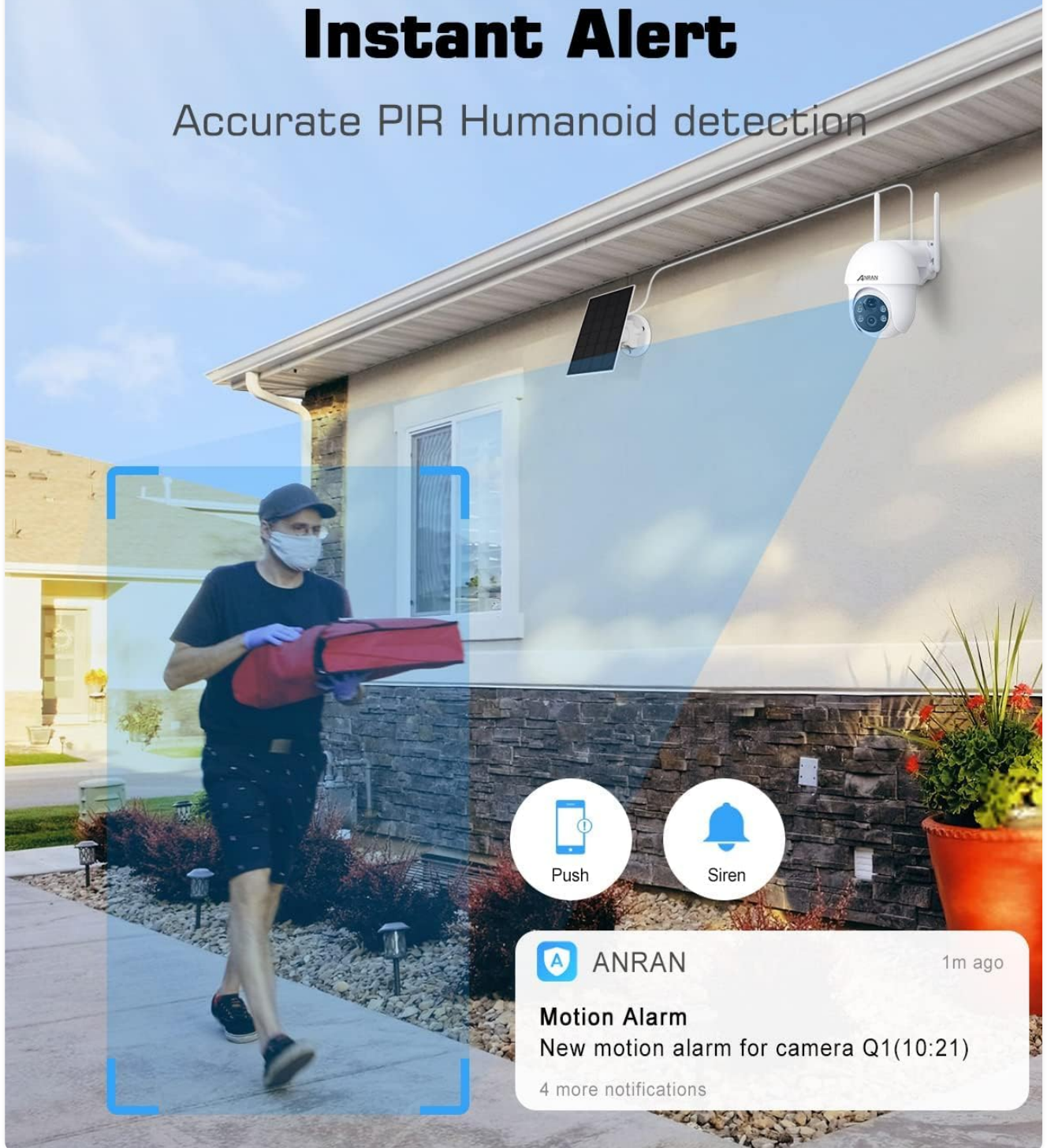

Figure 9: Illustrates the smart siren and instant alert system.



Figure 10: Adjustable detection sensitivity settings.

4.6 Smart Home Integration (Alexa/Google Assistant)

Integrate your ANRAN camera with Amazon Alexa or Google Assistant for convenient voice control. Once linked, you can ask your smart assistant to display the live feed from your camera on compatible smart displays.

Works with Alexa



works with
alexa



Figure 11: ANRAN camera compatibility with Alexa.

5. MAINTENANCE

5.1 Solar Panel Cleaning

Regularly clean the surface of the solar panel to ensure maximum sunlight absorption. Dust, dirt, and debris can

reduce charging efficiency. Use a soft, damp cloth to gently wipe the panel.

5.2 Camera Lens Cleaning

Keep the camera lens clean for optimal image clarity. Use a soft, lint-free cloth to wipe away any smudges or dirt. Avoid abrasive materials that could scratch the lens.

5.3 Firmware Updates

Periodically check the ANRAN app for available firmware updates. Keeping your camera's firmware up-to-date ensures you have the latest features, security enhancements, and bug fixes.

6. TROUBLESHOOTING

6.1 Camera Not Connecting to Wi-Fi

- Ensure your Wi-Fi network is 2.4GHz. The camera does not support 5GHz Wi-Fi.
- Check Wi-Fi signal strength at the camera's location. Move the camera closer to the router if necessary.
- Verify the Wi-Fi password entered in the app is correct.
- Restart your Wi-Fi router and the camera.

6.2 Battery Not Charging / Low Battery

- Ensure the solar panel is clean and receives direct sunlight for several hours daily.
- Check the connection between the solar panel and the camera.
- If sunlight is insufficient, manually charge the camera using the USB cable and a 5V/2A power adapter.
- Verify the ambient temperature is within the camera's operating range. Extreme cold can affect battery performance.

6.3 Poor Image Quality

- Clean the camera lens to remove any dirt or smudges.
- Ensure adequate lighting in the monitored area, especially for color night vision.
- Check your Wi-Fi connection speed. A weak signal can lead to choppy video.

6.4 False Alarms

- Adjust the PIR detection sensitivity in the ANRAN app.
- Ensure the camera is not pointed at areas with frequent movement from non-human sources (e.g., trees swaying, busy roads).

7. SPECIFICATIONS

Feature	Specification
---------	---------------

Model Name	Q03
Video Capture Resolution	1920p (5MP)
Connectivity Technology	Wireless (2.4GHz Wi-Fi)
Power Source	Solar Powered, Battery Powered
Viewing Angle	110 Degrees (Fixed Lens)
Pan/Tilt Range	355° Horizontal, 140° Vertical
Night Vision Range	55 Feet (approx. 15 meters)
Frame Rate	25 frames per second
Water Resistance Level	IP65 (Waterproof)
Item Weight	930 g
Batteries	2 AA batteries required (included)
Compatible Devices	Amazon Alexa, Google Assistant

8. WARRANTY AND SUPPORT

8.1 Product Warranty

The ANRAN Solar Security Camera Outdoor comes with a **1 Year Warranty** from the date of purchase. This warranty covers manufacturing defects and ensures the product functions as described under normal use. Please retain your proof of purchase for warranty claims.

8.2 Customer Support

For any questions, technical assistance, or warranty claims, please contact ANRAN customer support. ANRAN provides multi-channel service including email, phone, and live chat, available 7x24 hours online. Our dedicated team is ready to provide high-quality and considerate service.





Figure 12: ANRAN after-sales service details.

You can find contact information in the user manual provided with your product or by visiting the official ANRAN website.

Related Documents - Q03

	<p>ANRAN Solar Security Camera Outdoor User Manual</p> <p>This manual provides instructions for setting up and using the ANRAN Solar Security Camera Outdoor, a 5MP wireless camera with 2.4G WiFi, 360° view, pan/tilt, Alexa compatibility, night vision, PIR human detection, two-way talk, and IP65 rating.</p>
	<p>ANRAN Solar Security Cameras: User Guide and Specifications</p> <p>Comprehensive guide for ANRAN Solar Security Cameras, covering setup, features, and specifications for wireless outdoor surveillance.</p>
	<p>ANRAN S02 Solar Powered Wireless Security Camera Quick Start Guide</p> <p>Quick start guide for the ANRAN S02 solar-powered wireless security camera. Learn how to install, connect, and set up your camera using the ANRAN app. Features include 1080P resolution, PIR human detection, 2-way talk, and night vision.</p>
	<p>ANRAN S01/S02 Wireless Security Camera User Guide and Setup</p> <p>Comprehensive user guide for ANRAN S01 and S02 wireless outdoor security cameras. Learn how to install, set up the mobile app, and operate your camera for home surveillance with features like 2K resolution, solar power, and night vision.</p>

	<p>ANRAN P3 Max HD WiFi Security Camera Quick Start Guide</p> <p>Get started with your ANRAN P3 Max HD WiFi Security Camera. This guide provides step-by-step instructions for app setup, camera installation, Wi-Fi configuration, and answers common questions. Features include 5MP resolution, PTZ control, 360° view, color night vision, and IP66 waterproofing.</p>
	<p>ANRAN 3MP Solar Security Camera: Quick Start Guide</p> <p>Get started with your ANRAN 3MP Solar Security Camera. This guide covers setup, features like 2K color night vision, Wi-Fi, solar power, spotlight, PIR detection, and two-way audio for home security.</p>

Documents - ANRAN – Q03



Solar powered
-wireless security camera **Q3**
Quick Start Guide



● www.anran-cctv.com
✉ support@anran-cctv.com
☎ 1-866-958-6988 (US)
44-20 8610 1559 (UK)

TABLE OF CONTENTS

01

What's Included

Page

02

Product overview

Page

03

App installation and Setup

Page

04

Mounting the camera

Page

05

Register an account

Page

06

Set up WiFi for the camera

Page

07

FAQ

Page

What's Included



Camera



Solar panel



Screw Pack



Sticker



Warning Sticker



User Manual



Micro-USB
Charging Cable

support@anran-cctv.com

01

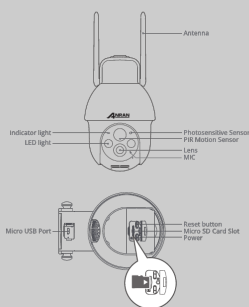

CAUTION: Please insert the Micro SD Card according to the direction shown in the diagram. Micro SD Card might JAM if inserted incorrectly and device could be damaged.

SD Card Port: Support micro SD card for local storage (Max 128GB).
Reset button: Used to restore the camera to factory settings (Press and hold on 5-8s).
Card capacity requirements: 8-128GB.
Read and write speed requirements: class10 level.
File format: FAT32.

ANRAN App installation and Setup

Search "ANRAN" on apple store or google play to download the app.

- from Google Play
- from Apple Store
- or Scan the following QR code



Download App (iOS & android)

Mounting the camera

Select Height and location

Hang the camera 7-10 ft (2-3 m) above the ground. This height maximizes the detection range of the motion sensor of the camera. Avoid placing the camera under direct sunlight.

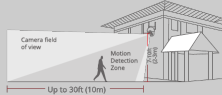

Installation

1. Drilling according to position sticker, drill bit: 15/64"(6 mm).
2. Insert the plugs.
3. Tighten the screw.

What is required:

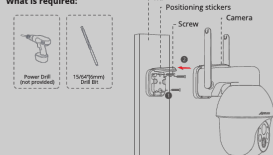

Installation instruction of solar panel

1. Keep the installation angle of solar panels about 30-45° with the horizontal plane, as shown in the picture below.
2. The installation between the solar panel and the camera is shown in the following figure. Open up the silicone cover at the bottom of the camera, remove the small center part of the cover. Insert the power cord through the opening and plug it into the USB port and then close the cover taking up any slack in the power cord from the solar panel.

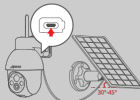

Tips for the installation of solar panel

1. When installing in the northern hemisphere, face the panel to the south, and when installing in the southern hemisphere, face the panel to the north.
2. Take care to install the solar panel so that the sun is not blocked by any items such as eaves, trees branches, etc.



Test the Wifi signal at installation position

Use cell phone to test Wifi signal quality at the installation position before installing camera, make sure the Wifi router can provide good Wifi signal.





06 | support@anran-cctv.com

Register an account

1. Open the APP to sign up an account. Go to the login interface, and click "Sign Up".
2. Sign up with your email address, and click "Next".
3. Set up an "Nickname" and "Password" for your APP, click "Done" to complete.



support@anran-cctv.com 07

Set up WiFi for the camera

1. Bring both your mobile phone and your camera close to your router (max distance of 5 meters/16 feet).

Note: The camera can only connect to a 2.4 GHz WiFi signal. It does not support using a 5 GHz signal. Therefore, please ensure you connect to a 2.4 GHz signal on your network as shown in the below illustration.



08 | support@anran-cctv.com

2. Log in to "ANRAN", then tap the "+" icon in the center. Tap "Battery Camera" to add device.

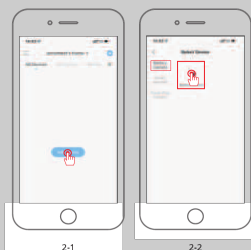

support@anran-cctv.com 09

3. Reset the device and wait for a flashing RED indicator light, then tap "Next".





3-1

3-2

10 support@anran-cctv.com

4. Selecting the Wi-Fi the device needs to connected with (your home Wi-Fi), Input the password and click "Next".



4-1



4-2

support@anran-cctv.com 11

5. Using the device to scan the QR code on the mobile phone according to the operation the figure shows, then proceed to the next step after hearing the prompt tone.



5-1



5-2

12 support@anran-cctv.com

6. After the network configuration is successful, set the name and password for the device to add successfully; then you can view the camera screen in real time.



6-1



6-2

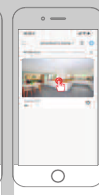

6-3

support@anran-cctv.com 13

Humanoid Detection

Turn on humanoid detection, the alert will be triggered only when human motion is detected.
Click the Settings button  and select "Alarm Management", then enable "Motion Detection" and click "Alarm Working Mode", select "Custom Mode" and click the Settings button to set the humanoid alarm.
Recording Time: The duration of each alarm video;
Alarm Interval: Interval of each alarm push.



Tips: If you want to detect other moving objects such as vehicles, please turn off humanoid detection switch, don't turn on "Day Detection" and "Night Detection".

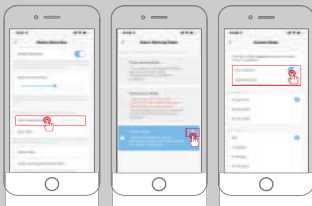

Audio warning and strobe light

Audio warning and strobe light is only valid at night.

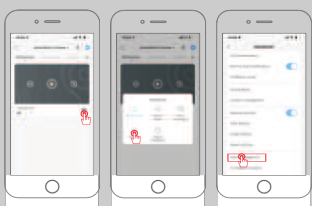

Device Share

The camera can only be added by one APP account. If other family members want to view the camera, you can share the camera with your family through the sharing function of the APP. Click the Settings button and select "Device Share"→"Add"→"Enter account" and input other party's APP account, then your family will receive a shared message on the APP, click Agree to view the camera you shared.

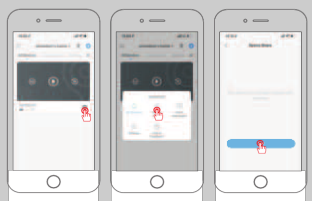



support@anran-cctv.com 19

FAQ

Q: The device prompts offline?

A: • Check whether the equipment is in the power-on state.
• Check whether the Wi-Fi network is in good condition and restart the router.
• If the device is located far away from the router, which results in the inability to obtain a good Wi-Fi signal, it is recommended to move the router to a closer place or add a Wi-Fi amplifier to improve the Wi-Fi performance of the home.
• Delete the camera from your ANRAN APP account and add it again after resetting the device.
• Check whether the device firmware and application program are the latest version.

Q: Why is it still in the list of devices after resetting?

A: The reset device only resets the network configuration of the camera, but cannot change the configuration on the App, remove the camera, and must be deleted by the App.

Q: How to cut the camera network to another router?

A: First remove and reset the device on the App and then configure the device again by the App.

Q: Why doesn't the device identify the SD card?

A: It is recommended to plug in SD card after power cut. Confirm whether the SD card is normally available and the format is FAT32. And the TF card can't be identified when the internet environment is not good.

Q: Why I can't get the notifications with my cell phone App?

A: Please confirm that the App has been running on the phone, and the relevant reminder function has been opened. Message notification and authority confirmation in the mobile phone system have been opened.

20 | support@anran-cctv.com

Manufacturer's Name: Shenzhen Anran Security Technology Co., Ltd
Address: No.290, Jihua Road, Jihua street, Longgang District, Shenzhen, No.112
EU Compliance statement: Shenzhen Anran Security Technology Co., Ltd.
Hereby declares this device in compliance with the essential requirements and other relevant provisions of Directive 2014/53/EU.
A copy of the EU Declaration of conformity is available online at www.anran-cctv.com/euro-compliance
To comply with RF exposure requirements, this equipment should be installed and operated with minimum distance 20cm between the radiator and your body.
UK compliance statement: Shenzhen Anran Security Technology Co., Ltd.
Hereby declares that this device is in compliance with the essential requirements and other relevant provisions of the UK Radio Equipment Regulations 2017 (SI 2017/1206).
A copy of the UK declaration of the conformity is available online at www.anran-cctv.com/UKCA-compliance
To comply with RF exposure requirements, this equipment should be installed and operated with minimum distance 20cm between the radiator and your body.
RF Specification
WiFi: 2412-2472MHz
Transmission power: 16.81 dbm (eirp)

Safety Statement

FCC Statement

This device complies with Part 15 of the FCC Rules. Operation is subject to the following two conditions: (1) this device may not cause harmful interference, and (2) this device must accept any interference received, including interference that may cause undesired operation.

Warning: Changes or modifications not expressly approved by the party responsible for compliance could void the user's authority to operate the equipment.

Note: This equipment has been tested and found to comply with the limits for a Class B digital device, pursuant to Part 15 of the FCC Rules. These limits are designed to provide reasonable protection against harmful interference in a residential installation.

This equipment generates uses and can radiate radio frequency energy and, if not installed and used in accordance with the instructions, may cause harmful interference to radio communications. However, there is no guarantee that interference will not occur in a particular installation. If this equipment does cause harmful interference to radio or television reception, which can be determined by turning the equipment off and on, the user is encouraged to try to correct the interference by one or more of the following measures: (1) Reorient or relocate the receiving antenna. (2) Increase the separation between the equipment and receiver. (3) Connect the equipment into an outlet on a circuit different from that to which the receiver is connected. (4) Consult the dealer or an experienced radio/ TV technician for help.

FCC Radio Frequency Exposure Statement

The device has been evaluated to meet general RF exposure requirements. The device can be used in fixed/mobile exposure condition. The min separation distance is 20cm.

Notice: Shielded cables

All connections to other computing devices must be made using shielded cables to maintain compliance with FCC regulations.

Warranty Tips

Please fill in the following information or scan QR code to activate the free 12-month warranty from the order date on.

After finish filling or scanning, please take a picture and send it to the email(support@anran-cctv.com).

Then your free warranty will take effect!

During the warranty period, if any parts of product are damaged, please contact us immediately and we will

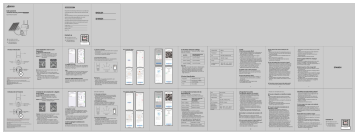
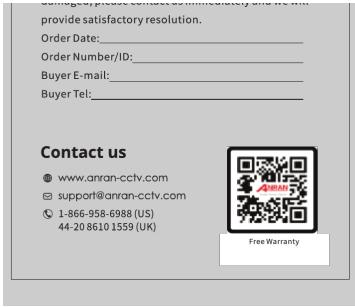

[ANRAN Q3 Pro Solar Security Camera User Guide](#)

Comprehensive user guide for the ANRAN Q3 Pro 2K solar-powered wireless outdoor security camera, covering installation, app setup, features, and troubleshooting.
lang: **score:15** filesize: 6.07 M page_count: 1 document date: 2023-06-09

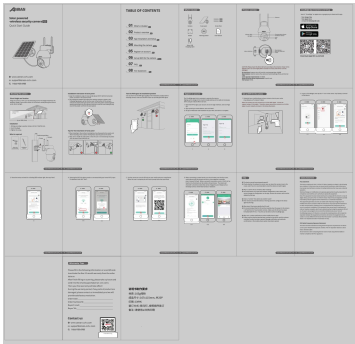

[\[pdf\] User Manual](#)

AR Q03 2022 03 10 Administrator User Manual Amazon ANRAN 2K Security Camera Outdoor Solar Wireless with 360° View Smart Siren Spotlights Color Night Vision AI Human Detection 2 Way Talk Compatible Alexa Q3 Black Electronics C1MgtlXjNPL m media amazon images I |||
...
lang: **score:13** filesize: 4.25 M page_count: 1 document date: 2022-03-12

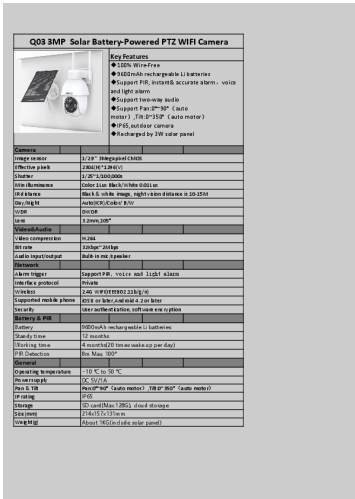

[\[pdf\] Specifications](#)

Administrator Specification Sheet Amazon ANRAN 2K Security Camera Outdoor Solar Wireless with 360° View Smart Siren Spotlights Color Night Vision AI Human Detection 2 Way Talk Compatible Alexa Q3 Black Electronics 718rldfEgL m media amazon images I |||
Q03 3MP Solar Battery-Powered PTZ WIFI Camera Key Features 100 Wire-Free 9600mAh rechargeable Li batteries Support PIR, instant accurate alarmvoice and light alarm Support two-way audio Support Pan:0-90auto motor,Tilt:0-350auto motor IP65,outdoor camera Recharged by 3W solar panel Camera Image se...
lang:en **score:11** filesize: 248.59 K page_count: 3 document date: 2022-10-24

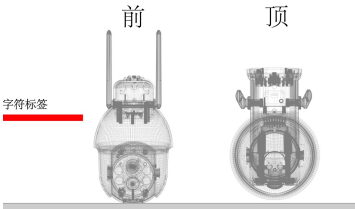

[\[pdf\] Label](#)

q03 2 ID label and location Shenzhen Anran Security Technology Co Ltd Q1PRO IP Camera with Battery 2AZUX 2AZUXQ1PRO q1pro
...
lang:en **score:11** filesize: 2.42 M page_count: 2 document date: 2022-09-20

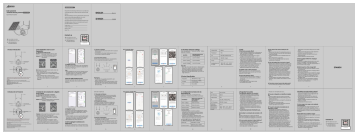

[ANRAN Solar Security Camera Outdoor User Manual](#)

This manual provides instructions for setting up and using the ANRAN Solar Security Camera Outdoor, a 5MP wireless camera with 2.4G WiFi, 360° view, pan/tilt, Alexa compatibility, night vision, PIR human detection, two-way talk, and IP65 rating.
lang:en **score:11** filesize: 6.27 M page_count: 1 document date: 2023-06-09