

## Ortis Ortis Smart Pool Timer

# Ortis Smart Pool Timer Instruction Manual

Model: Ortis Smart Pool Timer

## 1. INTRODUCTION

Thank you for choosing the Ortis Smart Pool Timer. This device is designed to automate the operation of your pool pump, filters, landscape lights, and other equipment, providing convenience and energy efficiency. Please read this manual thoroughly before installation and operation to ensure safe and optimal performance.



Image 1.1: Ortis Smart Pool Timer in an outdoor pool setting.

## 2. SAFETY INFORMATION

- Ensure the timer is connected to a properly grounded outlet.
- Do not exceed the maximum total current of 15A for the dual sockets.
- Verify that the wall outlet and appliance plug are in good condition before use.
- Keep the device away from direct water exposure unless explicitly stated as waterproof.
- Do not attempt to disassemble or repair the device yourself. Contact qualified personnel for service.

### 3. SETUP

#### 3.1. Components Overview

The Ortis Smart Pool Timer features a compact design with dual grounded outlets and a simple control panel.



Image 3.1: Front view of the Ortis Smart Pool Timer, showing the dual outlets and attached power plug.



Image 3.2: Detailed view highlighting the UL Listed Plug, Control Switch, 2 Grounded Outlets, and Mounting Hole.

### 3.2. Physical Installation

The timer can be installed in two ways:

- **Wall Mounting:** Use the integrated mounting holes on the back of the timer to secure it to a wall or suitable surface.
- **Hanging:** The timer can also be hung using the top loop, ensuring it is in a stable position.

# Meet Your Different Needs

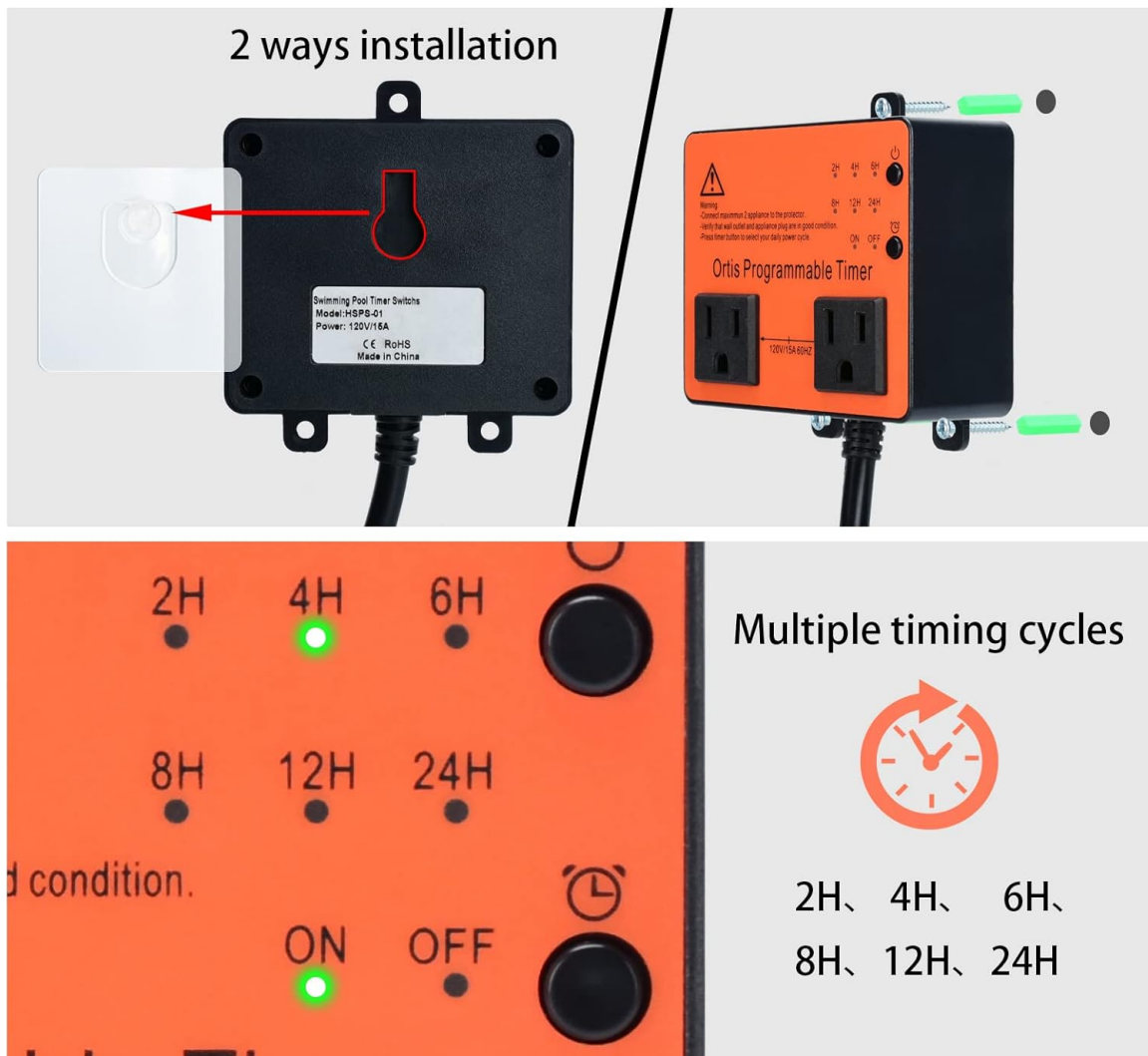

Image 3.3: The back of the timer illustrating the two installation methods: wall mounting with screws or hanging.

## 3.3. Connecting Devices

Plug your pool pump, filter, landscape lights, or other compatible devices into the dual grounded outlets on the timer. Ensure the total current draw does not exceed 15A.



# Run The Pump And Salt Chlorine System At The Same Time



Image 3.4: The timer connected to a pool pump and a salt chlorine generator, demonstrating multi-device connection.

## 3.4. Initial Programming (One-Button Operation)

The Ortis Smart Pool Timer features a simple one-button operation for setting timing cycles:

1. Plug the timer into a wall outlet.
2. Press the timer button repeatedly to cycle through the available timing options: 2H, 4H, 6H, 8H, 12H.
3. Select your desired daily power cycle. The timer will then operate for the selected duration and repeat every 24 hours.

# Extremely Easy Setup



Image 3.5: Close-up of the timer's control panel, showing the timing cycle options and the one-button interface.

## 3.5. App Setup (If Applicable)

For advanced control and smart features, the Ortis Smart Pool Timer may be compatible with the GeniLife app. Follow the instructions in the video below to set up the app and pair your device.

Video 3.1: Instructions on how to use the GeniLife App for iOS systems, including Bluetooth and Wi-Fi pairing.

## 4. OPERATING THE TIMER

### 4.1. Automatic Operation

Once a timing cycle (2H, 4H, 6H, 8H, or 12H) is selected using the one-button operation, the timer will automatically turn on for the set duration and then turn off. This cycle will repeat every 24 hours from the initial activation time.

### 4.2. Manual On/Off

To manually switch the device on or off outside of the programmed cycle, simply press the timer button. This will override the current program until the next scheduled event or until a new cycle is selected.

### 4.3. Multi-Device Connection

The dual sockets allow for simultaneous operation of two devices, such as a pool pump and a salt chlorine system. Ensure the combined current of both devices does not exceed 15A. For additional devices, a power strip can be connected to one of the timer's outlets, provided the total current limit is respected.



Image 4.1: Examples of equipment that can be controlled by the Oris Smart Pool Timer, including pool pumps and landscape lighting.

Video 4.1: A user demonstrating how they utilize the Oris Smart Pool Timer for both pool equipment and lights, highlighting its versatility.

## 5. MAINTENANCE

- Regularly inspect the timer and connected cables for any signs of damage or wear.
- Clean the timer's exterior with a soft, dry cloth. Do not use harsh chemicals or abrasive cleaners.
- Ensure the timer is protected from extreme weather conditions, even if it is designed for outdoor use.

## 6. TROUBLESHOOTING

- **Timer not turning on/off:** Check if the timer is properly plugged into a live outlet. Ensure the connected appliance is functioning correctly. Re-select the desired timing cycle.
- **Power outage resets timer:** The Ortis Smart Pool Timer is designed with a power-off memory function to retain settings. However, in rare cases or with prolonged outages, a reset might occur. Re-program the desired timing cycle if necessary.
- **Devices not receiving power:** Verify that the total current of all connected devices does not exceed 15A. Check the power indicator light on the timer. If it's off, there might be no power to the timer itself.

## 7. SPECIFICATIONS

- **Brand:** Ortis
- **Model:** Ortis Smart Pool Timer
- **Color:** Orange
- **Material:** Metal, Plastic
- **Product Dimensions:** 1"D x 1"W x 2"H
- **Item Weight:** 0.32 Kilograms (11.3 ounces)
- **Number of Timing Cycles:** 5 (2H, 4H, 6H, 8H, 12H)
- **Max Current:** 15A (total for dual sockets)
- **First Available:** April 3, 2023





Image 7.1: Visual representation of the Ortis Smart Pool Timer's dimensions.

## 8. WARRANTY AND SUPPORT

For warranty information, technical support, or any questions regarding your Ortis Smart Pool Timer, please refer to the product packaging or contact Ortis customer service directly. Contact details are typically provided with your purchase documentation.