

## De'Longhi PAC EX105

# De'Longhi Pinguino PAC EX105 Portable Air Conditioner User Manual

## 1. INTRODUCTION AND OVERVIEW

---

Thank you for choosing the De'Longhi Pinguino PAC EX105 Portable Air Conditioner. This appliance is designed to provide optimal comfort through cooling, dehumidification, and ventilation functions. It features EcoRealFeel technology for energy efficiency and an integrated dust filter for improved air quality.



Image 1.1: De'Longhi Pinguino PAC EX105 in operation with remote control.

## Key Features:

- **Optimal Environment:** Cooling with a closed refrigerant system (20-22 °C) and an integrated dust filter to remove pollen, dust, and small dirt particles from the air.
- **Silent and Compact:** Silent technology ensures quiet operation. Reduced fan speed minimizes noise, making it suitable for use as a dehumidifier.
- **Powerful and Efficient:** Achieves A+++ energy class, includes a 24-hour timer, and offers dehumidification up to 56 liters in 24 hours.
- **Personal Comfort:** EcoRealFeel technology automatically adjusts temperature and humidity for optimal comfort, potentially saving up to 30% energy compared to models without Eco mode.
- **Easy to Move:** Portable design with integrated handles and wheels for convenient relocation within a room.

## 2. SAFETY INFORMATION

Please read all safety warnings and instructions carefully before using this appliance to prevent personal injury or damage. Keep this manual for future reference.

- Ensure the power supply voltage matches the rating label on the appliance.
- Do not operate the appliance with a damaged cord or plug.
- Keep the appliance away from heat sources, direct sunlight, and water.
- Do not block air inlets or outlets. Maintain a minimum distance of 50 cm from walls or other objects.
- Always unplug the appliance before cleaning or maintenance.
- This appliance is not intended for use by persons (including children) with reduced physical, sensory or mental capabilities, or lack of experience and knowledge, unless they have been given supervision or instruction concerning use of the appliance by a person responsible for their safety.
- Children should be supervised to ensure that they do not play with the appliance.
- In case of malfunction, do not attempt to repair the appliance yourself. Contact qualified service personnel.

### 3. PRODUCT COMPONENTS

Familiarize yourself with the components included in your De'Longhi Pinguino PAC EX105 package:

## Guarda all'interno della confezione

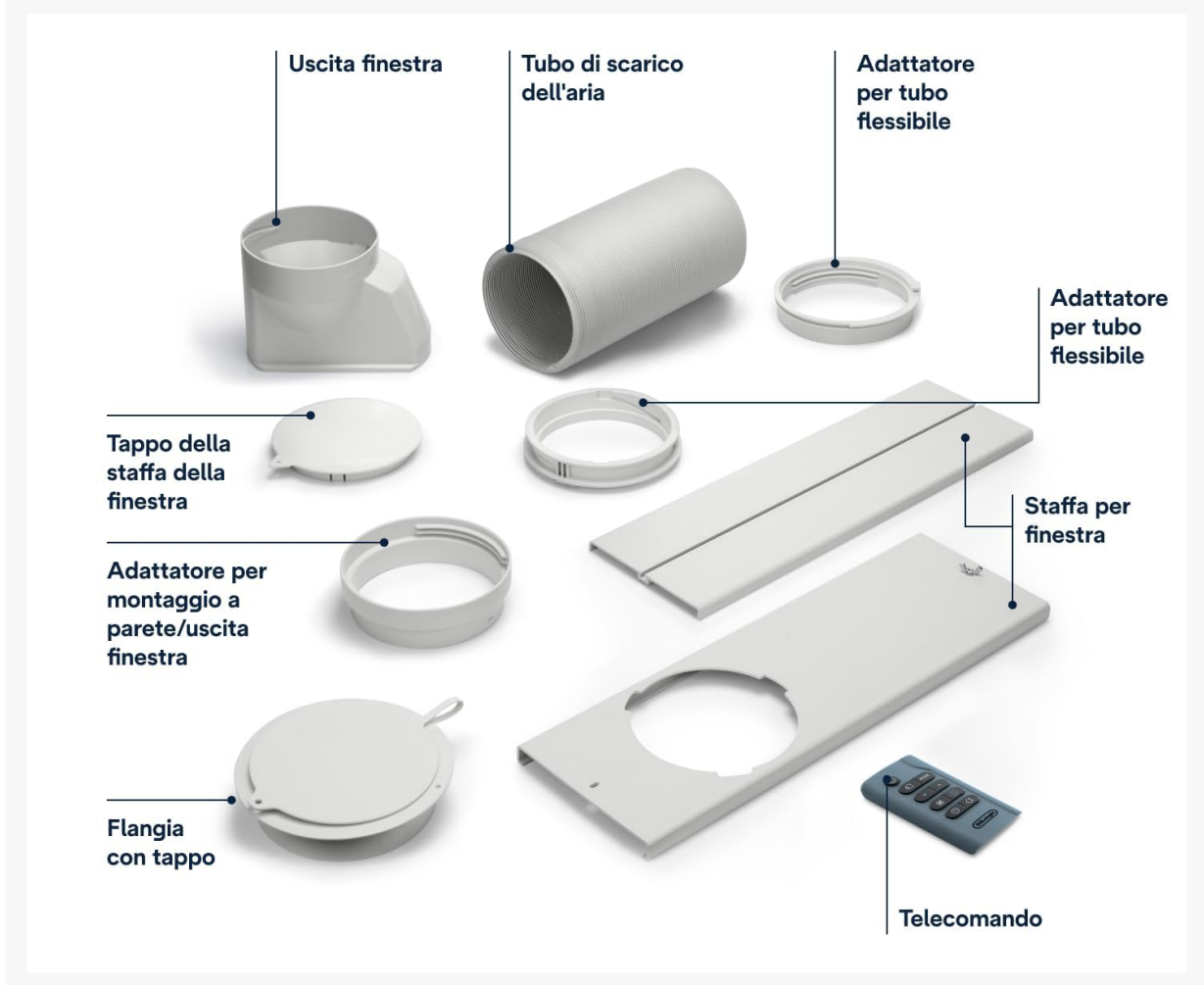

Image 3.1: Contents of the De'Longhi Pinguino PAC EX105 package.

1. Main Air Conditioner Unit
2. Air Exhaust Hose
3. Flexible Hose Adapter
4. Window Outlet
5. Window Bracket
6. Window Bracket Cap
7. Wall/Window Outlet Mounting Adapter
8. Flange with Cap
9. Remote Control

## 4. SETUP

---

Proper setup is crucial for efficient operation. Follow these steps to prepare your air conditioner for use:

### 4.1 Positioning the Unit

- Place the unit on a flat, stable surface.
- Ensure there is at least 50 cm of clear space around the unit for proper airflow.
- Position the unit near a window or opening for the exhaust hose.

### 4.2 Installing the Air Exhaust Hose

The exhaust hose expels hot air outside. There are two main installation options:

# Scegli la tua impostazione

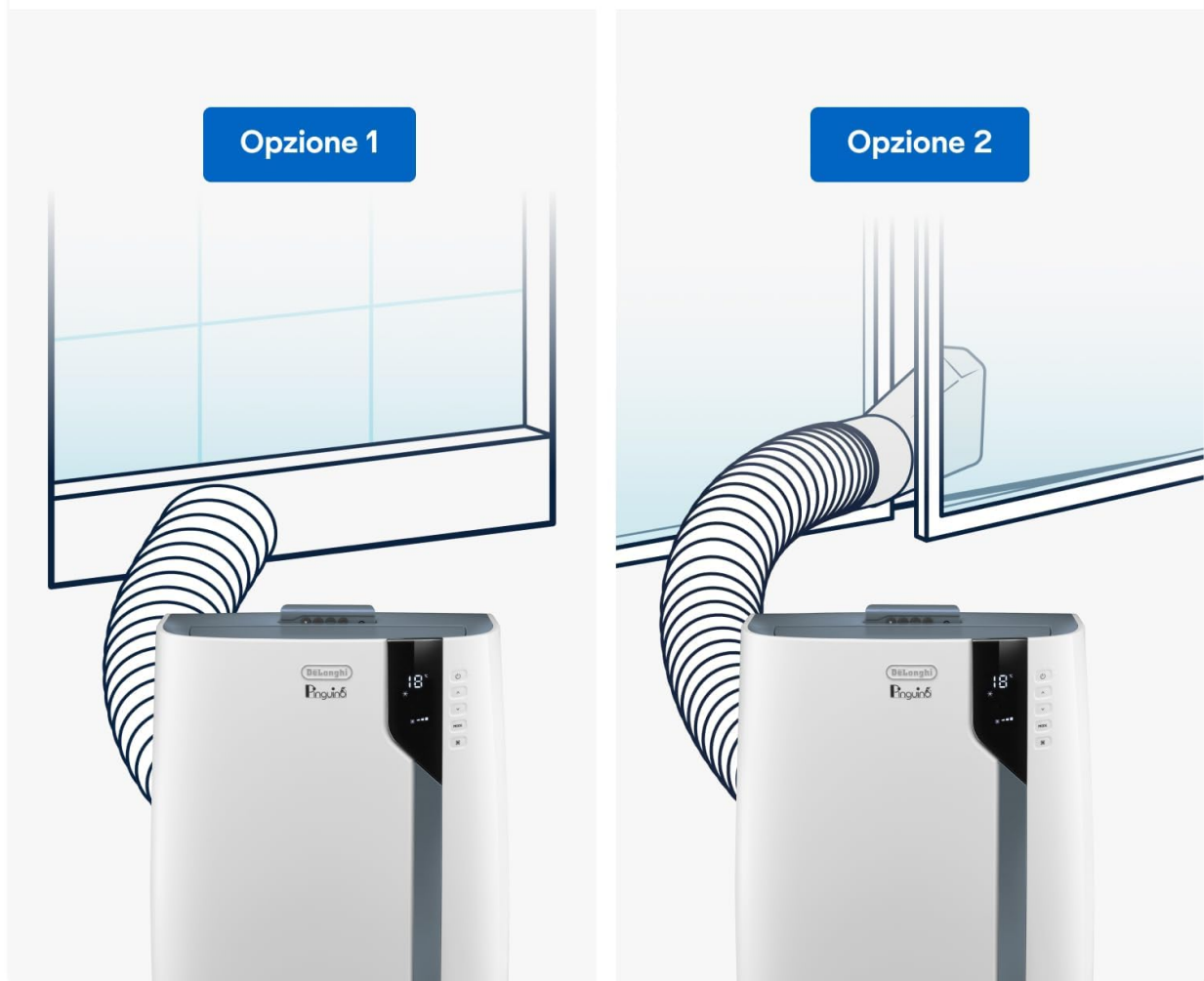

Image 4.1: Exhaust hose installation options.

## 1. Option 1: Through a Window (Temporary)

- Attach the flexible hose adapter to one end of the air exhaust hose.
- Insert the other end of the hose into the air outlet on the back of the air conditioner.
- Open the window slightly and place the window outlet into the opening.
- Connect the flexible hose adapter to the window outlet.
- Close the window as much as possible to minimize air exchange with the outside. Consider using a window sealing kit (not included) for better efficiency.

## 2. Option 2: Through a Window Bracket (Semi-Permanent)

- Assemble the window bracket according to the instructions provided with the bracket.
- Install the window bracket in a vertical or horizontal sliding window.
- Attach the flexible hose adapter to the air exhaust hose and then connect it to the opening in the window bracket.
- Ensure the connection is secure to prevent hot air from re-entering the room.

**Important:** The exhaust hose must be as short as possible and without sharp bends to ensure efficient operation. A minimum window opening width of 445 mm is required for the window bracket.

## 5. OPERATING INSTRUCTIONS

Your De'Longhi Pinguino PAC EX105 can be operated using the control panel on the unit or the remote control.

# Scopri il suo potenziale



Image 5.1: Control panel and remote control.

**Controllo remoto**

**Funzionamento silenzioso**

**Flusso d'aria direzionabile e regolabile**

### 5.1 Control Panel and Remote Control Functions

The control panel features a digital display and various buttons for mode selection, temperature adjustment, and timer settings. The remote control offers the same functionalities for convenient operation.

### 5.2 Operating Modes

- **Cooling Mode (COOL):** This mode provides active cooling. Set your desired temperature using the up/down arrows. The unit will cool the room to the set temperature.
- **Dehumidifying Mode (DRY):** This mode removes excess moisture from the air without significant cooling. Ideal for humid conditions. The unit can remove up to 56 liters of moisture per 24 hours.
- **Fan Mode (FAN):** This mode circulates air without cooling or dehumidifying. You can select from 3 fan speeds.

### 5.3 Setting Temperature and Fan Speed

- Use the **UP** and **DOWN** arrows on the control panel or remote to adjust the desired temperature in Cooling mode.
- In Fan mode, press the **FAN SPEED** button to cycle through low, medium, and high settings.

### 5.4 EcoRealFeel Technology

The EcoRealFeel technology automatically optimizes temperature and humidity levels to achieve maximum comfort with reduced energy consumption. Activate this mode for intelligent and efficient climate control.

## Il tuo comfort ideale

### Tecnologia Eco Real Feel

Raggiunge e mantiene automaticamente la temperatura ideale risparmiando fino al 30%\* di consumo energetico.

\*Test di laboratorio interno, condizioni iniziali 30° e 40% R.H.



Image 5.2: EcoRealFeel technology display.

### 5.5 24-Hour Timer

The integrated 24-hour timer allows you to program the unit to turn on or off automatically. Refer to the detailed instructions in the full manual for setting the timer.

### 5.6 Silent Operation

For quieter operation, select the Silent mode. This reduces the fan speed and overall noise level, making it suitable for use during sleep or in quiet environments.

## 6. MAINTENANCE

---

Regular maintenance ensures optimal performance and extends the lifespan of your air conditioner.

### 6.1 Cleaning the Air Filter

- The air filter should be cleaned regularly (e.g., every two weeks) or more frequently depending on usage and air quality.
- Unplug the appliance from the power outlet.
- Locate and remove the air filter from the back or side of the unit.
- Wash the filter with lukewarm water and a mild detergent. Rinse thoroughly.
- Allow the filter to dry completely before reinserting it into the unit. Do not expose to direct sunlight.

### 6.2 Draining Condensate Water

During dehumidification or in very humid conditions, water will collect inside the unit. The PAC EX105 typically evaporates most condensate automatically. However, if the water tank becomes full, the unit will stop operating and display an error. You may need to manually drain the water:

- Unplug the appliance.
- Place a shallow pan or container under the drainage outlet (usually located at the bottom rear of the unit).
- Remove the drain plug and allow the water to flow out.
- Once drained, replace the drain plug securely.

### 6.3 Cleaning the Unit Exterior

- Wipe the exterior of the unit with a soft, damp cloth.
- Do not use abrasive cleaners, waxes, or solvents.

## 7. TROUBLESHOOTING

---

If you encounter issues with your De'Longhi Pinguino PAC EX105, refer to the following common problems and solutions:

| Problem                   | Possible Cause  | Solution  |
|---------------------------|---|---|
| Unit does not turn on     | No power supply; Plug not inserted; Timer active                                | Check power connection; Insert plug firmly; Deactivate timer  |
| Unit cools insufficiently | Windows/doors open; Exhaust hose blocked/bent; Air filter dirty; Room too large | Close openings; Check hose for obstructions; Clean air filter; Ensure room size is within unit capacity (up to 100 m <sup>3</sup> ) |
| Unit is noisy             | Unit not on a flat surface; Fan speed too high                                  | Place on a flat surface; Select Silent mode or lower fan speed  |
| Water leaks from unit     | Drain plug not secured; Unit tilted   | Ensure drain plug is tightly closed; Place unit on a level surface  |

| Problem                  | Possible Cause       | Solution   |
|--------------------------|----------------------|--|
| Display shows error code | Specific malfunction | Refer to the full manual for specific error code meanings or contact customer support. |

If the problem persists after attempting these solutions, please contact De'Longhi customer support.

## 8. SPECIFICATIONS

Detailed technical specifications for the De'Longhi Pinguino PAC EX105:

# Potente ed efficiente

**10.000 BTU/h**  
**2.5 kW**  
capacità di  
raffreddamento

---

Stanze fino a  
**100 m<sup>3</sup>**

---

**3-in-1**  
Raffreddamento,  
deumidificazione,  
ventilazione



805 mm

390 mm

445 mm

Image 8.1: Product dimensions and performance overview.

| Specification | Value      |
|---------------|------------|
| Brand         | De'Longhi  |
| Model Name    | PAC EX 105 |

| Specification                           | Value   |
|---|---|
| Cooling Capacity                        | 10,000 BTU/h (2.5 kW)   |
| Recommended Room Size                   | Up to 100 m <sup>3</sup>  |
| Energy Efficiency Class                 | A+++  |
| Seasonal Energy Efficiency Ratio (SEER) | 20  |
| Annual Energy Consumption               | 2500 Kilowatt (This value seems high for annual consumption, typically it's kWh/60min or similar. Please refer to the energy label for precise values.) |
| Dehumidification Capacity               | Up to 56 Liters/24 hours  |
| Noise Level                             | 63 Decibels   |
| Refrigerant                             | R-290   |
| Power Electrical                        | 645 Watts   |
| Voltage                                 | 240 Volts   |
| Product Dimensions (DxWxH)              | 39P x 44.5l x 80.5H cm  |
| Item Weight                             | 29.8 Kilograms  |
| Control Method                          | Remote  |
| Special Features                        | Dust filter, 3 fan speeds, 24-hour digital timer, EcoRealFeel technology  |

# Risparmia energia con raffreddamento consapevole



## Il Pinguino più efficiente

L'unico con classe energetica A+++

Image 8.2: Energy Efficiency Label.

## 9. WARRANTY AND SUPPORT

Your De'Longhi Pinguino PAC EX105 comes with a limited warranty. Please refer to the warranty card included in your product packaging for specific terms and conditions.

### Customer Support:

For technical assistance, troubleshooting beyond this manual, or warranty claims, please contact De'Longhi customer support. Contact information can typically be found on the official De'Longhi website or in the product documentation.

When contacting support, please have your product model number (PAC EX105) and serial number ready. The serial number is usually located on a label on the back or bottom of the unit.

