

Backnets TS-ZY-002

Backnets TS-ZY-002 Brushed Nickel Pressure Balancing Shower Diverter Mixing Valve Instruction Manual

Model: TS-ZY-002 | Brand: Backnets

1. INTRODUCTION

This manual provides detailed instructions for the installation, operation, and maintenance of your Backnets TS-ZY-002 Brushed Nickel Pressure Balancing Shower Diverter Mixing Valve. Please read this manual thoroughly before installation and use to ensure proper function and longevity of the product. Retain this manual for future reference.

2. PRODUCT FEATURES

- **Durable Construction:** Manufactured from solid brass with a brushed nickel finish for enhanced durability and corrosion resistance.
- **Stable Water Pressure:** Integrated pressure balancing technology helps prevent sudden temperature fluctuations, ensuring a consistent and comfortable shower experience.
- **Versatile Functionality:** This 3-way diverter valve allows seamless switching between up to three shower outlets (e.g., rain showerhead, handheld shower, tub spout).
- **Water Saving:** Designed for efficient water usage, potentially reducing water consumption by up to 30%.
- **Safety Design:** Features a round design without sharp edges for a safe showering environment.

Easy to Use

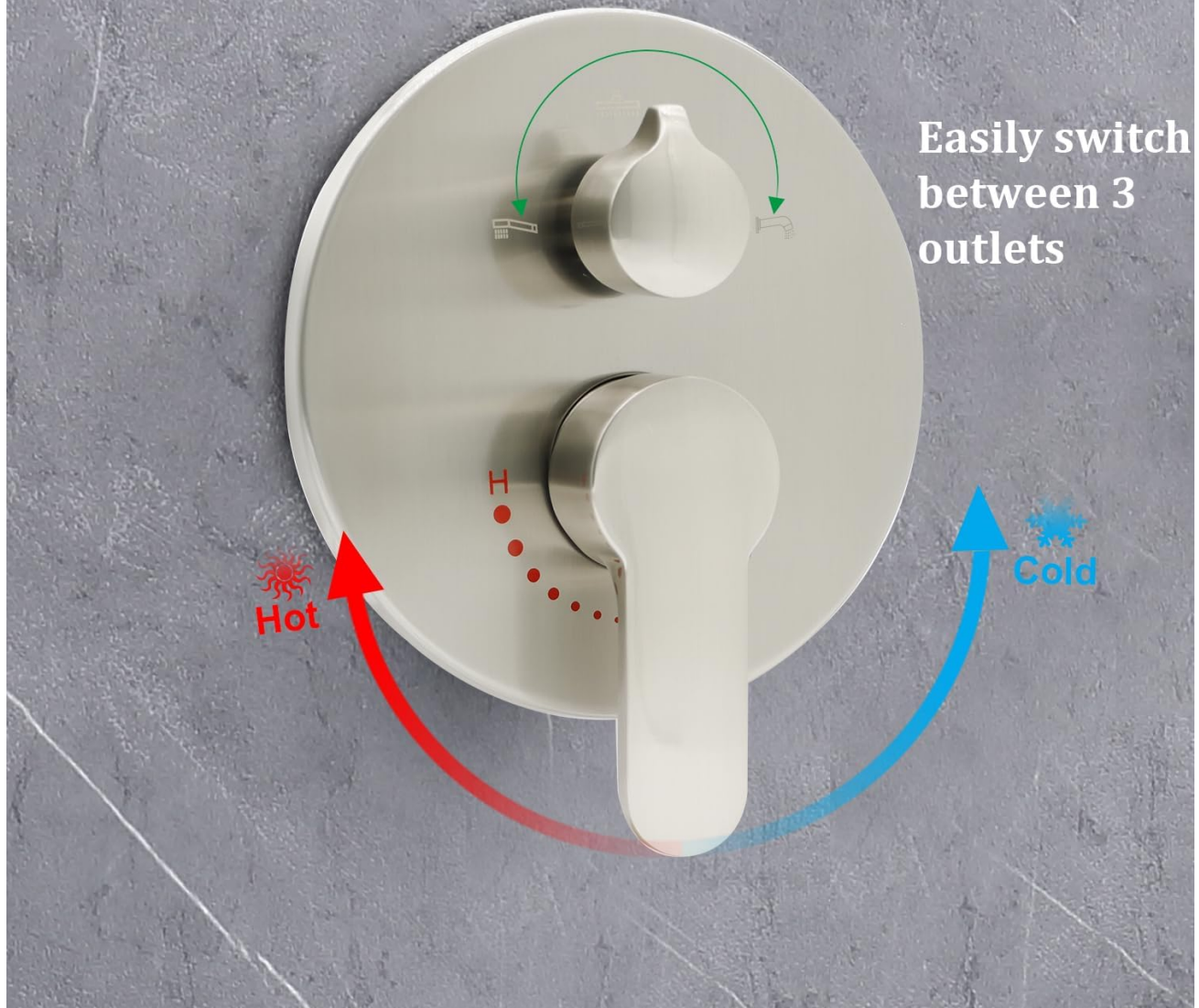
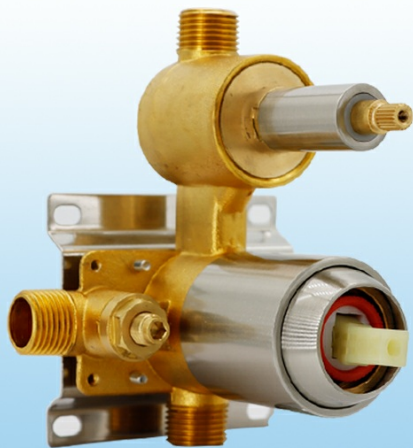

Figure 2.1: Easy-to-use controls for temperature and outlet selection.



Solid Brass

The valve design of high-strength brass material not only gives the shower valve excellent robustness and stability, but also significantly reduces the influence of thermal expansion and cold contraction caused by temperature changes in daily use, ensuring the durability and safety of use.

Figure 2.2: The valve is constructed from high-strength brass for robustness and stability.

3. PACKAGE CONTENTS

Carefully unpack the box and ensure all components are present and undamaged. If any parts are missing or damaged, please contact customer support before proceeding with installation.

- Pressure Balancing Shower Diverter Mixing Valve Body
- Faceplate (Brushed Nickel)
- Temperature Control Handle
- Diverter Knob
- Mounting Hardware

Your browser does not support the video tag.

Video 3.1: Unpacking and component overview of the Pressure Balance Shower Diverter Valve.

4. SETUP AND INSTALLATION

Professional installation is recommended. Ensure water supply is turned off before beginning installation. This valve is designed for concealed installation within the wall.

4.1 Connection Overview

- The thread standard for this pressure balancing valve is male NPT 1/2.
- The valve body has three connectors: cold water inlet, hot water inlet, and a mixed outlet.
- This is a three-function valve; however, it cannot operate all three functions simultaneously.

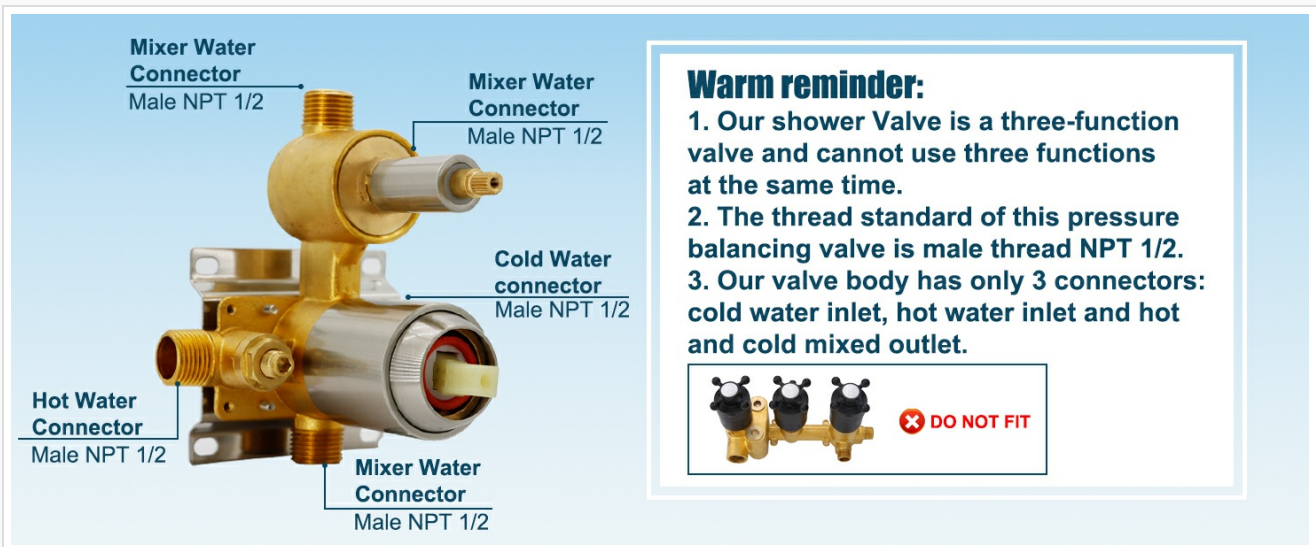

Figure 4.1: Diagram illustrating the hot water inlet, cold water inlet, and mixed water outlet connections.

4.2 Identifying Inlets and Outlets

Refer to the video below to correctly identify the hot water inlet, cold water inlet, and the three outlets (Outlet 1, Outlet 2, Outlet 3) on the valve body. Proper identification is crucial for correct plumbing.

Your browser does not support the video tag.

Video 4.2: Detailed view of the shower valve diverter, highlighting hot/cold inlets and outlets.

4.3 Plumbing Reference

The installation reference diagram provides a visual guide for plumbing connections. Ensure that the hot and cold water lines are connected to their respective inlets. The three outlets can be connected to your desired shower components (e.g., main showerhead, handheld, body jets).

Figure 4.3: Schematic diagram for plumbing connections and valve orientation.

5. OPERATING INSTRUCTIONS

The Backnets shower valve features two main controls: a temperature control handle and a diverter knob for selecting outlets.

5.1 Temperature Control

The lower handle controls the water temperature. Rotate the handle towards the red indicators for hotter water and towards the blue indicators for colder water. The pressure balancing feature will maintain a consistent temperature even with fluctuations in household water pressure.

5.2 Outlet Selection (Diverter)

The upper knob functions as the diverter, allowing you to switch between the connected shower outlets. Rotate the knob to select the desired water flow. Remember, only one outlet can be active at a time.



Figure 5.1: Visual guide to operating the 3-function shower valve, showing selection for rain shower, handheld, and body jets.

Your browser does not support the video tag.

Video 5.2: Demonstration of the pressure balance function during operation.

6. MAINTENANCE

Regular cleaning and proper care will help maintain the appearance and functionality of your shower valve.

6.1 Cleaning the Finish

To clean the brushed nickel finish, use a soft, damp cloth and a mild soap. Avoid abrasive cleaners, harsh chemicals, or scouring pads, as these can damage the finish. Rinse thoroughly with water and dry with a soft cloth to prevent water spots.

6.2 Internal Components

The internal brass components are designed for long-term durability. If you experience issues with water flow or temperature control, it may indicate a need for professional inspection or cartridge replacement. Consult a qualified plumber for internal maintenance.

7. TROUBLESHOOTING

This section addresses common issues you might encounter with your shower valve.

7.1 No Water Flow or Incorrect Outlet

- **Check Diverter Position:** Ensure the diverter knob is fully engaged in the desired outlet position.
- **Verify Plumbing:** Confirm that the hot and cold water inlets and the three outlets are plumbed correctly according to the installation diagrams. Incorrect plumbing can lead to unexpected water flow from outlets.
- **Water Supply:** Ensure the main water supply to your home and the shower is turned on.

7.2 Temperature Fluctuations

- **Pressure Balancing:** The valve is designed to minimize fluctuations. If severe fluctuations occur, it may indicate an issue with the pressure balancing cartridge or significant changes in household water pressure beyond the valve's compensation range.
- **Water Heater:** Ensure your water heater is functioning correctly and providing a consistent hot water supply.

7.3 Leaks

- **Connection Points:** Check all plumbing connections for tightness. Do not overtighten.
- **Internal Leak:** If leaks persist from within the valve body, the internal cartridge may need inspection or replacement. Contact a qualified plumber.

8. SPECIFICATIONS

Specification	Detail
Brand	Backnets
Model Number	TS-ZY-002
Material	Brass
Exterior Finish	Brushed Nickel

Inlet Connection Type	Compression (Male NPT 1/2)
Outlet Connection Type	Compression (Male NPT 1/2)
Number of Ports	3
Item Weight	5.19 pounds
Package Dimensions	9.53 x 8.46 x 7.24 inches
Date First Available	March 29, 2023

9. WARRANTY AND SUPPORT

Specific warranty details for the Backnets TS-ZY-002 Pressure Balancing Shower Diverter Mixing Valve are not provided in the product information. For warranty claims, technical support, or replacement parts, please contact Backnets customer service directly through their official channels or the retailer where the product was purchased.

Manufacturer: Backnets

For further assistance, please visit the [Backnets Store on Amazon](#).