

Ciays CIPS07W-5

Ciays Automatic Pet Feeder (Model CIPS07W-5) Instruction Manual

1. PRODUCT OVERVIEW

The Ciays Automatic Pet Feeder (Model CIPS07W-5) is designed to provide scheduled and portion-controlled meals for your pets. This feeder helps establish consistent feeding routines, supports weight management, and offers convenience for pet owners. It features a 5.6-liter capacity, allowing for multiple days of feeding, and includes a voice recording function to call your pet to meals.

Hey, I'm Luna. I love this chef!
It always serves on time.



4 Meals



20 Portions



Health



Image 1.1: Ciays Automatic Pet Feeder in use, highlighting its core functionalities.

Key Features:

- **Personalized Feeding Schedules:** Program up to 4 meals per day with adjustable portions (1-20 portions, approximately 5g per portion).
- **Kibble Compatibility:** Suitable for dry pet food sizes between 2mm and 10mm.
- **Dual Power Supply:** Operates via AC adapter or 3 D-cell batteries (not included) for up to 45 days of backup power.
- **Voice Recorder:** Record a 10-second personalized message to alert your pet at meal times.
- **Secure Design:** Features a lid-locking mechanism to prevent pets from accessing food.
- **Easy Cleaning:** Includes a dishwasher-safe stainless steel food bowl.
- **Transparent Food Container:** Allows for easy monitoring of food levels.

2. PRODUCT COMPONENTS

Before setting up your feeder, ensure all components are present and undamaged. The package should contain the following items:

- Automatic Pet Feeder Unit
- Stainless Steel Food Bowl
- AC Power Adapter
- USB Power Cable
- Desiccant Packet
- User Manual (this document)

Clumsy Proof

Secure lid-locking design to prevent pets and knock overs from freeing food.

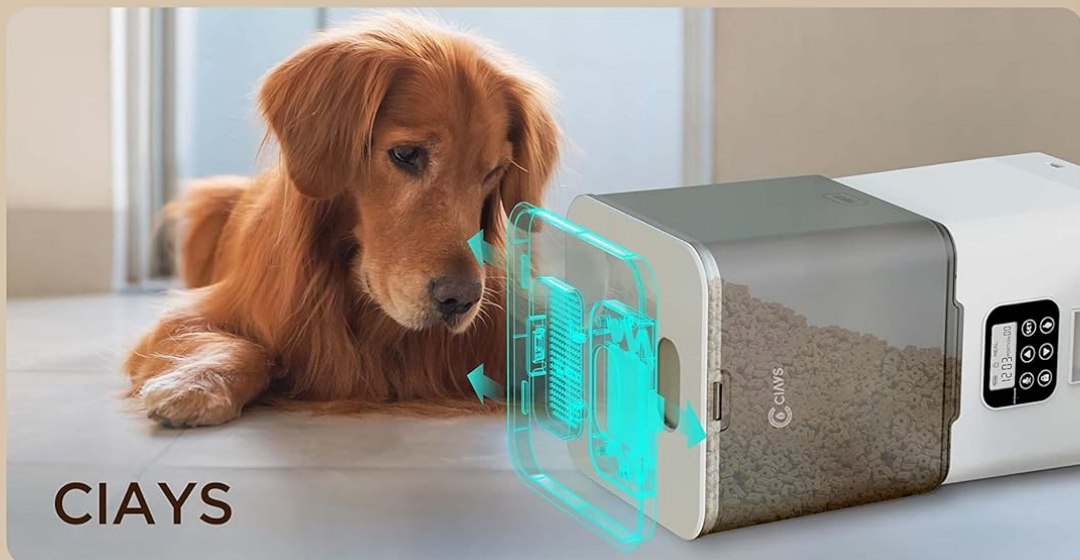

Image 2.1: Contents of the Ciays Automatic Pet Feeder package.

3. SETUP INSTRUCTIONS

3.1 Unpacking and Assembly

1. Carefully remove all components from the packaging.
2. Place the main feeder unit on a flat, stable surface.
3. Attach the stainless steel food bowl to the designated slot at the base of the feeder. Ensure it is securely seated.

3.2 Powering the Feeder

The feeder can be powered by an AC adapter or D-cell batteries for backup.

1. **AC Power:** Connect the USB power cable to the feeder's power port and plug the AC adapter into a standard wall outlet.
2. **Battery Backup (Optional):** For backup power during outages, open the battery compartment at the bottom of the feeder and insert 3 D-cell batteries (not included), ensuring correct polarity. The feeder will automatically switch to battery power if AC power is interrupted.



Image 3.1: Illustration of the feeder's backup power mode.

3.3 Filling the Food Hopper

1. Open the lid of the food hopper. The lid features a secure locking design.
2. Pour dry pet food into the hopper. Ensure the kibble size is between 2mm and 10mm to prevent dispensing issues.
3. Close the lid securely until it clicks into place.
4. Insert the desiccant packet into its designated slot under the lid to help keep food fresh.

4. OPERATING INSTRUCTIONS

4.1 Control Panel Overview

The control panel is located on the front of the feeder. It consists of a display screen and several buttons for programming and manual control.



Image 4.1: Control Panel.

- **SET Button:** Enters programming mode and confirms settings.
- **UP/DOWN Buttons:** Adjust values (time, portions, meal numbers).
- **Record Button (Microphone Icon):** Records and plays voice messages.
- **Manual Feed Button (Paw Icon):** Dispenses one portion manually.
- **Lock Button (Padlock Icon):** Locks/unlocks the control panel.

4.2 Setting Current Time

1. Press and hold the **SET** button for 3 seconds until the hour digit flashes.
2. Use the **UP/DOWN** buttons to adjust the hour.
3. Press **SET** to confirm the hour and move to the minute setting.
4. Use the **UP/DOWN** buttons to adjust the minute.
5. Press **SET** to save the current time.

4.3 Programming Meal Schedules

The feeder supports up to 4 meals per day.

1. Press the **SET** button once to enter meal programming mode. The display will show "Meal 1".
2. Use the **UP/DOWN** buttons to select the meal number (1-4) you wish to program.
3. Press **SET**. The hour digit for the selected meal will flash. Adjust the hour using **UP/DOWN** buttons.
4. Press **SET**. The minute digit will flash. Adjust the minute using **UP/DOWN** buttons.
5. Press **SET**. The portion number will flash. Adjust the number of portions (1-20) using **UP/DOWN** buttons.
6. Press **SET** to save the settings for this meal.
7. Repeat steps 2-6 for additional meals. To disable a meal, set its portion to 0.

4.4 Recording a Voice Message

You can record a 10-second voice message that will play at each scheduled meal time.

1. Press and hold the **Record Button (Microphone Icon)** for 3 seconds until you hear a beep.
2. Speak your message clearly into the microphone. The recording will automatically stop after 10 seconds or when you release the button.

3. To play back the recorded message, press the **Record Button** once.

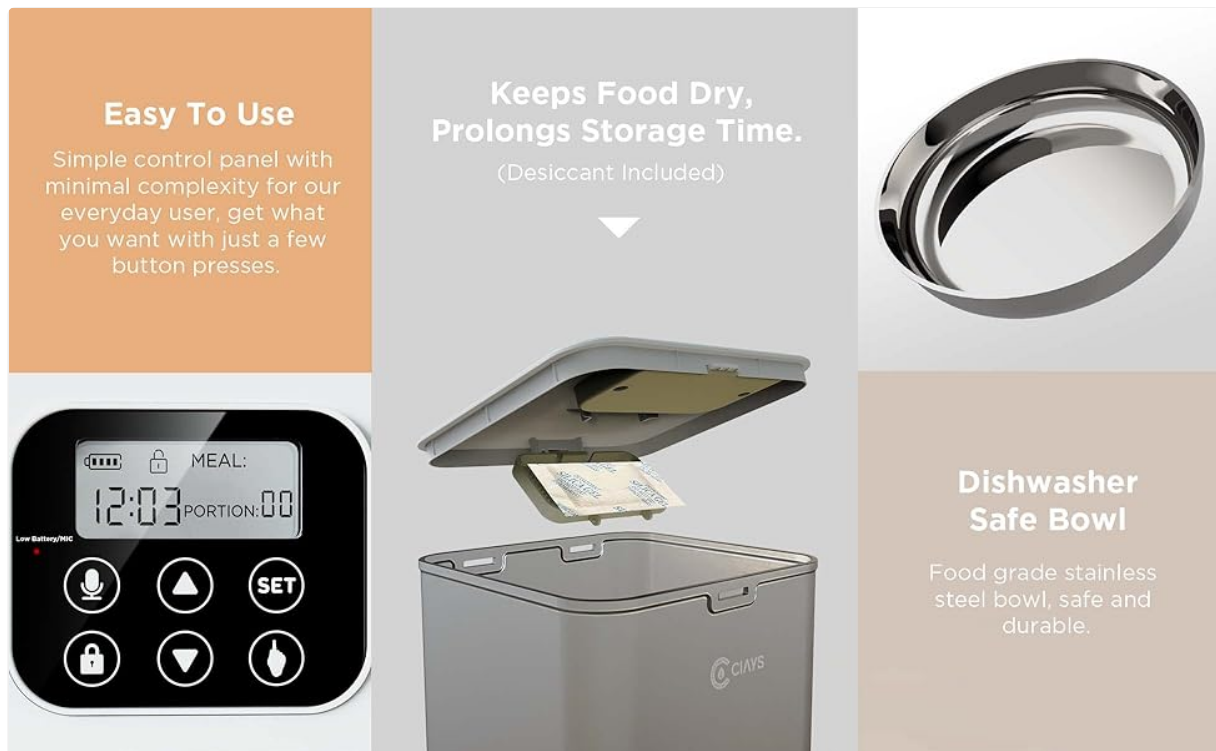

Image 4.2: Using the voice recording feature.

4.5 Manual Feeding

To dispense a single portion of food immediately:

1. Ensure the control panel is unlocked (see section 4.6).
2. Press the **Manual Feed Button (Paw Icon)** once. One portion of food will be dispensed.

4.6 Locking/Unlocking Control Panel

To prevent accidental changes to settings or manual dispensing, the control panel can be locked.

1. To lock the panel, press and hold the **Lock Button (Padlock Icon)** for 3 seconds. A lock icon will appear on the display.
2. To unlock the panel, press and hold the **Lock Button** for 3 seconds again. The lock icon will disappear.

5. MAINTENANCE

5.1 Cleaning the Feeder

Regular cleaning ensures hygiene and proper functioning of the feeder.

- **Stainless Steel Bowl:** The stainless steel food bowl is dishwasher safe for easy cleaning. Alternatively, wash it by hand with mild soap and water, then rinse thoroughly and dry.
- **Main Feeder Unit:** Wipe the exterior of the feeder with a soft, damp cloth. Do not submerge the main unit in water or wash it in a dishwasher, as this can damage electronic components.
- **Food Hopper:** Periodically empty the food hopper and wipe the interior with a dry cloth to remove any food residue.



Image 5.1: Dishwasher-safe stainless steel bowl.

5.2 Refilling Food

Monitor the transparent food container regularly. When the food level is low, refill the hopper following the steps in Section 3.3.

5.3 Desiccant Replacement

The desiccant packet helps keep the dry food fresh. Replace it every 1-2 months, or as needed, especially in humid environments.



Image 5.2: Desiccant packet in the lid compartment.

6. TROUBLESHOOTING

If you encounter issues with your Ciays Automatic Pet Feeder, refer to the following common problems and solutions:

Problem	Possible Cause	Solution
---------	----------------	----------

Problem	Possible Cause	Solution
Feeder not dispensing food.	Food hopper is empty. Kibble size is too large or too small. Food chute is blocked. Control panel is locked.	Refill the food hopper. Ensure kibble size is between 2mm and 10mm. Check and clear any blockages in the chute. Unlock the control panel (Section 4.6).
Lid is difficult to open or close.	Lid mechanism is stiff or misaligned.	Ensure you are pressing the release tab firmly while lifting. Apply gentle, even pressure. Avoid forcing the lid.
Desiccant packet falls into food.	Desiccant compartment latch is not secure.	Ensure the desiccant compartment cover is firmly closed. If the latch is faulty, consider placing the desiccant in a small, breathable pouch directly in the hopper, ensuring it cannot be ingested by pets.
Control panel is unresponsive or display is off.	No power or low battery. Control panel is locked.	Check AC power connection. If using batteries, replace them. Unlock the control panel (Section 4.6).
Voice recording is unclear or not playing.	Microphone obstruction. Recording error.	Ensure the microphone is clear of debris. Re-record the message, speaking clearly and close to the microphone.

7. SPECIFICATIONS

Feature	Detail
Model Number	CIPS07W-5
Capacity	5.6 Liters
Product Dimensions (L x W x H)	16 x 31.8 x 27.9 cm
Item Weight	1.38 kg
Material	BPA-free Plastic, Stainless Steel (bowl)
Operation Mode	Automatic
Power Supply	AC Adapter (USB), 3 x D-cell Batteries (backup, not included)
Number of Meals	Up to 4 per day

Feature	Detail
Portion Control	1-20 portions (approx. 5g per portion)
Kibble Size Recommendation	2mm - 10mm
Voice Recording	10 seconds
Care Instructions	Hand Wash Only (main unit), Dishwasher Safe (stainless steel bowl)
Target Species	Cat, Small to Medium Dogs