

IVY IVY-E13-1

IVY TWS Smart Bluetooth Audio Glasses User Manual

Model: IVY-E13-1

1. INTRODUCTION

Thank you for choosing the IVY TWS Smart Bluetooth Audio Glasses. These glasses combine advanced audio technology with eye protection features, offering a versatile solution for daily use. This manual provides detailed instructions to help you set up, operate, and maintain your smart glasses for optimal performance and longevity.

2. IMPORTANT SAFETY INFORMATION

- Do not expose the glasses to extreme temperatures or humidity.
- Avoid dropping or subjecting the glasses to strong impacts.
- Keep away from water and liquids to prevent damage to electronic components.
- Use only the provided charging cable.
- Do not attempt to disassemble or repair the glasses yourself. Contact customer support for assistance.
- Prolonged exposure to loud audio may cause hearing damage. Adjust volume to a safe level.

3. PACKAGE CONTENTS

Verify that all items are present in your package:

- IVY TWS Smart Bluetooth Audio Glasses (with Blue Light Blocking Lenses installed)
- Polarized Sunglasses Lenses (replacement pair)
- Magnetic Charging Cable
- Cleaning Cloth
- User Manual

Different type of box
The same fashion



149mm



55mm

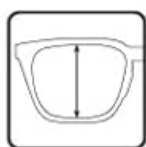

43.7mm



20mm

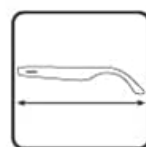

146mm

IVY-03

Anti-blue light tablets/sunglasses (suitable for myopia lenses)



145mm



53mm

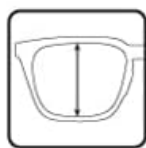

41mm



17mm

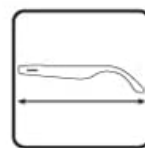

146mm

IVY-04

Anti-blue light tablets/sunglasses (suitable for myopia lenses)

cleaning cloth.

4. SETUP

4.1. Charging the Glasses

Before first use, fully charge your IVY Smart Bluetooth Audio Glasses.

1. Connect the magnetic charging cable to the charging port on the glasses.
2. Connect the other end of the USB cable to a power adapter (not included) or a computer's USB port.
3. The indicator light will show charging status (refer to LED indicator section for details).
4. A full charge typically takes approximately 1-2 hours.

Note: The glasses will automatically shut down when charging to protect the battery.

Select battery long endurance

Built-in 80mAh Seiko protection plate pure cobalt core,
Listening to music for up to five hours, making
voice calls for up to four hours,
Magnetic charging, easy to charge, trigger.

5_h

Listen to music

4_h

Voice call



Image: Close-up of the temple arm of the IVY Smart Bluetooth Audio Glasses, showing the magnetic charging contacts.

4.2. Bluetooth Pairing

Follow these steps to pair your glasses with your smartphone or other Bluetooth-enabled device:

1. Ensure the glasses are charged.
2. Press and hold the touch key (red line on the temple arm) on both sides of the glasses for approximately 5 seconds to power them on and enter pairing mode. You will hear an audible prompt.
3. On your smartphone, go to Bluetooth settings and enable Bluetooth.
4. Search for available devices and select "Glasses-E13" (or similar) from the list.
5. Once connected, you will hear a confirmation sound.

Note: If the glasses are not connected to a mobile phone within 5 minutes, they will automatically shut down to conserve battery.

Your browser does not support the video tag.

Video: Demonstrates the power-on and Bluetooth pairing process for the IVY TWS Smart Bluetooth Audio Glasses with a smartphone.

5. OPERATING INSTRUCTIONS

The IVY Smart Bluetooth Audio Glasses feature touch-enabled controls on the temple arms. The red line on each temple arm indicates the touch sensor area.

5.1. Basic Controls

- **Power On/Off:** Long press the touch key on both sides for 5 seconds.
- **Play/Pause Music:** Single-click the touch key on either the left or right temple arm.
- **Next Track:** Double-click the touch key on the right temple arm.
- **Previous Track:** Double-click the touch key on the left temple arm.
- **Answer/End Call:** Single-click the touch key on either temple arm during an incoming call.
- **Reject Call:** Long press the touch key on either temple arm during an incoming call.
- **Activate Voice Assistant (Siri, Google Assistant, Cortana):** Long press the touch key on the left temple arm for 2 seconds.
- **Phone Selfie Function:** Double-click the touch key on the right temple arm (may require specific app support).

Intelligent manipulation is at a hair trigger

The mirror leg is equipped with a touch sensor,
which can be completed with a gentle touch
Answer the phone, play music, play games,
connect the wheat and other commands.

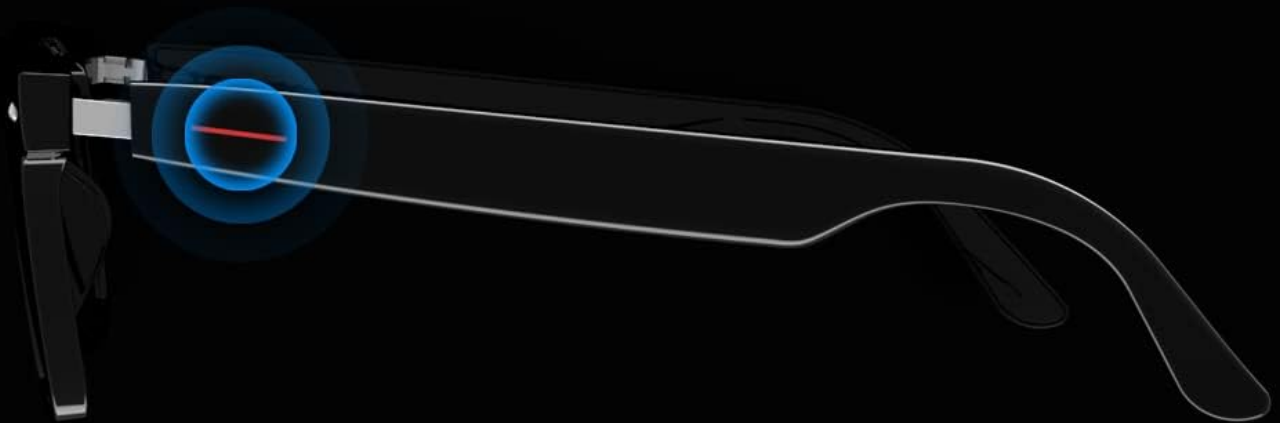

click
Play/pause



Long press 2s
Wake up voice assistant



Double click
Remote photography



Double click
Last song/next song



Long press 5s
Switching machine



Single-phone answering
Long press to hang up

Image: Diagram illustrating the touch control functions on the temple arms of the IVY Smart Bluetooth Audio Glasses, including play/pause, next/previous song, voice assistant activation, and call management.

5.2. Audio Quality and Microphone

The glasses feature a high-sensitivity, noise-canceling microphone for clear calls and custom oversized voice units for immersive stereo sound. While designed for personal listening, sound may be audible to others in quiet environments at higher volumes.

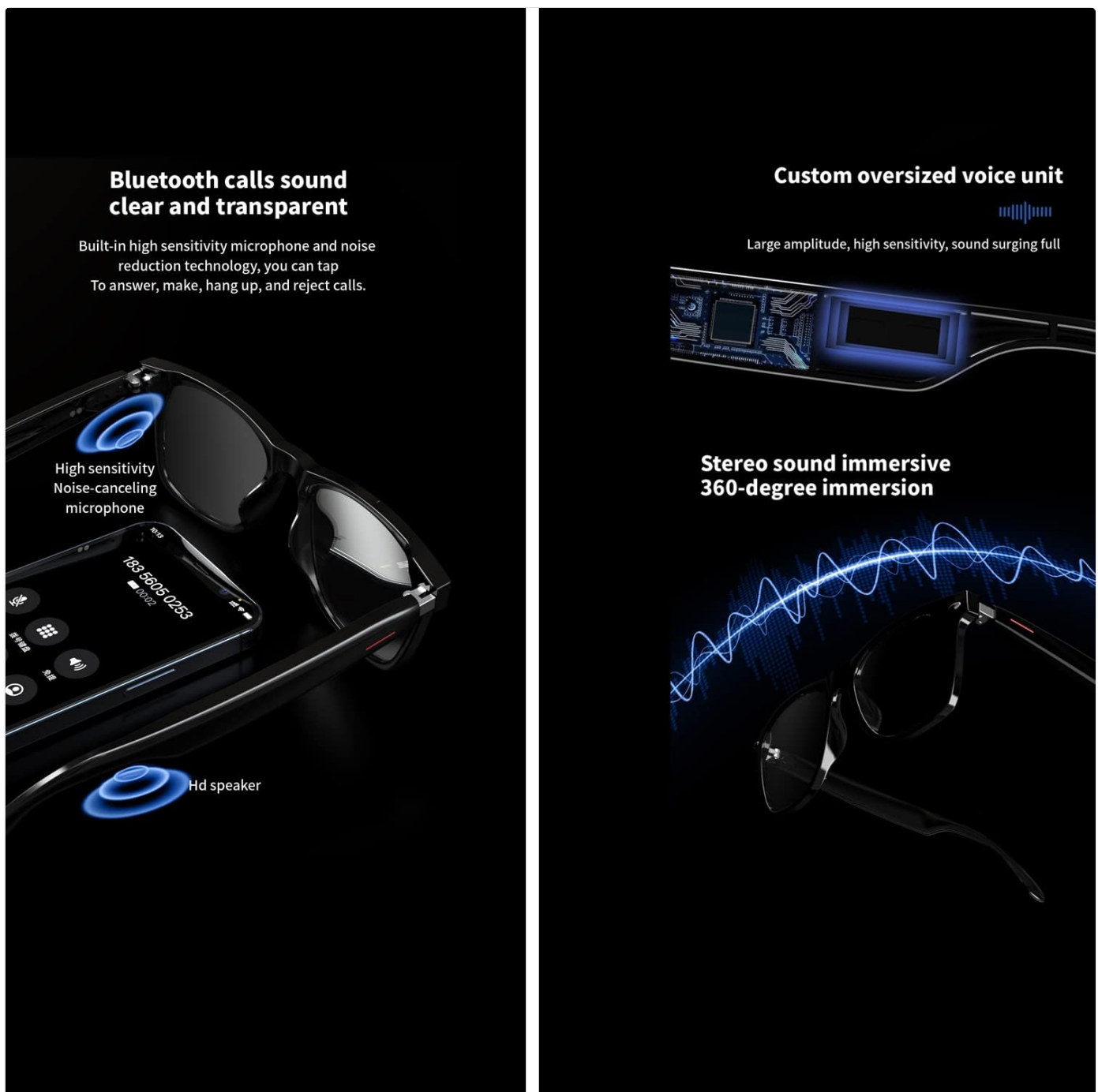

Image: Visual representation of the audio features of the IVY Smart Bluetooth Audio Glasses, highlighting the high-sensitivity microphone and stereo sound immersion.

6. LENS REPLACEMENT

Your IVY Smart Bluetooth Audio Glasses come with pre-installed blue light blocking lenses and an additional pair of polarized sunglasses lenses. You can switch between them as needed.

1. Gently push the existing lens out from the front of the frame.
2. Align the new lens with the frame groove.
3. Carefully press the new lens into place until it clicks securely.
4. Repeat for the other lens.

Your browser does not support the video tag.

Video: Step-by-step demonstration of how to replace the lenses on the IVY Smart Bluetooth Audio Glasses.

7. MAINTENANCE AND CARE

- Clean lenses with the provided cleaning cloth or a soft, lint-free cloth. Avoid abrasive materials.
- For stubborn smudges, use a lens cleaning spray specifically designed for eyewear.
- Store the glasses in their protective case when not in use to prevent scratches and damage.
- Avoid prolonged exposure to direct sunlight or high temperatures, which can damage the battery and frame.

8. TROUBLESHOOTING

Problem	Possible Solution
Glasses won't turn on.	Ensure the battery is charged. Connect to the charger and try again.
Cannot pair with device.	Make sure Bluetooth is enabled on your device. Ensure the glasses are in pairing mode (indicator light flashing). Move the glasses closer to your device. Forget the device in your phone's Bluetooth settings and try pairing again.
No sound or low sound.	Check the volume level on both the glasses and your connected device. Ensure the glasses are properly connected via Bluetooth. Restart both the glasses and your device.
Touch controls are unresponsive.	Ensure your fingers are clean and dry. Try restarting the glasses.

9. SPECIFICATIONS

Feature	Detail
Model Number	IVY-E13-1
Connectivity	Bluetooth
Lens Types	Blue Light Blocking, Polarized Sunglasses (interchangeable)
Battery Type	Lithium Polymer (included)
Battery Capacity	80mAh (estimated, based on 5h music/4h call)
Music Playback Time	Up to 5 hours
Voice Call Time	Up to 4 hours
Charging Method	Magnetic Charging
Product Dimensions	7.09 x 2.36 x 2.36 inches
Item Weight	5.6 ounces

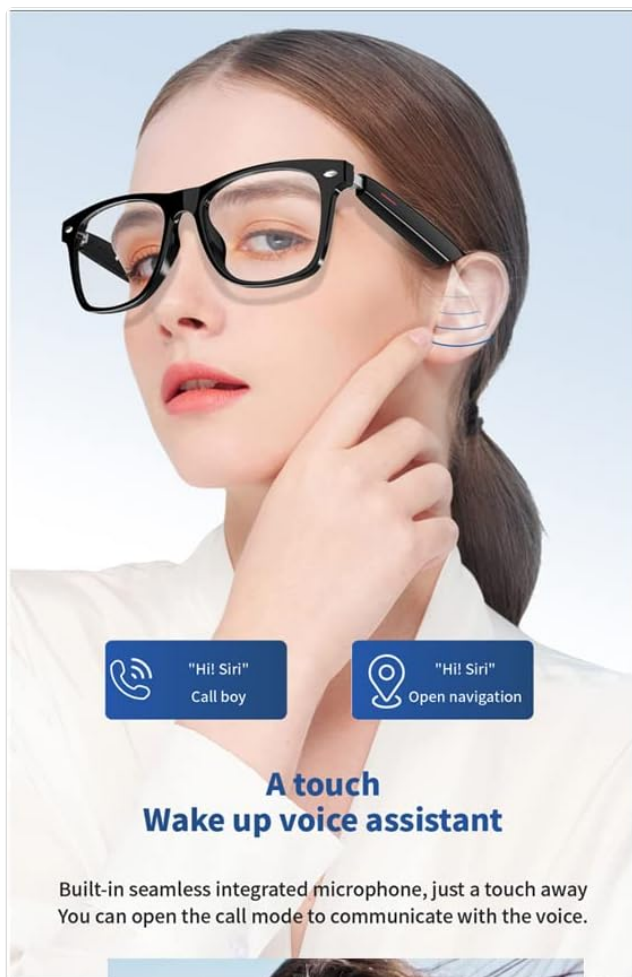

Comfortable and light without feeling

Selected materials, excellent optics, comfortable to wear.



Image: Diagram illustrating the battery endurance of the IVY Smart Bluetooth Audio Glasses, showing up to 5 hours for music and 4 hours for voice calls.

10. WARRANTY AND SUPPORT

IVY products are designed and manufactured to the highest quality standards. For warranty information, technical support, or customer service inquiries, please refer to the contact details provided on the product packaging or visit the official IVY website. Please retain your proof of purchase for warranty claims.

