



Manuals.plus /

- › BANTI /
- › BANTI 55"x24" Electric Standing Desk User Manual

BANTI B-STDJ-55WE

BANTI 55"x24" Electric Standing Desk User Manual

Model: B-STDJ-55WE | Brand: BANTI

INTRODUCTION

This manual provides comprehensive instructions for the assembly, operation, maintenance, and troubleshooting of your BANTI 55"x24" Electric Standing Desk. Please read this manual thoroughly before assembly and use to ensure proper function and safety.

The BANTI height adjustable electric standing desk is designed to enhance your working style by allowing seamless transitions between sitting and standing positions. This feature helps alleviate neck, shoulder, and back pain associated with prolonged sitting.

SAFETY INFORMATION

WARNING: This product has a maximum weight recommendation of 155 pounds. Improper use may lead to potential injuries. Assembly is required.

- Ensure all components are securely fastened before use.
- Keep children and pets away from the desk during operation.
- Do not place liquids directly on the control panel or motor components.
- Avoid placing hands or objects near moving parts during height adjustment.

PACKAGE CONTENTS

Please verify that all components are present before beginning assembly.

- Desktop (55" x 23.6")
- Electric Lifting Columns (Legs)
- Control Panel
- Power Adapter and Cables
- Assembly Hardware (screws, bolts, etc.)
- Assembly Tools

- Accessories: 1 normal hook, 2 bundle clamps, 1 cup holder

SETUP AND ASSEMBLY

Assembly steps have been optimized for convenience. A detailed instruction manual and necessary tools are included in the package.

1. **Unpack Components:** Carefully remove all parts from the packaging and lay them out on a clean, flat surface. Verify all parts against the package contents list.
2. **Attach Lifting Columns:** Secure the electric lifting columns to the desktop using the provided screws and tools. Ensure they are aligned correctly.
3. **Install Control Panel:** Mount the multi-function intelligent keypad to the underside of the desk in an easily accessible location.
4. **Connect Power:** Connect the power adapter and cables to the control panel and motor, then plug into a suitable power outlet.
5. **Attach Accessories:** Install the cup holder, storage hook, and bundle clamps as desired.



Figure 1: Fully assembled BANTI Electric Standing Desk with accessories.

This image shows the BANTI Electric Standing Desk in a typical office setup, highlighting its spacious desktop and integrated accessories like the cup holder and headphone hook.

OPERATING INSTRUCTIONS

Your BANTI Electric Standing Desk features an intuitive control panel for easy height adjustment and memory presets.

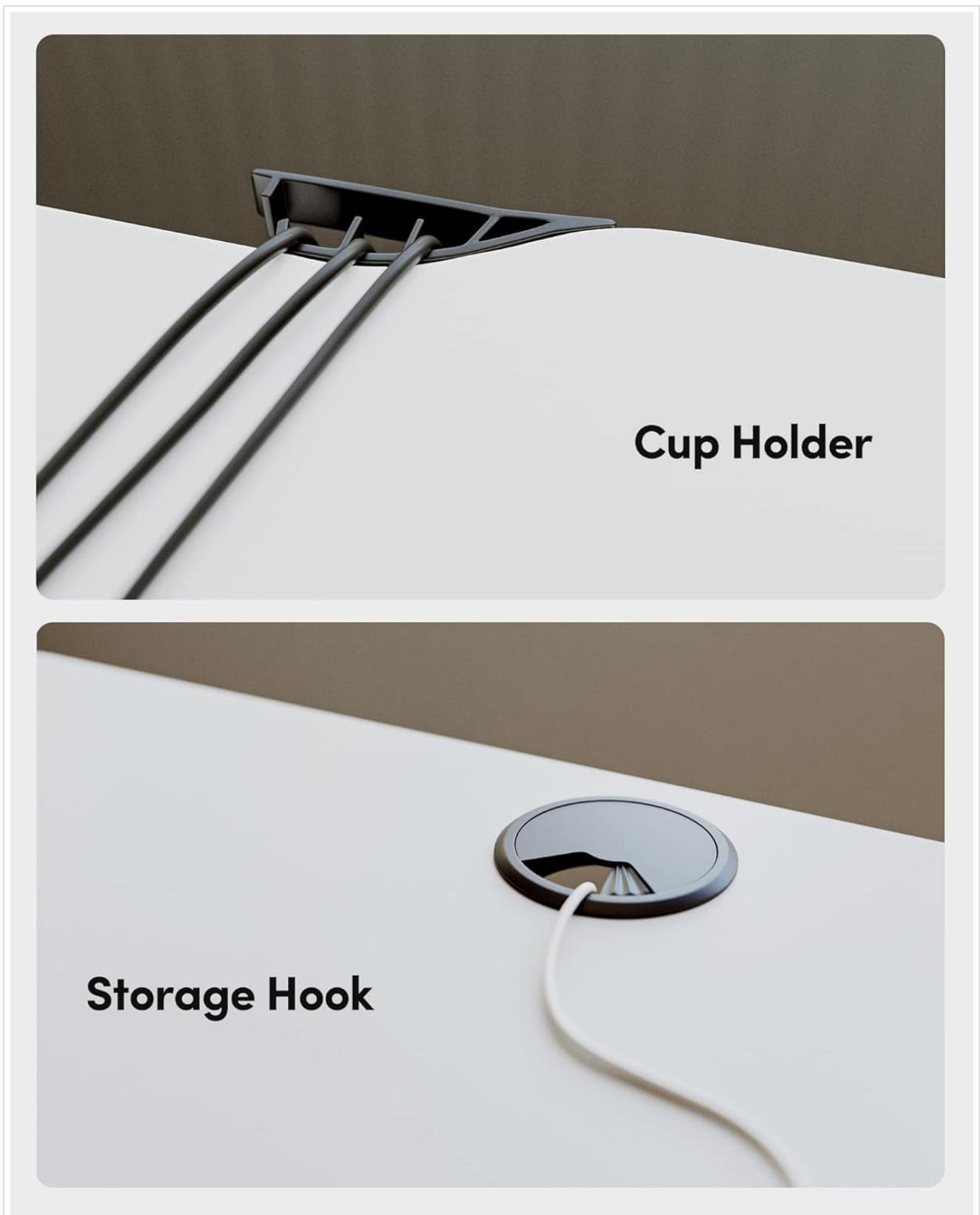

Figure 2: Multi-Function Intelligent Keypad.

The control panel allows for precise height adjustments and includes memory functions for convenience.

Control Panel Functions:

- **Up Button (▲):** Press and hold to raise the desk height.
- **Down Button (▼):** Press and hold to lower the desk height.
- **Standing Height Setting ():** Press to move the desk to your pre-set standing height.
- **Sitting Height Setting ():** Press to move the desk to your pre-set sitting height.
- **Reset Button (⌂):** Used for resetting the desk or clearing memory presets. Consult troubleshooting for

specific reset procedures.

Setting Memory Presets:

1. Adjust the desk to your desired sitting height using the Up/Down buttons.
2. Press and hold the "Sitting Height Setting" button until the display flashes or you hear a beep, indicating the height is saved.
3. Repeat the process for your desired standing height using the "Standing Height Setting" button.



Figure 3: Adjustable Height Range.

The desk offers a height range from 28.3 inches to 46.2 inches, accommodating various user preferences.



Figure 4: Quiet Operation.

The desk operates with minimal noise, ensuring a quiet working environment (less than 50dB).

Integrated Accessories:

- **Cup Holder:** Conveniently located for beverages, preventing spills on the desktop.
- **Storage Hook:** Ideal for hanging headphones or bags, keeping your workspace tidy.
- **Bundle Clamps:** For effective cable management, helping to organize power cords and peripheral cables.

Advanced Desk Frame Design

For the perfect ergonomic position



Figure 5: Desk Accessories.

The desk includes practical accessories like a cup holder and a storage hook for enhanced usability.

MAINTENANCE

Proper maintenance ensures the longevity and optimal performance of your standing desk.

- **Cleaning:** Wipe the desk surface with a dry cloth. Avoid abrasive cleaners or harsh chemicals.
- **Cable Management:** Periodically check and organize cables to prevent tangling or damage during height adjustments.

- **Weight Limit:** Do not exceed the maximum weight recommendation of 155 pounds to prevent damage to the motor and frame.

TROUBLESHOOTING

If you encounter any issues with your BANTI Electric Standing Desk, please refer to the following common solutions:

Problem	Possible Cause	Solution
Desk not moving.	Power cable disconnected; Overload; Motor error.	Check power connections. Reduce weight on desk. Perform a reset (press and hold reset button for 5 seconds).
Uneven height adjustment.	Obstruction; Unbalanced load.	Clear any obstructions. Redistribute weight evenly on the desktop.
Memory presets not working.	Presets not saved correctly.	Re-save the memory presets following the operating instructions.

If issues persist, please contact BANTI customer support.

SPECIFICATIONS

Feature	Detail
Brand	BANTI
Model Number	B-STDJ-55WE
Product Dimensions	23.6"D x 55"W x 28.3"H
Color	White
Height Adjustment Range	28.3" to 46.2"
Maximum Weight Recommendation	155 Pounds
Base Material	Alloy Steel
Top Material Type	Alloy Steel
Special Features	Adjustable Height, Ergonomic, Electric, Home Office
Noise Level	<50dB
Assembly Required	Yes (Recommended 1 person)
Included Components	Headphone Hook, Cup Holder

Reliable & Durable

Lifting tested 50,000 times

132 LBS Load Capacity

50,000



Figure 6: Reliability and Durability.

The desk is tested for durability, with a lifting capacity of 132 lbs and tested over 50,000 times for reliable performance.

WARRANTY AND SUPPORT

BANTI provides the following warranty for your electric standing desk:

- **Motor:** 2 years warranty.
- **Frame:** 5 years warranty.

For any questions, warranty concerns, or technical support during assembly and use, please do not hesitate to contact BANTI customer service. Refer to the contact information provided with your purchase or visit the official BANTI website.

You can also find additional information and support at the [BANTI Store on Amazon](#).