

manuals.plus /

› [LOKITHOR](#) /

› [LOKITHOR J1000 Jump Starter User Manual](#)

## LOKITHOR J1000

# LOKITHOR J1000 Jump Starter User Manual

Model: J1000

### 1. PRODUCT OVERVIEW

The LOKITHOR J1000 is a powerful and compact 12V jump starter designed for emergency vehicle starting. It features advanced LiFePO4 battery technology, ensuring safety and extended lifespan. This device is capable of delivering 1000A starting current, suitable for gasoline engines up to 6.0L and diesel engines up to 3.0L. It also functions as a portable power bank with 60W two-way fast charging capabilities.



Image 1.1: The LOKITHOR J1000 Jump Starter in use, connected to a car battery. The display shows battery voltage and status.

### Key Features:

- **High Performance:** 1000A starting current for up to 6.0L gas and 3.0L diesel engines.
- **LiFePO4 Battery:** Utilizes Lithium Iron Phosphate technology for enhanced safety, stability, and a longer cycle life (2000 cycles).
- **Smart Technology:** Integrated BMS (Battery Management System) provides 10 types of protection, including spark-proof, mistake-proof, and reverse-polarity protection.
- **Fast Charging:** 60W two-way fast charging allows a full charge in approximately 25 minutes, and a 3-minute charge can provide enough power for a jump start.
- **Durable Design:** IP65 water-resistant and 94V0 flame retardant enclosure for robust performance in various conditions.
- **Long Standby Time:** Maintains charge for up to 24 months on a single full charge.

## 2. WHAT'S IN THE BOX

Upon opening the package, please ensure all the following items are present:

- LOKITHOR J1000 Portable Lithium Car Battery Jump Starter Unit
- LO-CLAMP-Pro (Smart Jumper Cables)
- 12V Car Adapter
- User Manual
- USB-C to USB-C Cable
- USB-A to USB-C Cable



Image 2.1: A visual representation of all items included in the LOKITHOR J1000 Jump Starter package, including the main unit, jumper cables, cables, and adapter.

## 3. SETUP AND CHARGING

### 3.1 Initial Charge

Before first use, fully charge the LOKITHOR J1000. The device comes with a partial charge, but a full charge ensures optimal performance and readiness for emergencies.

### 3.2 Charging the J1000

The J1000 supports 60W two-way fast charging via its USB-C port. Use the provided USB-C to USB-C cable and a compatible 60W (or higher) USB-C power adapter (not included) for the fastest charging. Alternatively, you can use the 12V car adapter.

1. Connect one end of the USB-C cable to the J1000's USB-C input/output port.
2. Connect the other end of the USB-C cable to a suitable power source (e.g., wall adapter, car adapter).
3. The display will indicate charging status. A full charge typically takes about 25 minutes with a 60W charger.

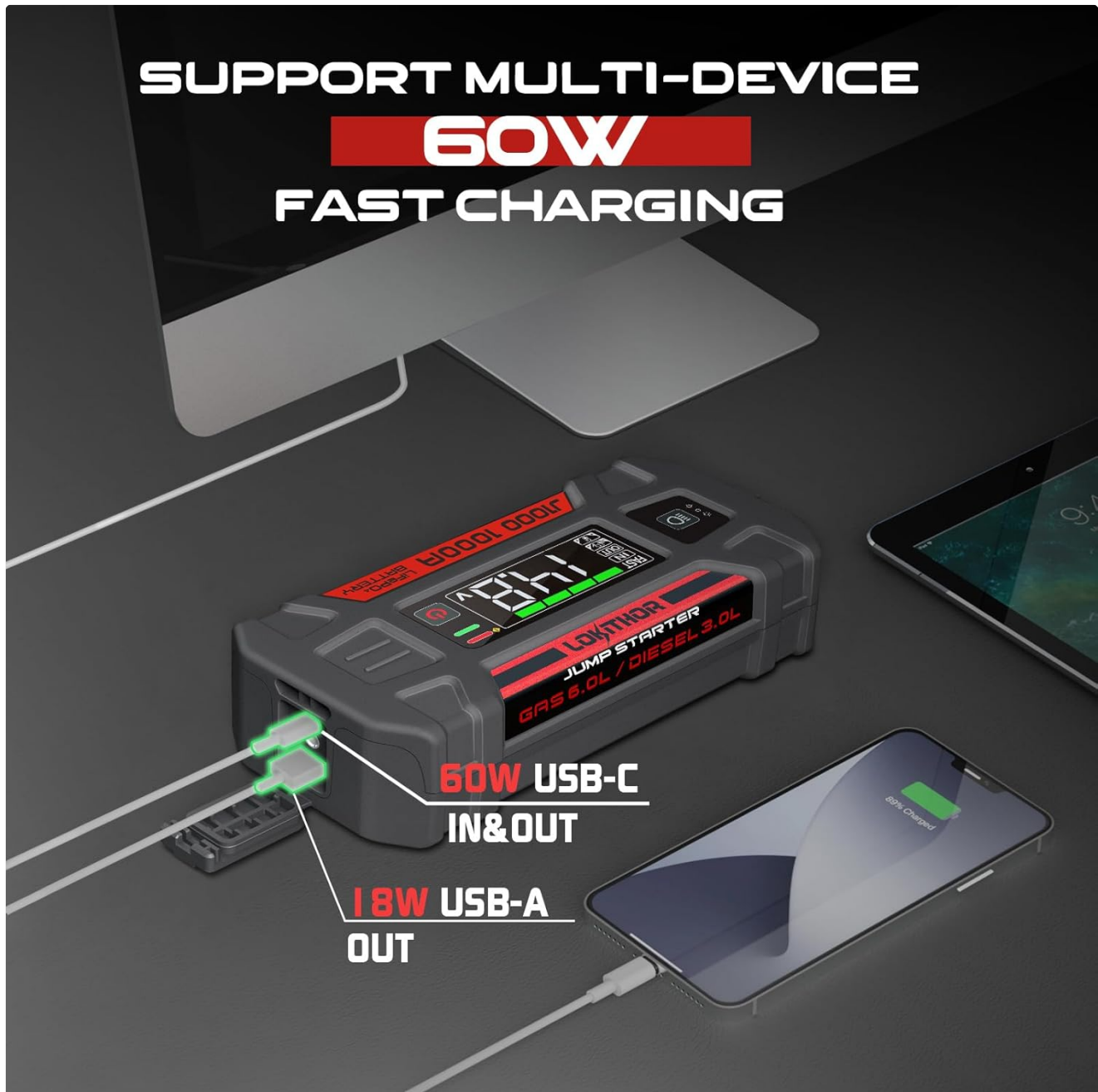

Image 3.1: The LOKITHOR J1000 Jump Starter connected via its USB-C port for 60W fast charging, demonstrating its power bank capabilities for other devices.

## 4. OPERATING INSTRUCTIONS

### 4.1 Jump Starting a Vehicle (Normal Start)

Use this method when the vehicle battery voltage is above 8V.

1. Ensure the J1000 is sufficiently charged.
2. Connect the LO-CLAMP-Pro jumper cable harness into the jump starter's port.

3. Attach the red clamp to the positive (+) terminal of the vehicle battery.
4. Attach the black clamp to the negative (-) terminal of the vehicle battery.
5. Observe the J1000's display. Wait for the green light indicator to come on and start flashing, indicating it's ready to start.
6. Start your vehicle.
7. Once the vehicle starts, immediately remove the jumper cables from the vehicle battery, then disconnect them from the J1000.

## 4.2 Jump Starting a Vehicle (Force Start)

Use this method when the vehicle battery voltage is below 8V or if the normal start fails.

1. Ensure the J1000 is sufficiently charged.
2. Connect the LO-CLAMP-Pro jumper cable harness into the jump starter's port.
3. Attach the red clamp to the positive (+) terminal of the vehicle battery.
4. Attach the black clamp to the negative (-) terminal of the vehicle battery.
5. Long press the Power Button and the LED Button simultaneously on the J1000. The display will show a specific indicator for force start mode.
6. Start your vehicle within 30 seconds.
7. Once the vehicle starts, immediately remove the jumper cables from the vehicle battery, then disconnect them from the J1000.

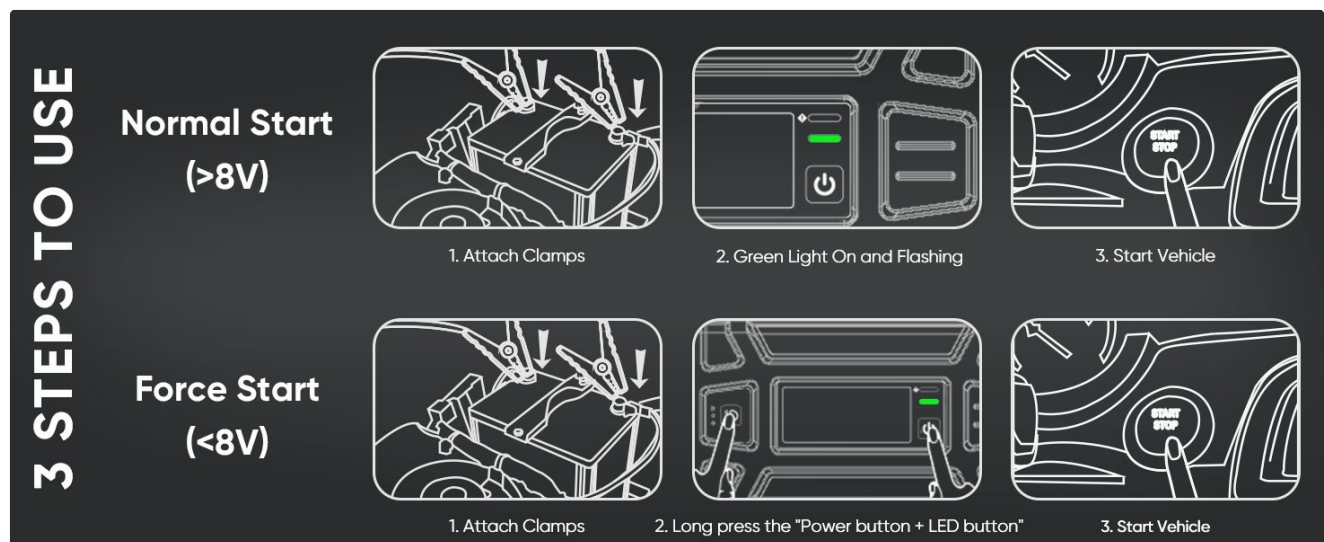

Image 4.1: A visual guide illustrating the three steps for both Normal Start (for batteries above 8V) and Force Start (for batteries below 8V) using the LOKITHOR J1000.

## 4.3 Using as a Power Bank

The J1000 can charge various electronic devices via its USB-A (18W output) and USB-C (60W two-way) ports.

1. Connect your device to the appropriate USB-A or USB-C port on the J1000 using a compatible charging cable.
2. The J1000 will automatically begin charging your device.

## 4.4 LED Flashlight Function

The J1000 includes an integrated LED flashlight with multiple modes.

- Press the LED button once to turn on the flashlight.
- Press again to cycle through modes: Flashlight, Strobe, SOS.
- Press and hold the LED button to turn off the flashlight.



## 5. SAFETY INFORMATION AND PROTECTIONS

---

The LOKITHOR J1000 is equipped with multiple safety features to protect both the user and the vehicle.

- **LiFePO4 Battery:** Inherently safer and more stable than traditional lithium-ion batteries.
- **Smart BMS:** The intelligent Battery Management System provides comprehensive protection.
- **10 Types of Protection:** Includes Over Voltage, Over Current, Over Load, High-Temp & Low-Temp, Short Circuit, Spark-Proof, Reverse-Charge, Over Charge, and Reverse-Polarity Protection.
- **IP65 Water-Resistant:** Provides protection against dust and low-pressure water jets.
- **94V0 Flame Retardant:** The enclosure material meets high standards for flame resistance.



Image 5.1: A visual breakdown of the 9 types of safety protection integrated into the LOKITHOR J1000's Smart BMS system, including over-voltage, over-current, and reverse-polarity protection.

## 6. MAINTENANCE AND STORAGE

---

### 6.1 General Maintenance

- Keep the device clean and dry. Wipe with a soft, damp cloth if necessary.
- Do not use harsh chemicals or abrasive cleaners.
- Regularly inspect cables and clamps for any damage. Replace if worn or damaged.

## 6.2 Storage

The J1000 has an impressive standby time of up to 24 months on a single full charge, making it ideal for long-term storage.

- Store the jump starter in a cool, dry place away from direct sunlight and extreme temperatures.
- Ensure the device is fully charged before storing for extended periods to maximize battery life.
- Periodically check the charge level, especially if stored for more than 6-12 months, and recharge if necessary.



Image 6.1: A graphic illustrating the LOKITHOR J1000's ability to maintain a charge for up to 24 months in standby mode, highlighting its low self-discharge rate.

## 7. TROUBLESHOOTING

If you encounter issues with your LOKITHOR J1000, refer to the following common problems and solutions:



Problem	Possible Cause	Solution
Device does not turn on.	Battery is completely discharged.	Charge the J1000 fully before use.
Vehicle does not start (Normal Start).	Vehicle battery voltage is too low (<8V) or connection issue.	Try the Force Start method. Ensure clamps are securely connected to the correct battery terminals.
Green light on display is not flashing.	Incorrect connection or battery voltage too low.	Check clamp connections. If battery is very low, use Force Start.
Device is not charging other devices.	J1000 battery is low or cable is faulty.	Ensure J1000 is charged. Try a different USB cable.
Abnormal Temperature Indicator (on display).	Device is too hot or too cold.	Allow the device to return to a safe operating temperature range (typically 0°C to 45°C or 32°F to 113°F).

For issues not listed here, please contact LOKITHOR customer service.

## 8. TECHNICAL SPECIFICATIONS

Feature	Specification
Model	J1000
Starting Current	1000 Amps
Peak Output Current	2000 Amps
Battery Type	LiFePO4 (Lithium Iron Phosphate)
Battery Capacity	8000 mAh
Voltage	12 Volts
Engine Compatibility	Up to 6.0L Gas, 3.0L Diesel
Charging Input	USB-C (60W Two-Way Fast Charging)
USB Output	USB-A (18W), USB-C (60W Two-Way)
Water Resistance Rating	IP65
Flame Retardant Rating	94V0
Item Weight	2.01 pounds (approx. 910 grams)
Product Dimensions	9.46 x 4.19 x 2.36 inches

## 9. WARRANTY AND CUSTOMER SUPPORT

### 9.1 Warranty Information



The LOKITHOR J1000 Jump Starter comes with a 12-month limited warranty from the date of purchase. This warranty covers manufacturing defects and workmanship under normal use. It does not cover damage caused by misuse, accidents, unauthorized modifications, or natural disasters.

## **9.2 Customer Service**

For any questions, technical support, or warranty claims, please contact LOKITHOR customer service. Our support team is available 24/7 to assist you.

Please refer to the contact information provided on the LOKITHOR official website or your purchase documentation for the most up-to-date support channels.