

Master Airbrush MAS TC-51

Master Airbrush Cordless Airbrushing System Instruction Manual

Model: MAS TC-51

Brand: Master Airbrush

INTRODUCTION

This manual provides comprehensive instructions for the safe and effective operation and maintenance of your Master Airbrush Cordless Airbrushing System. Please read this manual thoroughly before use to ensure optimal performance and longevity of your equipment.

The Master Airbrush Cordless Airbrushing System is a portable and powerful tool designed for various applications, including hobbies, crafts, auto graphics, makeup, temporary tattoos, cake decorating, model painting, fine art, and nail art. It features a precision dual-action airbrush with a 0.4mm tip and a rechargeable air compressor with four airflow speed settings.

SAFETY INFORMATION

Observe the following safety precautions to prevent injury or damage to the product:

- Always operate the airbrush in a well-ventilated area.
- Wear appropriate personal protective equipment, such as a respirator mask and safety glasses, when spraying paints or chemicals.
- Keep the airbrush system away from children and pets.
- Do not immerse the compressor unit in water or other liquids.
- Use only the provided charging cable and a compatible 2A or 3A fast charger.
- Avoid spraying flammable materials near open flames or ignition sources.
- Disconnect the power source before cleaning or performing maintenance.
- Do not modify the airbrush or compressor in any way.

PACKAGE CONTENTS

Verify that all items are present in your package:

- Cordless Air Compressor
- Precision Dual-Action Airbrush with 0.4mm tip
- 5 Screw-on Gravity Feed Cups (2cc, 6cc, 7cc Metal, 12cc, 24cc)
- 4-foot Air Hose
- Airbrush Holder
- Wrench
- Eyedropper
- 5 Cleaning Brushes
- 4 O-Rings
- USB-C Charging Cable
- Instruction Manual



Image: All components of the Master Airbrush Cordless Airbrushing System Kit, including the compressor, airbrush, various cups, hose, cleaning tools, and charging cable.

ACCESSORIES



Includes: 5 Fluid Cups, Wrench, Eyedropper, 5 Cleaning Brushes, 4 O-Rings & USB-C Cable, 4ft Air Hose



Image: A detailed view of the accessories included with the airbrush system, showing the five fluid cups (2cc, 6cc, 7cc metal, 12cc, 24cc), wrench, eyedropper, cleaning brushes, O-rings, USB-C cable, and 4ft air hose, along with the airbrush holder attached to the compressor.

PRODUCT OVERVIEW

The Master Airbrush Cordless System consists of two primary units: the air compressor and the dual-action airbrush, complemented by various accessories.

Air Compressor

- **Power Button:** Activates and deactivates the compressor.
- **LED Display:** Shows current airflow level (P1-P4) and battery charge status.
- **Airflow Adjustment Button:** Cycles through four airflow speed settings (P1: Low, P2: Medium, P3: High, P4: Extra-High).
- **USB-C Charge Connector:** For recharging the internal Lithium-Ion battery.
- **Airbrush Holder:** Conveniently stores the airbrush when not in use.

Dual-Action Airbrush

- **Trigger:** Controls both air and fluid flow. Pushing down releases air; pulling back releases fluid.
- **Nozzle Cap:** Protects the needle and nozzle.

- **Fluid Cups:** Interchangeable cups for holding paint.
- **Preset Control Knob:** Located at the rear of the airbrush, this knob limits the backward travel of the trigger, allowing for consistent line thickness.
- **Quick Flush Cutaway Handle:** Enables quick access to the needle chucking nut for flushing and cleaning air passages.

DUAL ACTION AIRBRUSH FEATURES

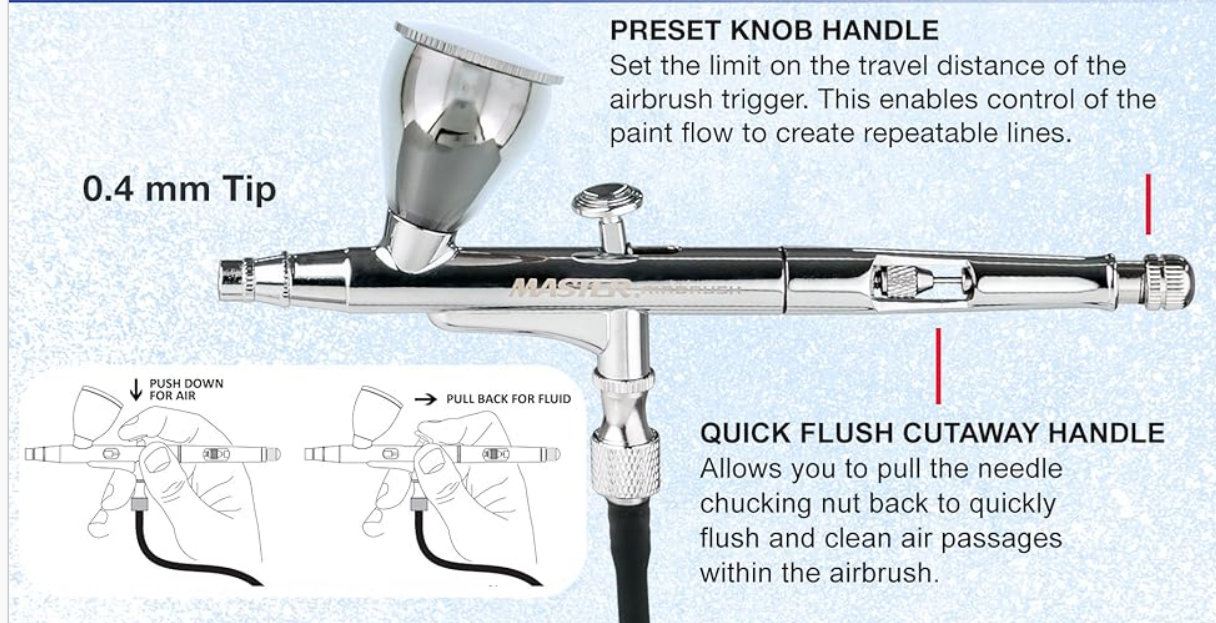

Image: Detailed diagram of the Master Airbrush system, labeling key components of the airbrush and compressor for easy identification and assembly.

DUAL ACTION AIRBRUSH FEATURES

QUICK FLUSH CUTAWAY HANDLE

Allows you to pull the needle chucking nut back to quickly flush and clean air passages within the airbrush.

PRESET KNOB HANDLE

Set the limit on the travel distance of the airbrush trigger. This enables control of the paint flow to create repeatable lines.



Image: Diagram illustrating the features of the dual-action airbrush, including the preset knob handle for paint flow control and the quick flush cutaway handle for easy cleaning. It also shows the trigger action for air and fluid.

PROFESSIONAL FINE DETAIL PRECISION DUAL-ACTION AIRBRUSH

Spray Nozzle Size: **0.4 mm Tip**

Air Pressure: **20 to 36 PSI**

Airflow: **6-12 L/M**

Power: **10W**

Motor: **DC5V**

Charging Time: **35 minutes; 2A or
3A Fast Charging**

Battery: **5V2A, 7.4V 1000mAh**

Certification: **CE, FCC, RoHS**

Thread Size: **1/8" BSP**



**CORDLESS
AIR COMPRESSOR
WITH 4 AIRFLOW SETTINGS**

**WORKING TIME
OVER 30 MINUTES
CONTINUOUS,
OVER 1 HOUR
INTERMITTENTLY**

**MASTER
AIRBRUSH**

Image: Overview of the airbrush system's technical specifications, highlighting the 0.4mm tip, 20-36 PSI air pressure, 6-12 L/M airflow, 35-minute fast charging, and over 30 minutes of continuous working time.

SETUP

1. **Charge the Compressor:** Before first use, fully charge the compressor using the provided USB-C cable and a 2A or 3A fast charger. The LED display will indicate charging status. A full charge takes approximately 35 minutes.
2. **Attach Air Hose:** Connect one end of the 4-foot air hose to the air outlet on the compressor and the other end to the airbrush. Ensure connections are secure to prevent air leaks.
3. **Select and Attach Fluid Cup:** Choose the appropriate size fluid cup for your project and screw it onto the top of the airbrush.
4. **Mount Airbrush Holder (Optional):** The airbrush holder can be attached to the side of the compressor for convenient storage.

OPERATING INSTRUCTIONS

1. **Prepare Your Paint:** The 0.4mm tip is suitable for light to medium viscosity acrylic paint, makeup, water-based paint, food coloring, or other liquid media. Thicker paints may require dilution. Test paint

consistency on a scrap surface before applying to your project.

2. **Fill the Fluid Cup:** Use the eyedropper to carefully fill the selected fluid cup with your prepared paint. Do not overfill.
3. **Power On the Compressor:** Press the power button on the compressor. The LED display will show the current airflow level (P1 by default).
4. **Adjust Airflow:** Press the airflow adjustment button to cycle through the four pressure settings (P1 to P4) to achieve the desired air pressure for your application (20 to 36 PSI).
5. **Begin Spraying:**
 - Hold the airbrush approximately 2-6 inches from your surface.
 - Push down on the trigger to start airflow.
 - While maintaining airflow, gently pull the trigger back to release paint. The further back you pull, the more paint will be released.
 - Adjust the preset control knob at the rear of the airbrush to limit trigger travel for consistent lines.
 - Move the airbrush smoothly and consistently across your surface.
6. **Stop Spraying:** Release the trigger forward to stop paint flow, then release the trigger upwards to stop airflow.
7. **Power Off:** Press the power button on the compressor to turn it off when finished.

EXCELLENT FOR MOST AIRBRUSHING APPLICATIONS

The airbrush has a 0.4mm fluid tip nozzle installed for spraying light to medium viscosity acrylic paint, makeup, water-based paint, makeup, food coloring or other liquid media. When spraying thicker viscosity acrylic paint or media, it should be diluted or thinned until the airbrush can spray it out properly.

HOBBIES, CRAFTS, AUTO GRAPHICS, TEMPORARY TATTOOS, CAKE DECORATING, FINE ART, NAIL ART AND MORE!



Image: Examples of various applications for the Master Airbrush system, including model painting, nail art, and cake decorating, demonstrating its versatility.

MAINTENANCE

Proper cleaning and maintenance are crucial for the longevity and performance of your airbrush system.

After Each Use:

1. **Empty Fluid Cup:** Remove any remaining paint from the fluid cup.
2. **Rinse:** Fill the cup with an appropriate cleaning solution (water for water-based paints, specific cleaner for acrylics/makeup). Spray the cleaner through the airbrush until it runs clear.
3. **Back-Flush:** Place your finger over the nozzle cap and pull back the trigger. This will force air back into the fluid cup, bubbling and cleaning the inside of the cup and paint passage. Repeat with fresh cleaning solution.
4. **Clean Needle and Nozzle:** Use the provided cleaning brushes to gently clean the inside of the fluid cup and around the needle. For thorough cleaning, you may need to remove the needle and nozzle (refer to the detailed diagram in the manual for component identification).
5. **Wipe Down:** Wipe the exterior of the airbrush and compressor with a clean, damp cloth.

Regular Maintenance:

- Periodically lubricate the needle packing with airbrush-specific lubricant.
- Inspect O-rings for wear and replace if necessary (spare O-rings are included).
- Store the airbrush and compressor in a clean, dry place.

TROUBLESHOOTING

Problem	Possible Cause	Solution
No air flow	Compressor not powered on; low battery; air hose disconnected.	Ensure compressor is on and charged; check air hose connections.
No paint flow	Clogged nozzle; paint too thick; needle bent or stuck; empty fluid cup.	Clean nozzle and needle; dilute paint; check needle for damage; refill cup.
Splattering or inconsistent spray	Paint too thick or thin; air pressure too high or low; partially clogged nozzle; damaged needle.	Adjust paint consistency; modify air pressure; clean nozzle; inspect/replace needle.
Air leaks	Loose connections; damaged O-rings.	Tighten all connections; inspect and replace O-rings if damaged.
Compressor battery drains quickly	Continuous high-pressure use; battery degradation over time.	Use intermittently for longer operation; ensure full charge before use.

SPECIFICATIONS

- **Brand:** Master Airbrush
- **Model Name:** MAS TC-51
- **Airbrush Tip Size:** 0.4mm
- **Maximum Operating Pressure:** 20 to 36 PSI (adjustable)
- **Air Flow Capacity:** 6 to 12 Liters Per Minute
- **Power Source:** Battery Powered (1 Lithium Ion battery included)
- **Voltage:** 12 Volts
- **Charging Time:** Approximately 35 minutes (with 2A or 3A fast charger)
- **Continuous Working Time:** Over 30 minutes
- **Intermittent Working Time:** Over 1 hour
- **Noise Level:** 65 Decibels
- **Item Weight:** 0.54 Kilograms (1.2 pounds)
- **Hose Length:** 4 Feet
- **Special Features:** Cordless, Portable

WARRANTY AND SUPPORT

Master Airbrush stands behind its products. If you are not satisfied with this system at any time within the first year of purchase, the manufacturer will provide a refund or replacement.

For further assistance, technical support, or warranty claims, please refer to the contact information

provided on the product packaging or visit the official Master Airbrush website.