

kleankin 834-519V00WT

kleankin Modern Bathroom Under Sink Cabinet Instruction Manual

Model: 834-519V00WT

Brand: kleankin

1. INTRODUCTION

Thank you for choosing the kleankin Modern Bathroom Under Sink Cabinet. This cabinet is designed to provide efficient storage solutions for your bathroom, particularly for wall-mount sinks. Its space-saving design, double doors, and adjustable shelf help keep your bathroom organized and tidy. Please read this manual thoroughly before assembly and use to ensure proper installation and longevity of your product.

2. SAFETY INFORMATION

WARNING: This product may contain chemicals known to the state of California to cause cancer, birth defects, or other reproductive harm.

- Always follow assembly instructions carefully.
- Do not overload the cabinet. The maximum weight capacity is 77 lbs (overall) and 11 lbs (per shelf).
- Ensure all screws and fasteners are securely tightened before use. Periodically check and re-tighten if necessary.
- Install the anti-tipping strap as instructed to prevent accidental tipping, especially in households with children or pets.

ANTI-TIPPING STRAP

For extra stability

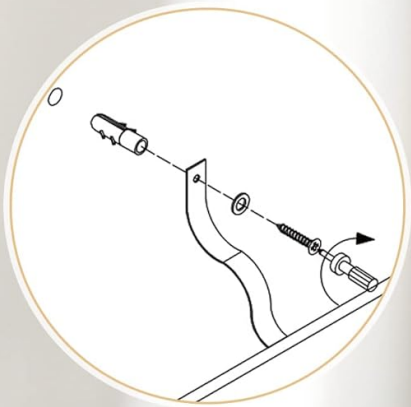

Figure 2.1: Anti-tipping strap installation for enhanced stability.

3. PACKAGE CONTENTS

Before beginning assembly, ensure all parts are present and undamaged. If any parts are missing or damaged, please contact customer support.

- Cabinet Panels (Top, Bottom, Sides, Back, Doors)
- Adjustable Shelf
- Hardware Pack (Screws, Dowels, Hinges, Knobs, Anti-tipping Strap)
- Instruction Manual

4. ASSEMBLY INSTRUCTIONS

Assembly is required for this product. Please follow the steps below carefully. It is recommended to assemble on a soft, clean surface to prevent scratches.

1. **Identify Components:** Lay out all panels and hardware. Refer to the diagram below for part identification and dimensions.



Figure 4.1: Cabinet dimensions and internal layout. Overall Dimensions: 23.5" W x 11.75" D x 24" H. "U" Cut-Out Dimensions: 8" W x 8.75" D.

2. **Assemble Side Panels:** Attach the side panels to the bottom panel using the provided screws and dowels. Ensure the pre-drilled holes align.
3. **Install Back Panel:** Secure the back panel to the assembled frame.
4. **Attach Top Panel:** Fasten the top panel, ensuring the U-shaped cut-out is correctly oriented for your sink. This cabinet is suitable for most wall-mount sinks. Measure your sink before purchasing to ensure compatibility.



Figure 4.2: Compatibility with various sink types, including pedestal and wall-mount sinks.

5. **Mount Doors:** Attach the hinges to the cabinet doors and then to the main cabinet frame. Install the door knobs.
6. **Insert Adjustable Shelf:** Place the adjustable shelf at your desired height using the shelf pins.
7. **Install Anti-Tipping Strap:** Secure the anti-tipping strap to the back of the cabinet and to a wall stud, following the instructions provided with the strap.

5. OPERATING INSTRUCTIONS

The kleankin Under Sink Cabinet is designed for convenient storage in your bathroom.

- **Accessing Storage:** Open the double doors to access the interior storage space.
- **Adjusting Shelf Height:** The internal shelf is adjustable. To change its height, remove any items from the shelf, lift the shelf, remove the shelf pins from their current holes, re-insert them into the desired holes, and then place the shelf back on the pins. This allows you to accommodate items of different heights.

ADJUSTABLE SHELF

Accommodates your different-sized items



Figure 5.1: The adjustable shelf can be moved up or down to fit various item sizes.

6. CARE AND MAINTENANCE

To maintain the appearance and longevity of your cabinet, follow these care instructions:

- **Cleaning:** Wipe surfaces with a soft, damp cloth. Avoid abrasive cleaners or harsh chemicals, as they may damage the painted finish.
- **Spills:** Promptly wipe up any spills, especially water, to prevent damage to the engineered wood material.
- **Humidity:** While designed for bathroom environments, excessive humidity should be avoided. Ensure proper ventilation in your bathroom.
- **Inspection:** Periodically check all hardware connections to ensure they remain tight. Re-tighten if necessary.

7. TROUBLESHOOTING

If you encounter any issues with your cabinet, consider the following common solutions:

- **Wobbly Cabinet:** Ensure all assembly screws are fully tightened. Check that the cabinet is placed on a level surface. Adjust feet if applicable.
- **Doors Not Aligning:** Check hinge adjustments. Most hinges allow for minor adjustments to align doors. Ensure

the cabinet itself is square.

- **Sink Does Not Fit:** Double-check the U-cutout dimensions against your sink's pedestal or plumbing. This cabinet is designed for wall-mount sinks with specific dimensions.
- **Damaged Parts:** If any parts were damaged during shipping or assembly, do not attempt to force them. Contact customer support for replacement parts.

8. SPECIFICATIONS

Feature	Detail
Brand	kleankin
Model Number	834-519V00WT
Color	White
Overall Dimensions	23.5" W x 11.75" D x 24" H
"U" Cut-Out Dimensions	8" W x 8.75" D
Weight Capacity (Overall)	77 lbs
Weight Capacity (Shelf)	11 lbs
Material	Engineered Wood
Number of Shelves	1 (Adjustable)
Assembly Required	Yes
Manufacturer	Aosom LLC
Item Weight	20.7 pounds

9. WARRANTY AND SUPPORT

This product is manufactured by Aosom LLC. For any product-related inquiries, support, or to report missing/damaged parts, please contact the manufacturer or the retailer from whom you purchased the product.

Return Policy: This product typically has a 30-day return policy for refund or replacement, subject to the retailer's terms and conditions.