

[manuals.plus](#) /

› [SUNFREE](#) /

› [SUNFREE Top Down Bottom Up Cellular Blinds \(Light Filtering\), Model 9b1f9904-6f5a-4e03-88e8-d109866a6b84](#)

## SUNFREE 9b1f9904-6f5a-4e03-88e8-d109866a6b84

# SUNFREE Top Down Bottom Up Cellular Blinds (Light Filtering)

Model: 9b1f9904-6f5a-4e03-88e8-d109866a6b84

## INTRODUCTION

---

This manual provides comprehensive instructions for the installation, operation, and maintenance of your SUNFREE Top Down Bottom Up Cellular Blinds. Please read this manual thoroughly before installation and use to ensure proper function and longevity of your product.

## SAFETY INFORMATION

---

These cellular shades feature a cordless design, making them safe for homes with children and pets. Ensure the shades are operated smoothly and without excessive force.



Image showing a child playing near the cordless cellular shade, highlighting its safety features for children and pets.

## PACKAGE CONTENTS

---

Verify that all components are present before beginning installation.

- Top Down Bottom Up Cellular Blinds
- Brackets & Screws
- Installation Instruction Sheet
- Rail Handle

# What are included in the package

## 1 Top Down Bottom Up Cellular Blinds

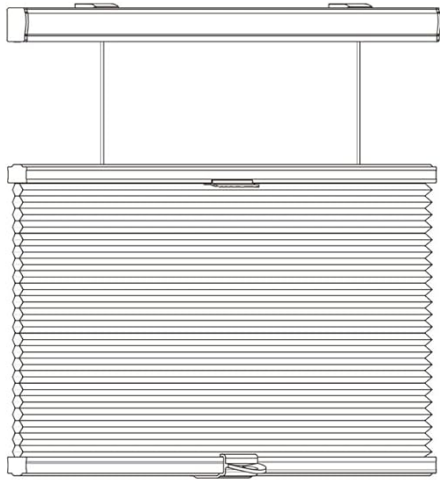

## 2 Brackets & Screws

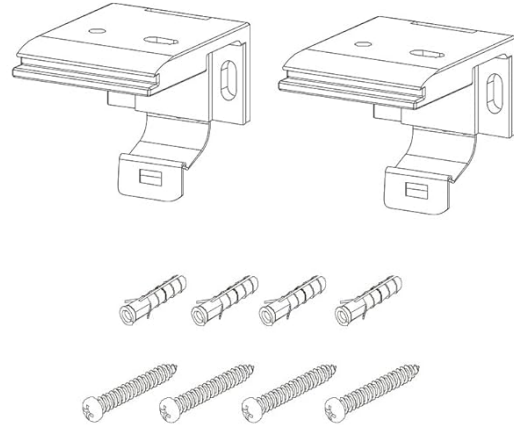

## 3 Installation Instruction

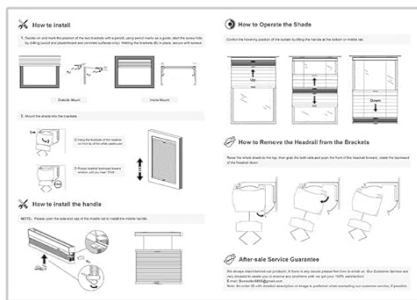

## 4 Rail Handle

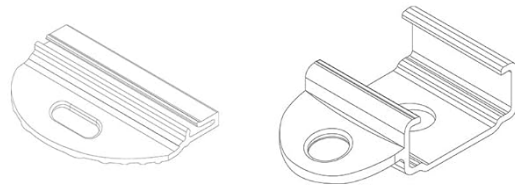

Diagram illustrating the components included in the package: cellular blinds, mounting brackets and screws, installation instructions, and rail handles.

## SETUP AND INSTALLATION

### Before You Begin

Ensure you have the necessary tools: measuring tape, pencil, drill, screwdriver.

### Mounting Options

Your cellular blinds can be installed using either an inside mount or an outside mount.

#### Inside Mount

For an inside mount, the blinds fit within the window frame.

- **Order Width:** Window width - 0.5 inch.

- **Shade Height:** Suitable for window height (H) less than 72 inches.
- **Window Depth:** Minimum 1.9 inches (D).

## Outside Mount

For an outside mount, the blinds cover the window frame.

- **Order Width:** Window width + 4 inches.
- **Shade Height:** Should be greater than window height.
- **Tip:** For full blackout effect, choose outside mount.

## Inside Mount

Order width = Window width-0.5inch

Shade height: Suitable for H (window)<72inch

window depth: D (window)>=1.9inch



## Outside Mount

Order width = Window width+4inch

Shade height>Window height

**Tips:** if you want full blackout effect, please choose outside mount

Diagram comparing inside mount and outside mount measurements for cellular shades, including recommended width and height adjustments.

## General Installation Steps

1. Mark bracket positions on the window frame or wall.
2. Drill pilot holes at the marked positions.



3. Secure the mounting brackets with the provided screws.
4. Attach the headrail of the blind to the installed brackets, ensuring it clicks securely into place.
5. Install the rail handles onto the bottom rail of the shade.
6. Test the operation by gently pulling the top and bottom rails to ensure smooth movement.

## OPERATING YOUR CELLULAR BLINDS

---

### Cordless Top Down Bottom Up Operation

These blinds offer flexible light and privacy control through their cordless top-down bottom-up mechanism.

- **To adjust the top portion:** Gently pull down or push up the top rail handle to raise or lower the top section of the shade.
- **To adjust the bottom portion:** Gently pull down or push up the bottom rail handle to raise or lower the bottom section of the shade.
- The shade will stop at any desired position.

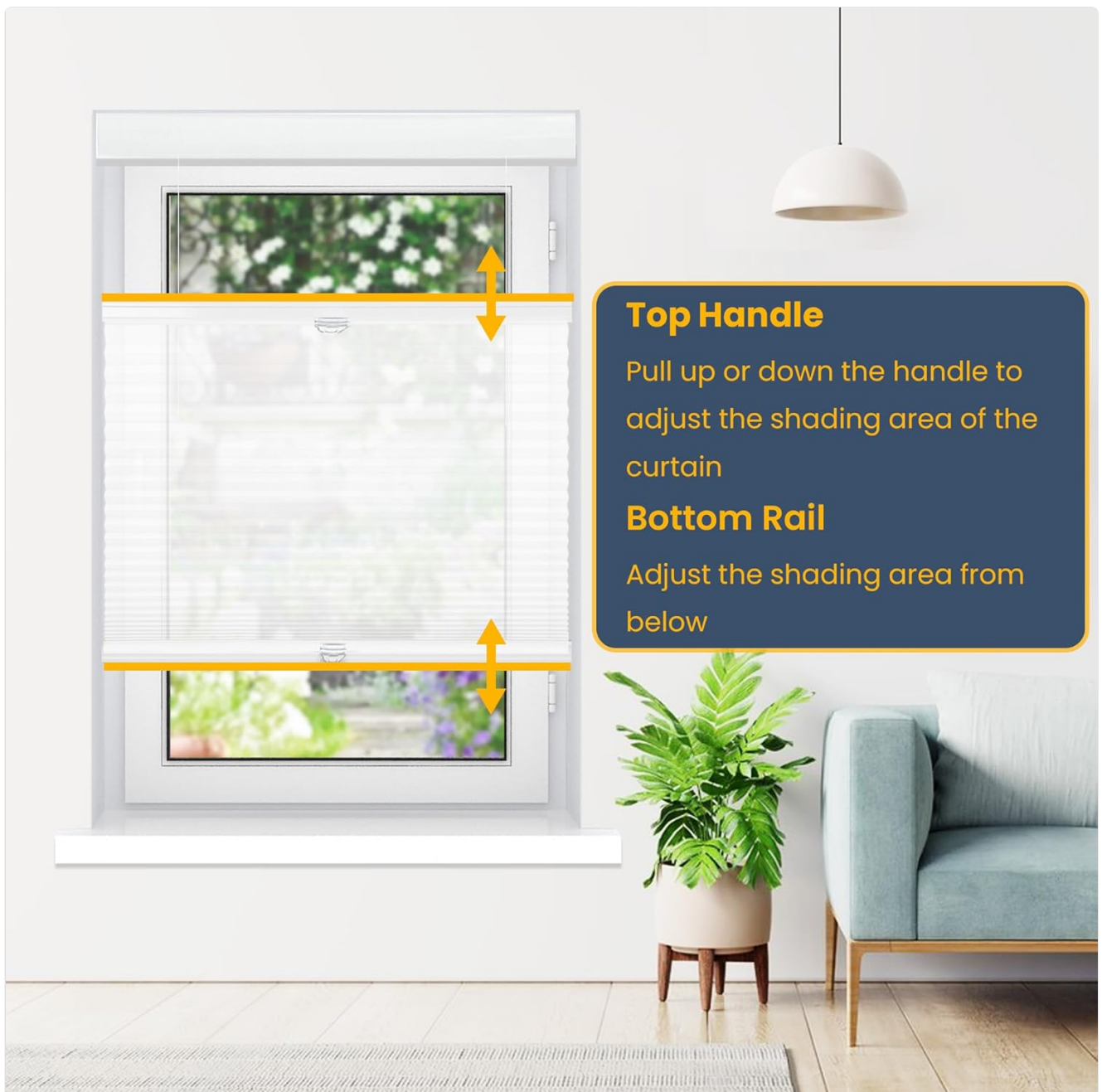

Image demonstrating the top-down and bottom-up operation of the cellular shade, showing how to adjust the top and bottom rails.

## Light Control and Privacy

The honeycomb design provides both light filtering and noise reduction.

- **Light Filtering:** Allows natural light to gently diffuse into the room while maintaining privacy.
- **Noise Reduction:** The cellular structure helps to dampen outside noise.
- **UV Protection:** Helps block harmful UV rays.



A white cellular blind installed in a window, demonstrating its light-filtering capability with a view of the ocean outside.

## FULLY CLOSED

The honeycomb design and surface coating allow for complete blackout.

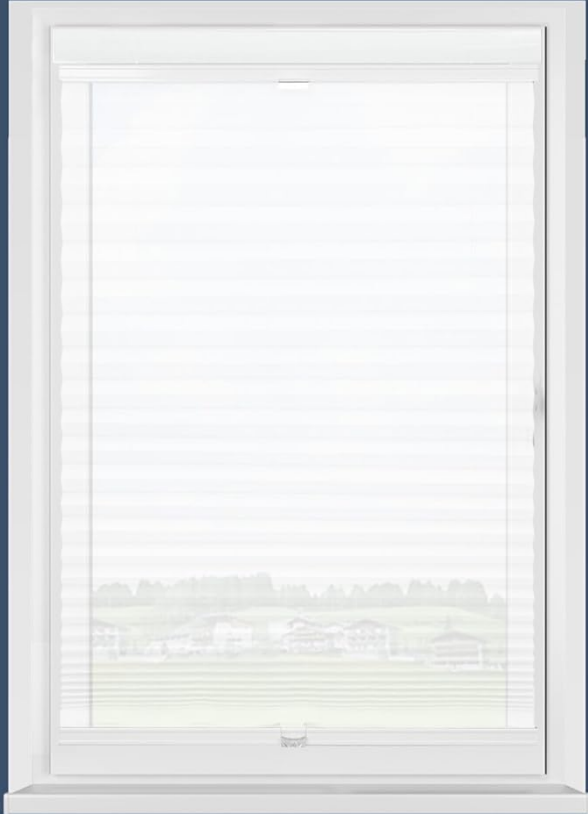

☉ 100% Blackout

## TOP DOWN AND BOTTOM UP

Adjust to most comfortable position for you by pulling at random.



☾ 30% Blackout

Comparison image showing a cellular blind fully closed for maximum privacy and light blocking, next to a blind adjusted with the top-down bottom-up feature for partial light and privacy.



Close-up view of the cellular blind's honeycomb structure, illustrating its insulating and light-filtering properties.





Graphic illustrating the benefits of cellular shades, including privacy protection, UV blocking, and noise reduction, with a visual representation of light and sound waves.

## CARE AND MAINTENANCE

---

To maintain the appearance and functionality of your cellular blinds, follow these guidelines:

- **Cleaning:** Spot clean only. Use a soft, damp cloth with mild soap and water for any stains. Do not immerse the blinds in water.
- **Dusting:** Regularly dust the shades with a feather duster or a vacuum cleaner with a brush attachment on a low setting.
- **Operation:** Operate the shades gently to prevent damage to the cordless mechanism.

## TROUBLESHOOTING

---

### Shade Does Not Move Smoothly

Ensure there are no obstructions in the window frame or along the shade's path. Gently try to operate the shade again. If the issue persists, contact customer support.

### Shade Does Not Stay in Position

The cordless mechanism may need adjustment. Try fully extending and then fully retracting the shade a few times. If the problem continues, contact customer support.

### PRODUCT SPECIFICATIONS

Feature	Detail
Material	Polyester
Product Dimensions	36"L x 22"W
Brand	SUNFREE
Color	White (light Filtering)
Opacity	Semi-Sheer
Recommended Uses For Product	Indoor
Room Type	Bedroom, Living Room
Operation Mode	Manual
Special Feature	Cordless, Window Treatments
Included Components	Shade included
Shape	Hexagonal
Number of Items	1
Pattern	Solid
Item Weight	2.74 pounds (1.25 Kilograms)
Product Care Instructions	Spot Clean Only
Size	22"W x 36"H
Mounting Type	Inside Mount, Outside Mount
Number Of Panels	1
Water Resistance Level	Not Water Resistant
Control Type	Cordless
Manufacturer	sunfree
Item model number	9b1f9904-6f5a-4e03-88e8-d109866a6b84
Date First Available	February 15, 2023

## WARRANTY AND CUSTOMER SUPPORT

SUNFREE is committed to providing high-quality products and excellent customer service.





- **Customer Service:** 7x24 hour online fast response via email.
- **Returns:** 30-day courtesy return policy.
- **Replacement:** 12-month free replacement for product damage, logistics damage, not working, or product error.



Graphic detailing SUNFREE's customer service commitments: 24-hour online response, 30-day courtesy return, and 12-month free replacement.

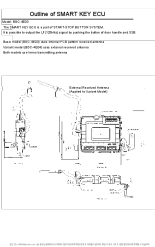

Graphic outlining reasons for free replacement: product damage, logistics damage, not working, and product error.

	<p><a href="#">AC701 Wifi Bridge Quick Start Guide - Sunfree</a></p> <p>Comprehensive guide to setting up and using the Sunfree AC701 Wifi Bridge for smart home control, including app pairing, device integration, and voice assistant setup.</p>
	<p><a href="#">Wifi Bridge Quick Start Guide AC801/AC802/AC803</a></p> <p>A quick start guide for the Wifi Bridge, covering setup, pairing, and smart blind control. Includes troubleshooting tips and FCC compliance information.</p>
	<p><a href="#">AC701 Wifi Bridge Quick Start Guide - Sunfree</a></p> <p>Comprehensive guide to setting up and using the Sunfree AC701 Wifi Bridge for smart home control, including app pairing, device integration, and voice assistant setup.</p>
	<p><a href="#">Hyundai Mobis BDC-4E03 Smart Key ECU Overview and Specifications</a></p> <p>Detailed overview of the Hyundai Mobis BDC-4E03 Smart Key ECU, including system description, model variants, antenna information, and FCC/ISED compliance. Learn about its function in start-stop systems.</p>
	<p><a href="#">Wifi Bridge Quick Start Guide AC801/AC802/AC803</a></p> <p>A quick start guide for the Wifi Bridge, covering setup, pairing, and smart blind control. Includes troubleshooting tips and FCC compliance information.</p>
	<p><a href="#">Dyness Energy Storage System Inverter Compatibility List</a></p> <p>Comprehensive compatibility list for Dyness energy storage batteries and inverters, including brands like SolarBrain, SUNSYNK, Thinkpower, Megarevo, SAJ, and specific Dyness models such as PowerRack HV1 and B-series.</p>