



Manuals.plus /

› Aiwa /

› Aiwa Portable Boombox User Manual

## Aiwa AI7001

# Aiwa Portable Boombox User Manual

Model: AI7001

Brand: Aiwa

## INTRODUCTION

---

Thank you for purchasing the Aiwa Portable Boombox. This versatile entertainment system combines a 7-inch LCD display, powerful speakers, and multiple playback options, including CD/DVD, Bluetooth, FM radio, and USB. It also features HDMI input for connecting streaming devices. This manual provides detailed instructions for setting up, operating, and maintaining your new boombox.

## SAFETY INFORMATION

---

- Read all instructions before operating the device.
- Keep the device away from water and moisture.
- Do not block ventilation openings.
- Use only specified power sources (AC adapter or D batteries).
- Do not attempt to repair the device yourself. Refer all servicing to qualified personnel.
- Avoid exposing the device to extreme temperatures or direct sunlight.

## PRODUCT FEATURES

---



Figure 1: Aiwa Portable Boombox highlighting key features such as the 7-inch LCD screen, built-in speakers, DVD/CD/MP3 player, bass function, FM radio, and USB playback.

- **7-inch LCD Display:** Provides clear and vivid picture quality for video content.
- **High-Quality Audio:** Equipped with 3W x 2 speakers and a bass function for crisp, clear sound.
- **Multiple Playback Options:**
  - Top-loading DVD/CD/MP3 player
  - Bluetooth wireless connectivity
  - USB playback
  - Aux-in jack
  - FM radio
- **HDMI Input:** Allows connection of external Wi-Fi media players like Roku and Amazon Firestick for multimedia streaming.
- **Audio/Video Output:** Connect to an external display or audio system.
- **Portable Design:** Operates via power adapter or 8 D batteries (not included) for flexible use.
- **Remote Control:** Included for convenient operation from a distance.

## SETUP

### Powering the Boombox

The Aiwa Portable Boombox can be powered in two ways:

1. **AC Power:** Connect the included AC power adapter to the "DC IN" port on the back of the boombox and plug the other end into a standard wall outlet.
2. **Battery Power:** For portable use, the boombox requires 8 D batteries (not included).



Figure 2: Inserting 8 D-cell batteries into the battery compartment located on the underside of the boombox.

To install batteries:

- Locate the battery compartment on the underside of the boombox.
- Open the battery compartment cover.
- Insert 8 D-size batteries, ensuring correct polarity (+/-) as indicated inside the compartment.
- Close the battery compartment cover securely.

### Initial Connections

- **Remote Control:** Insert 2 AAA batteries (not included) into the remote control.

- **FM Antenna:** Extend the telescopic FM antenna for optimal radio reception.

## OPERATING INSTRUCTIONS

### General Operation

- **Power On/Off:** Press the Power button on the unit or remote control.
- **Volume Control:** Use the Volume knob on the unit or the VOL+/- buttons on the remote.



Figure 3: Detail of the volume and bass control knobs located on the top panel of the boombox.

- **Source Selection:** Press the SOURCE button on the unit or remote to cycle through available modes (DVD/CD/MP3, Bluetooth, USB, Aux-in, FM Radio, HDMI).
- **Bass Function:** Press the BASS button to enhance bass output.

### DVD/CD/MP3 Playback

1. Open the top-loading disc compartment.



Figure 4: The top-loading disc compartment is open, revealing the CD/DVD player mechanism.

2. Place a DVD, CD, or MP3 disc onto the spindle, label side up.
3. Close the disc compartment. The unit will automatically detect the disc and begin playback.
4. Use the Play/Pause, Stop, Skip (forward/backward) buttons on the unit or remote to control playback.
5. **Video Output:** To view DVD content on an external display, connect an RCA cable (not included) from the "VIDEO OUT" ports on the boombox to your TV's video input.

### Bluetooth Connectivity

1. Press the SOURCE button until "Bluetooth" mode is selected. The display will show "BT" or a similar indicator.
2. On your Bluetooth-enabled device (smartphone, tablet, etc.), enable Bluetooth and search for available devices.
3. Select "AIWA Boombox" (or similar name) from the list of devices.
4. Once paired, you can stream audio wirelessly from your device to the boombox.

### FM Radio Operation

1. Press the SOURCE button until "FM Radio" mode is selected.
2. Extend the telescopic antenna fully for best reception.
3. Use the Tuning knob or the Tune +/- buttons on the remote to scan for radio stations.

## USB Playback

1. Insert a USB flash drive containing MP3 audio files into the USB port.
2. Press the SOURCE button until "USB" mode is selected. The unit will automatically detect and begin playing audio files from the USB drive.
3. Use the playback controls (Play/Pause, Skip) to navigate your music.

## Aux-in Connection

1. Connect an audio cable (3.5mm stereo jack, not included) from the audio output of an external device (e.g., smartphone, MP3 player) to the "AUX IN" jack on the boombox.
2. Press the SOURCE button until "AUX" mode is selected.
3. Audio from the connected device will now play through the boombox speakers. Control playback from your external device.

## HDMI Streaming

The boombox features an HDMI input for connecting external streaming devices (e.g., Roku, Amazon Firestick) to utilize the 7-inch LCD display.

1. Connect your HDMI streaming device to the "HDMI IN" port on the back of the boombox.



Figure 5: The HDMI IN port and Audio/Video OUT ports are visible on the rear panel of the boombox.

2. Press the SOURCE button until "HDMI" mode is selected.
3. The content from your streaming device will now be displayed on the boombox's LCD screen. Use your streaming device's remote control for navigation and content selection.

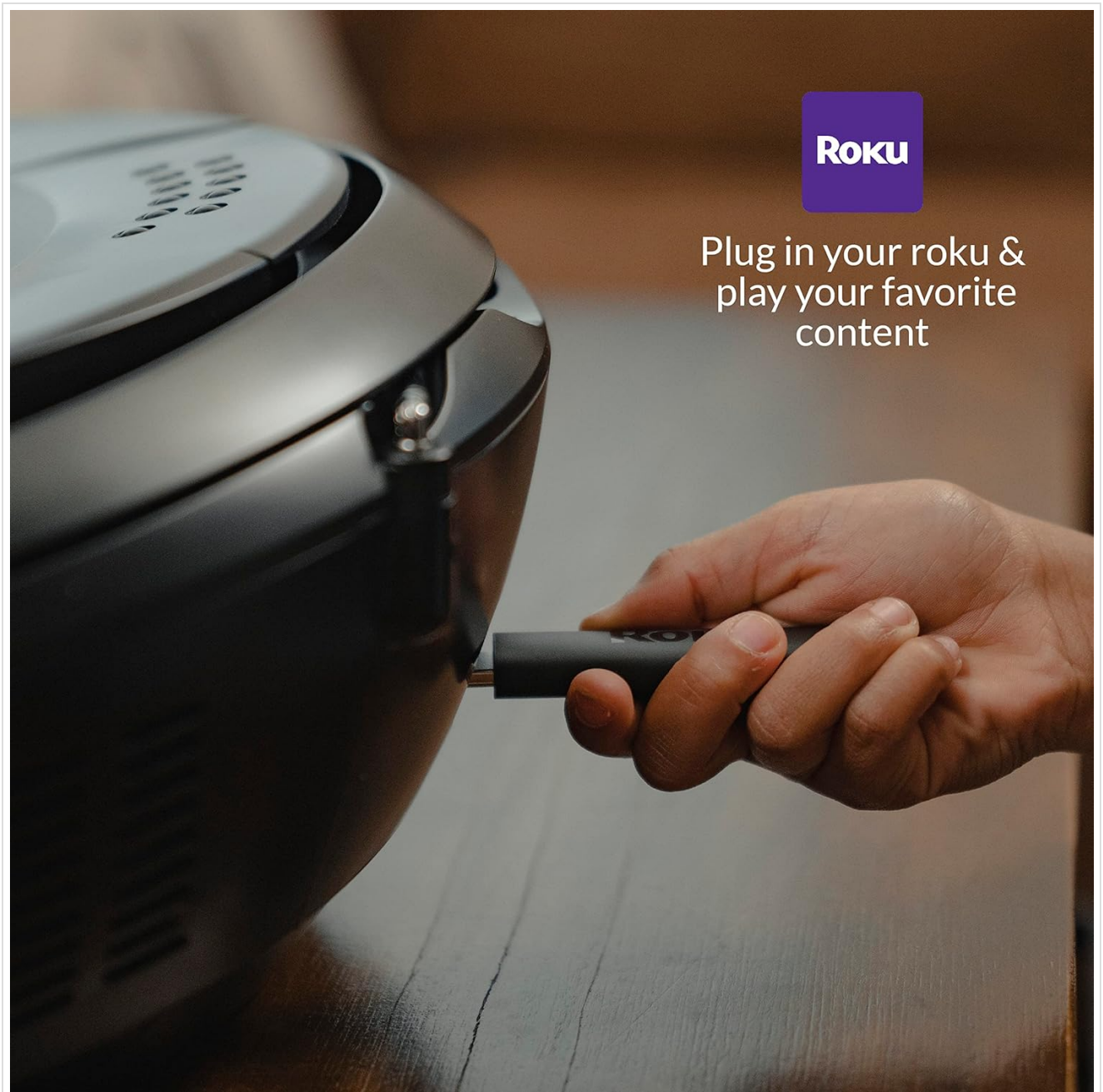

Figure 6: A Roku streaming stick being inserted into the HDMI input port on the side of the boombox.

## Using the Remote Control



Supports  
**ROKU** firetvstick

 Multimedia  
Streaming

 **Bluetooth**<sup>®</sup>

**HDMI**<sup>™</sup>

**DVD**  
CD & VIDEO

Figure 7: The Aiwa Portable Boombox shown alongside its included remote control.

The included remote control provides full functionality for operating your boombox from a distance. Refer to the button labels on the remote for specific functions such as Power, Source, Volume, Playback controls (Play, Pause, Stop, Skip), Menu, Setup, and more.

## MAINTENANCE

- **Cleaning:** Wipe the exterior of the unit with a soft, dry cloth. Do not use abrasive cleaners or solvents.
- **Disc Care:** Handle discs by their edges. Keep them clean and free of scratches.
- **Storage:** When not in use for extended periods, remove batteries and store the unit in a cool, dry place.

## TROUBLESHOOTING

Problem	Possible Cause	Solution
No power	AC adapter not connected; Batteries drained or incorrectly inserted.	Ensure AC adapter is securely plugged in. Replace or correctly insert D batteries.
No sound	Volume too low; Mute activated; Incorrect source selected.	Increase volume. Deactivate mute. Select the correct input source.
Disc not playing	Disc inserted incorrectly; Disc is dirty or scratched; Disc format not supported.	Reinsert disc correctly. Clean or replace disc. Ensure disc is DVD, CD, or MP3 format.
Bluetooth not pairing	Boombox not in Bluetooth mode; Device too far; Bluetooth not enabled on external device.	Select Bluetooth mode on boombox. Move devices closer. Enable Bluetooth on your device and re-scan.
Poor FM reception	Antenna not extended; Weak signal.	Fully extend the telescopic antenna. Try repositioning the unit.
No picture from HDMI	HDMI cable not connected properly; Incorrect source selected; Streaming device issue.	Check HDMI cable connection. Select HDMI source. Ensure streaming device is powered on and functioning.

## SPECIFICATIONS

- **Model Number:** AI7001
- **Product Dimensions (L x W x H):** 15.95 x 10.63 x 7.5 inches
- **Item Weight:** 5.96 pounds
- **Display:** 7-inch LCD
- **Speakers:** 3W x 2 (Stereo)
- **Power Source:** AC Adapter (included) or 8 x D Batteries (not included)
- **Connectivity:** Bluetooth, Auxiliary (3.5mm), USB, HDMI In, Audio/Video Out (RCA)
- **Playback Formats:** DVD, CD, MP3 (from disc or USB)
- **Radio:** FM
- **Manufacturer:** Sakar International

## WARRANTY AND SUPPORT

For warranty information, technical support, or service inquiries, please refer to the warranty card included with your product or visit the official Aiwa support website. You may also consult the full User Guide PDF available online for more detailed information. A digital copy of the user guide can be found at: [Aiwa Portable Boombox User Guide \(PDF\)](#)