

MLEEDA KVM switch 4 monitors 204UH

MLEEDA Quad Monitor KVM Switch (Model: KVM switch 4 monitors 204UH)

User Instruction Manual

1. INTRODUCTION

The MLEEDA Quad Monitor KVM Switch allows two computers to share four HDMI monitors and four USB 3.0 devices. This device supports resolutions up to 1080P at 60Hz across all four monitors simultaneously. It is designed to streamline your workspace by enabling seamless switching between two systems using a single set of peripherals and displays. This manual provides comprehensive instructions for installation, operation, and troubleshooting.

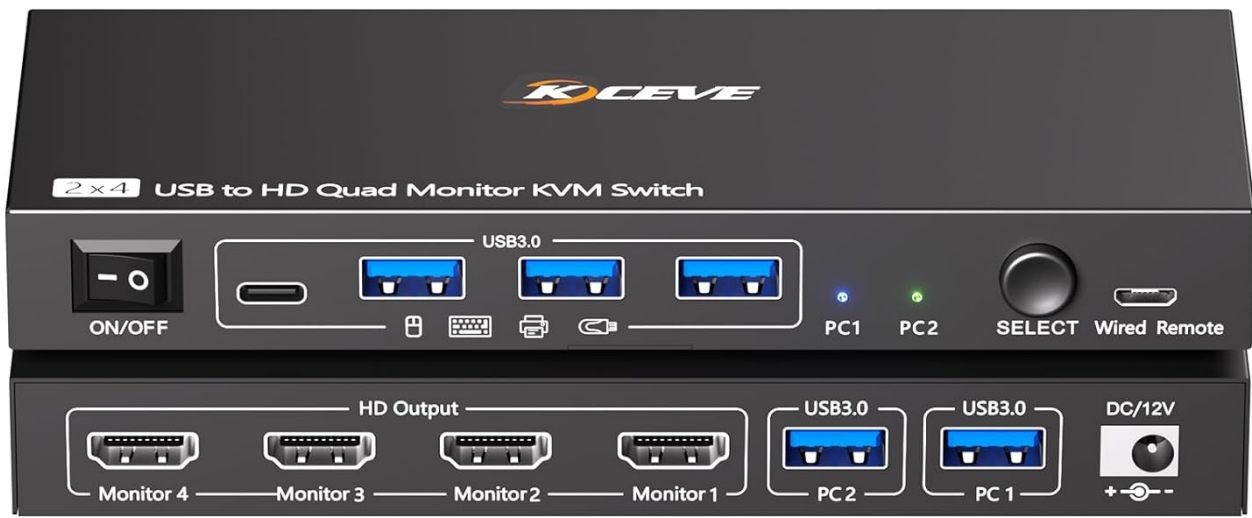

Image 1: MLEEDA Quad Monitor KVM Switch in a typical setup.

2. PACKAGE CONTENTS

Please verify that all items are present in your package:

- 1 x MLEEDA Quad Monitor KVM Switch
- 2 x USB A to C OTG Cables (1.5m)
- 1 x Wired Remote Control (1.5m)
- 1 x 12V Power Adapter
- 1 x User Manual

Packing list

- 1*KVM Switch;
- 2*USB A Cable+A-C OTG(1.5m)
- 1* Wired Remote (1.5 m)
- 1*12V Power Adapter
- 1*User Manual



Image 2: Included components in the package.

3. PRODUCT FEATURES

- **Quad Monitor Support:** Connects up to four HDMI monitors to two computers.
- **High Resolution:** Supports 4x 1080P@60Hz simultaneous output.
- **USB 3.0 Ports:** Equipped with 4 USB 3.0 ports for keyboard, mouse, printer, U-disk, and other USB devices, offering data transfer rates up to 5Gbps. Backward compatible with USB 1.1/2.0.
- **Two Switching Methods:** Switch between computers using the physical button on the KVM switch or the included wired remote control.
- **Wide Compatibility:** Compatible with Windows and Mac OS operating systems.
- **Driver Installation Required:** A USB driver must be installed on each connected PC for monitor recognition.

Only One USB Cable is Needed to Obtain 4 HDMI Outputs

Suitable for Desktops and Laptops



Image 3: USB 3.0 data transfer capabilities.

4. CONNECTION DIAGRAM

Follow the diagram below to connect your computers, monitors, and USB devices to the KVM switch.

1. Connect your four HDMI monitors to the "HD Output" ports (Monitor 1-4) on the KVM switch.
2. Connect the USB 3.0 cables from each computer to the corresponding "PC IN" ports (PC 1 IN, PC 2 IN) on the KVM switch. Each PC requires one USB cable for monitor output and USB device sharing.
3. Connect your keyboard, mouse, printer, U-disk, or other USB devices to the "USB3.0" ports on the front of the KVM switch.
4. Plug the wired remote control into the "SELECT Wired Remote" port.
5. Connect the 12V power adapter to the "DC/12V" port on the KVM switch and then to a power outlet.

Multiple Display Modes

Windows



Mac OS



Image 4: Front and rear panel connection points.

5. DRIVER INSTALLATION

Important: Driver installation is mandatory for the KVM switch to recognize and output to the monitors. Without the driver, the monitors will not function correctly.

1. After connecting your PC to the KVM switch via the USB 3.0 cable, your computer should automatically detect the USB device.
2. A pop-up window will appear on your PC screen prompting you to install the USB driver. Follow the on-screen wizard to complete the installation.
3. This driver is solely for identifying monitors and does not record any personal information.

4. System Requirements:

- For Windows PCs: Must be equipped with an Intel CPU of 11th Generation or higher, and the operating system should be Windows 10 or higher.
- For Mac OS: Must be Mac OS 11 (Big Sur) or above.

Connection Diagram



Image 5: Driver installation steps for different operating systems.

6. OPERATING INSTRUCTIONS

The KVM switch offers two methods for switching between connected computers:

6.1. Button Switch

Press the "SELECT" button on the front panel of the KVM switch to toggle between PC1 and PC2. LED indicators will illuminate to show which computer is currently active.

6.2. Wired Remote Control

Use the included wired remote control to switch between PC1 and PC2. Simply press the button on the remote to change the active computer. This allows for convenient switching if the KVM switch is not easily accessible.

Need to install driver: USB Display

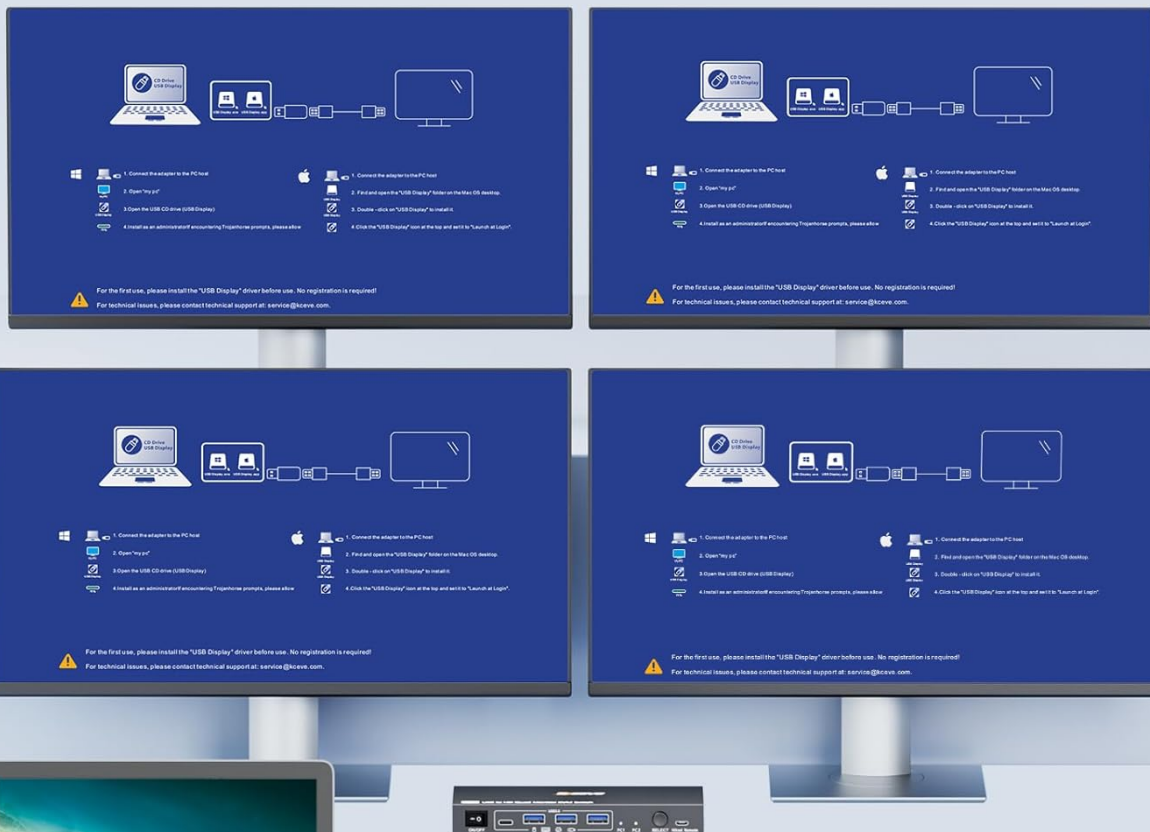

MAC OS: Must be MAC OS11 or above

Windows: Must be equipped with an Intel CPU of 11th Gen or higher, and the system should be WIN10 or higher

Image 6: Switching methods: physical button and wired remote control.

7. DISPLAY MODES

The KVM switch supports both mirror mode and extended mode for your displays. After driver installation, you can configure your display settings within your operating system.

- **Mirror Mode:** All four monitors display the same content.
- **Extended Mode:** Each monitor acts as a separate display, extending your desktop across all four screens.

Refer to your operating system's display settings for detailed configuration options.

Switch Between 2 Computers Share 4 Monitors and 4 USB Devices

Wide Compatibility:



Windows



Mac OS



Image 7: Various display configurations for Windows and Mac OS.

8. TROUBLESHOOTING

If you encounter issues, please refer to the following common solutions:

- **No Display on Monitors:**

- Ensure the KVM switch is powered on and the 12V power adapter is securely connected.
- Verify that all HDMI cables are securely connected between the KVM switch and your monitors, and between your computers and the KVM switch.
- Confirm that the USB 3.0 cables are properly connected from each PC to the KVM switch.
- **Crucially, ensure the USB driver has been successfully installed on both connected computers.** Refer to Section 5 for driver installation instructions.
- Check your PC's display settings to ensure the monitors are detected and configured correctly (e.g., extended or mirror mode).
- Ensure your PC meets the minimum system requirements (Intel 11th Gen+ CPU, Windows 10+; Mac OS 11+).

- **USB Devices Not Working:**

- Ensure the USB 3.0 cables from your PCs are connected to the KVM switch.
- Try connecting the USB device directly to your computer to confirm it is functional.
- Restart the KVM switch and your computers.

- **Flickering or Intermittent Display:**

- Check all HDMI cables for damage and ensure they are high-quality and securely connected.
- Ensure the power adapter is providing stable power to the KVM switch.
- Verify that your graphics card drivers are up to date on your computers.

- **Switching Issues:**

- Ensure the wired remote control is securely plugged into the KVM switch.
- Allow a few seconds for the switch to complete the transition between computers.

If problems persist after following these steps, please contact MLEEDA technical support for further assistance.

9. SPECIFICATIONS

Brand	MLEEDA
Model	KVM switch 4 monitors 204UH
Operation Mode	ON-OFF
Current Rating	2 Amps
Operating Voltage	5 Volts
Connector Type	Plug In (HDMI, USB)
Switch Type	Push Button
Material	Metal
Item Dimensions (L x W x H)	6.69 x 2.56 x 0.79 inches (16.8 x 6.5 x 2.08 cm)
Circuit Type	2-way
Mounting Type	Surface Mount
Number of Positions	2
Upper Temperature Rating	70 Degrees Celsius
Control Method	Push Button, Remote
Connectivity Protocol	USB, HDMI
Control Type	Manual
Compatible Devices	Windows, Mac OS
Item Weight	248 Grams
International Protection Rating	IP54
Certification	CE

10. IMPORTANT NOTES

- Driver installation is required for monitor recognition. Please follow the instructions in Section 5.
- To ensure proper functionality, Windows PCs must have an Intel CPU of 11th Generation or above and run Windows 10 or higher. Mac OS systems must be Mac OS 11 or above.
- HDMI cables are **not** included in the packaging. Please ensure you have the necessary HDMI cables for your setup.
- This KVM switch does not support EDID emulation or hotkey switching.

11. WARRANTY AND SUPPORT

The MLEEDA Quad Monitor KVM Switch comes with a **1-year warranty** from the date of purchase.

For technical assistance, troubleshooting, or warranty claims, please contact MLEEDA technical support. Our team is available to reply within 12 hours to address any questions or concerns you may have.

Please retain your proof of purchase for warranty purposes.