

AIKE AK2065 & AK5101

# AIKE Vertical Hand Dryer and Paper Towel Dispenser Bundle User Manual

Models: AK2065 (Hand Dryer) & AK5101 (Paper Towel Dispenser)

[Overview](#) [Components](#) [Specifications](#) [Installation](#) [Operation](#) [Maintenance](#) [Troubleshooting](#) [Support](#)

## 1. PRODUCT OVERVIEW

This manual provides comprehensive instructions for the installation, operation, and maintenance of the AIKE Vertical Hand Dryer (Model AK2065) and the AIKE Multifold Paper Towel Dispenser (Model AK5101). This bundle is designed to provide efficient and hygienic hand drying solutions for various environments.



Image: The AIKE Vertical Hand Dryer (AK2065) and the AIKE Multifold Paper Towel Dispenser (AK5101) shown together, highlighting their silver finish and compact design.

## 2. PACKAGE CONTENTS

---

Upon unpacking, please verify that all the following components are present:

- One (1) AIKE Vertical Hand Dryer - Model AK2065 (Silver)
- One (1) AIKE Multifold Paper Towel Dispenser - Model AK5101 (Silver)
- Installation hardware (screws, anchors, optional adhesive stickers for dispenser)
- User Manual (this document)

## 3. TECHNICAL SPECIFICATIONS

---

Detailed specifications for both products are provided below:

### 3.1. AIKE Vertical Hand Dryer (Model AK2065)

Model	AK2065
Color	Silver
Type	Vertical Slim Jet Hand Dryer
Approximate Width	7 inches
Features	Water collection reservoir to prevent wet floors



# Water Collection

Collects residual water in a dedicated reservoir  
and prevents wet floor hazards

Image: The AIKE Vertical Hand Dryer (AK2065) highlighting its slim profile and approximate 7-inch width.

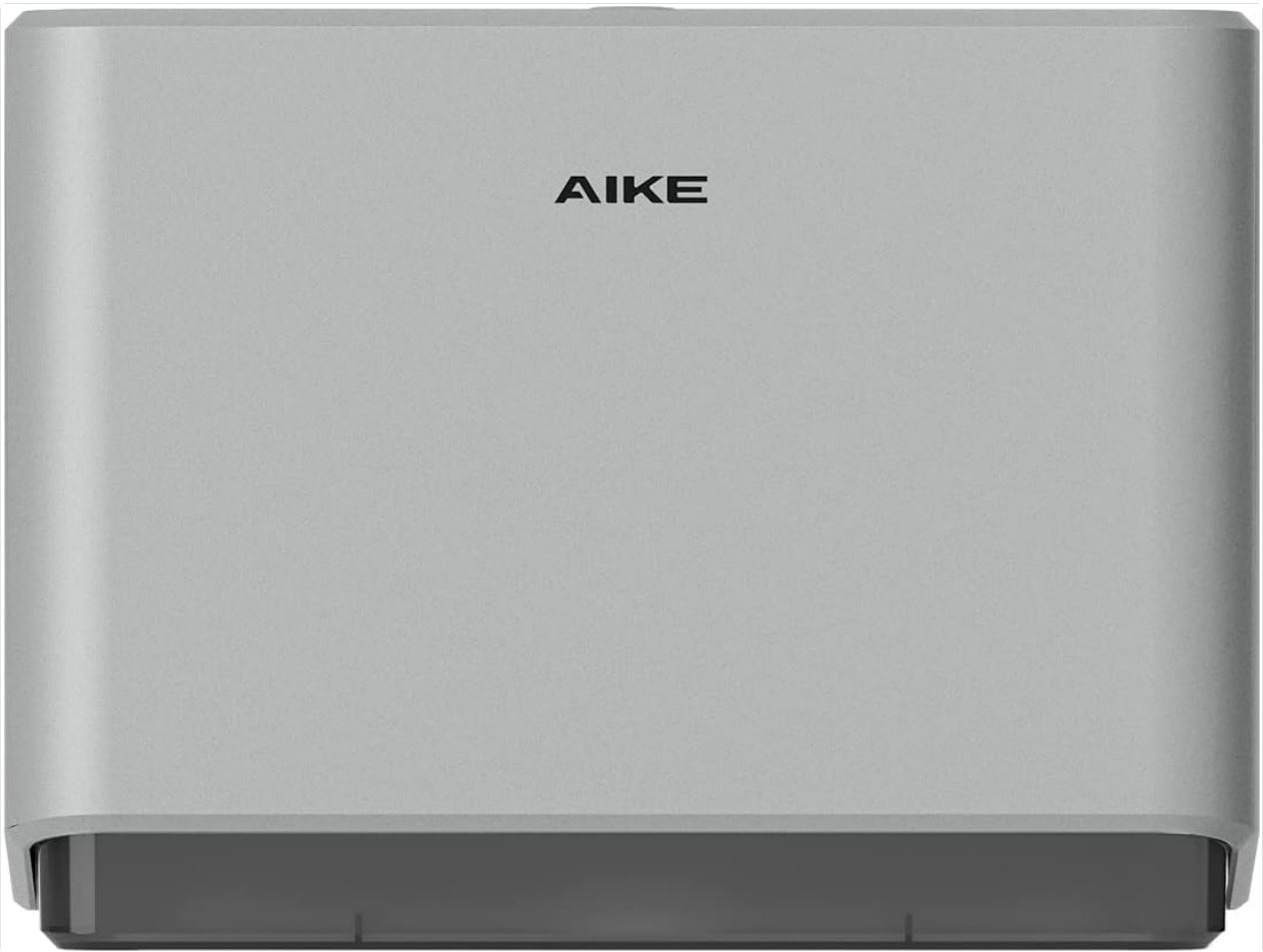

Image: Close-up view of the AIKE Hand Dryer's integrated water collection system, designed to capture residual water.

3.2. AIKE Multifold Paper Towel Dispenser (Model AK5101)

Model	AK5101
Color	Silver
Dimensions (W x H x D)	Approximately 11" x 8.2" x 3.8"
Compatible Paper Towel Size	Folded size 10" x 3.1" or smaller

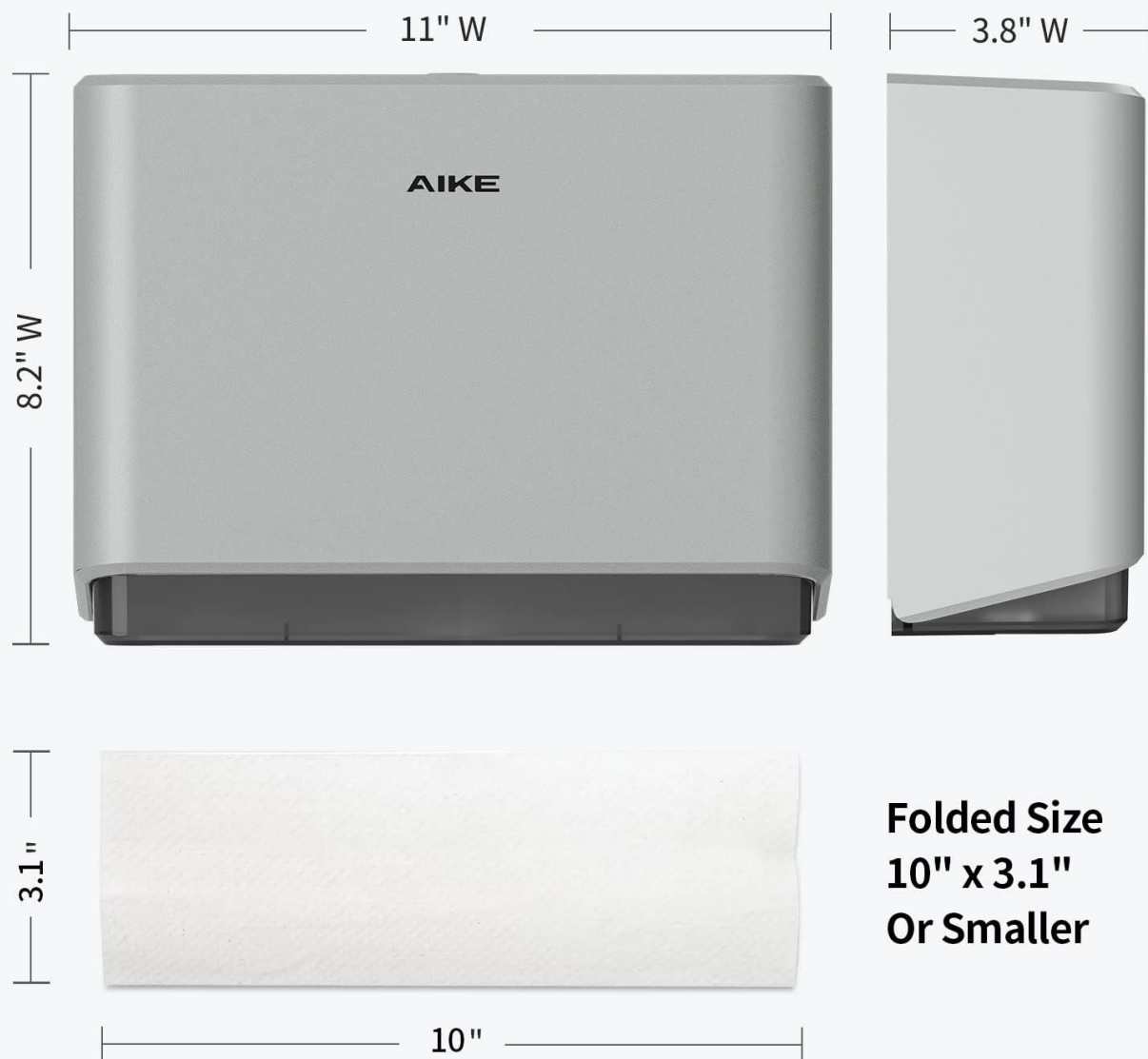

Image: The AIKE Paper Towel Dispenser (AK5101) with its key dimensions labeled, including width, height, and depth, and compatible paper towel size.

## 4. INSTALLATION GUIDE

Proper installation is crucial for the optimal performance and longevity of your AIKE products. Please follow these instructions carefully.

### 4.1. AIKE Vertical Hand Dryer (Model AK2065) Installation

The hand dryer is designed for wall-mounting. Choose a suitable location with access to a power outlet and sufficient clearance for hand drying. It is recommended to consult a qualified electrician for electrical connections if direct wiring is required.

1. **Select Location:** Choose a sturdy wall surface, ideally near a sink, ensuring adequate space for users.
2. **Mark Drilling Points:** Hold the hand dryer against the wall at the desired height and mark the mounting hole locations.
3. **Drill Holes:** Drill holes at the marked points using an appropriate drill bit for your wall type. Insert wall anchors if necessary.
4. **Mount Hand Dryer:** Secure the hand dryer to the wall using the provided screws. Ensure it is firmly attached and level.

5. **Connect Power:** Plug the hand dryer into a grounded electrical outlet. If hardwiring, ensure power is off at the circuit breaker before connecting.



Image: Two AIKE Hand Dryers (AK2065) mounted on a wall in a modern bathroom setting, demonstrating typical installation placement.

## 4.2. AIKE Multifold Paper Towel Dispenser (Model AK5101) Installation

The paper towel dispenser offers two installation methods: drill installation with screws or nail-free sticker installation.

### 1. Method 1: Drill Installation with Screws

- **Mark Drilling Points:** Open the dispenser and hold it against the wall at the desired height. Mark the locations for the mounting holes.
- **Drill Holes:** Drill holes at the marked points. Insert wall anchors if needed.
- **Mount Dispenser:** Secure the dispenser to the wall using the provided screws.

### 2. Method 2: Nail-Free Sticker Installation

- **Clean Surface:** Ensure the wall surface is clean, dry, and smooth.
- **Apply Stickers:** Peel the backing from the adhesive stickers and apply them to the designated areas on the back of the dispenser.
- **Mount Dispenser:** Press the dispenser firmly against the wall at the desired location for at least 30 seconds. Allow adhesive to set for several hours before loading with paper towels.

# Two-methods easy installation

## 01 Drill installation with screws.

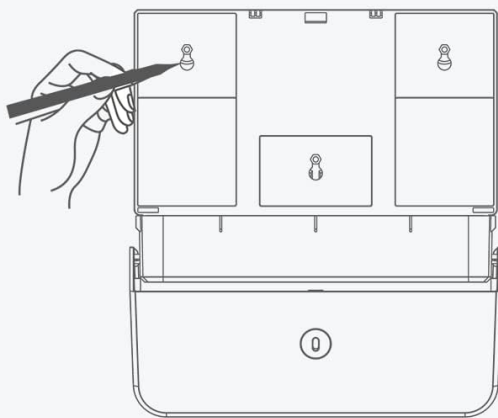

## 02 Nail-free sticker installation

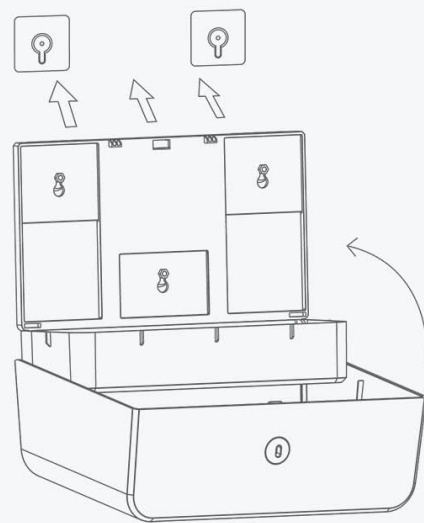

Image: Diagram illustrating the two installation methods for the AIKE Paper Towel Dispenser: drill installation with screws and nail-free sticker installation.

## 5. OPERATING INSTRUCTIONS

### 5.1. AIKE Vertical Hand Dryer (Model AK2065) Operation

The AIKE Vertical Hand Dryer operates automatically via an infrared sensor.

1. **Activate:** Place your hands into the drying chamber from the top opening. The sensor will detect your hands and automatically activate the airflow.
2. **Dry Hands:** Move your hands slowly up and down within the drying chamber to ensure all surfaces are dried.
3. **Deactivate:** Remove your hands from the drying chamber. The airflow will automatically stop after a few seconds.

### 5.2. AIKE Multifold Paper Towel Dispenser (Model AK5101) Operation

This dispenser is designed for easy loading and dispensing of multifold paper towels.

#### 1. Loading Paper Towels:

- Open the dispenser cover (usually by a latch or key).
- Place a stack of multifold paper towels into the dispenser, ensuring they are aligned correctly.

- Pull the first towel through the dispensing slot at the bottom.
- Close the dispenser cover securely.

2. **Dispensing:** Gently pull a single paper towel from the bottom slot. The next towel will automatically present itself.



Image: A hand pulling a paper towel from the AIKE Multifold Paper Towel Dispenser, demonstrating its ease of use.

## 6. CARE AND MAINTENANCE

Regular cleaning and maintenance will ensure the longevity and hygienic operation of your AIKE products.

### 6.1. AIKE Vertical Hand Dryer (Model AK2065) Maintenance

- **Exterior Cleaning:** Wipe the exterior surfaces with a soft, damp cloth and mild, non-abrasive cleaner. Do not use harsh chemicals or abrasive materials.
- **Water Collection Reservoir:** Periodically check and empty the water collection reservoir located at the bottom of the unit. This prevents water accumulation and potential spills.
- **Air Intake Filter (if applicable):** Some models may have an air intake filter. Refer to specific product documentation for cleaning or replacement instructions if present.
- **Power Disconnection:** Always disconnect power before performing any cleaning or maintenance.



## 6.2. AIKE Multifold Paper Towel Dispenser (Model AK5101) Maintenance

- **Exterior Cleaning:** Clean the exterior with a soft, damp cloth. Avoid abrasive cleaners that may scratch the surface.
- **Interior Cleaning:** Periodically open the dispenser and wipe down the interior to remove any paper dust or debris.
- **Check for Obstructions:** Ensure the dispensing mechanism is free from obstructions to prevent jamming.

## 7. TROUBLESHOOTING

If you encounter issues with your AIKE products, please refer to the following common problems and solutions before contacting support.

### 7.1. AIKE Vertical Hand Dryer (Model AK2065) Troubleshooting

Problem	Possible Cause	Solution
Hand dryer does not activate.	No power; Sensor obstructed or dirty; Hands not positioned correctly.	Check power connection and circuit breaker. Clean sensor window. Ensure hands are fully inserted into the drying chamber.
Weak airflow.	Air intake blocked; Motor issue.	Check for obstructions around air intake. If problem persists, contact customer support.
Water leaking from unit.	Water collection reservoir full or improperly seated.	Empty and properly re-seat the water collection reservoir.

### 7.2. AIKE Multifold Paper Towel Dispenser (Model AK5101) Troubleshooting

Problem	Possible Cause	Solution
Paper towels jam.	Incorrect paper towel type/size; Overloaded dispenser; Debris in mechanism.	Ensure using multifold towels of compatible size (10" x 3.1" or smaller). Do not overfill. Clear any debris from the dispensing slot.
Dispenser cover does not close.	Paper towels obstructing closure; Latch/hinge issue.	Adjust paper towel stack. Check for any foreign objects.





## 8. WARRANTY AND CUSTOMER SUPPORT

AIKE products are manufactured with quality and durability in mind. For specific warranty details, please refer to the warranty card included with your purchase or visit the official AIKE website.

If you require further assistance, have questions, or need to report an issue that cannot be resolved using the troubleshooting guide, please contact AIKE customer support:

- **Website:** [Visit the AIKE Store on Amazon](#)
- **Email:** Refer to product packaging or official website for email contact.
- **Phone:** Refer to product packaging or official website for phone contact.

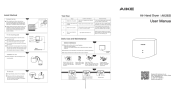
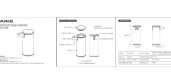
Please have your model numbers (AK2065, AK5101) and purchase information ready when contacting support.

	<p><a href="#">AIKE AK2065 Jet Hand Dryer User Manual - Installation, Features, and Maintenance</a></p> <p>Comprehensive user manual for the AIKE AK2065 Jet Hand Dryer. Covers installation procedures, features, specifications, maintenance, troubleshooting, and safety precautions for optimal use.</p>
	<p><a href="#">AIKE High Speed Hand Dryer AK2822 User Manual</a></p> <p>User manual for the AIKE High Speed Hand Dryer, model AK2822. Provides instructions on operation, routine maintenance, cleaning the air filter, installation, troubleshooting, and technical specifications.</p>
	<p><a href="#">AIKE AK2630S High Speed Hand Dryer User Manual</a></p> <p>This manual provides instructions for the installation, operation, and maintenance of the AIKE AK2630S High Speed Hand Dryer. It includes safety precautions, troubleshooting tips, and product specifications in multiple languages.</p>
	<p><a href="#">AIKE AK2630 Air Hand Dryer User Manual</a></p> <p>User manual for the AIKE AK2630 Air Hand Dryer, covering installation, testing, daily use, maintenance, specifications, and safety precautions.</p>
	<p><a href="#">AIKE AK1333 Automatic Soap Dispenser User Manual and Specifications</a></p> <p>Detailed user manual and specifications for the AIKE AK1333 Automatic Sensor Soap Dispenser, including how to use, warnings, packing list, and liquid adjustment features.</p>
	<p><a href="#">AIKE AK1205 Automatic Soap Dispenser User Manual</a></p> <p>User manual for the AIKE AK1205 Automatic Soap Dispenser. Provides detailed instructions on installation, operation, liquid adjustment, battery management, troubleshooting, and specifications for the AIKE automatic soap dispenser.</p>