

Shad H0RB12IF

Shad 3P System Side Kit Instruction Manual

For Honda Rebel CMX 1100

PRODUCT OVERVIEW

The Shad 3P System side kit is an innovative solution designed to integrate seamlessly with your Honda Rebel CMX 1100. This system focuses on an integrated design, ensuring the side mounting blends well with the motorcycle's aesthetics.

Key features include its **lightweight construction**, which minimizes impact on the bike's center of gravity, thereby enhancing safety. The system is also noted for its **ease of assembly** and overall **durability** and **robustness**.

This product is 100% designed and manufactured in Barcelona, reflecting a commitment to quality.

PACKAGE CONTENTS

Before beginning installation, please verify that all components are present in the package:

- Fitting kits
- Screw set
- All necessary mounting hardware for the 3P System

If any items are missing or damaged, please contact your retailer or Shad customer support.

INSTALLATION GUIDE

The Shad 3P System is designed for straightforward installation, typically taking 20 minutes or less for experienced users. Follow these general steps for mounting the side kit:

1. **Prepare the Motorcycle:** Ensure the motorcycle is stable and on a level surface. It is recommended to have the bike on a stand.
2. **Identify Mounting Points:** Locate the designated mounting points on the motorcycle frame, typically near the rear footpegs and under the seat/fender area. Refer to the specific diagrams provided with your physical fitting kit for precise locations.
3. **Attach Brackets:** Secure the main mounting brackets to the motorcycle frame using the provided screws and fasteners. Ensure all connections are hand-tightened initially.

4. **Assemble 3P System Frame:** Connect the various components of the 3P system frame according to the included instructions.
5. **Mount 3P System to Brackets:** Attach the assembled 3P system frame to the previously installed mounting brackets.
6. **Final Tightening:** Once all components are in place and aligned, progressively tighten all screws and bolts to the manufacturer's specified torque settings. Do not overtighten.
7. **Check Clearance:** Verify that the installed system does not interfere with any moving parts of the motorcycle, such as the suspension or wheels, and that there is adequate clearance for passenger footpegs if applicable.



Image: The Shad 3P System side kit seamlessly integrated onto a Honda Rebel CMX 1100. This view highlights the low-profile design when no luggage is attached.



Image: A closer view of the Shad 3P System side kit on the Honda Rebel CMX 1100, illustrating the attachment points and how the system maintains the bike's aesthetic.

Important Note for Rebel 1100 T Models:

For installation on the Honda Rebel 1100 T model, modifications to the support bracket may be necessary. The footpeg position on the 1100 T differs from the standard Rebel 1100. This may require cutting, welding, and repainting the bracket for proper adaptation. It is recommended to consult a professional if you are not comfortable performing these modifications.

OPERATING THE 3P SYSTEM

The 3P System is designed to be compatible with Shad's range of side cases, such as the SH38X Expandable Side Case and Click System Bags (E03, E09CL PRO, E09CM). These cases feature a convenient **Click System** for easy attachment and detachment.

To attach a compatible side case:

1. Align the mounting points on the side case with the corresponding pins on the 3P System frame.
2. Push the case firmly onto the frame until you hear an audible "click," indicating it is securely locked in place.
3. Verify the case is firmly attached by gently pulling on it.

To detach a side case:

1. Insert the key into the lock mechanism on the side case and turn it to the unlock position.
2. Press the release button (if applicable) or pull the release lever.
3. Gently lift the side case off the 3P System frame.



Image: An example of a compatible Shad side case (SH38X) that utilizes the 3P System for mounting. Note the expansion feature for increased capacity.

MAINTENANCE

To ensure the longevity and optimal performance of your Shad 3P System, regular maintenance is recommended:

- **Cleaning:** Clean the metal components regularly with a mild soap and water solution. Avoid abrasive cleaners or solvents that could damage the finish.

- **Fastener Check:** Periodically inspect all screws and bolts for tightness. Vibrations from riding can cause fasteners to loosen over time. Re-tighten as necessary, referring to the original installation instructions for torque specifications if available.
- **Corrosion Prevention:** If riding in wet or corrosive conditions, consider applying a rust-inhibiting spray to exposed metal parts after cleaning and drying.
- **Inspect for Damage:** Regularly check the frame for any signs of bending, cracks, or other damage. If damage is found, discontinue use and contact Shad support for advice.

TROUBLESHOOTING

This section addresses common issues you might encounter with your Shad 3P System.

Issue: Difficulty installing the 3P System on a Honda Rebel 1100 T.

Possible Cause: The Honda Rebel 1100 T model has a different footpeg position compared to the standard Rebel 1100, which can cause interference with the 3P System's support bracket.

Solution: Adaptation of the support bracket may be required. This could involve cutting, welding, and repainting the bracket to ensure proper fitment. It is strongly advised to seek assistance from a qualified mechanic or fabrication specialist if you are not equipped or experienced in performing such modifications.

Issue: Side cases feel loose or rattle after installation.

Possible Cause: Mounting bolts may not be sufficiently tightened, or the side case is not fully engaged with the Click System.

Solution:

- Re-check all installation bolts and ensure they are tightened to the recommended torque specifications.
- Ensure the side case is pushed firmly onto the 3P System until an audible "click" is heard, indicating it is fully locked.
- Inspect the Click System mechanism on both the case and the 3P System for any obstructions or damage.

SPECIFICATIONS

Attribute	Detail
Brand	Shad
Model Number	H0RB12IF
Manufacturer	SHAD
Item Weight	5.28 pounds (approx. 2.4 kg)
Package Dimensions	23.23 x 15.35 x 4.72 inches (approx. 59 x 39 x 12 cm)
Compatibility	Honda Rebel CMX 1100 (Note: Potential modifications for 1100 T model)
Design Features	Integrated design, lightweight, robust, easy to assemble
Manufacturing Origin	100% designed and manufactured in Barcelona

WARRANTY AND SUPPORT

For specific warranty information regarding your Shad 3P System, please refer to the documentation provided with your purchase or visit the official Shad website. Warranty terms and conditions may vary by region and retailer.

If you require technical assistance, have questions about installation, or need to report a defect, please contact Shad customer support directly through their official channels. Contact information can typically be found on the manufacturer's website or on the product packaging.

Related Documents - H0RB12IF

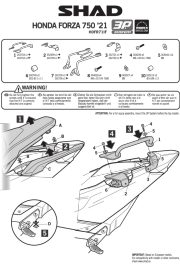
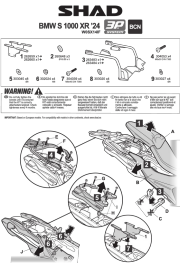
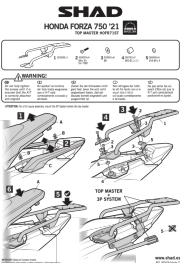
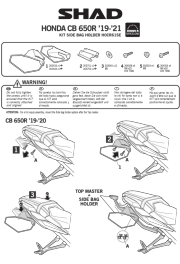
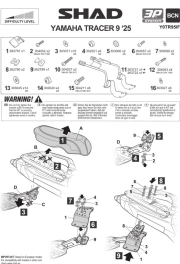
	<p>SHAD 3P System Installation Guide - Honda Forza 750 '21</p> <p>Comprehensive installation instructions for the SHAD 3P System luggage rack on a 2021 Honda Forza 750. Includes parts list, step-by-step assembly, and important warnings.</p>
	<p>SHAD 3P System Side Case Racks for BMW S 1000 XR '24 Installation Guide</p> <p>Installation guide for the SHAD 3P System Side Case Racks (W0SX14IF) designed for the BMW S 1000 XR '24 motorcycle. Provides detailed steps and parts list for mounting.</p>
	<p>SHAD Top Master HOF71ST Installation Guide for Honda Forza 750 '21</p> <p>Concise installation guide for the SHAD Top Master HOF71ST luggage rack system on the Honda Forza 750 (2021 model). Includes parts list and step-by-step instructions with textual descriptions of diagrams.</p>
	<p>SHAD Kit Side Bag Holder HOCR61SE for Honda CB 650R '19-'21 Installation Guide</p> <p>Official installation guide for the SHAD Kit Side Bag Holder (HOCR61SE) designed for the Honda CB 650R motorcycle models from 2019 to 2021. Includes parts list and assembly steps.</p>
	<p>SHAD 3P System Mounting Kit for Yamaha Tracer 9 '25 (YOTR95IF) - Assembly Instructions</p> <p>Detailed assembly instructions for the SHAD 3P System side case mounting kit for the Yamaha Tracer 9 motorcycle (2025 model). Includes parts list, warnings, and step-by-step visual guidance.</p>

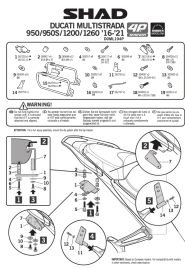

[SHAD 4P System Installation Guide for Ducati Multistrada 950/950S/1200/1260 \(2016-2021\)](#)

Detailed installation instructions and parts list for the SHAD 4P System side case racks designed for Ducati Multistrada 950, 950S, 1200, and 1260 models from 2016 to 2021. Includes warnings and assembly steps.