

[manuals.plus](#) /

› [Phomemo](#) /

› [Phomemo Thermal Label Printer, 4X6 Shipping Labels Printer for Small Business, Wireless Label Printers for Package for Phone & Pad & PC, Used for Ebay, UPS, Shopify, TikTok, USPS, FedEx, DHL, Temu Blue](#)

## Phomemo 241BT

# Phomemo Thermal Label Printer 241BT User Manual

Model: 241BT | Brand: Phomemo

## 1. INTRODUCTION

The Phomemo 241BT Thermal Label Printer is designed for efficient and high-quality label printing for various applications, including shipping, small business, and personal use. This printer utilizes advanced thermal direct technology, eliminating the need for ink or toner. It supports both wireless (Bluetooth) and wired (USB) connections, offering versatility across multiple devices and operating systems.



Image: The Phomemo 241BT printer actively printing a shipping label, surrounded by various label types and a smartphone connected via Bluetooth.

Image: The Phomemo 241BT printer demonstrating connectivity with both a laptop via USB and a smartphone via Bluetooth, highlighting its multi-system compatibility.

Key features include:

- **Inkless Printing:** Advanced thermal direct technology removes the need for expensive toner or ink.
- **High-Speed Output:** Prints up to 72 sheets of 4x6 labels per minute.
- **High Resolution:** 203 DPI ensures clear and precise printing.
- **Versatile Connectivity:** Supports Bluetooth for mobile devices (iOS/Android) and USB for PC (Windows, Mac OS, Chrome OS, Linux).
- **Wide Compatibility:** Works with major shipping and sales platforms like eBay, Shopify, Amazon, Etsy, UPS, USPS, FedEx, and DHL.
- **Adaptable Label Width:** Accommodates labels from 1 to 4.6 inches (25.4-117mm).

## 2. WHAT'S IN THE BOX

Please verify that all components are present in the package:

- 1 x Phomemo 241BT Label Printer
- 10 sheets of 4x6 thermal label paper
- 1 x Power Adapter and Cord
- 1 x Type C Adapter and USB Cable
- 1 x User Guide

# Package Includes

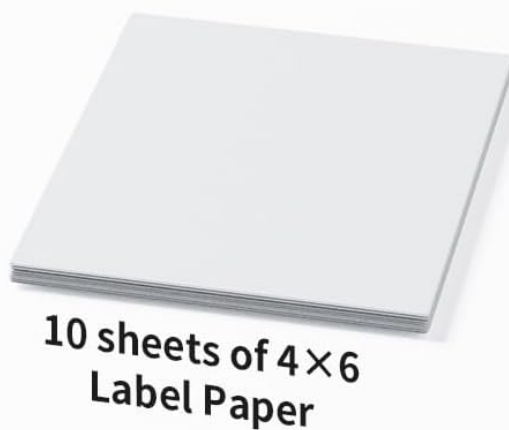
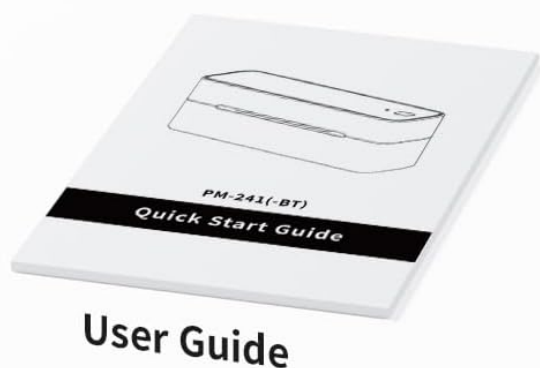
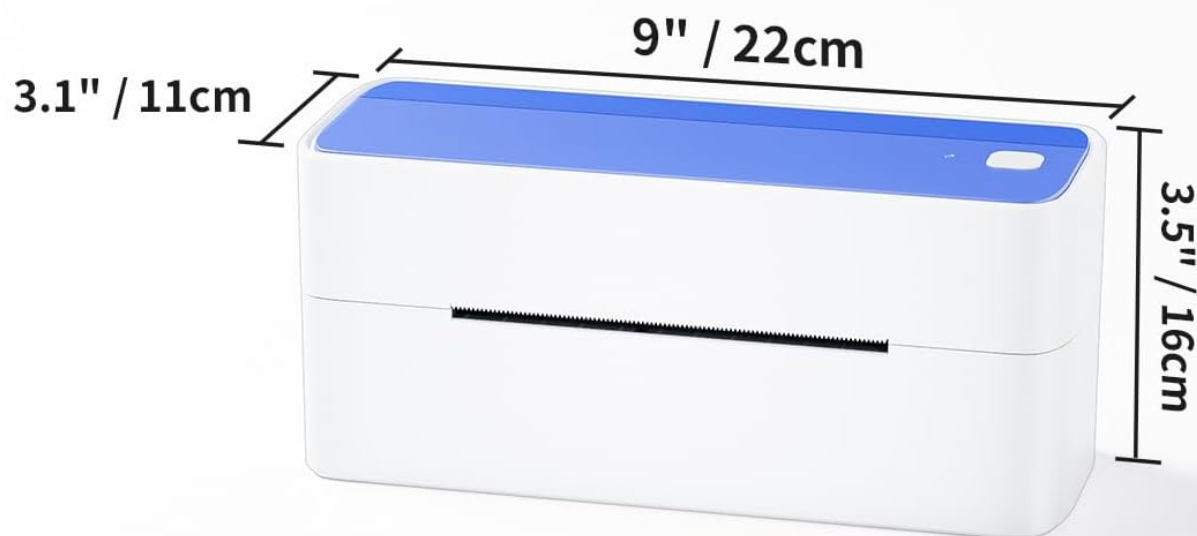

## 3. SETUP GUIDE

### 3.1. Hardware Connection

1. **Connect Power:** Plug the power adapter into the printer's power port and then into a wall outlet.
2. **Connect USB (Optional):** For wired printing, connect one end of the USB cable to the printer and the other end to your computer. Use the Type C adapter if your computer requires it.

### 3.2. Software Installation

#### For Mobile Devices (iOS & Android - Wireless Bluetooth)

1. **Download "Labelife" App:** Search for "Labelife" in the Apple App Store (for iOS) or Google Play Store (for Android) and download the application.
2. **Enable Bluetooth:** Turn on Bluetooth on your mobile phone or tablet.
3. **Connect in App:** Open the "Labelife" app and follow the in-app instructions to connect to your Phomemo 241BT printer via Bluetooth.

### How to Download 'Labelife' App on Phone?

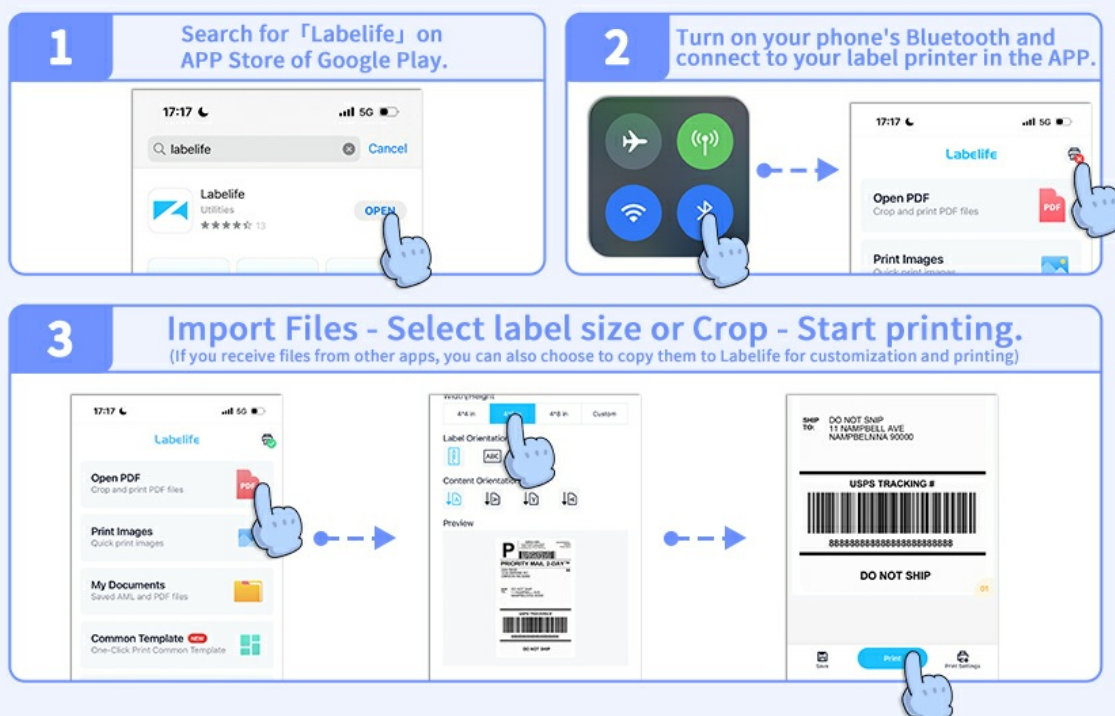

Image: Visual instructions for downloading the Labelife app, enabling Bluetooth, and connecting to the printer for wireless printing.

#### For Computers (Windows, Mac OS, Chrome OS, Linux - USB Wired)

1. **Download Driver:** Visit [labelife.net/pm241](http://labelife.net/pm241) to download the appropriate driver for your operating system (Windows, Mac OS, Linux).
2. **Install Driver:** Follow the on-screen instructions to install the downloaded driver.
3. **For Chrome OS:** Enter "Labelife" in the Chrome Web Store and add the extension to your Google Chrome browser.



# USB wired connection

## Laptop & Desktop computers



Windows



Mac



Chrome



Linux

USB connection printing need to download and install the driver



Driver URL: [labelife.net/pm241](http://labelife.net/pm241)

Image: The Phomemo 241BT printer connected via USB to a laptop, illustrating compatibility with various desktop operating systems and the need for driver installation.

### 3.3. Loading Labels

The Phomemo 241BT supports thermal labels with widths ranging from 1 inch (25.4mm) to 4.6 inches (117mm). Ensure labels are loaded correctly for optimal printing.

1. Open the printer cover.

2. Insert the label roll or fan-fold labels into the label compartment, ensuring the printable side faces up.
3. Adjust the label guides to fit the width of your labels snugly, without being too tight.
4. Close the printer cover. The printer will automatically detect the label size and calibrate.

## Adaptable label width: 25.4-117mm (1"-4.6")



Image: A visual representation of the printer's capability to handle different label widths and types, from small circular labels to standard 4x6 shipping labels.

## 4. OPERATING INSTRUCTIONS

#### 4.1. Printing via USB Cable (PC)

1. Ensure the printer is connected to your PC via USB and the driver is installed.
2. Open the document or label file you wish to print on your computer.
3. Select "Print" from your application's menu.
4. Choose the Phomemo 241BT printer from the list of available printers.
5. Adjust print settings (e.g., label size, orientation) as needed in the print dialogue box.
6. Click "Print" to start printing.

#### 4.2. Printing Wirelessly (Mobile App)

1. Ensure your mobile device is connected to the Phomemo 241BT via Bluetooth through the "Labelife" app.
2. Within the "Labelife" app, import the file (PDF, image) you want to print.
3. Select the desired label size or crop the content as necessary.
4. Preview the label to ensure correct formatting.
5. Tap "Print" to send the job to the printer.

#### 4.3. Supported Platforms and Applications

The Phomemo 241BT printer is compatible with a wide range of e-commerce and shipping platforms, facilitating label creation for various services.



# Widely used on various platforms



Image: A display of logos from numerous online platforms and shipping carriers that are compatible with the Phomemo 241BT label printer.

Common applications include:

- Shipping labels for major carriers (UPS, USPS, FedEx, DHL).
- Labels for e-commerce platforms (Amazon, eBay, Shopify, Etsy, Poshmark, Temu).
- Barcode labels for inventory management.
- Product labels and notes for various business needs.



# Suitable for Different Use



Shopping



Logo



Barcode



Note

Image: Various applications of the Phomemo 241BT printer, showing labels used for shopping, logos, barcodes, and notes in different settings.

## 5. MAINTENANCE

Regular maintenance ensures the longevity and optimal performance of your Phomemo 241BT printer.

- **Cleaning the Print Head:** Use an alcohol wipe or a specialized print head cleaning pen to gently clean the thermal print head. Ensure the printer is off and cooled down before cleaning.
- **Cleaning the Exterior:** Wipe the exterior of the printer with a soft, damp cloth. Avoid using harsh chemicals.
- **Dust Removal:** Keep the label compartment free of dust and debris to prevent paper jams and maintain print quality.
- **Storage:** Store the printer in a cool, dry place away from direct sunlight and extreme temperatures when not in use.

## 6. TROUBLESHOOTING

This section addresses common issues you might encounter with your Phomemo 241BT printer.

Problem	Possible Cause	Solution
No Power	Power cable not connected; power outlet issue.	Ensure power cable is securely connected to printer and a working outlet.
Poor Print Quality	Dirty print head; incorrect label type; low resolution setting.	Clean the print head. Ensure you are using thermal labels. Check print settings for 203 DPI resolution.
Labels Not Feeding Correctly	Labels loaded incorrectly; label guides not adjusted; label jam.	Reload labels, ensuring they are straight and guides are snug. Clear any jammed labels.
Cannot Connect via Bluetooth	Bluetooth not enabled; app not open; printer not discoverable.	Ensure Bluetooth is on your device. Open the "Labelife" app and follow connection steps. Restart printer and device.
Cannot Print via USB	Driver not installed; incorrect USB port; cable issue.	Install the correct driver from <a href="https://labelife.net/pm241">labelife.net/pm241</a> . Try a different USB port or cable.

## 7. SPECIFICATIONS

Feature	Detail
Model Name	241BT
Printing Technology	Thermal
Connectivity Technology	Bluetooth, USB
Maximum Media Size	4 x 6 inch (117mm width)
Maximum Print Resolution	203 DPI
Max Print Speed (Monochrome)	66 ppm (72 sheets of 4x6 labels per minute)
Compatible Devices	PC (Windows, Mac OS, Chrome OS, Linux), Smartphones (iOS, Android)

Feature	Detail
Product Dimensions	8.66 x 6.3 x 4.41 inches (22 x 16 x 11.2 cm)
Item Weight	2.84 pounds (1.29 kg)
Control Method	App (Labelife)
Included Components	Printer, 10 sheets 4x6 thermal label paper, Power Adapter and Cord, Type C Adapter and USB Cable, User Guide

## 8. WARRANTY AND SUPPORT

Phomemo provides a limited warranty for the 241BT Thermal Label Printer. For specific warranty terms and conditions, please refer to the official Phomemo website or the documentation included with your product. For technical support, inquiries, or assistance with your Phomemo product, please contact the professional support team:





- **Phone Call:** (9:00-17:00 Mon-Fri EST)
- **Email:** (5x24 Hours Mon-Fri EST)
- Support includes live chat, phone calls, emails, and remote desktop operation.

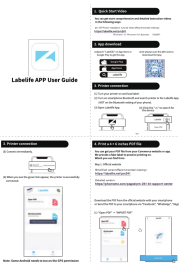
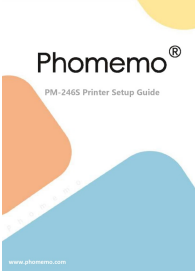
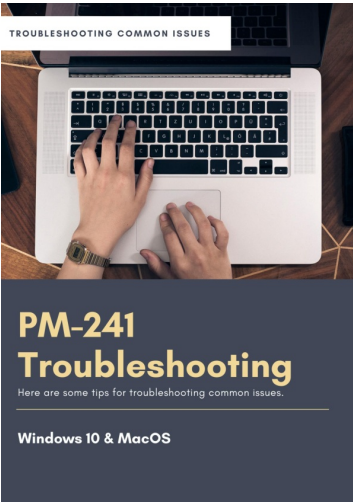

Image: A customer service representative, representing the available support channels for the product.

### Related Documents - 241BT



	<p><a href="#">Phomemo 241-BT Bluetooth Thermal Label Printer: Installation and User Resources</a></p> <p>Find installation tutorials, user guides, and support resources for the Phomemo 241-BT Bluetooth Thermal Label Printer, a wireless solution for small businesses and shipping.</p>
	<p><a href="#">Phomemo PM-246S Printer Setup Guide</a></p> <p>This comprehensive setup guide provides detailed instructions for installing and configuring the Phomemo PM-246S label printer. It covers essential topics such as adjusting label margins, creating custom label sizes, and integrating the printer with popular e-commerce and shipping platforms like Amazon FBA, UPS, Shopify, Etsy, and more. Users will find valuable troubleshooting tips and support resources to ensure optimal performance of their Phomemo PM-246S.</p>
	<p><a href="#">Phomemo PM-246S Label Printer Setup Guide and Troubleshooting</a></p> <p>This comprehensive guide provides detailed instructions for setting up the Phomemo PM-246S label printer on Mac and Windows, including driver installation, troubleshooting common issues, and configuring settings for various e-commerce platforms.</p>
	<p><a href="#">Phomemo PM-246S Label Printer Setup and Troubleshooting Guide</a></p> <p>Comprehensive setup guide and troubleshooting manual for the Phomemo PM-246S label printer, covering driver installation for Mac and Windows, label adjustments, and platform-specific printing instructions.</p>
	<p><a href="#">Phomemo PM-246S Label Printer Setup Guide &amp; Troubleshooting</a></p> <p>Comprehensive setup guide for the Phomemo PM-246S label printer, including driver installation for Mac and Windows, detailed troubleshooting steps, and integration instructions for various e-commerce platforms and shipping services.</p>
	<p><a href="#">Phomemo PM-246S Logistics Label Printer Quick Start Guide</a></p> <p>This quick start guide provides comprehensive instructions for setting up and using the Phomemo PM-246S Logistics Label Printer. Learn about printer components, label loading, driver installation for macOS and Windows, printer settings, status light indicators, feed button functions, maintenance, and safety notices for optimal performance and longevity.</p>



[PM-241 Label Printer Troubleshooting Guide for Windows & MacOS](#)

Comprehensive troubleshooting guide for Phomemo PM-241 label printer, covering common issues like print quality, label feeding, and connectivity on Windows 10 and MacOS.

lang:en score:31 filesize: 1.79 M page\_count: 16 document date: 2021-09-30

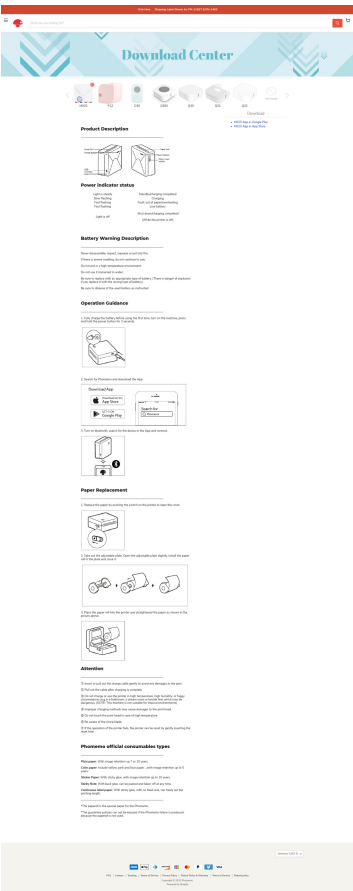

[Phomemo Portable Thermal Printer User Guide & Operation Manual](#)

Comprehensive user guide for Phomemo portable thermal printers, including models like M02S, D30, and Q30S. Learn about product features, power indicators, battery safety, app download, Bluetooth connection, and paper replacement. Discover official Phomemo consumables.

lang:en score:28 filesize: 487.31 K page\_count: 1 document date: 2023-09-20



[\[pdf\]](#) Quick Start Guide Troubleshooting Guide Guide Warranty Label

Phomemo Upgrade 241BT Bluetooth Thermal Shipping Label Printer Wireless 4x6 for Package Small Business Connection ChromeOS Mac Windows Phone Super Easily Black and White 241 User Guide B0CCNPGJ6F B09JBVHTZS C1CeQbyLleL m media amazon images I |||

1 Support Your label printer is covered by a one-year warranty. In the unlikely event that you experience any issues with your printer, please contact priority customer service to promptly receive troubleshooting tips for a replacement. Contact information: Tel 1 833 940 3818US and CA only Servic...

lang:en **score:26** filesize: 7.76 M page\_count: 84 document date: 2021-09-30



[\[pdf\]](#) Guide Label

PM241BT ZX V2 241209 Phomemo Label Printer 241BT Thermal for Shipping Packages Small Business Pink 4x6 Printers Compatible with Android iOS Windows Widely Used Amazon Ebay UPS Shopify and White PINK GM User Guide B0DRJ7DN4P B0DH1TDXDB B0BRMRD91W B09PVB6QF7 B0CW39K9T3 C1FjMz92WnL m media amazon images I |||

Printer 1 Power Adapter 1 Power Cord 1 USB Cable 1 ...

lang:en **score:17** filesize: 6.47 M page\_count: 9 document date: 2025-03-21



[\[pdf\]](#) User Manual Guide Label

PM 241 BT A2 20220308 Manuale utente Phomemo 241BT Bluetooth stampante etichette 4 x 6 DHL Stampante Termica Etichette Label Printer Connessione wireless compatibile con Phone PC USPS FedEx Amazon DPD Shopify Ebay it Cancelleria e prodotti per ufficio C1TeU9OXfAL m media amazon images I |||

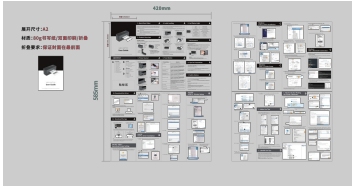

Logistics Label Printer User Guide For more language user manuals please search the brand website. 143.25 102 Logistics Label Printer User Guide For more language user manuals please search the brand website. CONTENT A Overview 1. Quick Start Video 2. Product Overview 3. Printer Started 4. La...

lang:en score:15 filesize: 5.11 M page\_count: 1 document date: 2022-03-08



[\[pdf\]](#) Label

Bekijk de CE marking Phomemo 241BT Draadloze Thermische Label Printer 102 x 150 MM Geschikt voor bol original media s xxPZzNy32VBq |||

...

lang:en score:14 filesize: 134.38 K page\_count: 1 document date: 2024-05-21