

ESOXOFFORE ABS-681

ESOXOFFORE Kids Instant Print Camera User Manual

Model: **ABS-681**

Brand: **ESOXOFFORE**

1. INTRODUCTION

This manual provides essential information for the safe and effective operation of your ESOXOFFORE Kids Instant Print Camera. Please read this manual thoroughly before using the product and retain it for future reference. This digital camera is designed for children aged 3-12, offering instant printing capabilities, 1080P video recording, and various creative features.



Image 1.1: Front view of the ESXOFFORE Kids Instant Print Camera, highlighting its compact design and screen interface.

2. WHAT'S IN THE BOX

Verify that all the following items are included in your package:

- 1 x ESXOFFORE Kids Instant Print Camera (Blue)
- 3 x Print Paper Rolls
- 1 x Lanyard
- 1 x User Manual
- 1 x 32GB SD Card
- 1 x USB Type-C Charging Cable

Easy to install and use

2.5Hours continuous usage



1



Push up the part with lens to open the paper slot

2



Install the printing paper into the slot

3



Close two parts of the camera



Print Paper Roll
x 3



Lanyard
x 1

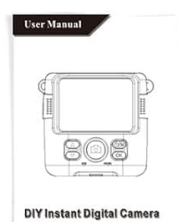

User Manual
x 1



32G SD Card
x 1



Type-C
x 1

Image 2.1: All components included with the camera, demonstrating the complete package contents.

3. PRODUCT FEATURES

The ESOXOFFORE Kids Instant Print Camera offers a range of features designed for an engaging user experience:

- **Instant Print Function:** Print black and white photos directly from the camera in approximately one second.
- **High-Resolution Video:** Record videos in 1080P quality.
- **Digital Zoom:** Features up to 16X digital zoom for capturing distant subjects.
- **Creative Filters & Stickers:** Includes 15 scene filters and 16 sticker options to enhance photos.
- **Time-Lapse Photography:** Set a 3-second time-lapse for delayed shots.
- **Continuous Shooting:** Capture multiple photos in quick succession.
- **Built-in Games:** Enjoy 4 pre-installed puzzle games.
- **MP3 Playback:** Supports MP3 audio playback.
- **Type-C Charging:** Fast and convenient charging via a Type-C port.
- **Durable Design:** Constructed with high-quality soft plastic and a shockproof shell for enhanced

protection.

- **2.4-inch Screen:** A clear display for viewing photos and videos.



Image 3.1: Visual representation of the camera's key functionalities.

4. SETUP

4.1 Charging the Camera

Before first use, fully charge the camera. Connect the provided USB Type-C cable to the camera's charging port and a compatible USB power adapter (not included). The charging indicator will show the charging status. A full charge typically provides 2-3 hours of continuous use.

4.2 Installing the SD Card

The camera comes with a 32GB SD card for storing color photos and videos. Locate the SD card slot, usually on the side or bottom of the camera. Insert the SD card with the metal contacts facing the correct direction until it clicks into place.

4.3 Installing Print Paper

Follow these steps to install the thermal print paper:

1. Gently push up the part with the lens to open the paper slot.
2. Insert a new roll of thermal printing paper into the slot. Ensure the paper feeds out from the top of the roll, facing towards the printing mechanism.
3. Close the camera body securely until it clicks.

How to correctly install paper

1



2



Pay attention to the direction of the paper installation. If put it in wrong direction, it can not print with image.

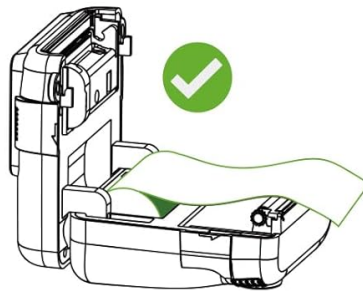

Image 4.1: Correct paper installation. Ensure the paper direction is accurate for proper printing.

5. OPERATING INSTRUCTIONS

5.1 Power On/Off

Press and hold the power button (usually marked with a power symbol) to turn the camera on or off.

5.2 Taking Photos

In photo mode, frame your shot using the screen. Press the shutter button (often a large, central button) to capture an image. The camera will instantly print a black and white version, while a color version is saved to the SD card.

5.3 Video Recording

Switch to video mode using the mode button. Press the shutter button to start recording and press it again to stop. Videos are saved to the SD card.



Image 5.1: The camera supports 1080P video recording and features digital zoom.

5.4 Digital Zoom

Use the zoom buttons (often marked with '+' and '-') to adjust the 16X digital zoom level before taking a photo or recording a video.

5.5 Applying Filters and Stickers

Navigate through the camera's menu to access the 15 scene filters and 16 sticker frames. Select your desired effect before capturing a photo.



Image 5.2: Examples of creative stickers and frames available for photos.

5.6 Time-Lapse Function

Activate the time-lapse feature (e.g., 3-second delay) from the settings menu to allow time to pose before the photo is taken.



Image 5.3: The time-lapse feature allows for delayed photo capture.

5.7 Playing Games

Access the games menu to select and play from the 4 pre-installed puzzle games.



Image 5.4: The camera includes four engaging puzzle games.

5.8 Printing Options

The camera offers different print density modes (Low, Medium, High) which can be adjusted in the settings for desired print quality.

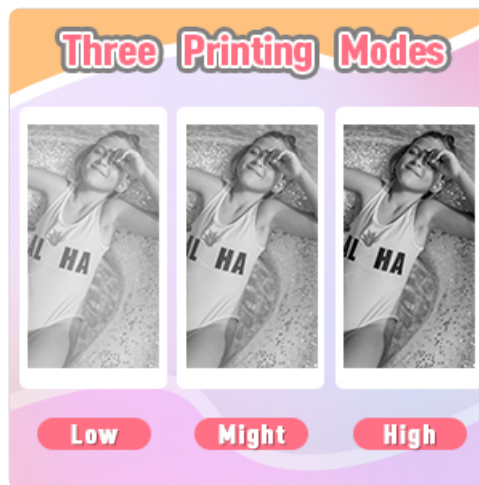

Image 5.5: Adjusting print density for optimal results.

6. MAINTENANCE

6.1 Cleaning the Camera

Use a soft, dry cloth to clean the camera body. For the lens, use a specialized lens cleaning cloth. Avoid using liquid cleaners or abrasive materials.

6.2 Storing the Camera

Store the camera in a cool, dry place away from direct sunlight and extreme temperatures. Remove the SD card if the camera will not be used for an extended period.

6.3 Print Paper Care

Use only thermal print paper compatible with this camera. Store paper rolls in a dry place. The included paper is BPA-free and non-toxic.

Safe & Cost-Effective printing paper

Take pictures whenever you want, and let the happiness continue



Our

- ✓ \$0.08 per paper
- ✓ 124 papers a roll
- ✓ Friendly material to store
- ✓ Clear pictures

Other

- ✗ \$0.3 per paper
- ✗ Toxic paper and smelly
- ✗ 60 papers a roll
- ✗ Blurry images



Other

- ✗ \$0.9 per paper
- ✗ 20 sheets a pack

Image 6.1: The camera uses safe and cost-effective thermal printing paper.

7. TROUBLESHOOTING

If you encounter issues with your camera, refer to the following common problems and solutions:

- **Camera Not Turning On:** Ensure the battery is charged. Connect the camera to a power source using the Type-C cable.
- **No Image on Print:** Check if the print paper is installed correctly (refer to Section 4.3). Ensure the paper is thermal paper and not inserted backward.
- **Blurry Prints:** Ensure the lens is clean. Check print density settings (Section 5.8) and adjust to 'High' if needed.
- **"Overheat" Error:** If printing many photos consecutively, the camera may temporarily overheat. Allow it to cool down for a few minutes before resuming printing.
- **SD Card Error:** Ensure the SD card is properly inserted. Try reformatting the SD card (this will erase all data, so back up important files first).
- **Camera Freezes:** Press and hold the power button for 10 seconds to force a restart.

8. SPECIFICATIONS

Feature	Detail
Model Number	ABS-681
Brand	ESOXOFFORE
Package Dimensions	7.76 x 4.61 x 2.46 inches
Item Weight	1.13 ounces (0.07 Pounds)
Batteries	1 LR44 battery (included)
Special Feature	Travel
Film Format Type	Instant (Thermal Print)
Film Color	Black and White (for prints)
Compatible Devices	Camera
Viewfinder Magnification	1x
Video Resolution	1080P
Digital Zoom	16X
Screen Size	2.4 inches

9. WARRANTY AND SUPPORT

This product is covered by a standard manufacturer's warranty. For specific warranty details, please refer to the warranty card included in your package or contact ESOXOFFORE customer support. For technical assistance or further inquiries, please visit the official ESOXOFFORE website or contact their customer service department.





10. IMPORTANT SAFETY INFORMATION

- This product contains small parts and is not suitable for children under 3 years old without adult supervision.
- Do not expose the camera to water or extreme moisture.
- Avoid dropping the camera or subjecting it to strong impacts.
- Use only the provided charging cable and compatible power adapters.
- Do not attempt to disassemble or repair the camera yourself.

11. PRODUCT VIDEOS

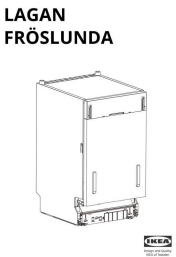
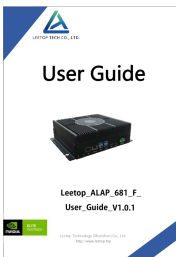
No official product videos from the seller were available for embedding based on the provided data.

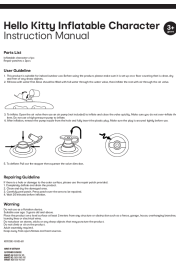
Related Documents - ABS-681

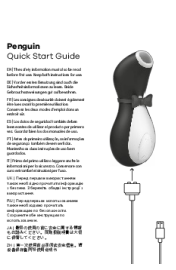
	<p>IKEA LAGAN FRÖSLUNDA Integrated Dishwasher Installation Guide</p> <p>Comprehensive installation guide for the IKEA LAGAN FRÖSLUNDA integrated dishwasher, covering all steps from unpacking to final setup. Includes safety information and part identification.</p>
	<p>Leetop ALP-681-F User Guide: Embedded AI Computer Specifications and Setup</p> <p>Comprehensive user guide for the Leetop ALP-681-F embedded artificial intelligence computer, detailing specifications, setup, system configuration, developer tools, and FCC compliance. Features NVIDIA Jetson AGX Orin.</p>
	<p>Dream Toys Travel Buddy Art. 22266 User Manual and Guide</p> <p>Official user manual for the Dream Toys Travel Buddy (Art. 22266). Learn how to use, charge, clean, and understand safety precautions for this personal massager.</p>
	<p>Hello Kitty Inflatable Character Instruction Manual - Setup, Use, and Care Guide</p> <p>Official instruction manual for the Hello Kitty Inflatable Character. Learn how to set up, inflate, deflate, repair, and safely use your inflatable toy. Includes warnings and customer service information.</p>
	<p>Flying Fairy User Manual</p> <p>This manual provides instructions for the Flying Fairy toy, including setup, operation, safety warnings, and recycling information. The Flying Fairy is a toy fairy equipped with lights and an infrared sensor for flight control.</p>
	<p>Satisfyer Penguin Quick Start Guide</p> <p>A quick start guide for the Satisfyer Penguin, providing essential safety information and usage instructions in multiple languages.</p>

