

## Manuals+

[Q & A](#) | [Deep Search](#) | [Upload](#)

Manuals.plus /

› [NFESOLAR](#) /

› NFESOLAR 16 Pack Solar Outdoor Lights Instruction Manual

## NFESOLAR NFESOLAR

# NFESOLAR 16 Pack Solar Outdoor Lights Instruction Manual

Model: NFESOLAR

## INTRODUCTION

Thank you for choosing NFESOLAR 16 Pack Solar Outdoor Lights. These lights are designed to provide bright, energy-efficient illumination for your pathways, gardens, yards, lawns, walkways, and driveways. Utilizing solar power, they automatically charge during the day and light up at night, offering a convenient and sustainable lighting solution.

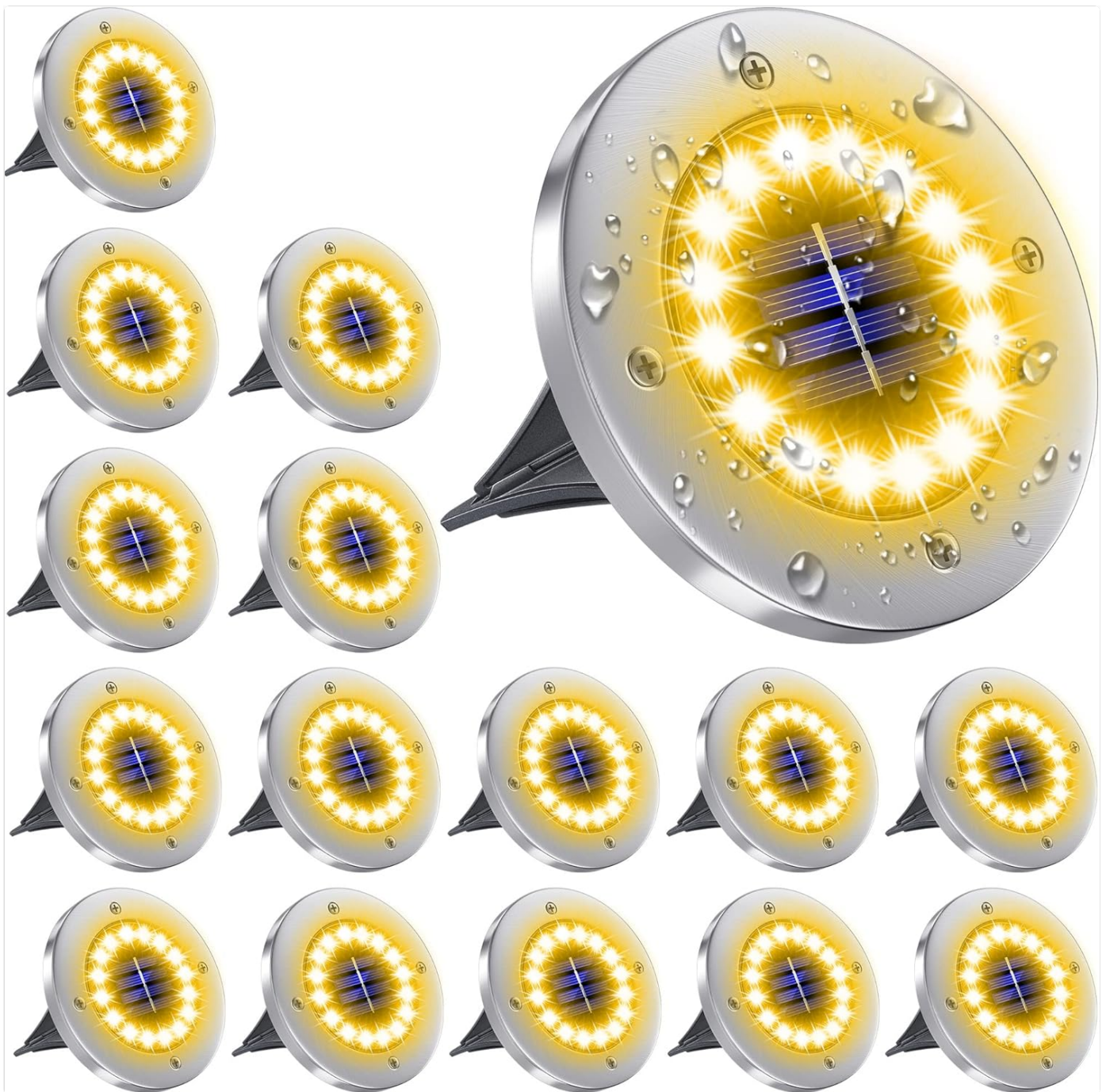

Image: A full set of 16 NFESOLAR solar ground lights, showcasing their warm white illumination and sleek design.

## What's in the Box

- 16 x NFESOLAR Solar Ground Lights
- 16 x Ground Stakes
- 1 x Instruction Manual

## SAFETY INFORMATION

Please read all safety instructions before using the product. Failure to follow these instructions may result in injury or damage to the product.

- Do not attempt to disassemble or modify the lights. This may damage the product and void the warranty.
- Keep the solar panel clean to ensure optimal charging performance.
- Ensure the lights are installed in a location that receives direct sunlight for at least 6-8 hours daily.

- Avoid placing the lights near other strong light sources at night, as this may prevent them from turning on automatically.
- The product is waterproof (IP65 rated) but should not be submerged in water.

## PRODUCT OVERVIEW

The NFESOLAR solar ground lights feature a robust design with advanced components for reliable outdoor lighting.

# Product Features



Image: A diagram illustrating the key features and dimensions of the NFESOLAR solar light, including 16 LEDs, stainless steel shell, ON/OFF switch, and upgraded stake.

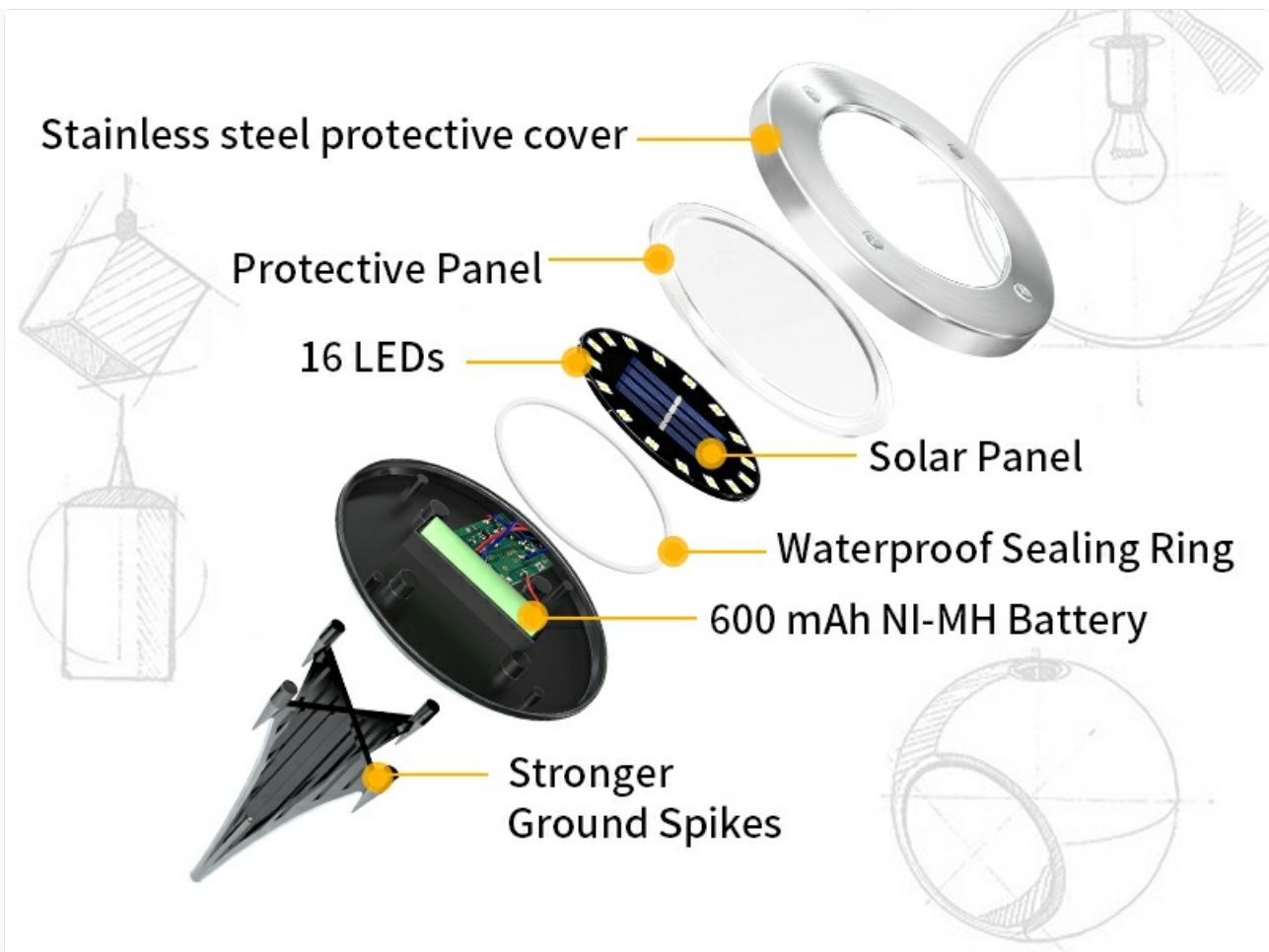

Image: An exploded view showing the internal components of the solar light, including the stainless steel protective cover, protective panel, 16 LEDs, solar panel, waterproof sealing ring, 600 mAh NI-MH battery, and stronger ground spikes.

## Key Features:

- **Bright Illumination:** Equipped with 16 LEDs for enhanced brightness.
- **Durable Construction:** Features an IP65 waterproof rating and a stainless steel shell for outdoor resilience.
- **Automatic Operation:** Integrated light sensor automatically turns lights on at dusk and off at dawn.
- **Energy Efficient:** Powered entirely by solar energy, eliminating electricity costs.
- **Easy Installation:** Wireless design with upgraded stakes for simple setup.

## SETUP

Follow these simple steps to set up your NFESOLAR solar outdoor lights:

1. **Unpack and Activate:** Carefully remove all lights and stakes from the packaging. Locate the ON/OFF switch on the underside of each light and switch it to the "ON" position.

## Easy to Assemble

Wireless, Solar Powered

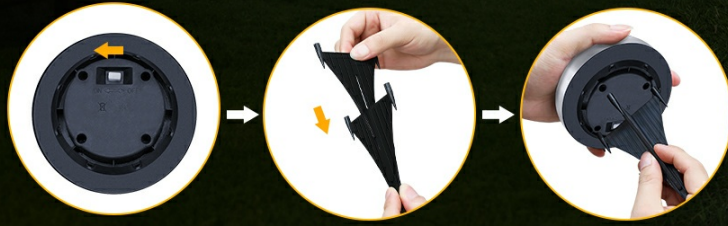

## Easy to Use

Automatic work

Image: A visual guide showing the simple steps to assemble the solar lights, including turning on the switch and attaching the ground stake.

2. **Assemble the Stakes:** Attach the pointed ground stakes to the back of each solar light. Ensure they are securely fastened.
3. **Choose a Location:** Select an outdoor location where the solar panel can receive direct sunlight for at least 6-8 hours during the day. Avoid shaded areas or locations near other strong light sources (like streetlights) that might interfere with the automatic sensor.
4. **Install the Lights:** Gently push the assembled lights into the ground. Ensure the solar panel is facing upwards and is unobstructed.

For optimal performance, allow the lights to charge for a full day in direct sunlight before their first use.

## OPERATING

The NFESOLAR solar lights are designed for automatic, hassle-free operation.



Image: A split image demonstrating the solar light's operation: charging in sunlight during the day and automatically illuminating at night.

- **Automatic On/Off:** Once activated and placed in a suitable location, the lights will automatically detect ambient light levels. They will turn on at dusk and turn off at dawn.
- **Charging:** The built-in solar panel absorbs sunlight throughout the day, converting it into electrical energy and storing it in the internal battery.
- **Illumination Duration:** After 6-8 hours of full charging in direct sunlight, the lights can operate for approximately 8-10 hours. Performance may vary based on weather conditions and seasonal sunlight availability.

## MAINTENANCE

Regular maintenance ensures the longevity and optimal performance of your solar lights.

- **Cleaning the Solar Panel:** Periodically wipe the solar panel with a soft, damp cloth to remove dirt, dust, leaves, or snow. A clean panel ensures efficient sunlight absorption.
- **Battery Care:** The lights come with a pre-installed rechargeable AA battery. While designed for long life, if the light duration significantly decreases over time, the battery may need replacement. Use only rechargeable AA Ni-MH

batteries.

- **Winter Storage:** In areas with prolonged periods of low sunlight or harsh winter conditions, it is recommended to bring the lights indoors. Clean them thoroughly and store them in a dry place.
- **Inspect Stakes:** Occasionally check the ground stakes for any damage, especially after heavy rain or strong winds.

## TROUBLESHOOTING

If your NFESOLAR solar lights are not functioning as expected, consider the following common issues and solutions:

Problem	Possible Cause	Solution
Light does not turn on at night.	Switch is in "OFF" position. Insufficient sunlight for charging. Solar panel is dirty or obstructed. Light sensor is affected by other light sources. Battery is depleted or faulty.	Ensure the switch is set to "ON". Relocate the light to an area with direct sunlight for 6-8 hours daily. Clean the solar panel surface. Move the light away from streetlights, porch lights, or other strong light sources. Allow several days for charging. If issue persists, consider replacing the AA Ni-MH battery.
Light duration is short.	Insufficient charging time. Battery capacity reduced over time. Weather conditions (cloudy days).	Ensure maximum direct sunlight exposure. Replace the AA Ni-MH battery. Understand that performance may be reduced during prolonged cloudy or rainy periods.
Light flickers or is dim.	Low battery charge. Loose connection.	Allow the light to charge fully in direct sunlight. Check internal connections if comfortable, or replace the unit if necessary.

## SPECIFICATIONS

Feature	Detail
Brand	NFESOLAR
Model	NFESOLAR
Color	Warm White
Material	Acrylonitrile Butadiene Styrene, Stainless Steel
Light Source Type	LED
Number of LEDs	16
Power Source	Solar Powered
Voltage	1.2 Volts
Wattage	1.2 watts

Feature	Detail
Brightness	12 Lumen
Water Resistance Level	IP65 Waterproof
Product Dimensions	9.4"L x 9.4"W x 4.9"H
Item Weight	4.14 pounds (for 16 pack)
Battery	1 AA rechargeable battery required (included)
Control Method	Touch (ON/OFF switch)
Installation Type	Free Standing / In-Ground

## WARRANTY AND SUPPORT

NFESOLAR stands behind the quality of its products.

### Warranty Service

This product comes with a **one-year warranty service** from the date of purchase. This warranty covers manufacturing defects and material flaws under normal use.

### Customer Support

If you have any questions, concerns, or require assistance with your NFESOLAR solar lights, please do not hesitate to contact our customer support team. We are committed to providing the highest standard of service and will respond to your inquiries within 24 hours.

Please refer to your purchase documentation or the seller's contact information for specific support channels.