

Alula RE667W-R-Pro

Alula RE667W-R-Pro Touchpad Slimline Pro User Manual

Model: RE667W-R-Pro

INTRODUCTION

The Alula Slimline Touchpad PRO provides modern and intuitive control for your smart security system. Featuring a 7-inch full-color touchscreen, this device can be wall-mounted or placed on a tabletop, offering complete control of your security system from anywhere within your premises. It allows you to arm and disarm the system, view cameras, control smart devices, and initiate scenes. Its interface mirrors the Alula Smart Security app, ensuring ease of use and a familiar experience.



Figure 1: Alula Slimline Touchpad Pro main interface.

PACKAGE CONTENTS

- Alula Slimline Touchpad PRO
- Wall Mount Bracket
- Tabletop Stand
- 110V Plug-in Transformer

- Charger

SETUP AND INSTALLATION

The Slimline Touchpad PRO offers flexible installation options, including wall mounting or tabletop placement. Ensure the device is placed within Wi-Fi range for optimal performance.

Wall Mount Installation

1. Choose a suitable location on a wall, preferably near a power outlet.
2. Secure the wall mount bracket to the wall using appropriate screws (not included).
3. Connect the 12V direct wire or use the 110V plug-in transformer to power the device.
4. Carefully attach the touchpad to the mounted bracket, ensuring it clicks securely into place.



Figure 2: Touchpad in tabletop configuration, showing device and zone management.

Tabletop Stand Installation

1. Attach the tabletop stand to the back of the touchpad.
2. Place the touchpad on a flat, stable surface.
3. Connect the 110V plug-in transformer to the touchpad and plug it into a power outlet.

Initial Power-Up and Wi-Fi Connection

1. Once powered, the touchpad will boot up.
2. Follow the on-screen prompts to connect to your home Wi-Fi network.
3. Enter your Wi-Fi password when prompted.
4. The touchpad will then attempt to connect to your Alula smart security system.

OPERATING INSTRUCTIONS

The Slimline Touchpad PRO provides comprehensive control over your Alula smart security system.

Arming and Disarming

- **Arm Stay:** Tap the "Stay" icon to arm the system with interior motion sensors bypassed. Ideal for when you are home.
- **Arm Away:** Tap the "Away" icon to arm all sensors. Ideal for when you leave the premises.
- **Arm Night:** Tap the "Night" icon for a customized arming mode, typically similar to "Stay" but with specific zones armed.
- **Disarm:** Tap the "Disarmed" area and enter your user code to disarm the system.

Controlling Smart Devices and Scenes

- Navigate to the "Devices" or "Scenes" tab on the bottom menu.
- From the "Devices" tab, you can control connected smart home devices such as lights, locks, and thermostats.
- From the "Scenes" tab, you can activate pre-configured scenes that control multiple devices simultaneously (e.g., "Good Morning" scene).



Figure 3: Touchpad displaying a scenic background in disarmed state.

Two-Way Audio Communication

The touchpad supports two-way audio, allowing communication with monitoring stations or other connected devices if configured within your system.

MAINTENANCE

To ensure the longevity and optimal performance of your Alula Slimline Touchpad PRO, follow these maintenance guidelines:

- **Cleaning:** Use a soft, dry, lint-free cloth to clean the touchscreen. For stubborn smudges, slightly dampen the cloth with water. Avoid abrasive cleaners, solvents, or aerosol sprays.
- **Software Updates:** Ensure your touchpad's software is kept up-to-date. Updates are typically pushed automatically via your Wi-Fi connection.

- **Power Supply:** Always use the original Alula power adapter. Do not use third-party adapters.
- **Placement:** Avoid placing the touchpad in direct sunlight, near heat sources, or in areas with extreme humidity.

TROUBLESHOOTING

Problem	Possible Cause	Solution
Touchpad not powering on.	No power, faulty adapter, or loose connection.	Check if the power adapter is securely plugged into the touchpad and the wall outlet. Verify the wall outlet is functional. Ensure the charger is connected properly.
Cannot connect to Wi-Fi.	Incorrect password, out of range, or router issue.	Double-check the Wi-Fi password. Move the touchpad closer to the Wi-Fi router. Restart your Wi-Fi router.
Touchscreen unresponsive.	Temporary software glitch or physical damage.	Perform a soft reset by disconnecting and reconnecting power. If the issue persists, contact Alula support.
System not arming/disarming.	Incorrect user code, system fault, or communication issue.	Verify the user code. Check the system status for any fault indicators. Ensure the touchpad is properly connected to the security system network.

SPECIFICATIONS

Feature	Detail
Model Number	RE667W-R-Pro
Screen Size	7 inches
Resolution	1024 x 600px
Color	White
Power Source	110V (with included transformer) or 12V direct wire
Connectivity	Wireless (Wi-Fi)
Control Method	Touch
Audio	Two-way audio
Dimensions (L x W x H)	9 x 6 x 4 inches
Installation Type	Wall Mount, Tabletop
Compatible Devices	Smartphone (via Alula Smart Security app)
UPC	810044990607

WARRANTY AND SUPPORT

For warranty information and technical support, please refer to the official Alula website or contact your authorized Alula dealer.
Keep your purchase receipt as proof of purchase.

Alula Support: alula.com/support

© 2023 Alula. All rights reserved.

Documents - Alula – RE667W-R-Pro

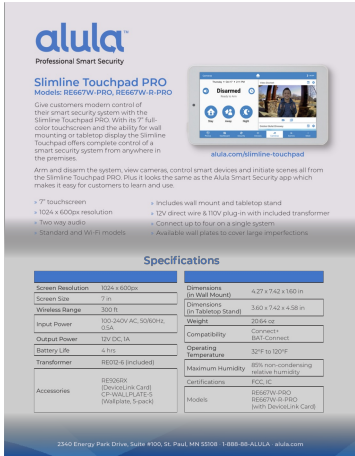

[\[pdf\]](#) Installation Guide Specifications Dimension Guide Accessories

Download Installation Guides Alula RE667W R PRO Product Sheet alula touchpad pro product sheet
wpdmdl 37615 refresh 62b7d0e4a30331656213732 |||

Slimline Touchpad PRO Models: RE667W-PRO, **RE667W-R-PRO** Give customers modern control of their smart security system with the Slimline Touchpad PRO. With its 7 fullcolor touchscreen and the ability for wall mounting or tabletop display the Slimline Touchpad offers complete control of a smart securi...

lang:en score:58 filesize: 245.54 K page_count: 1 document date: 2022-02-11

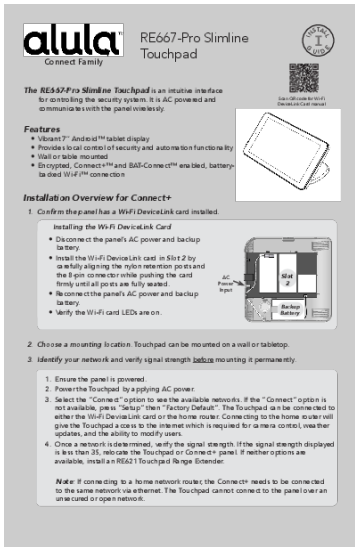

Alula RE667-Pro Slimline Touchpad Installation and User Guide

Comprehensive guide for installing and using the Alula RE667-Pro Slimline Touchpad, covering setup, features, and troubleshooting for home security systems.

lang:en score:32 filesize: 1.39 M page count: 12 document date: 2022-02-09



[Alula Solutions: Professional Smart Security Products and Services Catalog](#)

Explore the comprehensive range of Alula Solutions' smart security products and services, including mobile apps, dealer portals, security systems, sensors, cameras, communicators, and translators. Designed for professional installation, Alula offers a complete, fast, and flexible platform for residential and commercial security needs.

lang:en score:30 filesize: 2.66 M page_count: 16 document date: 2023-05-12



[\[pdf\] Installation Guide Warranty Catalog](#)

Alula Product Catalog Professional Smart Security System Home Dealer Program Web Spring 2023 alula 04 |||

ALULA SOLUTIONS CATALOG OF PRODUCTS AND SERVICES 1 What we do network management portal system co ... GE/ Interlogix devices System Controls multiple interface options for every use-case RE667W-PRO, **RE667W-R-PRO** SLIMLINE TOUCHPAD o Includes wall mount or tabletop stand o Video camera enabled with 2...

lang:en score:30 filesize: 2.66 M page_count: 16 document date: 2023-04-12