

QttyElok F20tuya Kit

QttyElok F20tuya Kit Waterproof Door Access Control System User Manual

Model: F20tuya Kit

1. INTRODUCTION

This manual provides detailed instructions for the installation, operation, and maintenance of your QttyElok F20tuya Kit Waterproof Door Access Control System. Please read this manual thoroughly before installation and use to ensure proper functionality and safety.

2. PACKAGE CONTENTS

Verify that all items listed below are included in your package:

- Waterproof Access Control Keypad (F20tuya)
- Electric Drop Bolt Lock (NC Type)
- Power Supply Control Unit (AC110-260V input, DC12V 3A output)
- Door Exit Button
- 10 x 13.56MHz RFID Keyfobs
- Mounting Screws and Accessories



Figure 2.1: Overview of the QttyElok F20tuya Kit components, including the access control keypad, electric drop bolt lock, power supply, exit button, and RFID keyfobs.

3. PRODUCT FEATURES

- **Multiple Access Methods:** Supports Fingerprint, RFID Card (13.56MHz), NFC (via mobile phone), Password, and Tuya APP.
- **High User Capacity:** Accommodates up to 100 users.
- **Waterproof Design:** IP68 rated access control keypad suitable for outdoor use.
- **Backlit Keypad:** Ensures visibility and ease of use in low-light conditions.
- **Electric Drop Bolt Lock:** NC type (Fail Safe) lock, meaning it locks when powered on and unlocks when power is off. Ideal for wooden and metal doors.
- **Integrated Doorbell Button:** Convenient for visitors.
- **Adjustable Lock Delay:** Electric drop bolt lock features 0, 3, or 6 seconds time delay.



Figure 3.1: The access control keypad is designed to be waterproof (left) and features a backlight for visibility in the dark (right).

4. SPECIFICATIONS

Table 4.1: System Specifications

Component	Specification
Access Control Keypad	Dimensions: 140mm (L) x 70mm (W) x 16mm (D) User Capacity: 100 Access Methods: Fingerprint, RFID (13.56MHz), NFC, Password, Tuya APP Waterproof Rating: IP68 Features: Backlight, Doorbell button
Electric Drop Bolt Lock	Type: NC (Fail Safe - Locked when power on, unlocked when power off) Voltage: DC12V / 24V Current: 100mA Dimensions: 150mm (L) x 34mm (W) x 28mm (H) Delay: 0, 3, 6 seconds adjustable
Power Supply Control Unit	Input Voltage: AC110-260V, 50-60Hz Output Voltage: DC12V Output Current: 3A Time Delay: 0-15 seconds adjustable Dimensions: 105mm (L) x 68mm (W) x 34mm (H)
Door Exit Button	Material: Plastic Maximum Power Rating: 36V DC 3A~5A output Modes: NC Mode (Fail Safe) & NO Mode (Fail Secure) Dimensions: 86mm (L) x 86mm (W)
RFID Keyfobs	Quantity: 10 pieces Material: ABS Working Frequency: 13.56MHz (Mi-fare 1k chip) Reading Distance: 0-5cm



Figure 4.1: Detailed dimensions of the access control keypad.

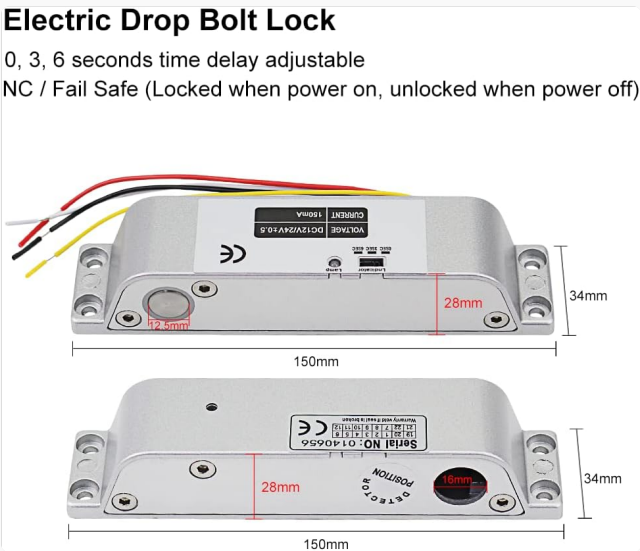

Figure 4.2: Detailed dimensions of the electric drop bolt lock.

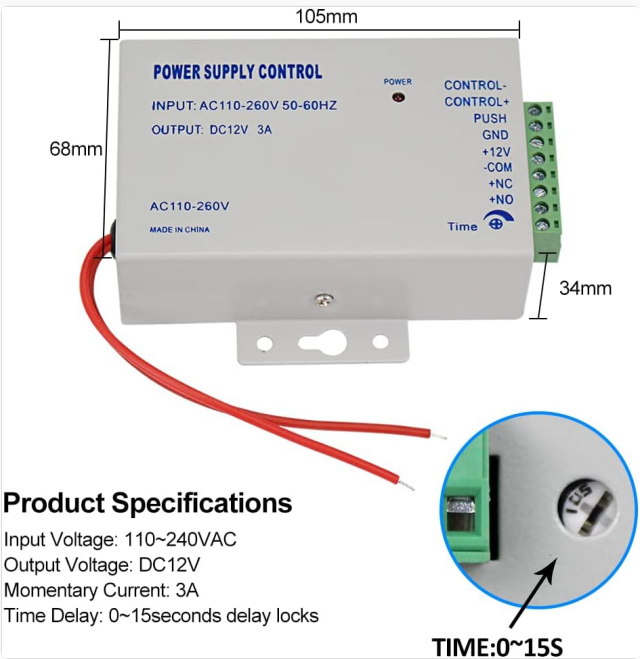

Figure 4.3: Dimensions and specifications of the power supply control unit.

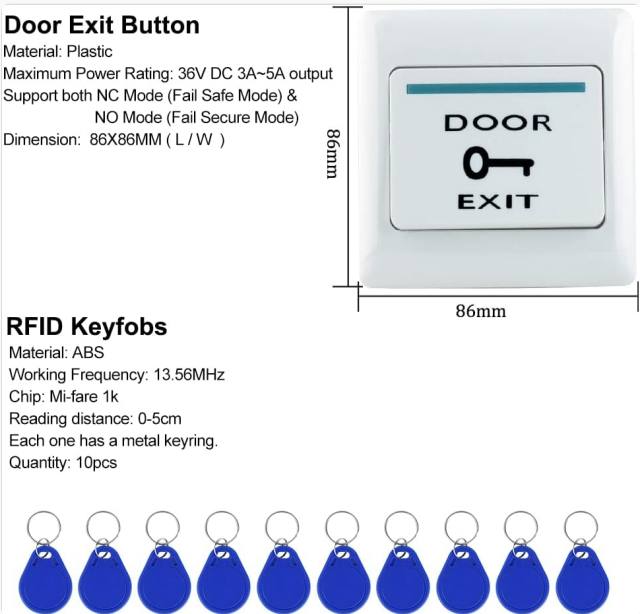

Figure 4.4: Specifications for the door exit button and RFID keyfobs.

5. SETUP & INSTALLATION

Installation requires basic electrical knowledge. If you are unsure, consult a qualified electrician.

5.1. Wiring Diagram

Follow the wiring diagram carefully to connect all components. Ensure power is disconnected before making any connections.

Wiring diagram:

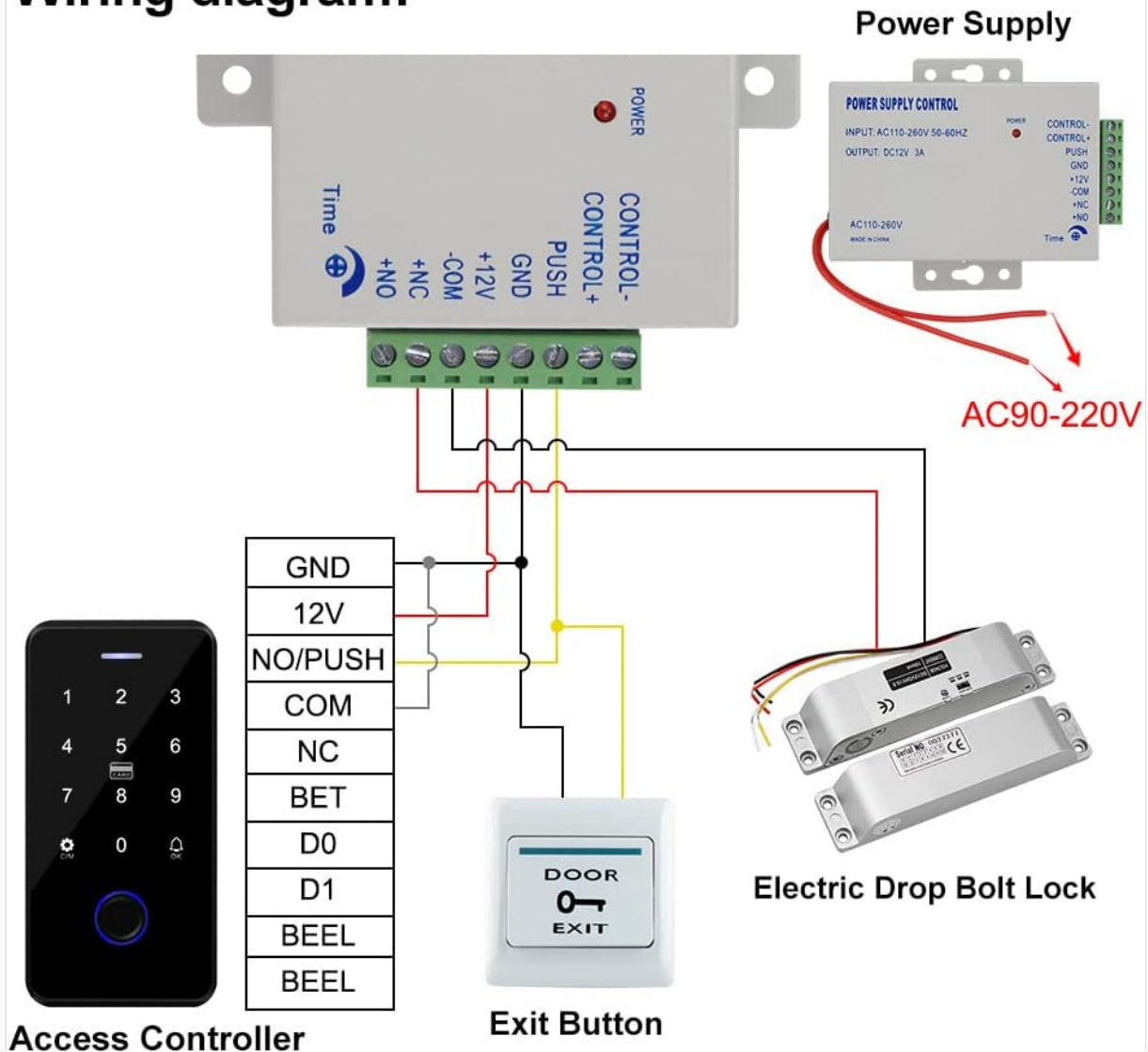

Figure 5.1: Comprehensive wiring diagram illustrating connections between the access controller, power supply, electric drop bolt lock, and exit button.

Wiring Connections:

- **Power Supply (AC110-260V Input):** Connect to your main AC power source.
- **Power Supply (DC12V Output):**
 - Connect **+12V** from Power Supply to **+12V** on Access Controller.
 - Connect **GND** from Power Supply to **GND** on Access Controller.
 - Connect **+12V** from Power Supply to one wire of the Electric Drop Bolt Lock.
 - Connect **GND** from Power Supply to one wire of the Exit Button.
- **Access Controller to Electric Drop Bolt Lock:**

- Connect **NC** (Normally Closed) from Access Controller to the remaining wire of the Electric Drop Bolt Lock.
- **Access Controller to Exit Button:**
 - Connect **NO/PUSH** from Access Controller to the remaining wire of the Exit Button.
 - Connect **COM** from Access Controller to the same wire as the Power Supply's GND that connects to the Exit Button.
- **Doorbell Connection:** If using the doorbell function, connect the doorbell wires to the **BEEL** terminals on the Access Controller.

5.2. Component Placement

Mount the access control keypad on the exterior side of the door, the electric drop bolt lock within the door frame or door, the power supply control unit in a secure, dry location, and the exit button on the interior side of the door.

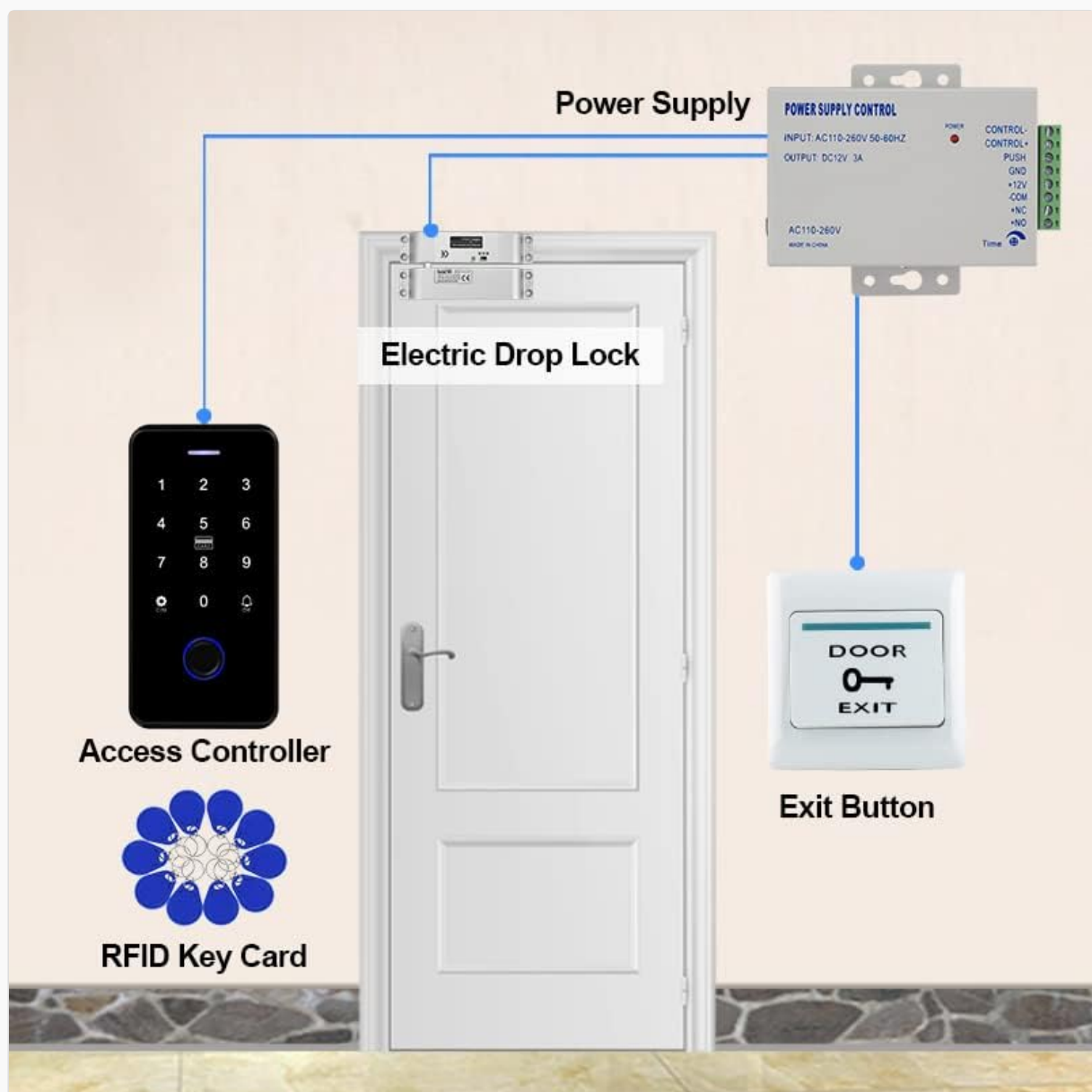

Figure 5.2: Illustrative diagram showing the typical placement of the access controller, electric drop lock, power supply, exit button, and RFID key cards relative to a door.

6. OPERATION

The system supports multiple methods for unlocking the door. Ensure the system is powered on and correctly configured before attempting to operate.

6.1. Access Methods

- **Fingerprint:** Place a registered finger on the fingerprint sensor.
- **RFID Card/Keyfob:** Present a registered RFID card or keyfob to the card reader area on the keypad.
- **NFC (Mobile Phone):** Use a mobile phone with NFC capabilities and the Tuya app configured for NFC access.
- **Password:** Enter a registered password on the keypad and press 'OK'.
- **Tuya APP:** Use the Tuya Smart application on your smartphone to remotely unlock the door via Bluetooth or Wi-Fi (if configured).
- **Exit Button:** Press the internal exit button to unlock the door from the inside.

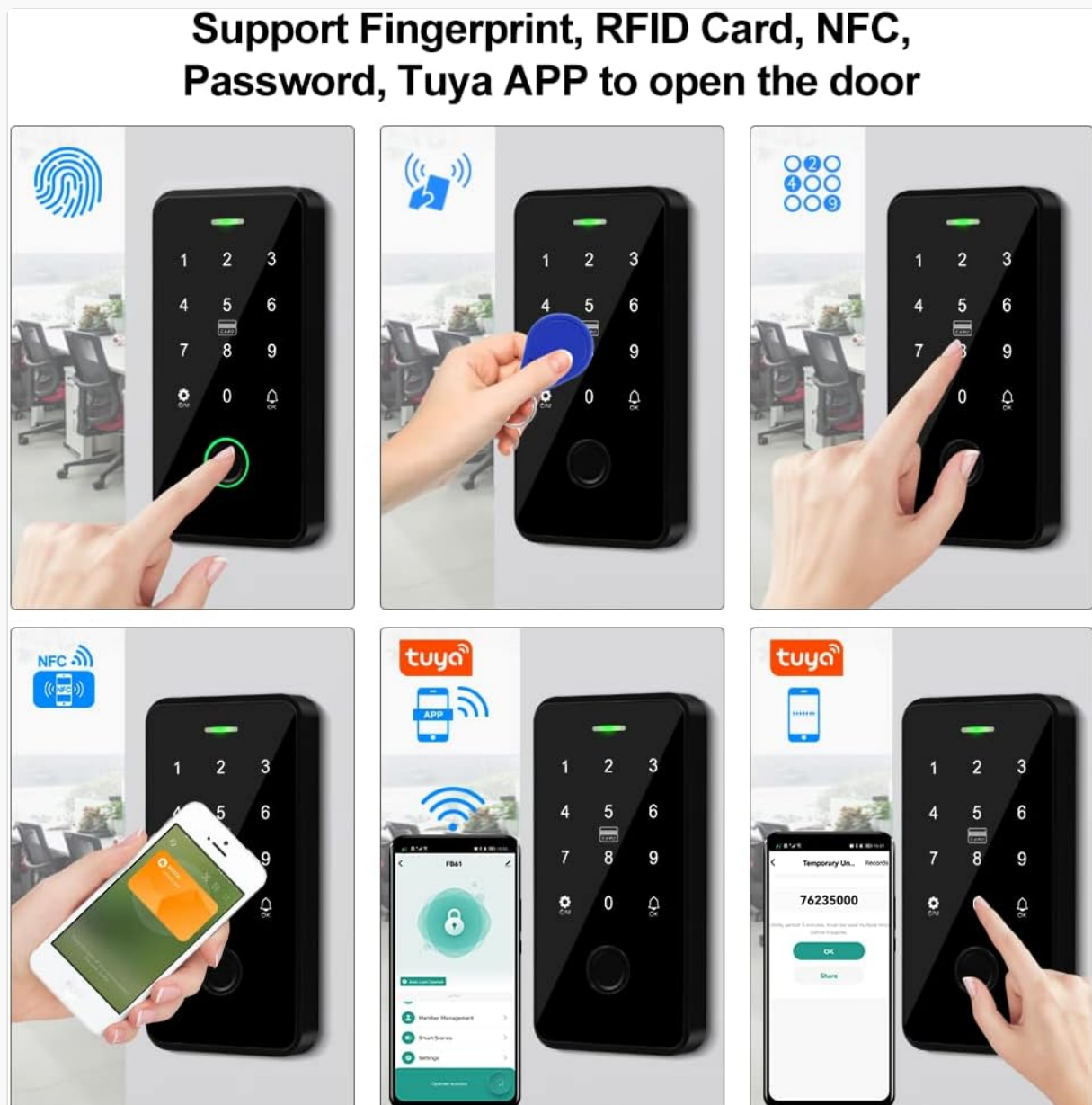

Figure 6.1: Visual representation of different access methods: fingerprint, RFID card, NFC, password, and Tuya app unlocking.

7. TUYA APP CONFIGURATION

7.1. Downloading the Tuya Smart App

Scan the QR code or search for "Tuya Smart" in your device's app store (App Store for iOS, Google Play Store for Android) to download and install the application.

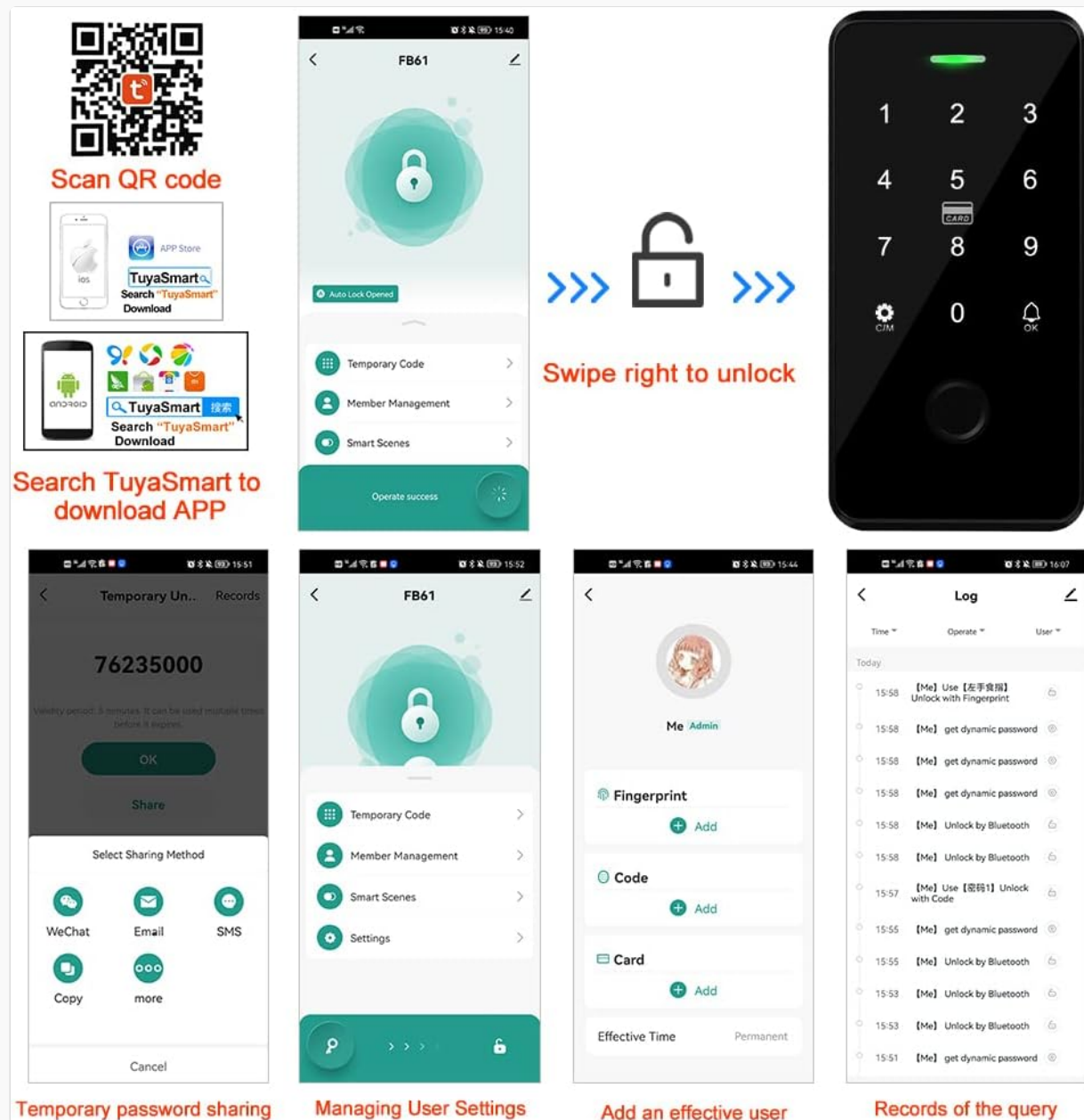
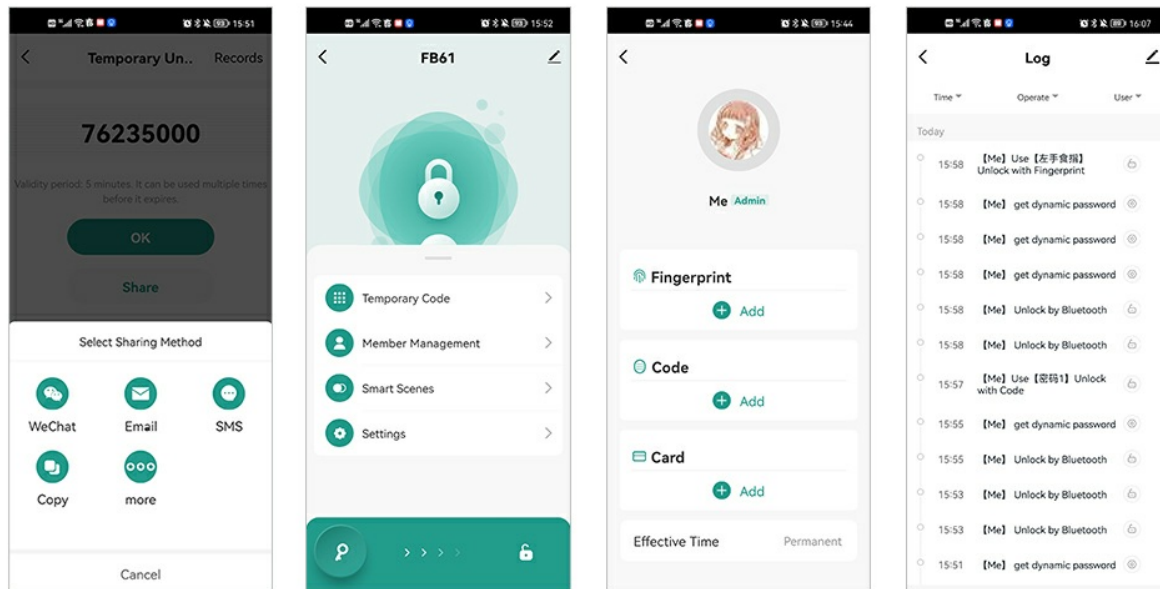

Figure 7.1: Instructions for downloading the Tuya Smart app via QR code or app store search, and an overview of the app's main interface.

Alternatively, download from: <http://smart.tuya.com/download>

7.2. Pairing and User Management

Follow the in-app instructions to pair your access control system with the Tuya Smart app. Once paired, you can manage users, add fingerprints, RFID cards, and passwords, and generate temporary access codes.



Temporary password sharing

Managing User Settings

Add an effective user

Records of the query

Figure 7.2: Screenshots of the Tuya app showing options for temporary password sharing, managing user settings, adding new users (fingerprint, code, card), and viewing access logs.

Key App Functions:

- **Temporary Code:** Generate time-limited access codes for guests or service providers.
- **Member Management:** Add, edit, or delete user profiles, including their fingerprints, RFID cards, and passwords.
- **Smart Scenes:** Integrate with other Tuya-compatible smart home devices.
- **Records Query:** View a log of all access events, including who accessed and when.

8. MAINTENANCE

- **Cleaning:** Wipe the keypad and other components with a soft, damp cloth. Avoid abrasive cleaners or solvents.
- **Fingerprint Sensor:** Keep the fingerprint sensor clean and dry for optimal performance.
- **Wiring:** Periodically check all wiring connections for tightness and signs of wear.
- **Software Updates:** Ensure the Tuya Smart app is updated to the latest version for new features and security enhancements.

9. TROUBLESHOOTING

Table 9.1: Common Issues and Solutions

Problem	Possible Cause	Solution
System not powering on.	No power to the power supply unit; incorrect wiring; faulty power supply.	Check AC power connection. Verify all wiring according to the diagram. Test power supply output.
Door does not unlock with valid credentials.	Incorrect user registration; lock mechanism issue; wiring problem; power supply issue.	Ensure fingerprint/card/password is correctly registered. Check lock for obstructions. Verify wiring to the lock and power supply.
Fingerprint not recognized.	Fingerprint sensor dirty or wet; finger not placed correctly; fingerprint not registered.	Clean and dry the sensor. Ensure full finger contact. Re-register fingerprint if necessary.
RFID card not working.	Card not registered; card damaged; incorrect frequency (not 13.56MHz).	Register the RFID card. Try a different card. Ensure cards are 13.56MHz compatible.
Tuya App cannot connect to the device.	Bluetooth/Wi-Fi off; device not paired; app outdated; network issues.	Ensure Bluetooth/Wi-Fi is enabled on your phone. Re-pair the device in the app. Update the Tuya Smart app. Check network connectivity.
Electric drop bolt lock remains unlocked.	Power failure (Fail Safe mode); incorrect wiring; faulty lock.	This is normal behavior for a Fail Safe (NC) lock during power outage. Check power supply. Verify wiring. Replace lock if faulty.





10. WARRANTY & SUPPORT

This product comes with a standard manufacturer's warranty. For specific warranty terms and conditions, please refer to the documentation provided with your purchase or contact QttyElok customer support. For technical assistance, troubleshooting, or further inquiries, please contact your retailer or the manufacturer's support channels. Keep your purchase receipt and model number (F20tuya Kit) handy when seeking support.

© 2023 QttyElok. All rights reserved.

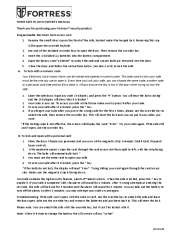
Related Documents - F20tuya Kit

 <p>USER MANUAL SMART LOCK</p> <p><small>HBUS-ZNS-H001-BLK-KIT 12.2023</small></p>	<p>Hornbill HBUS-ZNS-H001-BLK-KIT Smart Lock User Manual</p> <p>This user manual for the Hornbill HBUS-ZNS-H001-BLK-KIT smart lock provides detailed instructions on installation, setup, and operation. Learn to use the TTLock app, manage fingerprints, passcodes, and IC cards, and integrate with smart home systems like Alexa and Google Home. Includes troubleshooting tips and warranty information.</p>
--	---

	<p>ASSA ABLOY SMARTair® Glass Door Kit: Technical Data and Solutions</p> <p>Detailed technical specifications, installation solutions for single and double leave doors, and compatibility information for the ASSA ABLOY SMARTair® Glass Door Kit, enabling keyless access control on glass doors without drilling.</p>
	<p>Fortress Home Safe ES-LOCK Owner's Manual and Security Guide</p> <p>Detailed instructions and warranty information for the Fortress Home Safe ES-LOCK, covering electronic card access, numeric codes, installation, and security features.</p>
	<p>Schneider Electric XGCS491B201 Standalone RFID Reader - Installation and Configuration Guide</p> <p>This document provides comprehensive instructions for the Schneider Electric XGCS491B201 standalone RFID reader. It covers installation, wiring, configuration procedures including master key and user badge enrollment, access levels, maintenance, and troubleshooting. The guide details technical specifications, LED signaling, and regulatory compliance.</p>
	<p>EZVIZ DL01S Kit Smart Lock User Manual - Installation, Operation, and Maintenance</p> <p>Comprehensive user manual for the EZVIZ DL01S Kit Smart Lock, covering installation, setup via the EZVIZ app, operation, accessory management, gateway connection, maintenance, and troubleshooting.</p>
	<p>Smart Lock Manual: Electronic Keypad Deadbolt Lock</p> <p>Comprehensive user manual for the HBUS-AM-BLK-HUB-KIT smart lock, covering installation, operation, app integration with TTLock, and Alexa compatibility. Includes detailed instructions and troubleshooting.</p>