

Ketom D0486

Ketom GU10 LED Ceiling Light Instruction Manual

Model: D0486

INTRODUCTION

This manual provides essential information for the safe installation, operation, and maintenance of your Ketom GU10 LED Ceiling Light. Please read this manual thoroughly before installation and keep it for future reference.

SAFETY INFORMATION

- Always disconnect power at the main circuit breaker before installation or maintenance.
- Installation should be performed by a qualified electrician or competent person.
- Ensure the voltage supply matches the product specifications (220-240V, 50/60Hz).
- Do not exceed the maximum wattage for GU10 bulbs (50W).
- This product is designed for indoor use only (IP20 rating).
- Do not dispose of electrical appliances as unsorted municipal waste. Use separate collection facilities.

PACKAGE CONTENTS

Verify that all components are present before beginning installation:

- 1 x Ketom 4-Way Lighting Ceiling Lamp Holder (Round 4 Way White)
- 1 x Installation Instructions (this manual)
- 1 x Fixing Pack (screws, wall plugs)
- **Note: GU10 bulbs are NOT included.**



Image: The Ketom GU10 LED Ceiling Light, a white round base with four adjustable spotlights, mounted on a ceiling.

SETUP AND INSTALLATION

Follow these steps carefully to install your ceiling light:

1. **Safety First:** Turn off the main power supply at the circuit breaker before starting any electrical work.
2. **Prepare Mounting Surface:** Mark the desired location for the light fixture on the ceiling. Ensure there are no hidden wires or pipes.
3. **Mount the Base:** Use the provided fixing pack to securely attach the light's base plate to the ceiling.

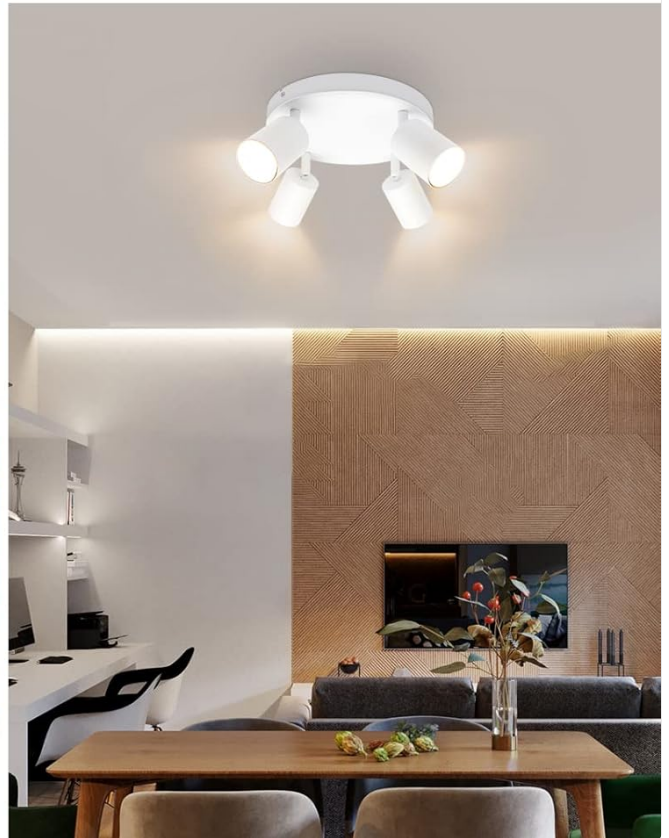

Image: A detailed view of the light fixture's base, showing the mounting holes and electrical connection points.

4. **Wire Connections:** Connect the household electrical wires to the corresponding terminals on the light fixture. Ensure correct polarity (Live to Live, Neutral to Neutral, Earth to Earth). Secure all connections.
5. **Attach Fixture to Base:** Once wiring is complete and secure, attach the main body of the light fixture to the mounted base plate.
6. **Insert GU10 Bulbs:** Carefully insert GU10 bulbs (not included) into each spotlight socket. Twist to secure.



Image: A close-up showing the GU10 bulb socket within one of the spotlight heads, illustrating where the bulb is inserted.

7. **Restore Power:** Once installation is complete and all connections are secure, restore power at the main circuit breaker.
8. **Test Functionality:** Turn on the light switch to ensure the fixture is working correctly.

OPERATING INSTRUCTIONS

The Ketom GU10 LED Ceiling Light features adjustable spotlight heads for versatile lighting:

- **Rotation:** Each spotlight head can be swiveled 350 degrees horizontally.
- **Tilt:** Each spotlight head can be tilted 90 degrees vertically (upside down).

Adjust the direction of each spotlight individually to illuminate specific areas or create desired lighting effects in your room.



Image: A diagram illustrating the 350-degree horizontal rotation and 90-degree vertical tilt capabilities of the individual spotlight heads.

MAINTENANCE

- **Cleaning:** To clean the fixture, ensure power is off. Wipe with a soft, dry cloth. Do not use abrasive cleaners or solvents.
- **Bulb Replacement:**
 - a. Turn off power at the circuit breaker.
 - b. Allow bulbs to cool completely if they were recently on.
 - c. Carefully remove the old GU10 bulb by twisting it counter-clockwise.
 - d. Insert a new GU10 bulb (max 50W) by aligning the pins and twisting clockwise until secure.
 - e. Restore power and test.

TROUBLESHOOTING

| Problem | Possible Cause | Solution |
|--------------------------------------|---|--|
| Light does not turn on. | No power supply. Bulb not installed correctly or faulty. Loose wiring connection. | Check circuit breaker. Ensure bulbs are correctly inserted and functional. Replace if necessary. Verify all wire connections are secure (with power off). |
| Light flickers. | Loose bulb. Incompatible dimmer switch (if applicable). Faulty bulb. | Ensure bulb is securely twisted in. Use a dimmer switch compatible with LED bulbs. Replace bulb. |
| Spotlight heads are stiff to adjust. | Normal operation. | Apply gentle, firm pressure. Do not force. |

SPECIFICATIONS

| | |
|-----------------------|-------------------------------|
| Brand: | Ketom |
| Model Number: | D0486 |
| Product Dimensions: | 24 x 24 x 9.5 cm; 880 g |
| Color: | Round 4 Way White |
| Material: | Iron |
| Style: | Modern |
| Light Fixture Form: | Close to Ceiling |
| Room Type: | Kitchen, Bedroom, Living Room |
| Specific Uses: | Indoor lighting |
| Indoor/Outdoor Use: | Indoor |
| Power Source: | AC |
| Bulb Socket Type: | GU10 (Bulb Not Included) |
| Max Wattage per Bulb: | 50W |
| Voltage: | 220-240V |
| Frequency: | 50/60Hz |
| IP Rating: | IP20 |

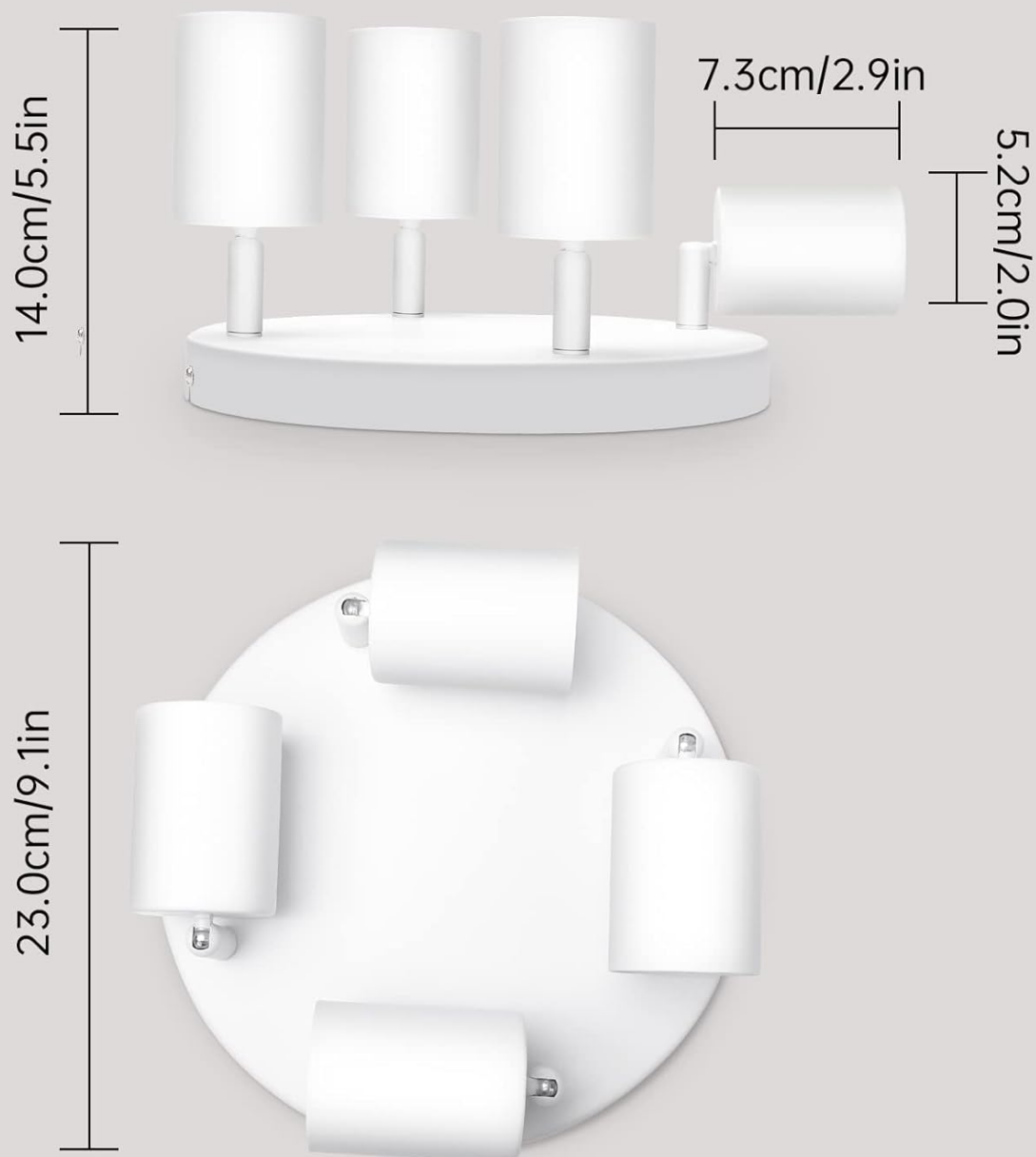

Image: A technical drawing indicating the dimensions of the Ketom 4-way ceiling light, including height and diameter measurements.

WARRANTY AND SUPPORT

For warranty information or technical support, please refer to the retailer's policy or contact Ketom customer service. Keep your purchase receipt as proof of purchase.

For further assistance, you may visit the product page on Amazon: [Product Link](#)

Related Documents

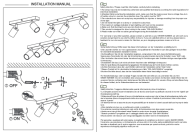

[Ketom Ceiling Spotlight Installation Manual](#)

This document provides essential safety instructions and installation guidelines for the Ketom Ceiling Spotlight, emphasizing professional installation and adherence to electrical regulations. It covers wiring, mounting, and important precautions for safe operation.