

Manuals+

[Q & A](#) | [Deep Search](#) | [Upload](#)

[manuals.plus](#) /

› [SMALLRIG](#) /

› [SmallRig Foldable L-Bracket 3984 Instruction Manual for Sony Alpha 7R V/Alpha 7 IV/Alpha 7S III](#)

SMALLRIG 3984

SmallRig Foldable L-Bracket 3984 Instruction Manual

For Sony Alpha 7R V, Alpha 7 IV, and Alpha 7S III Cameras

1. INTRODUCTION

This manual provides detailed instructions for the installation, operation, and maintenance of your SmallRig Foldable L-Bracket, model 3984. This L-bracket is specifically designed for Sony Alpha 7R V, Alpha 7 IV, and Alpha 7S III cameras, facilitating quick transitions between horizontal and vertical shooting orientations.



2. SETUP AND INSTALLATION

Follow these steps to securely attach the L-Bracket to your camera:

1. Align the L-bracket with the bottom of your Sony Alpha 7R V, Alpha 7 IV, or Alpha 7S III camera. Ensure the locating pins on the L-bracket align with the corresponding holes on the camera body.
2. Secure the L-bracket to the camera using the integrated 1/4"-20 screw. Tighten the screw firmly with the built-in flat-head screwdriver or a coin.
3. Verify that the L-bracket is flush against the camera body and does not wobble. The integrated cushions prevent scratches to your camera.

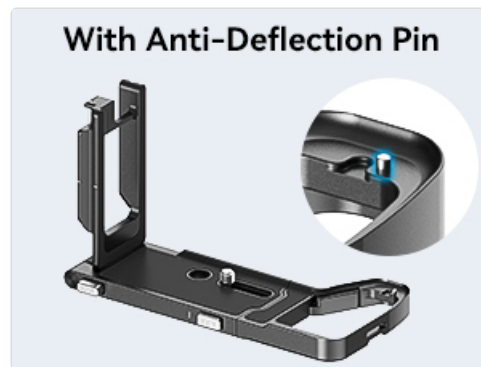

Image 2.1: The anti-deflection pin ensures a secure, twist-free attachment to the camera body.

Flip the LCD Screen Smoothly

This foldable L-Bracket can smoothly turn its side plate down for horizontal shooting and make the LCD screen freely flip

Arca-Swiss

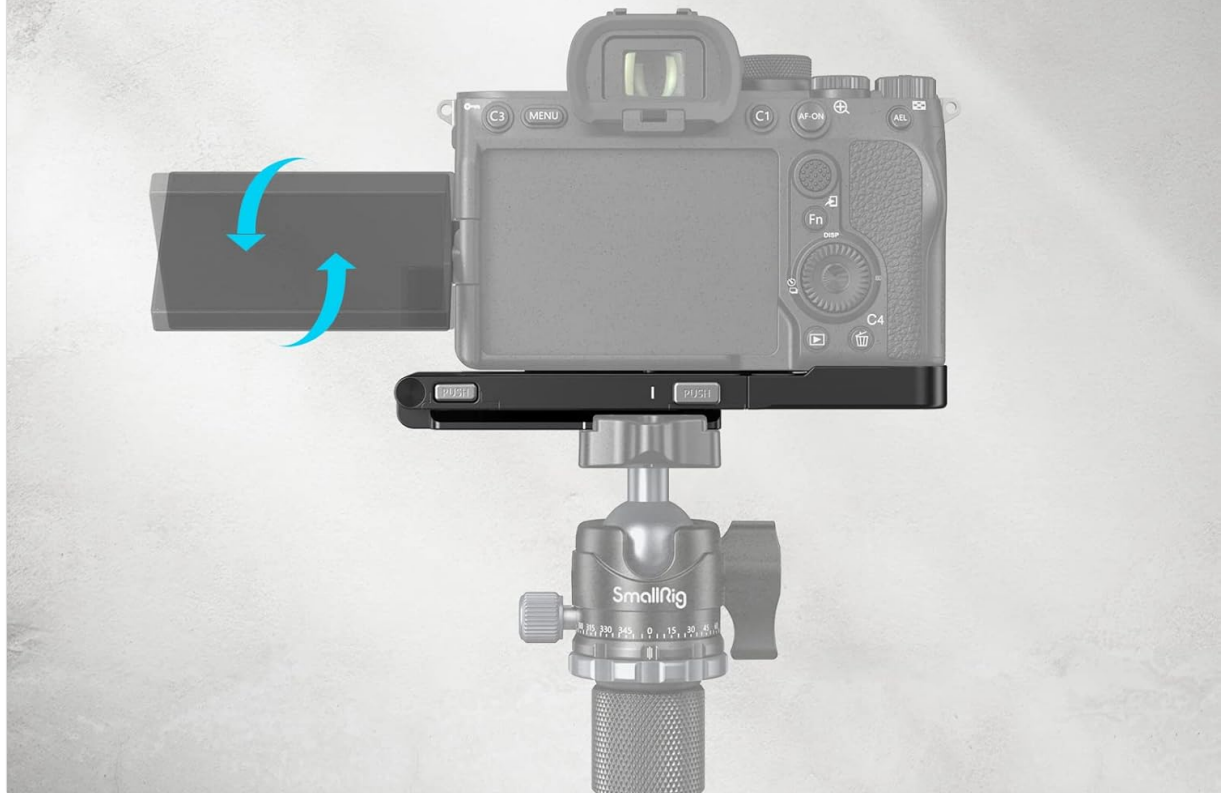

Image 2.2: The L-bracket securely mounted, providing a stable base for the camera.

3. OPERATING INSTRUCTIONS

3.1. Switching Between Horizontal and Vertical Shooting

The L-bracket features a foldable side plate for seamless transitions between shooting orientations.

- **For Horizontal Shooting:** The side plate can be folded onto the bottom baseplate via a folding press button. This integrates it as a single baseplate for Arca-Swiss compatible tripods.
- **For Vertical Shooting:** Press the middle button to quickly unfold the side plate. Once unfolded, it locks securely into place, allowing for vertical mounting on an Arca-Swiss compatible tripod head.

Uniquely Designed for Sony Alpha Series

Achieves quick switching from horizontal mode to vertical mode



For Sony Alpha 7R V



For Sony Alpha 7 IV



For Sony Alpha 7S III

Image 3.1: Visual representation of switching from horizontal to vertical shooting.

Quick Switching between Horizontal & Vertical Shooting

Press the button in the corner to fold the side plate with the baseplate, making it integrated as an baseplate for Arca-Swiss

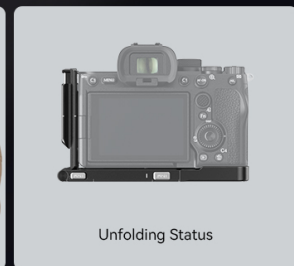
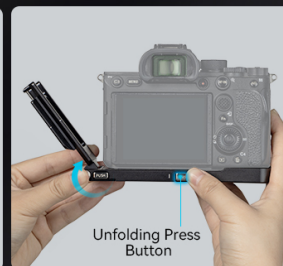
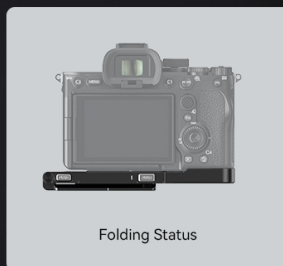

* Press the middle button to quickly unfold the side plate for vertical shooting

Image 3.2: Detailed steps for folding and unfolding the side plate.

3.2. LCD Screen Access

When the side plate is folded down for horizontal shooting, it allows the camera's LCD screen to be smoothly turned and flipped without obstruction.

Stretchable Baseplate

Slightly stretch the baseplate in vertical shooting to leave more room to allow cables access



Image 3.3: The L-bracket design ensures full articulation of the LCD screen.

3.3. Cable Access and Stretchable Baseplate

For vertical shooting, the baseplate can be stretched by up to 20mm to provide additional clearance for cables, such as USB-C and multi-interface cables. Note that only right-angle data cables are compatible when the baseplate is stretched.

Easy to Fold & Unfold

Innovative folding and unfolding press buttons achieve the L-Bracket can be folded and stored as one portable piece of accessory

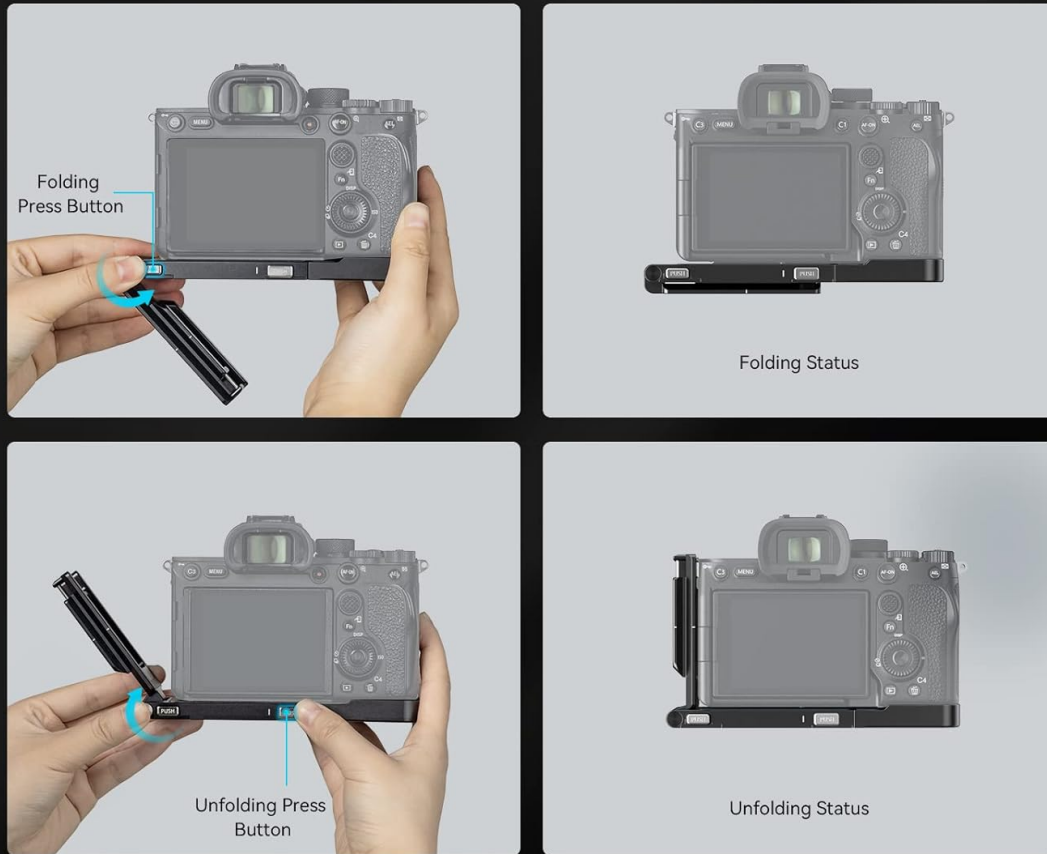

Image 3.4: The baseplate can be extended to accommodate cable connections during vertical shooting.

3.4. Battery Replacement

The L-bracket features a hinge arm at the battery door, allowing for easy battery replacement without needing to disassemble the L-bracket from the camera.

Easy Battery Replacement without L-Plate Disassembly

There is a hinge arm at the battery door, achieving easy battery replacement, fitting the camera curve, and enhancing the grip experience

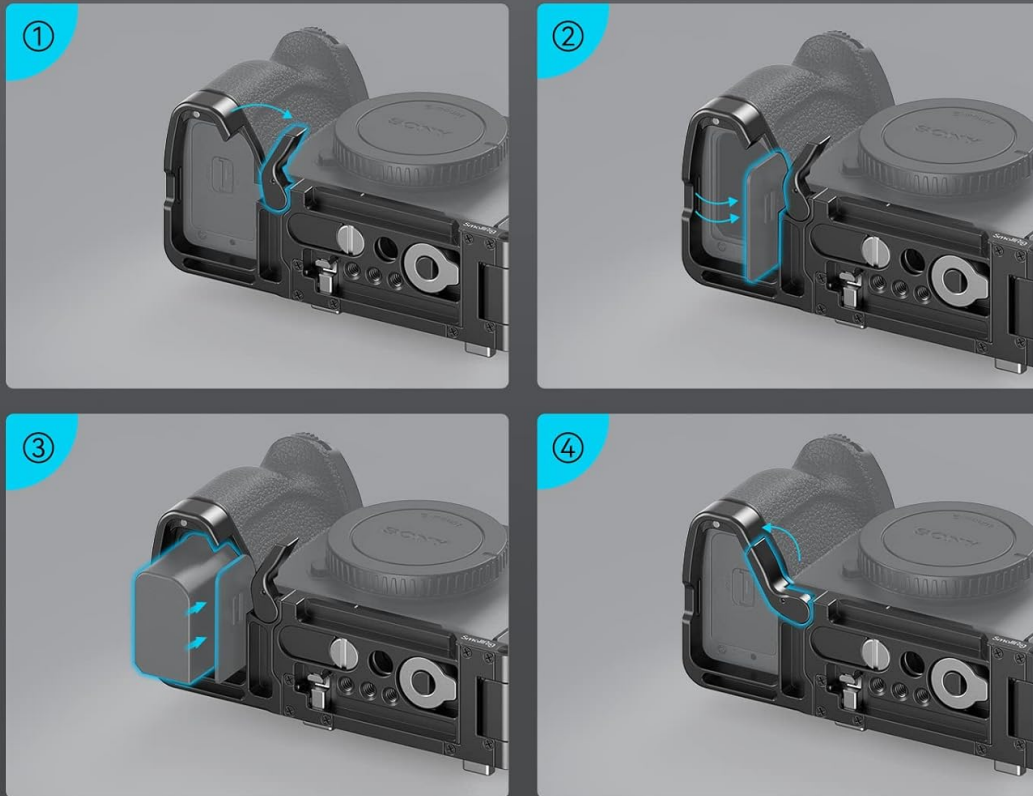

Image 3.5: The hinge arm design facilitates quick battery changes.

3.5. Additional Features and Expandability

The L-bracket is equipped with multiple 1/4"-20 threaded holes for attaching accessories such as magic arms, cold shoes for monitors, microphones, and other video production tools. It also includes a wrist strap hole and a QD connector for quick attachment of shoulder or wrist straps. A slotted screwdriver is integrated for convenience.

More Expandability & Detailing Designs

Equipped with multiple mounting points and a built-in wrench

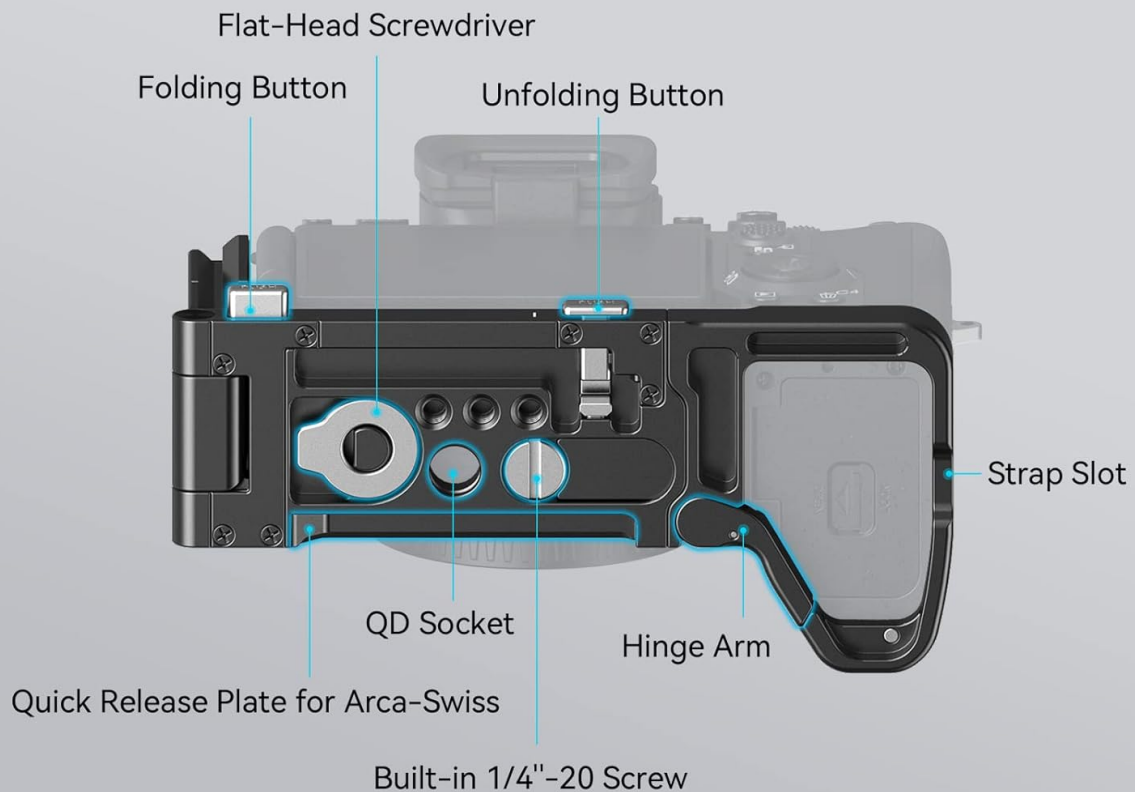

Image 3.6: Overview of the L-bracket's expandability features and built-in tools.

4. MAINTENANCE

To ensure the longevity and optimal performance of your SmallRig Foldable L-Bracket, please observe the following maintenance guidelines:

- **Cleaning:** Wipe the L-bracket with a soft, dry cloth to remove dust and fingerprints. For stubborn dirt, a slightly damp cloth can be used, followed by immediate drying. Avoid abrasive cleaners or solvents.
- **Storage:** Store the L-bracket in a dry, clean environment when not in use. If storing attached to the camera, ensure it is placed in a protective camera bag.
- **Inspection:** Periodically check all screws and moving parts for tightness and smooth operation. Do not overtighten screws.

5. TROUBLESHOOTING

This section addresses common questions and potential issues:

- **Issue: L-bracket feels loose on the camera.**
Solution: Ensure the 1/4"-20 screw is fully tightened. Check that the anti-deflection pins are correctly

seated in the camera's corresponding holes.

- **Issue: Difficulty folding or unfolding the side plate.**

Solution: Ensure the press buttons are fully depressed. Check for any obstructions or debris in the hinge mechanism. Do not force the mechanism.

- **Issue: Cables cannot be connected in vertical shooting mode.**

Solution: Activate the stretchable baseplate feature by pulling it outwards to create more space. Ensure you are using right-angle data cables for optimal compatibility.

- **Issue: LCD screen movement is restricted.**

Solution: Ensure the side plate is fully folded down for horizontal shooting, or fully extended for vertical shooting, to provide maximum clearance for the LCD screen.



6. SPECIFICATIONS

Feature	Detail
Model Number	3984
Compatibility	Sony Alpha 7R V, Alpha 7 IV, Alpha 7S III
Material	Aluminum Alloy (typical for SmallRig products)
Folded Dimensions (L x W x H)	5.8" x 3.42" x 2.72" (147.2 x 69 x 17.5mm)
Item Weight	5.1 ounces (144 Grams)
Max Load Capacity (Vertical Shooting)	5kg / 11lbs
Stretchable Baseplate Length	Max 20mm
Mounting Points	1/4"-20 threaded holes, QD connector, Wrist strap hole
Color	Black

7. WARRANTY AND SUPPORT

SmallRig products are manufactured to high-quality standards. For specific warranty information, please refer to the warranty card included with your product or visit the official SmallRig website. For technical support, product inquiries, or assistance with any issues, please contact SmallRig customer service through their official channels.

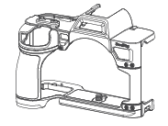
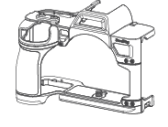
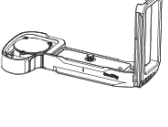
Official Website: www.smallrig.com

<div>SmallRig</div> <div></div> <div>Mount Plate for AirTag for Sony</div>	<p>SmallRig MD5423 Mount Plate for AirTag for Sony Cameras - Operating Instructions</p> <p>Detailed operating instructions for the SmallRig MD5423 Arca-Swiss Mount Plate designed for Sony Alpha and FX series cameras, featuring an integrated AirTag compartment, quick release system, and expansion options.</p>
<div>SmallRig</div> <div></div> <div>Case for Sony Alpha 7 IV 保护壳 (适用于索尼Alpha 7 IV) <small>Operating Instructions (操作指南)</small></div>	<p>SmallRig Camera Cage for Sony Alpha 7 IV: Operating Instructions and Specifications</p> <p>Detailed operating instructions and specifications for the SmallRig camera cage designed for the Sony Alpha 7 IV. This guide covers package contents, product features, step-by-step installation, and technical specifications for photographers.</p>
<div>SmallRig</div> <div></div> <div>Case for Sony Alpha 7 IV 保护壳 (适用于索尼Alpha 7 IV) <small>Operating Instructions (操作指南)</small></div>	<p>SmallRig Case for Sony Alpha 7 IV Operating Instruction</p> <p>This document provides operating instructions and installation guidance for the SmallRig camera cage designed for the Sony Alpha 7 IV. It details the package contents, product features, step-by-step installation procedures, and technical specifications.</p>
<div>SmallRig</div> <div></div> <div>L-Shape Mount Plate (for Sony Alpha 1 II / Alpha 9 III) L型安装板 (适用于索尼Alpha 1 II / Alpha 9 III) <small>Operating Instructions / 操作指南</small></div>	<p>SmallRig L-Shape Mount Plate for Sony Alpha 1 II / Alpha 9 III - Operating Instructions</p> <p>Operating instructions for the SmallRig L-Shape Mount Plate designed for Sony Alpha 1 II and Alpha 9 III cameras. Includes installation steps, product specifications, and package contents.</p>
<div>SmallRig</div> <div></div> <div>L-Bracket (for Sony Alpha 7R V / Alpha 7 IV / Alpha 7S III / Alpha 1 / Alpha 7R IV / Alpha 9 II)</div>	<p>SmallRig L-Bracket for Sony Alpha Cameras - Operating Instructions</p> <p>Operating instructions for the SmallRig L-Bracket designed for Sony Alpha 7R V, 7 IV, 7S III, 1, 7R IV, and 9 II cameras. Learn about its features, safety guidelines, and specifications.</p>
<div>SmallRig</div> <div></div> <div>Full Cage (for Sony Alpha 7R V / Alpha 7 IV / Alpha 7S III / Alpha 1 / Alpha 7R IV)</div>	<p>SmallRig Full Cage 3667B for Sony Alpha 7R V/IV, 7 IV, 7S III, 1 - Operating Instructions</p> <p>Detailed operating instructions and specifications for the SmallRig 3667B Full Cage, designed for Sony Alpha 7R V, Alpha 7 IV, Alpha 7S III, Alpha 1, and Alpha 7R IV cameras. Learn about features, safety, compatibility, and mounting options.</p>



[\[pdf\]](#) Borchure

Hollyland*3 *2 DF M1 DK 29*1 AS 15 L C1 C2 AF 3D AF Z6III TC

brochure brochures nikon asia Brochures |||

Z6III Z9 Z8 * CMOS 4000 cd/m2 EVF Nikon Imaging Cloud NX Studio Picture Control

... 6200119.8810059.945029.9725 23.976 fps 6048 340260p/50p/30p/25p/24p 4032

226860p/50p/30p/25p/24p **3984** 2240120p/100p/60p/50p/30p/25p/24p *

120p/100p/60p/50p/30p/25p 24p 119.8810059.945029.9725 23.976...

lang:en **score:11** filesize: 4.93 M page_count: 9 document date: 2024-09-20



[\[pdf\]](#) Borchure

OUTPERFORM Z6III NSG brochure 0821web nikon mea media brochures |||

OUTPERFORM OUTPERFORM The Z6III is far more than a simple upgrade from its predecessor; it s a cla ... pixels and frame rate RAW video 6048 3402:

60p/50p/30p/25p/24p 4032 2268: 60p/50p/30p/25p/24p **3984** 2240:

120p/100p/60p/50p/30p/25p/24p *Note: Actual frame rates for 120p, 100p, 60p, 50p, 30p, 2...

lang:en **score:8** filesize: 5.62 M page_count: 9 document date: 2024-08-21