

Antec AX90

ANTEC AX Series AX90 Mid-Tower ATX Gaming Case

User Manual

1. INTRODUCTION

This manual provides detailed instructions for the installation, operation, and maintenance of your ANTEC AX Series AX90 Mid-Tower ATX Gaming Case. Please read this manual thoroughly before beginning assembly to ensure proper setup and optimal performance.



Figure 1: ANTEC AX90 Mid-Tower ATX Gaming Case. This image shows the overall design of the case, highlighting its mesh front panel and tempered glass side panel.

2. KEY FEATURES

- **Unique Design & Powerful Heat Dissipation:** Engineered for optimal airflow and cooling performance.
- **Diamond-Shaped Mesh Front Panel:** Provides excellent air intake and a distinctive aesthetic.

- **Pre-Installed 4 x 120mm ARGB Fans:** Includes three 120mm ARGB fans at the front and one 120mm ARGB fan at the rear for immediate cooling and lighting.
- **Extensive Fan Support:** Accommodates up to 11 x 120mm fans simultaneously for maximum cooling potential.
- **Ample Cable Management Space:** Features 23mm of space behind the motherboard tray to ensure a neat and organized build.
- **Tempered Glass Side Panel:** Showcases your internal components with a clear, durable tempered glass panel.
- **Radiator Support:** Supports up to 360mm radiators for advanced liquid cooling solutions.



Figure 2: Pre-installed 120mm ARGB fans. This image illustrates the three front and one rear pre-installed ARGB fans, highlighting their lighting capabilities.

3. SPECIFICATIONS

Feature	Detail
Model Name	AX90
Case Type	Mid Tower
Dimensions (L x W x H)	47.3 x 21 x 48.6 cm
Weight	7.2 kg
Motherboard Compatibility	ATX, Micro-ATX, ITX
Expansion Slots	7
Front I/O Ports	1 x USB 3.0, 2 x USB 2.0, HD Audio
Pre-installed Fans	3 x 120mm ARGB (Front), 1 x 120mm ARGB (Rear)
Max GPU Length	385mm
Max CPU Cooler Height	160mm (estimated, common for mid-towers)
Radiator Support	Front: Up to 360mm, Top: Up to 360mm, Rear: 120mm
Drive Bays	2 x 3.5" HDD, 2 x 2.5" SSD (or 4 x 2.5" SSD)
Cable Management Space	23mm



Figure 3: Rear view of the ANTEC AX90 case, showing the expansion slots, rear fan mount, and power supply cutout.

4. SETUP AND INSTALLATION

Follow these steps for proper installation of your components into the ANTEC AX90 case.

4.1 Preparing the Case

1. **Remove Side Panels:** Carefully remove the tempered glass side panel by unscrewing the thumb screws at the rear and gently pulling it away. Place it on a soft, flat surface to prevent scratches or damage. Remove the steel side panel similarly.
2. **Accessory Box:** Locate the accessory box inside the case, which contains screws, zip ties, and other installation hardware.





Figure 4: Side view of the ANTEC AX90, illustrating the tempered glass panel. Exercise caution when handling the glass panel.

4.2 Motherboard Installation

1. Install the I/O shield into the motherboard cutout at the rear of the case.
2. Align your ATX, Micro-ATX, or ITX motherboard with the standoffs inside the case. Ensure all standoffs align with the screw holes on your motherboard.
3. Secure the motherboard using the appropriate screws from the accessory box.

4.3 Power Supply Installation

1. Position your ATX power supply unit (PSU) into the PSU shroud at the bottom rear of the case.
2. Secure the PSU from the rear of the case using the provided screws.

4.4 Storage Drive Installation

- **3.5" HDDs:** Install 3.5" hard drives into the drive cage located under the PSU shroud. Slide the drives into the trays and secure them.
- **2.5" SSDs:** Install 2.5" solid-state drives onto the dedicated mounting points behind the motherboard tray or on top of the PSU shroud. Secure with screws.

4.5 Graphics Card (GPU) Installation

1. Remove the necessary expansion slot covers at the rear of the case.
2. Insert your graphics card into the appropriate PCIe slot on the motherboard.
3. Secure the graphics card with screws. The case supports GPUs up to 385mm in length.



Figure 5: Internal view demonstrating maximum GPU length compatibility. The case provides ample space for long graphics cards.

4.6 Cooling System Installation (Optional)

- **Additional Fans:** Install additional 120mm or 140mm fans as desired on the top, front, or side mounts.
- **Liquid Cooling Radiators:** The case supports radiators up to 360mm at the front and top. Install radiators and fans according to your liquid cooler's instructions.

POWERFUL COOLING

Supporting 1 x 240mm radiator or 2 x 120mm fans side-mounted.



Figure 6: Illustration of liquid cooling radiator support. This image shows a 240mm radiator installed, demonstrating the case's cooling capabilities.

4.7 Cable Management

Utilize the 23mm space behind the motherboard tray and the numerous cable routing cutouts to organize your cables. Use zip ties (included in the accessory box) to secure cables for improved airflow and a cleaner aesthetic.

NEAT BUILD WITHIN REACH

23mm space for cable management ensures your PC build looks neat.



Figure 7: Rear view of the case highlighting the 23mm cable management space. Proper cable routing enhances airflow and aesthetics.

4.8 Final Assembly

Once all components are installed and cables are managed, reattach the steel side panel and then the tempered glass side panel, securing them with the thumb screws.

5. OPERATING THE ARGB LIGHTING

The ANTEC AX90 comes with pre-installed ARGB fans that can be controlled via the built-in hub or synchronized with your motherboard's ARGB software.

5.1 Using the Built-in ARGB Control Button

The case features a dedicated ARGB control button on the front I/O panel. Press this button to cycle through various pre-set lighting modes and effects. Hold the button down for a few seconds to turn the ARGB lighting on or off.

5.2 Motherboard Synchronization

To synchronize the ARGB lighting with your motherboard's software (e.g., ASUS Aura Sync, MSI Mystic Light Sync, GIGABYTE RGB Fusion, ASRock Polychrome Sync), connect the ARGB cable from the case's fan hub to the 3-pin 5V ARGB header on your motherboard. Once connected, you can control the lighting effects directly through your motherboard's utility software.



Figure 8: Diagram illustrating ARGB lighting synchronization with a motherboard. This shows the connection from the fan controller to the motherboard's ARGB header.

6. MAINTENANCE

Regular maintenance helps ensure optimal performance and longevity of your ANTEC AX90 case.

- **Dust Filters:** The case is equipped with removable dust filters (e.g., top, front, bottom). Periodically remove and clean these filters using compressed air or by washing them with water and mild soap. Ensure they are completely dry before reinstallation.

- **Interior Cleaning:** Use compressed air to blow out dust from inside the case, especially from fans, heatsinks, and hard-to-reach areas. For stubborn grime, use a soft, lint-free cloth slightly dampened with isopropyl alcohol.
- **Exterior Cleaning:** Wipe down the exterior surfaces with a soft, damp cloth. Avoid harsh chemicals or abrasive materials that could damage the finish or tempered glass.
- **Tempered Glass:** Clean the tempered glass panel with a glass cleaner and a microfiber cloth. Avoid excessive force or impact on the glass.

7. TROUBLESHOOTING

This section addresses common issues you might encounter with your ANTEC AX90 case.

7.1 Fans Not Spinning or ARGB Not Lighting Up

- **Check Connections:** Ensure all fan power cables (3-pin or 4-pin) are securely connected to the fan hub or motherboard fan headers. Verify ARGB cables are properly connected to the ARGB hub or motherboard's 5V ARGB header.
- **Power Supply:** Confirm the fan hub is receiving power from the PSU (usually via a SATA power connector).
- **Motherboard Software:** If using motherboard synchronization, ensure the correct software is installed and configured.
- **Control Button:** If using the built-in control, try pressing the ARGB button to cycle through modes or turn it on.

7.2 Poor Airflow or High Temperatures

- **Dust Filters:** Clean all dust filters regularly. Clogged filters severely restrict airflow.
- **Fan Orientation:** Ensure fans are oriented correctly for optimal airflow (e.g., front fans as intake, rear/top fans as exhaust).
- **Cable Management:** Improve cable management to reduce obstructions to airflow inside the case.
- **Component Clearance:** Ensure large components (e.g., CPU cooler, GPU) are not blocking critical airflow paths.

7.3 Front I/O Ports Not Functioning

- **Motherboard Headers:** Verify that the front panel cables (USB 3.0, USB 2.0, HD Audio, Power SW, Reset SW, HDD LED, Power LED) are correctly connected to the corresponding headers on your motherboard. Refer to your motherboard manual for header locations.
- **Driver Installation:** Ensure necessary USB drivers are installed for your operating system.

8. WARRANTY AND SUPPORT

For warranty information and technical support, please refer to the official Antec website or contact Antec

customer service directly. Keep your proof of purchase for warranty claims.

Antec Official Website: www.antec.com

Please note that damage to the tempered glass panel due to mishandling is typically not covered under warranty. Handle with extreme care.

© 2025 Antec Inc. All rights reserved. Product specifications are subject to change without notice.

Documents - Antec – AX90



[pdf]

Informacije o proizvodu EN ANTEC kućište AX90 AX Series Tehnoteka je online destinacija za upoređivanje cena i karakteristika bele tehnike potrošačke elektronike IT uređaja kod informacije en antec kuciste ax90 ax series 6523def3e8a0fapi tehnoteka rs 2023 10 informacije 6523def3e8a0f ||| <https://tehnoteka.rs> Informacije o proizvodu EN ANTEC kuiste **AX90** AX Series Tehnoteka je online destinacija za uporeivanje cena i karakteristika bele tehnike, potrosacke elektronike i IT ureaja kod trgovinskih lanaca i internet prodavnica u Srbiji. Nasa stranica vam omoguava da istrazite najnovije... lang:hr score:31 filesize: 14.59 M page_count: 3 document date: 2023-10-09

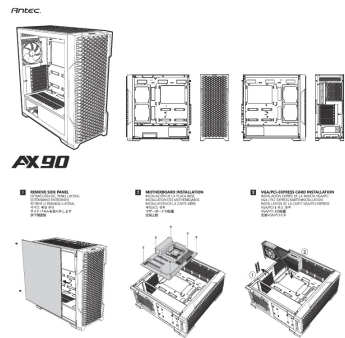

[pdf] User Manual

220926 Antec AX90 Manual OL User DocumentAntec Mid Tower Gaming Case Enhances Airflow ATX Compatible 1 Network Hardwares1077424428content etilize 1077424428 ||| ... lang:hr score:19 filesize: 63.52 M page_count: 2 document date: 2022-09-26



SPECIFICATIONS

Main Specs		Expansion Slots	
Model: AX90 RGB	4000 Series: AX90 RGB	Vertical	2
Case Type: Tower	4000 Series: AX90 RGB	Horizontal	6
Case Material: Steel	4000 Series: AX90 RGB	Other Slots	
Case Dimensions: 400mm (H) x 200mm (W) x 400mm (D)	4000 Series: AX90 RGB	PCI Express	2
Case Weight: 10.91kg (24.1lb)	4000 Series: AX90 RGB	PCI Express	2
Compatibility & Features		Internal Drive	
ATX, Micro-ATX, Mini-ITX	4000 Series: AX90 RGB	3.5" SATA	4
ATX, Micro-ATX, Mini-ITX	4000 Series: AX90 RGB	3.5" SATA	4
ATX, Micro-ATX, Mini-ITX	4000 Series: AX90 RGB	3.5" SATA	4
Power Supply		Internal Drive	
ATX, Micro-ATX, Mini-ITX	4000 Series: AX90 RGB	3.5" SATA	4
ATX, Micro-ATX, Mini-ITX	4000 Series: AX90 RGB	3.5" SATA	4
ATX, Micro-ATX, Mini-ITX	4000 Series: AX90 RGB	3.5" SATA	4
Build & Design		Internal Drive	
ATX, Micro-ATX, Mini-ITX	4000 Series: AX90 RGB	3.5" SATA	4
ATX, Micro-ATX, Mini-ITX	4000 Series: AX90 RGB	3.5" SATA	4
ATX, Micro-ATX, Mini-ITX	4000 Series: AX90 RGB	3.5" SATA	4



[pdf] Borchure

Brochure commerciale pour Antec AX90Télécharger le document Boitier Moyen Tour ATX AX90 RGB avec panneau vitré Noir brochure antec ax90 8181 1fodiscount ressources site product |||

...

lang:en score:14 filesize: 10.91 M page_count: 1 document date: 2022-11-07



[pdf]

№ 3 77 червень 2021 6514095c14e3d erc ua upload uploaded files 955 |||

3 77 2021 26 42 14 30 22 58 6 TWINKLY Ledworks, , . 14 Bo ... 4 / 5 1148 / 2,4 . 1,8 .

- . 2021 / ERC Magazine / 141 TP-LINK ARCHER **AX90** : Archer-**AX90** Archer **AX90** ,

TP-Link, . 4804 / 5 , 1201 / 5 574 / ...

lang:en score:13 filesize: 11.11 M page_count: 176 document date: 2022-04-18





SPECIFICATIONS			
Main Case		Expansion Slots	
Max. 2-bay 3.5" drive	400mm (15.7")	Max. 16 x PCIe 3.0	16
Max. 2-bay 2.5" drive	400mm (15.7")	Max. 16 x SATA 6Gb/s	16
Expansion Slots	400mm (15.7")	Max. 16 x SATA 6Gb/s	16
Max. 2-bay 3.5" drive	400mm (15.7")	Max. 16 x SATA 6Gb/s	16
Max. 2-bay 2.5" drive	400mm (15.7")	Max. 16 x SATA 6Gb/s	16
Compatibility & Certifications		Dimensions	
ATX, Micro-ATX, Mini-ITX	400mm (15.7")	Max. 16 x PCIe 3.0	16
ATX, Micro-ATX, Mini-ITX	400mm (15.7")	Max. 16 x SATA 6Gb/s	16
ATX, Micro-ATX, Mini-ITX	400mm (15.7")	Max. 16 x SATA 6Gb/s	16
Max. Support		Max. Support	
ATX, Micro-ATX, Mini-ITX	400mm (15.7")	Max. 16 x PCIe 3.0	16
ATX, Micro-ATX, Mini-ITX	400mm (15.7")	Max. 16 x SATA 6Gb/s	16
ATX, Micro-ATX, Mini-ITX	400mm (15.7")	Max. 16 x SATA 6Gb/s	16
Max. Support		Max. Support	
ATX, Micro-ATX, Mini-ITX	400mm (15.7")	Max. 16 x PCIe 3.0	16
ATX, Micro-ATX, Mini-ITX	400mm (15.7")	Max. 16 x SATA 6Gb/s	16
ATX, Micro-ATX, Mini-ITX	400mm (15.7")	Max. 16 x SATA 6Gb/s	16

[pdf] Datasheet

Antec AX90 black glass window Data sheet c7a3f241f5cfa4098db2ee34bffb7e54e57 gzhls at blob ldb 5 6 2 4 |||

...
lang:en score:12 filesize: 14.13 M page_count: 1 document date: 2022-12-16

