

PHI VILLA 9-Piece Set(Type 2)

PHI VILLA 9-Piece All-Weather Outdoor Dining Set Instruction Manual

Brand: PHI VILLA | Model: 9-Piece Set(Type 2)

1. PRODUCT OVERVIEW

This PHI VILLA 9-Piece All-Weather Outdoor Dining Set includes an expandable metal table and 8 swivel chairs with cushions, designed for outdoor use. The set combines durability with comfort and style, suitable for various patio, backyard, or garden settings.

Key Features:

- **Comfortable Padded Cushions:** Each swivel metal dining chair is equipped with an extra-large seat cushion and a soft pillow. These cushions are made from texture fabric that is UV resistant, weather resistant, and designed not to discolor easily. The covers are removable for easy cleaning.
- **360-Degree Swivel Chairs:** The outdoor dining chairs feature E-coated metal steel frames with decorative wicker accents. They offer a 360-degree swivel and gentle rocking motion, along with curved armrests for enhanced comfort and versatility.
- **Expandable Rectangular Table:** The dining table can be extended to approximately 82"x37"x30", providing ample space for up to 8 people. Its expandable design allows for length adjustment to suit your specific needs.
- **Durable Construction:** The entire set is constructed with heavy-duty materials, including E-coated metal steel for rust and weather resistance, ensuring longevity and stability.

2. SETUP AND ASSEMBLY

Assembly is required for this dining set. All necessary hardware and step-by-step paper instructions are included in the packaging. The set is shipped in multiple cardboard boxes to ensure protection during transit.

Assembly Steps (General Guidance):

1. Unpack all components and verify against the parts list in the instruction manual.
2. Assemble the table frame first, ensuring all bolts are securely tightened.
3. Attach the table top to the assembled frame.
4. Assemble each chair frame, then attach the wicker base and seat/back components.
5. Place the cushions on the chairs, securing them with the integrated velcro straps.



Figure 2.1: Dimensions of the dining table and swivel chair.

Hidden Extendable Design

Suitable for Different Situations

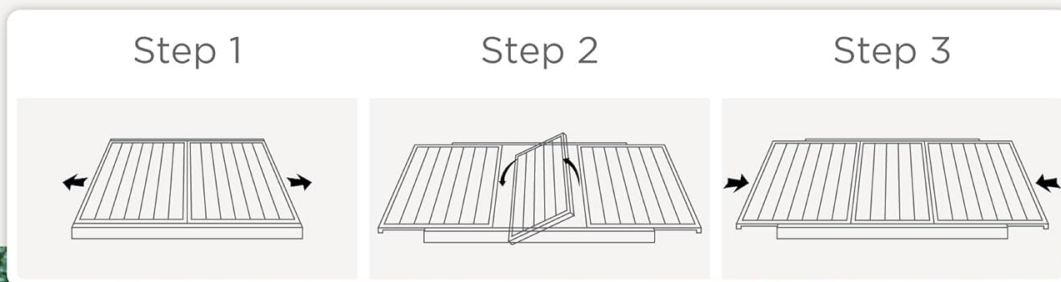

Figure 2.2: Steps for extending the dining table.

Video 2.1: Demonstration of the PHI VILLA 61"-84" Expandable Patio Outdoor Dining Table extension mechanism.

3. OPERATING INSTRUCTIONS

Using the Swivel Chairs:

The chairs are designed with a 360-degree swivel mechanism and a gentle rocking feature. To swivel, simply rotate the chair in your desired direction. For rocking, lean back gently. The wide base ensures stability during use.

360° Smooth Swivel

Gentle Rocking



Figure 3.1: Swivel and rocking features of the patio chair.

Video 3.1: Demonstration of the PHI VILLA Swivel Patio Dining Chairs with Cushions.

Extending the Dining Table:

The table features a hidden extendable design. Follow the steps in the assembly section (Figure 2.2) to adjust the table length to accommodate more guests or reduce it for a compact setup.

4. MAINTENANCE

Proper maintenance will ensure the longevity and appearance of your PHI VILLA dining set.

General Care:

- Wipe the table and chair frames with a dry cloth to remove dust and debris.
- For deeper cleaning, use a mild soap and water solution, then rinse thoroughly and dry completely.
- The cushions are water-resistant and stain-resistant. For spills, wipe immediately with a clean cloth.

Cushion covers can be removed via zippers for more thorough cleaning.



Figure 4.1: Cushion features for easy maintenance.

Video 4.1: Demonstration of the water-proof cushions on PHI VILLA Patio Chairs.

Storage and Protection:

- It is recommended to use a protective cover when the dining set is not in use to shield it from weather elements.
- Store the dining set in a covered area during harsh weather conditions or off-season to prevent damage.

Safety Guidelines:

- Keep the area around the dining set clear to prevent tip-over risks.
- Do not leave children unattended near the dining set.
- Inspect the dining set regularly for any loose or sharp edges and tighten or repair as necessary.

5. SPECIFICATIONS

Feature	Detail
Brand	PHI VILLA
Model	9-Piece Set(Type 2)
Color	Beige-swivel
Size (Extended Table)	82x37x30 inches
Style	Modern, Stylish
Assembly Required	Yes
Item Depth (Table)	30 inches
Shape (Table)	Rectangular
Product Care Instructions	Wipe with Dry Cloth
Material Type	Alloy Steel
Included Components	Back Cushions, Expandable Dining Table, Seat Cushions, Swivel Chairs

6. TROUBLESHOOTING

If you encounter any issues during the assembly or use of your PHI VILLA dining set, please consider the following general troubleshooting steps:

- **Loose Parts:** Ensure all bolts and fasteners are securely tightened. Periodically check and re-tighten as needed.
- **Uneven Surface:** If the table or chairs wobble, ensure they are placed on a flat, even surface. The table features adjustable non-slip footcaps that can be used to stabilize it.
- **Cushion Slippage:** Verify that the velcro straps on the cushions are properly attached to the chair frames to prevent movement.
- **Table Extension Issues:** If the table extension mechanism is stiff, ensure no debris is obstructing the slideway. Apply a silicone-based lubricant if necessary.

For persistent issues or specific concerns, please refer to the detailed assembly manual provided with your product or contact customer support.

7. WARRANTY AND SUPPORT

PHI VILLA offers a one-year warranty for this product. We are committed to providing professional customer service throughout your experience.

Customer Service:

Should you have any questions or encounter any problems after receiving your PHI VILLA dining set, please do not hesitate to contact our customer service team. We aim to resolve your concerns within 24 hours to ensure your satisfaction.

Contact information can typically be found in the product packaging or on the official PHI VILLA website.

Thank you for choosing PHI VILLA. Enjoy your outdoor dining experience!