



[Manuals.plus](#) /

› [SCYAN](#) /

› SCYAN D7 Smart Deadbolt Lock User Manual

SCYAN D7

SCYAN D7 Smart Deadbolt Lock User Manual

Model: D7 | Brand: SCYAN

1. INTRODUCTION

This manual provides detailed instructions for the installation, operation, and maintenance of your SCYAN D7 Smart Deadbolt Lock. Please read this manual thoroughly before installation and use to ensure proper function and to maximize the lifespan of your device. The SCYAN D7 offers multiple access methods including fingerprint, passcode, key card, and traditional key, designed for enhanced security and convenience in residential and rental properties.

2. SAFETY INFORMATION

- Do not attempt to disassemble or repair the lock yourself. Refer to qualified service personnel.
- Use only the specified battery type (4 AA alkaline batteries, not included). Do not mix old and new batteries or different types of batteries.
- Avoid exposing the lock to direct sunlight for prolonged periods or to extreme temperatures.
- Keep the keypad clean and dry. Avoid using abrasive cleaners or solvents.
- Ensure the door closes and latches properly before engaging the deadbolt.

3. PACKAGE CONTENTS

Verify that all components are present before beginning installation:

- Front Lock Unit
- Back Lock Unit
- Two Physical Keys (Schlage C key compatible)
- Metal Mounting Plate
- Deadbolt Latch
- Strike Plate

- Mounting Screws

4. INSTALLATION AND SETUP

4.1 Pre-installation Checks

- **Door Thickness:** Fits doors between 1 3/8" (35mm) and 2" (50mm).
- **Backset:** Adjustable for 2 3/8" (60mm) or 2 3/4" (70mm).
- **Crossbore Diameter:** 2 1/8" (53mm) or 1 1/2" (38mm).
- **Edge Bore Diameter:** 1" (25mm) hole, at least 1" (25mm) deep.

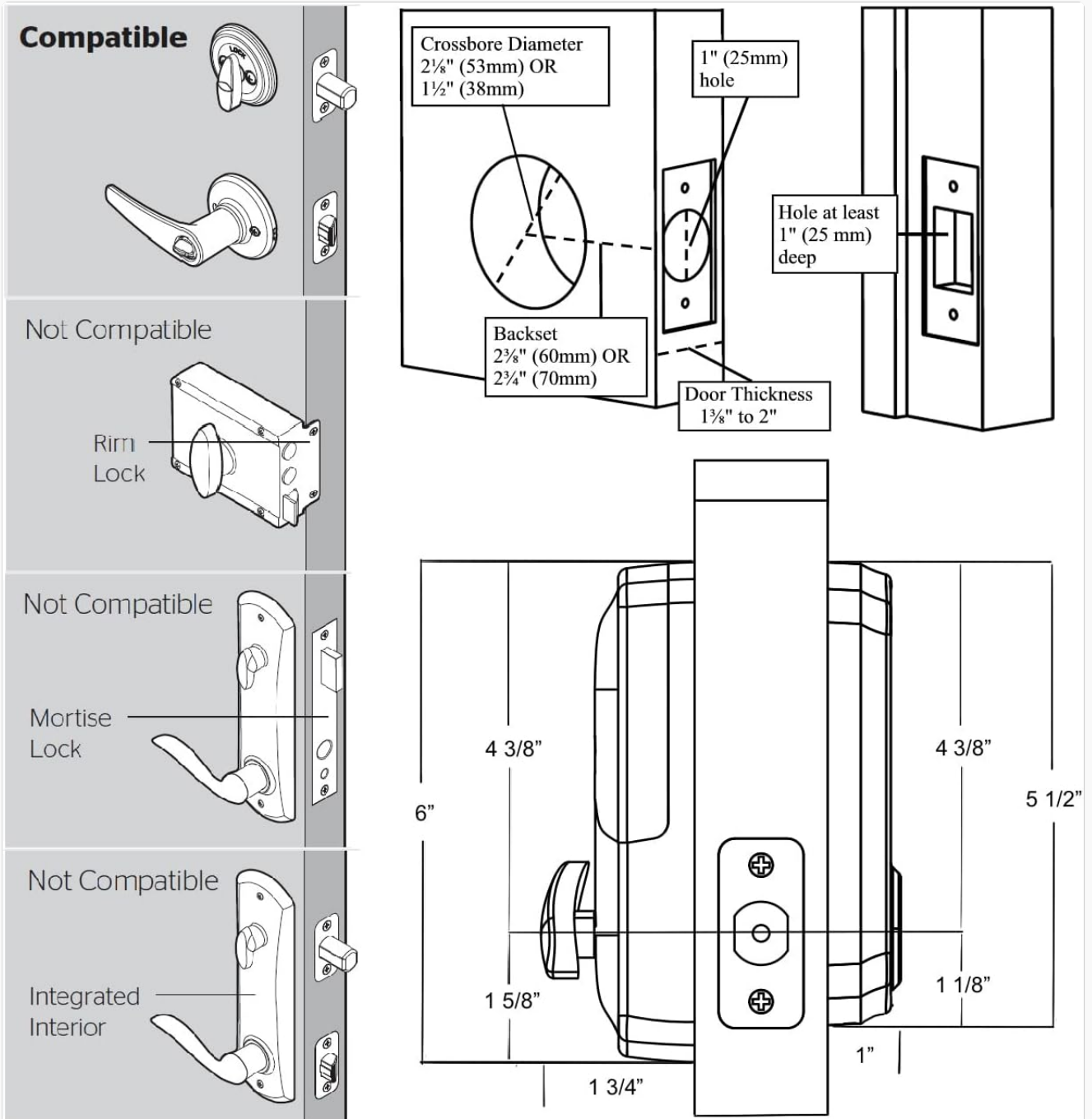

Figure 1: Door compatibility and dimensions for SCYAN D7 installation. This diagram illustrates the required measurements for door thickness, backset, and bore holes to ensure proper fitment of the deadbolt.

4.2 Tools Required

- Phillips Head Screwdriver

4.3 Installation Steps

The SCYAN D7 is designed for easy installation, typically requiring only a Phillips screwdriver. No drilling or locksmith services are usually needed if replacing an existing deadbolt.

1. **Prepare the Door:** Ensure your door meets the specifications listed in Section 4.1. Remove any existing deadbolt hardware.
2. **Install the Latch:** Insert the deadbolt latch into the door edge. Ensure the correct backset (2 $\frac{3}{8}$ " or 2 $\frac{3}{4}$ ") is selected and the latch bolt faces the door frame. Secure with screws.
3. **Install the Exterior Assembly:** Route the cable from the exterior keypad assembly through the crossbore hole. Position the exterior assembly flush against the door.
4. **Install the Interior Mounting Plate:** Secure the interior mounting plate to the exterior assembly using the provided screws, ensuring the cable passes through the plate.
5. **Install the Interior Assembly:** Connect the cable from the exterior assembly to the interior assembly. Ensure the thumb turn spindle aligns with the latch mechanism. Attach the interior assembly to the mounting plate with screws.
6. **Install Strike Plate:** Install the strike plate on the door frame, aligning it with the deadbolt latch.
7. **Insert Batteries:** Open the battery cover on the interior assembly and insert four (4) new AA alkaline batteries.
8. **Door Handing:** The lock is compatible with both left-handed and right-handed doors. The lock will automatically detect the door handing during initial setup or after battery installation.

4.4 App Download and Pairing

The SCYAN D7 lock is managed via a smartphone application (TTLock App). While the app cannot unlock the deadbolt directly, it is essential for user management, passcode generation, and advanced settings.

1. Download the TTLock App from your smartphone's app store.
2. Create an account and log in.
3. To pair the lock, ensure Bluetooth is enabled on your phone and the lock is in pairing mode. To activate pairing mode on the lock, press ***83#** on the keypad, then enter your Admin Code followed by#. The lock will prompt "please add a Bluetooth administrator."
4. In the app, select "Add Lock" and follow the on-screen instructions to discover and pair your SCYAN D7 lock. Keep the keypad illuminated by pressing a number key every few seconds during the pairing process.

5. OPERATING INSTRUCTIONS

Smart & Solid



Fingerprint



Work with Alexa



Privacy Mode



Backup Key



Micro USB port
for backup power



Fingerprint resistant
Matte finish keypad



IC card
unlock



Auto locking
mode



TTLock App



Figure 2: Overview of SCYAN D7 Smart Deadbolt features, including fingerprint, IC card, auto-locking, backup key, Micro USB port, and TTLock App compatibility.

5.1 Unlocking Methods

- **Fingerprint:** Place your registered finger on the fingerprint sensor. The lock will unlock upon successful recognition. The semiconductor fingerprint sensor offers high recognition rates for various finger conditions.
- **Passcode:** Enter your registered passcode on the illuminated touchscreen keypad, then press#. The keypad is designed with a matte finish to resist fingerprints and smudges.
- **Key Card:** Present a registered key card to the designated area on the lock.
- **Physical Key:** Insert the provided physical key into the keyhole and turn to unlock. This serves as an override in case of electronic failure or dead batteries.

5.2 User Management via App

The TTLock App allows comprehensive management of users and access methods:

- **Add/Delete Users:** Register up to 100 fingerprint users, 250 passcodes, and 1000 key cards.
- **Generate Passcodes:** Create various types of passcodes including permanent, timed, one-time, or customized passcodes for guests or service providers.
- **Audit Trail:** View up to 2000 audit trail logs to track lock activity.

5.3 Auto-Locking Feature

The auto-locking feature automatically relocks the deadbolt after a set delay time. This can be enabled and configured via the app or directly on the keypad.

- **To Enable Auto-Lock:** Press *21# on the keypad. Enter your Admin Code, then press#. Input the desired delay time in seconds (e.g., 15 for 15 seconds), then press # again to confirm. A minimum of 15 seconds is recommended.
- **To Disable Auto-Lock (Passage Mode):** Ensure the lock is in an unlocked state. Press*123# on the keypad. The lock will verbally confirm it is in passage mode, meaning it will not automatically relock.

5.4 Mute Function

The lock offers an option to turn off voice prompts via the TTLock App for silent operation.

6. MAINTENANCE

6.1 Battery Replacement

The lock requires four (4) AA alkaline batteries. The app will display the current battery level. When batteries are low, the lock will provide an audible warning. To replace, remove the battery cover on the interior assembly, replace all four batteries, and reattach the cover.

6.2 Backup Power

In case of complete battery depletion, a power bank can be connected via the micro USB port on the exterior unit to provide temporary power for unlocking.

6.3 Cleaning

Wipe the lock's exterior surfaces with a soft, damp cloth. Do not use harsh chemicals or abrasive materials, as these can damage the finish or electronic components.

7. TROUBLESHOOTING

- **Keypad Not Responding:** Ensure batteries are not depleted. If the keypad illumination turns off during input, you may need to re-enter the sequence more quickly.
- **Fingerprint Recognition Issues:** Try registering multiple fingerprints for the same finger, covering different angles and sides of the finger's surface. Ensure the sensor is clean.
- **App Pairing Problems:** If the app fails to find the lock, ensure the lock is in pairing mode by pressing*83# followed by your Admin Code and #. Keep the keypad illuminated during the search.
- **Lock Not Auto-Locking:** Verify that auto-lock is enabled (refer to Section 5.3) and the delay time is set correctly. Ensure the lock is not in Passage Mode.
- **Lock Not Unlocking:** Check battery levels. If batteries are dead, use the physical key or connect a power bank via the micro USB port.
- **General Issues:** For persistent problems, consult the help section within the TTLock App or contact customer support.

8. SPECIFICATIONS

Feature	Specification
---------	---------------

Brand	SCYAN
Model Name	Scyan D7
Lock Type	Deadbolt
Material	Zinc
Color	Aged Bronze
Dimensions (L x W x H)	6 x 3 x 2 inches
Item Weight	2.55 pounds
Door Thickness Compatibility	1 $\frac{3}{8}$ " to 2" (35mm to 50mm)
Backset Compatibility	Adjustable 2 $\frac{3}{8}$ " or 2 $\frac{3}{4}$ " (60mm or 70mm)
Operating Temperature	-4°F (-20°C) to 158°F (70°C)
Power Source	4 AA Batteries (not included)
Connectivity	Bluetooth
User Capacity (Fingerprints)	Up to 100
User Capacity (Passcodes)	Up to 250
User Capacity (Key Cards)	Up to 1000
Audit Trail Logs	Up to 2000

9. WARRANTY AND SUPPORT

The SCYAN D7 Smart Deadbolt Lock comes with a one-year limited manufacturer warranty. Additionally, SCYAN provides free lifetime technical support. As a US-based company, SCYAN offers customer service from Washington. For technical assistance, warranty claims, or further inquiries, please refer to the contact information provided with your product packaging or visit the official SCYAN website.