

[Manuals.plus](#) /

> [EdisonBright](#) /

> EdisonBright Fenix PD36 TAC 3000 Lumen LED Tactical Flashlight Instruction Manual

EdisonBright FEN-PD36TACZ-EBUSBACCC

EdisonBright Fenix PD36 TAC Flashlight

INSTRUCTION MANUAL

Model: FEN-PD36TACZ-EBUSBACCC

1. Product Overview

The Fenix PD36 TAC is a high-performance tactical flashlight designed for professional use and outdoor activities. It delivers a maximum output of 3000 lumens and features a patented dual-function tactical switch for instant activation and mode selection. This flashlight is built with a durable A6061-T6 aluminum body and includes a rechargeable 5000mAh battery.

- **3000 Lumen Output:** Provides powerful illumination for various scenarios.
- **Rechargeable Battery:** Comes with a 5000mAh Li-ion battery and USB charging capability.
- **Tactical and Duty Modes:** Offers versatile operation for different needs.
- **Dual-function Tactical Switch:** Enables quick and intuitive control.
- **Durable Construction:** Features an A6061-T6 aluminum body with a hard-anodized finish.

2. What's Included

Verify that all items listed below are present in your package:

- Fenix PD36 TAC Flashlight
- ARB-L21-5000U Rechargeable Li-ion battery
- USB Charging cable
- Holster
- Spare O-ring
- User manual
- Warranty card
- EdisonBright brand USB power adapter

INCLUDED

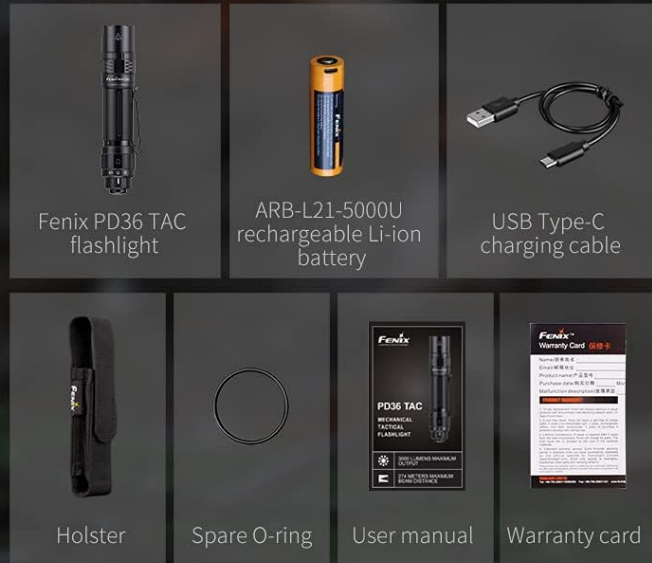

Package size: 160 x 90 x 35 mm

* The data is from the results produced by Fenix through its laboratory testing. Actual results may vary slightly according to the measurement method in the industry.

Image: All components included in the Fenix PD36 TAC package.

3. Setup

3.1 Battery Installation

1. Unscrew the tail cap of the flashlight by rotating it counter-clockwise.
2. Insert the ARB-L21-5000U Li-ion battery with the positive (+) terminal facing towards the head of the flashlight.
3. Screw the tail cap back on clockwise until it is securely tightened. Ensure proper polarity to prevent damage, as the flashlight features reverse polarity protection.

3.2 Charging the Battery

The included ARB-L21-5000U battery has a built-in USB-C charging port.

1. Locate the USB-C port on the battery itself.
2. Connect the provided USB charging cable to the battery's USB-C port.
3. Plug the other end of the USB cable into the EdisonBright brand USB power adapter or any compatible USB power source.
4. The battery's indicator light will show charging status (refer to battery manual for specific light indications).

- **Duty Mode:** In Duty Mode, partially press the tactical tail switch to cycle through Turbo, High, Med, Low, and Eco. Fully press to select the desired output.

4.4 Lockout Function

To prevent accidental activation, the flashlight features a lockout function. This is typically engaged by a specific sequence of switch presses or by slightly unscrewing the tail cap. Refer to the detailed user manual included in the package for the exact lockout procedure.



Image: The Fenix PD36 TAC flashlight demonstrating its compact design and tactical features.

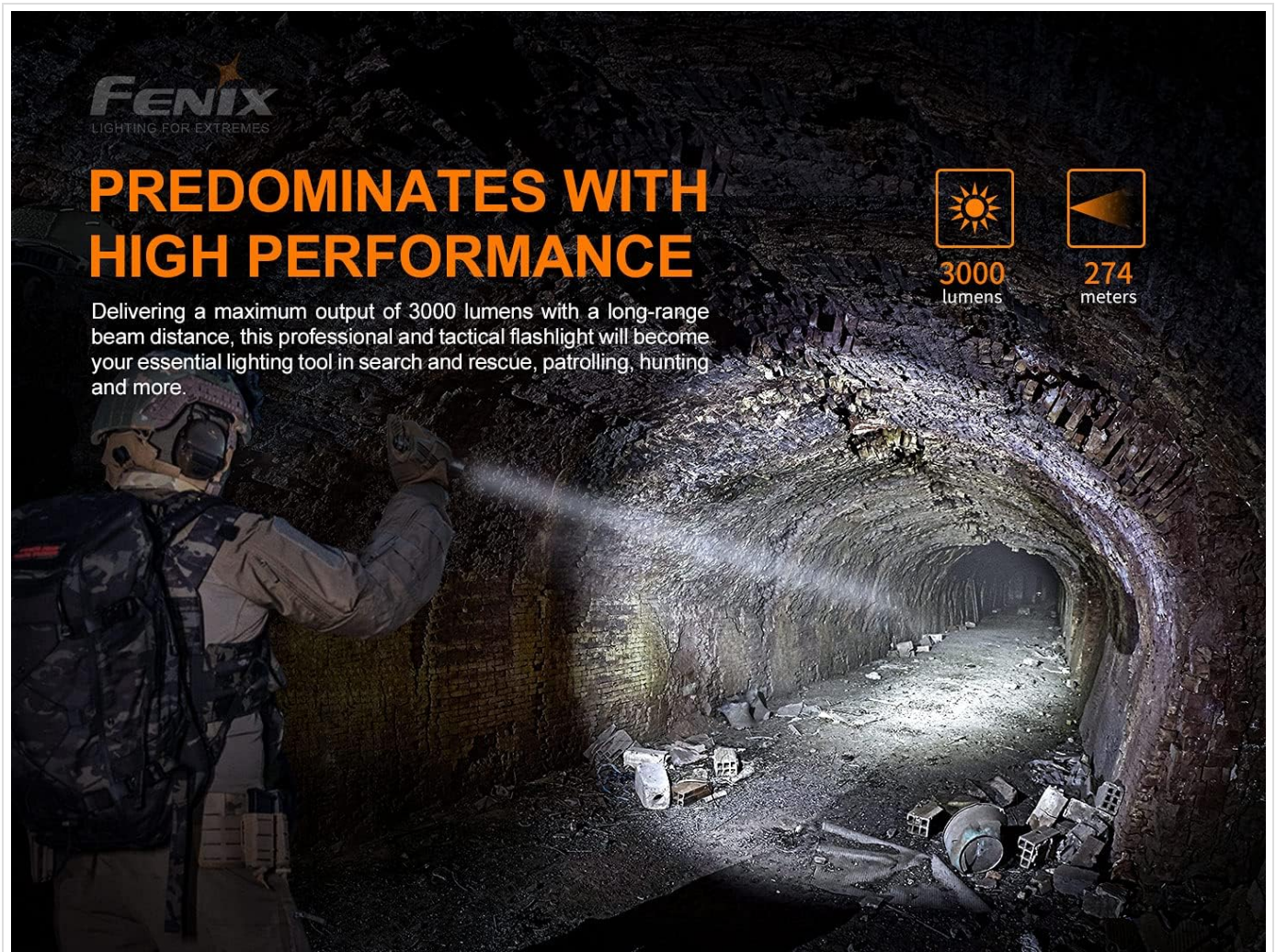

Image: The Fenix PD36 TAC flashlight providing high-performance illumination in a dark environment.

5. Maintenance

Proper maintenance ensures the longevity and optimal performance of your Fenix PD36 TAC flashlight.

- **Cleaning:** Clean the flashlight body with a soft cloth. For optical surfaces, use a lens cleaning cloth.
- **O-ring Maintenance:** Regularly inspect the O-ring for wear and tear. Replace it if damaged to maintain the IP68 waterproof rating. Apply silicone grease to the O-ring periodically to ensure a good seal.
- **Thread Lubrication:** Lubricate the threads of the tail cap with silicone grease to ensure smooth operation and prevent wear.
- **Battery Care:** Store the battery in a cool, dry place when not in use. Recharge the battery every four months if stored for extended periods to maintain battery health.

6. Troubleshooting

If your Fenix PD36 TAC flashlight is not functioning correctly, please refer to the following common issues and solutions:

- **Flashlight does not turn on or flickers:**
 - Check if the battery is inserted correctly with the positive (+) terminal facing the head. The flashlight has reverse polarity protection, but incorrect insertion will prevent operation.
 - Ensure the battery is fully charged.
 - Tighten the tail cap securely. A loose tail cap can interrupt the electrical connection.
 - Clean the contact points of the battery and flashlight with an alcohol swab.

- **Reduced brightness or short runtime:**

- The battery may be low. Recharge the battery fully.
- The flashlight may be in a lower output mode. Cycle through the modes to select a higher brightness.
- Ensure the battery is an authentic Fenix ARB-L21-5000U or equivalent high-quality 21700 Li-ion battery.

- **Flashlight becomes warm during use:**

- It is normal for high-lumen flashlights to generate heat, especially on Turbo or High modes, due to the powerful LED output. The flashlight is designed with intelligent overheat protection to automatically reduce output when the internal temperature reaches a certain threshold.
- If the flashlight becomes excessively hot to touch or causes discomfort, discontinue use and allow it to cool down. If you experience any issues such as material damage due to heat, cease use immediately and contact customer support.

If the problem persists after attempting these solutions, please contact EdisonBright customer support for further assistance.

7. Specifications

Detailed technical specifications for the Fenix PD36 TAC flashlight:

Feature	Detail
Maximum Output	3000 Lumens
LED Type	Luminus SST70 LED (50,000 hours lifespan)
Battery	ARB-L21-5000U Rechargeable Li-ion (included)
Operating Modes	Tactical Mode (High, Strobe), Duty Mode (Turbo, High, Med, Low, Eco)
Material	A6061-T6 Aluminum body, Premium type HAIII hard-anodized anti-abrasive finish
Water Resistance	IP68 Waterproof rating
Impact Resistance	1-Meter
Length	5.5 inches (140 mm)
Body Width	1 inch (25.4 mm)
Head Width	1.04 inches (26.5 mm)
Weight	3.24 ounces (92 grams) excluding battery
UPC	850038215347
Model Number	FEN-PD36TACZ-EBUSBACCC

Output Performance Table (ANSI/PLATO FL1 Standard)



RAPID REACT DUAL MODE

Rotating the mechanical toggle switch on the tail allows you to instantly switch between Tactical and Duty mode. You can count on this reliable PD36 TAC to fight against criminal activities or to enforce the law.



Image: Detailed technical parameters and performance data for the Fenix PD36 TAC.

8. Warranty and Support

The Fenix PD36 TAC flashlight comes with a limited warranty. Please refer to the warranty card included in your package for specific terms and conditions.

For technical support, warranty claims, or any inquiries regarding your product, please contact EdisonBright customer service. You can find contact information on the warranty card or by visiting the official EdisonBright store online.

EdisonBright Store: [Visit EdisonBright Store on Amazon](#)