

Manuals+

[Q & A](#) | [Deep Search](#) | [Upload](#)

[manuals.plus](#) /

› [ZOCONE](#) /

› [ZOCONE Heavy Duty Tension Curtain Rod \(51-148 Inches\) - Stainless Steel Instruction Manual](#)

ZOCONE 51-148 Inches

ZOCONE Heavy Duty Tension Curtain Rod (51-148 Inches) - Stainless Steel Instruction Manual

Model: 51-148 Inches

INTRODUCTION

Thank you for choosing the ZOCONE Heavy Duty Tension Curtain Rod. This versatile, no-drilling rod is designed for easy installation and strong support, suitable for various applications in your home or outdoor spaces. Crafted from thickened carbon steel, it offers durability and rust resistance. This manual provides detailed instructions for setup, operation, maintenance, and troubleshooting to ensure optimal performance and longevity of your product.

PACKAGE CONTENTS

Please verify that all components are present before beginning installation:

- 1 x Spring Rod with Holes
- 2 x Long Extension Rods (40 inches each)
- 2 x End Caps (Non-slip rubber)
- 12 x Curtain Rings
- 1 x Support Bracket (Optional use)
- 2 x Screw Anchors (for support bracket)

ADJUSTABLE TENSION CURTIAN ROD

32 MM Pressurizer * 1



29 MM Pressurizer * 1



Anti-slip end caps * 2



Support bracket * 1



Screw anchors *2



Curtain rings * 12



Long extension rod (40") * 2



Rod with holes (43-63") * 1

Get the length of shower curtain rod you want by splicing it together

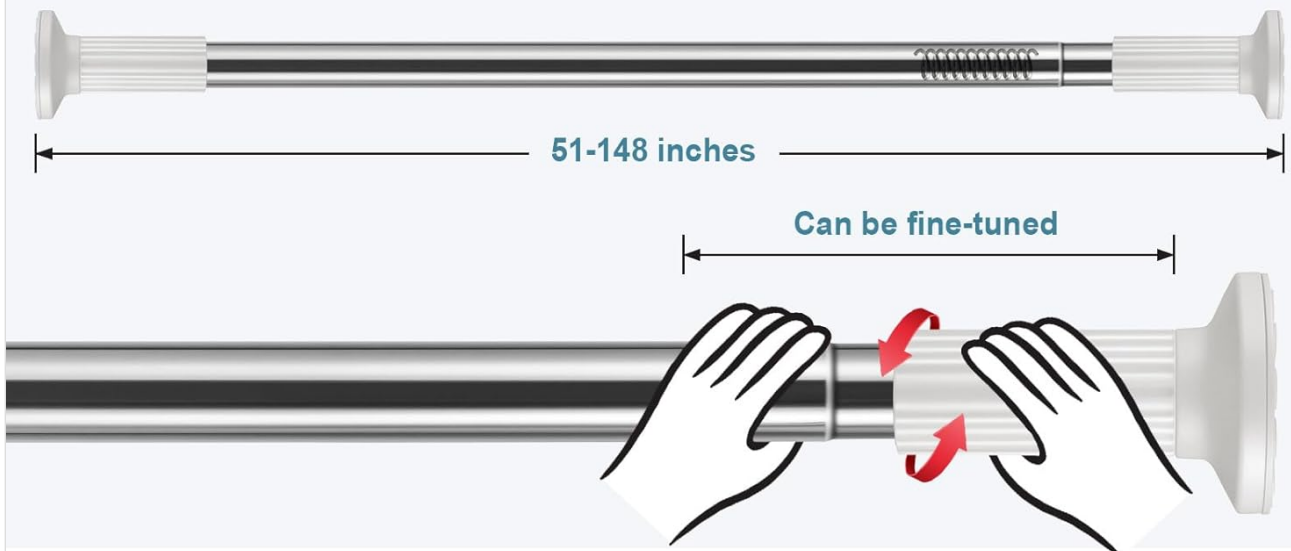

Figure 1: All components included with the ZOCONE Adjustable Tension Curtain Rod, showing the spring rod, extension rods, end caps, curtain rings, and support bracket.

SPECIFICATIONS

Feature	Detail
Brand	ZOCONE
Model	51-148 Inches
Material	Thickened Carbon Steel
Color	Stainless Steel
Product Dimensions	148"L x 1.26"W (fully extended)
Mounting Type	Tension Mounted (No Drilling)

Feature	Detail
Weight Capacity	Up to 45 lbs
Item Weight	4.25 Pounds

SETUP & INSTALLATION

The ZOCONE Tension Curtain Rod is designed for quick and easy installation without the need for drilling, screws, or additional tools. It is suitable for various surfaces including tiles, wood, wallpaper, glass, plaster, and both smooth or rough walls.

1. Measure and Select Rod Length

Before installation, accurately measure the distance between the two walls or surfaces where the rod will be placed. Refer to the diagram below to select the appropriate combination of rod sections to achieve the desired length. The rod can be extended from 51 to 148 inches.

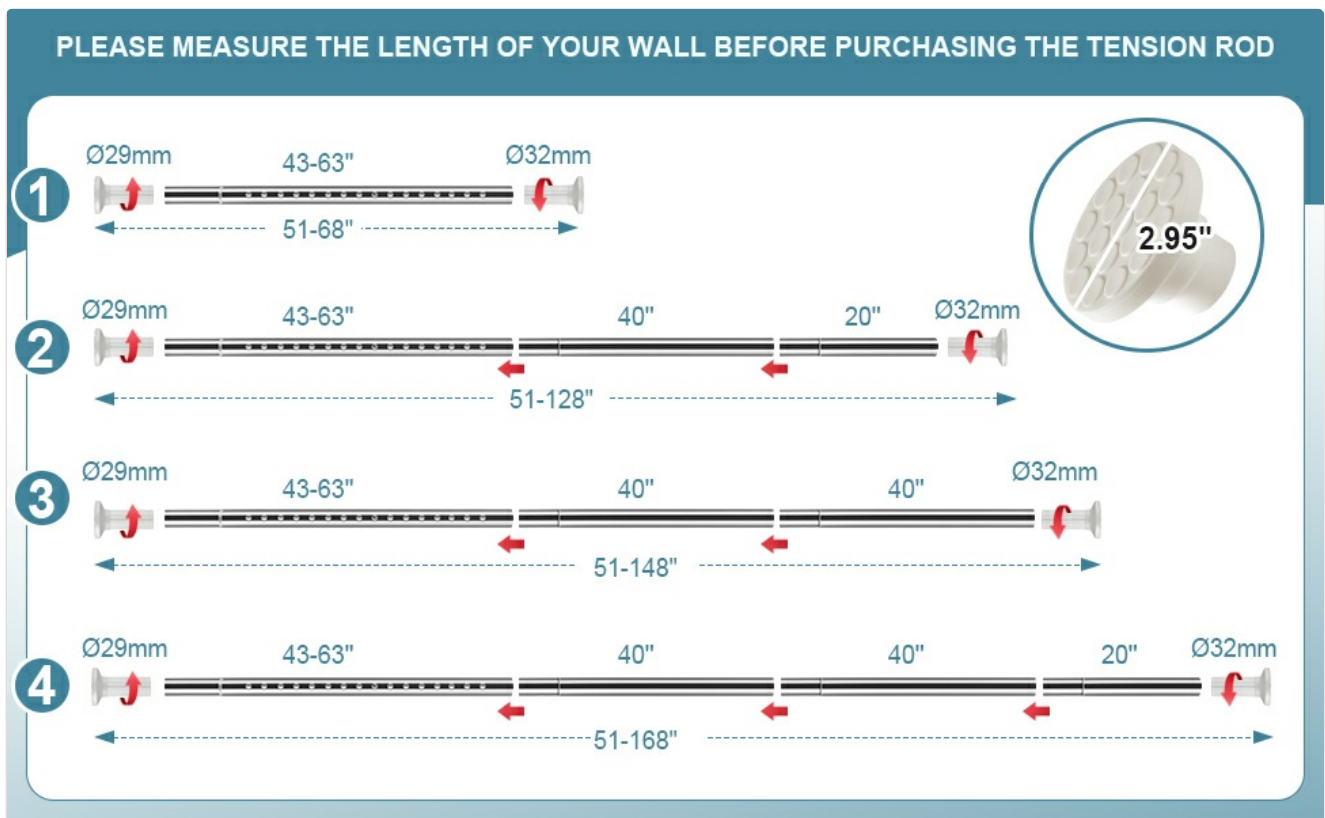

Figure 2: Guide for measuring wall length and combining rod sections to achieve various lengths from 51 to 148 inches.

2. Assemble and Adjust the Rod

Connect the necessary rod sections. The 29mm-diameter small end cap must be installed on the thin end of the perforated spring rod. Follow these steps for tension installation:

1. Measure the distance between the walls and choose the appropriate tension rod size.
2. Extend the rod to be 1-2 inches longer than the actual measured length. Press the metal button on the spring rod and leave two to three extra holes exposed.
3. Place one end of the spring rod against the wall. Compress the rod slightly while pushing the other end upwards until it is parallel to the floor.
4. Tighten the trimming nuts on both sides by rotating them to securely fasten the rod in place. The non-slip rubber end caps will provide a strong grip.

EASY TO INSTALL

1 Insert the Additional Rod



2 Adjust the Spring Rod



3 Rotate the pressurizer makes it more sturdy

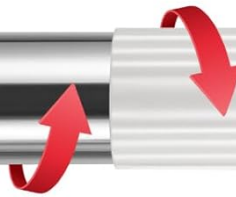

Figure 3: Step-by-step visual guide for installing the ZOCONE Tension Curtain Rod.

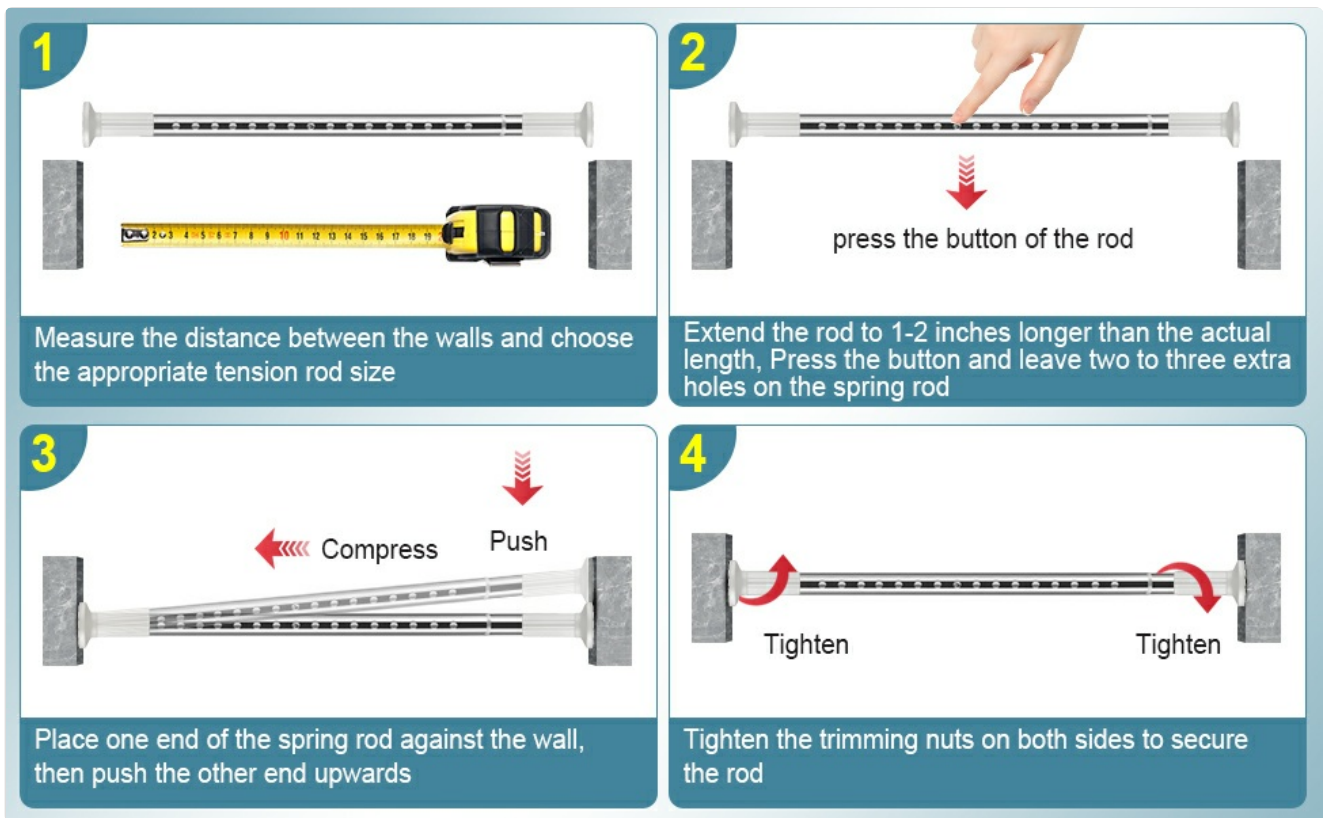

Figure 4: Comprehensive installation steps for the ZOCONE Tension Rod.

3. Optional Support Bracket Installation

For extra heavy loads or very long spans, a support bracket is included. This can be installed using sealant or screws (choose one method) to provide additional stability and prevent sagging. Note: The 128-inch pole does not include support brackets.



Figure 5: Instructions for installing the optional support bracket.

Installation Video

Your browser does not support the video tag.

Video 1: A seller-provided video demonstrating the assembly and installation of the ZOCONE Tension Curtain Rod.

OPERATING INSTRUCTIONS

Once installed, the ZOCONE Tension Curtain Rod requires minimal operation. Ensure the rod remains securely in place by periodically checking the tension. The non-slip end caps are designed to maintain a strong grip on various surfaces.

Adjusting Length

To adjust the length after initial installation, carefully release the tension by rotating the trimming nuts. Reposition the rod to the desired length, ensuring it is 1-2 inches longer than the opening, then re-tighten the nuts to secure it firmly.

Using Curtain Rings

The included curtain rings can be easily attached to your curtains and then slid onto the rod. This allows for smooth movement of curtains across the rod.

MAINTENANCE

To ensure the longevity and appearance of your ZOCONE Tension Curtain Rod, follow these simple maintenance guidelines:

- **Cleaning:** Wipe the rod with a soft, damp cloth to remove dust or grime. Avoid abrasive cleaners that could damage the stainless steel finish.
- **Rust Resistance:** The rod is designed to be rust-resistant. However, in high-humidity environments like bathrooms, occasional drying can help maintain its pristine condition.
- **Tension Check:** Periodically check the tension of the rod to ensure it remains securely in place. If it feels loose, re-tighten the trimming nuts as described in the installation section.

TROUBLESHOOTING

If you encounter any issues with your ZOCONE Tension Curtain Rod, please refer to the following common solutions:

- **Rod is not holding tension or keeps falling:**
 - Ensure the rod is extended 1-2 inches longer than the opening before tightening.
 - Make sure the trimming nuts on both ends are fully tightened.
 - Verify that the non-slip rubber end caps are clean and making full contact with the wall surface.
 - If using for heavy curtains or a long span, consider installing the included support bracket (if applicable for your rod size).
- **End cap installation issues:**
 - As per the product tips, the instructions may have order problems. Ensure the 29mm-diameter small end cap is installed on the thin end of the perforated spring rod. Refer to the main product images for visual guidance if needed.
- **Rod is sagging in the middle:**

- This can occur with very long spans or heavy loads. Install the provided support bracket in the middle of the rod to provide additional support.

If these steps do not resolve your issue, please contact ZOCCONE customer support for further assistance.

VERSATILE APPLICATIONS

The ZOCCONE Tension Curtain Rod is designed for multi-purpose use, offering flexible solutions for various spaces:

- **Bathroom:** Ideal as a shower curtain rod.
- **Bedroom & Living Room:** For hanging curtains, room dividers, or blackout curtains.
- **Closet:** Create temporary or additional hanging space for clothes.
- **Kitchen:** Hang kitchen supplies, towels, or light curtains.
- **Outdoor Patio, Caravans, Gazebo:** Use for outdoor curtains, decorations, or signs, designed to withstand outdoor winds.



Figure 6: Examples of the ZOCCONE Tension Rod in various home and outdoor settings.



Figure 7: The ZOCONE Tension Rod effectively used as a shower curtain rod.

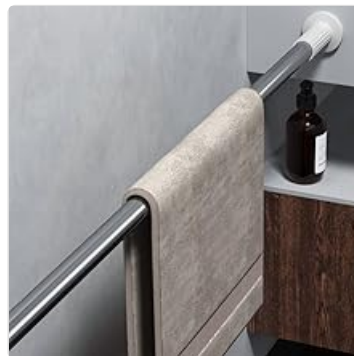

Figure 8: The tension rod serving as a convenient towel rack.



Figure 9: The tension rod providing practical storage for kitchen utensils.



Figure 10: The tension rod creating additional hanging space in a closet.

SUPPORT

For any questions, concerns, or further assistance regarding your ZOCCONE Heavy Duty Tension Curtain Rod, please contact ZOCCONE customer support. Refer to the product packaging or the retailer's website for contact information.