

## FAME SUPERDUCHA+110V

# FAME SUPERDUCHA+ Electric Shower 110V - 4 Temperatures - 4400W User Manual

Brand: FAME | Model: SUPERDUCHA+110V

## 1. INTRODUCTION

The FAME SUPERDUCHA+ Electric Shower provides instant hot water with four distinct temperature levels: cold, warm, hot, and super hot. This automatic heater activates upon water flow and allows temperature adjustment by controlling the water tap. It is designed for efficiency and adjusts temperature based on water pressure.

FAME is a pioneering company in the development of this technology, ensuring 100% product testing to guarantee quality and reliability.

## 2. IMPORTANT SAFETY INFORMATION

**Always read these instructions carefully before installation and use. Failure to follow safety guidelines can result in electric shock, fire, or other serious injury.**

- Before performing any work, ensure the electricity supply is **turned off** at the main circuit breaker.
- Verify that the circuit voltage matches the appliance's voltage (110V).
- Ensure that the electrical cables and circuit breaker are rated according to the product specifications.
- An exclusive and independent electrical circuit is required for this shower.
- Requires installing a **40 Amp circuit breaker** and **10 AWG wiring**.
- Do not use extension cords or adapters. The FAME heater must be connected directly to the electrical distribution protection box.
- The water resistivity at 15°C must not be less than 1300Ω.cm.
- The product has an IP24 protection level.
- The grounding system must always be installed by a qualified professional.
- The FAME electric shower heater is completely insulated and designed with surge protection, meeting international safety standards.
- The body of the FAME heater is made of high-quality polypropylene, which is heat-resistant and durable.

### 3. PACKAGE CONTENTS

Your FAME SUPERDUCHA+ package includes the following items:

- Shower Head (with flow reducer)
- Hose with Hand Head
- Hose Support
- Installation Tube (reinforced thermoplastic, 30 cm long)
- Wire Connector
- Cable Cover
- One (1) Free Spare Resistance



Figure 1: All components included in the FAME SUPERDUCHA+ Electric Shower package.

### 4. TECHNICAL SPECIFICATIONS

Feature	Specification
---------	---------------

Product Type	Instant Electric Heater
Model	SUPERDUCHA+110V
Brand	FAME
Voltage	110V (AC)
Rated Power	4400W
Rated Frequency	50/60Hz
Number of Temperature Settings	4 (Cold, Warm, Hot, Super Hot)
Material	High-quality Polypropylene
Conductive Parts	Copper, copper and silver alloys
Installation Type	Wall Mounted
Product Dimensions	18.7"L x 6"W (approximately)
Item Weight	1.41 pounds (approximately)

## 5. SETUP AND INSTALLATION

Proper installation is crucial for the safe and efficient operation of your FAME SUPERDUCHA+. If you are unsure about any step, consult a qualified professional.

### 5.1. Materials Needed for Installation

Before you begin, ensure you have the following tools and materials:

- Connector (included)
- Teflon Tape
- Screwdriver (Phillips or flathead)

### 5.2. Hydraulic Installation

1. **Prepare the Water Outlet:** Clean the water outlet pipe to eliminate any residues. Open the water tap and let the water flow for a few seconds to flush out any remaining debris.
2. **Check Pipe Diameter:** The hydraulic connection diameter should be 1/2 inch. If not, use an appropriate adapter.
3. **Determine Installation Height:** The FAME SUPERDUCHA+ should preferably be installed at a height of 2.10 meters (approximately 82.7 inches) from the floor to the water pipe outlet. This ensures the water does not cool down during flow.
4. **Water Pressure Requirements:**
  - Minimum pressure to allow SUPERDUCHA+ working: 13 kPa / 1.8 psi (1.3 meters of water column height).
  - Maximum pressure to allow SUPERDUCHA+ working: 400 kPa (40 meters of water column height).
  - Minimum pressure to activate the appliance: 8 kPa / 1 psi (0.8 meters of water column height).
5. **Pressure Reducer Usage:**
  - If the water pressure is **lower than 5 meters** of water column height (50 kPa), **remove the pressure**

**reducer.**

- If the water pressure is **higher than 5 meters** of water column height (50 kPa), **keep the pressure reducer installed.**

6. **Apply Teflon Tape:** Apply Teflon tape to the water inlet nipple of the shower.
7. **Connect to Wall Pipe:** Twist the shower's pipe with your hands until the flange is flush with the wall. Do not use tools for this step to avoid overtightening.
8. **Fill Heating Chamber:** Before connecting electrically, open the water tap and let the water run for a few seconds to fill the heating chamber completely. This prevents burning the heating element and helps identify any leaks.

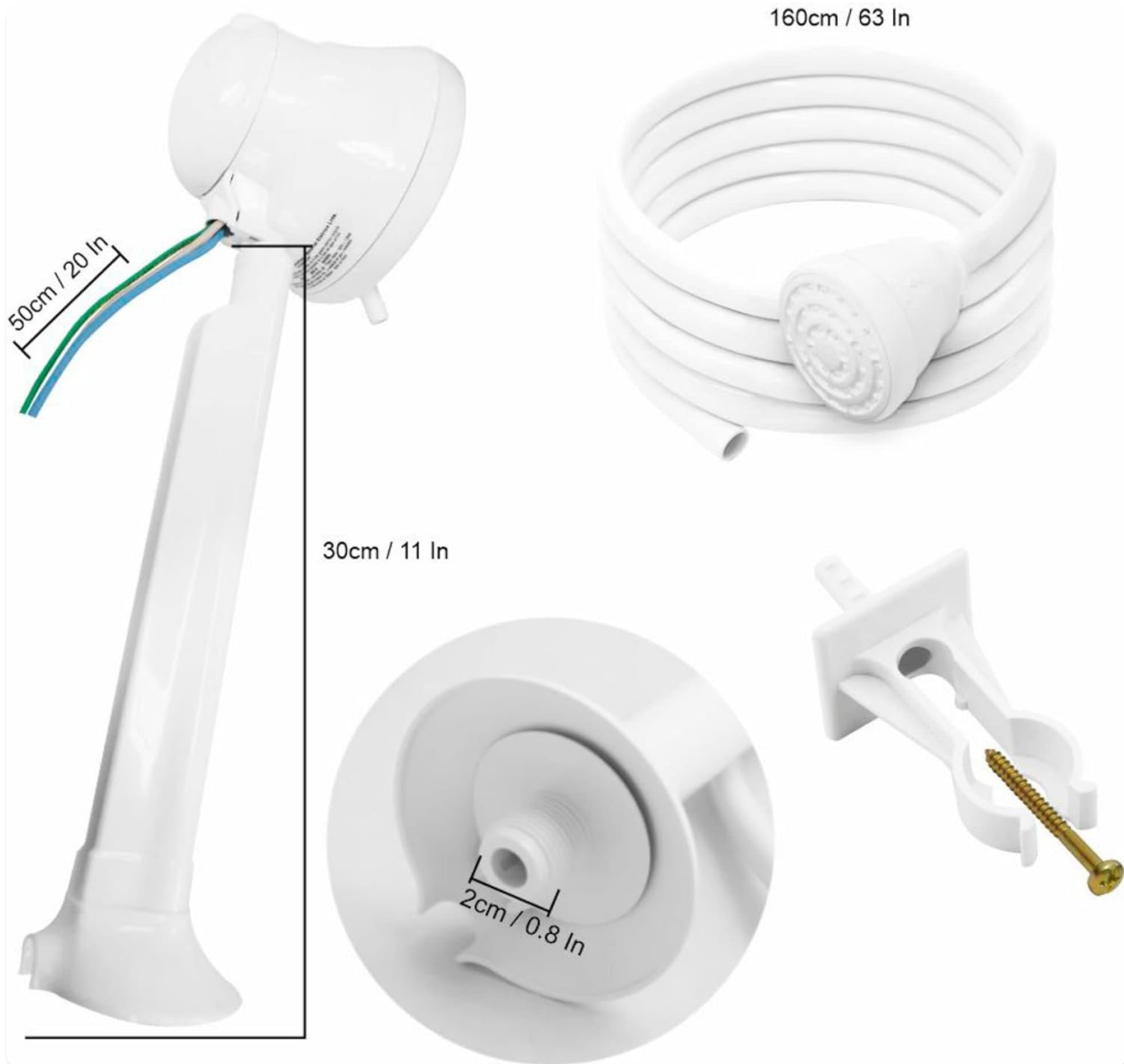

Figure 2: Hydraulic installation dimensions and components.



Figure 3: FAME SUPERDUCHA+ Electric Shower head.



Figure 4: FAME SUPERDUCHA+ Electric Shower in operation.



Figure 5: Spray plate of the FAME SUPERDUCHA+ Electric Shower.

### 5.3. Electrical Installation

1. **Turn Off Power:** Ensure the main circuit breaker for the shower's circuit is in the OFF position.
2. **Route Wires:** Route the electrical conductors through the shower's base plate.
3. **Connect Wires:** Use the provided connector to securely connect the shower's electrical wires to the household wiring. Ensure a firm connection.
4. **Ground Wire Connection:** Always connect the ground wire. This must be done by a qualified professional to ensure safety.
5. **Secure and Cover:** Place the connected wires inside the electrical box, then cover and screw the shower base plate securely to the wall.

Your browser does not support the video tag.

Video 1: Detailed installation guide for the FAME Electric Shower, covering both hydraulic and electrical connections. This video demonstrates the step-by-step process for safe and correct setup.

## 6. OPERATING INSTRUCTIONS



The FAME SUPERDUCHA+ is designed for ease of use with automatic operation and adjustable temperature settings.

1. **Turn On Water:** Open the water tap. The shower will automatically activate as water begins to flow.
2. **Select Temperature:** Use the temperature selector switch on the shower head to choose your desired temperature level: Cold (0), Warm (1), Hot (2), or Super Hot (3/4).
3. **Adjust Temperature:** Fine-tune the water temperature by slightly opening or closing the water tap. More water flow generally results in cooler water, while less flow results in hotter water, depending on the selected setting.
4. **Automatic Heating:** The shower automatically heats and adjusts the temperature according to the water pressure and selected setting.



Figure 6: FAME SUPERDUCHA+ Electric Shower in use.

## 7. MAINTENANCE

Regular maintenance ensures the longevity and optimal performance of your electric shower.

- **Temperature Selector:** When changing the temperature selector, always close the water tap first.



- **External Cleaning:** Clean the appliance externally using a moist cloth. Avoid abrasive products, as they can damage the finish.
- **Spray Plate Cleaning:** If the spray plate (the part where water exits) is removable or integral, it must be periodically removed and cleaned by brushing to prevent mineral buildup and maintain consistent water flow.

## 8. TROUBLESHOOTING

---

This section provides solutions to common issues you might encounter with your FAME SUPERDUCHA+ Electric Shower. For problems not listed here, or if solutions do not resolve the issue, please contact customer support.

### Common Issues and Solutions:

- **No Hot Water:**
  - Check if the circuit breaker is ON.
  - Ensure the temperature selector is not set to 'Cold' (0).
  - Verify that the water pressure is sufficient to activate the heating element.
  - Inspect the heating element for damage (if comfortable and qualified to do so, with power OFF).
- **Water Not Hot Enough:**
  - Increase the temperature setting on the selector.
  - Slightly reduce water flow from the tap.
  - Check if the pressure reducer is installed correctly for your water pressure conditions (refer to Section 5.2).
- **Water Leaks:**
  - Ensure all hydraulic connections are tight and properly sealed with Teflon tape.
  - Check for cracks or damage to the shower body or pipes.
- **Low Water Flow:**
  - Clean the spray plate for any blockages (refer to Section 7).
  - Check for obstructions in the water supply line.
- **Electrical Tripping:**
  - This indicates an electrical fault or overload. Immediately turn off the circuit breaker.
  - Verify that the wiring and circuit breaker specifications match the product requirements (40 Amp breaker, 10 AWG wiring).
  - Consult a qualified electrician to diagnose and fix the issue.

## 9. WARRANTY AND SUPPORT

---





Your FAME SUPERDUCHA+ Electric Shower comes with a **1-year warranty** from the date of purchase, covering manufacturing defects. Please retain your proof of purchase for warranty claims.

A free spare resistance is included with your purchase, which can be used for replacement if the original heating element wears out.

For further assistance, technical support, or warranty claims, please refer to the contact information provided in the product packaging or visit the official FAME website.

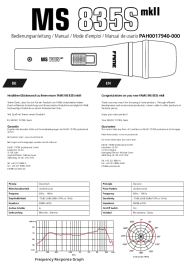
*We strongly recommend reading the complete instruction guide inside the package for comprehensive information on installation, operation, and proper functioning of the product.*

Related Documents - SUPERDUCHA+110V

	<p><a href="#">FAME MS 835S mkII Microphone User Manual</a></p> <p>User manual for the FAME MS 835S mkII microphone, detailing its specifications, frequency response, and polar pattern. Provided by MUSIC STORE professional GmbH.</p>
	<p><a href="#">FAME DD6600 Digital Drum Set User Manual</a></p> <p>Comprehensive user manual for the FAME DD6600 Digital Drum Set, covering features, operation, setup, safety guidelines, and troubleshooting.</p>
	<p><a href="#">FAME G-3000 User Manual: Setup, Features, and Operation</a></p> <p>Comprehensive user manual for the FAME G-3000 home keyboard, covering setup, connections, playing features, safety instructions, and specifications. Learn to use your digital keyboard effectively.</p>
	<p><a href="#">FAME Grand 3100 Digital Piano User Manual   Setup, Features, and Operation</a></p> <p>Comprehensive user manual for the FAME Grand 3100 Digital Piano. Includes setup guides, feature explanations, operation instructions, troubleshooting, and specifications from Music Store professional GmbH.</p>
	<p><a href="#">FAME Digital Drum DD6600 Operating Instructions</a></p> <p>Operating instructions for the FAME Digital Drum DD6600, covering setup, features, playing techniques, recording, coaching modes, and troubleshooting.</p>
	<p><a href="#">Fame Twin Looper User Manual and Specifications</a></p> <p>This document provides comprehensive instructions, safety guidelines, and technical specifications for the Fame Twin Looper, a guitar effects pedal designed for sound manipulation.</p>

