

manuals.plus /

› [AOOCOO](#) /

› [AOOCOO USB 3.0 KVM Switch Dual Monitor HDMI 4K@60Hz, 2K@144Hz User Manual](#)

AOOCOO B0BMP9G6HB

AOOCOO USB 3.0 KVM Switch Dual Monitor HDMI User Manual

Model: B0BMP9G6HB

1. INTRODUCTION

The AOOCOO USB 3.0 KVM Switch is designed to allow two computers to share one set of keyboard and mouse, along with two monitors. It supports extended or copy display modes, offering a versatile solution for managing multiple systems from a single workstation. This manual provides detailed instructions for setup, operation, and troubleshooting to ensure optimal performance.

2. PACKAGE CONTENTS

- 1 x Dual Monitor USB 3.0 HDMI KVM Switch
- 2 x HDMI 2.0 Cables (1.5m)
- 2 x USB 3.0 Cables (1.5m)
- 1 x Wired Controller
- 1 x User Manual



Figure 2.1: Included items in the product package.

3. PRODUCT OVERVIEW

The KVM switch features multiple ports for connecting your computers and peripherals. The front panel includes USB 3.0 ports for shared devices, while the rear panel houses HDMI inputs and outputs, along with USB 3.0 inputs for connecting to each computer.



Figure 3.1: Front and rear views of the KVM switch.

3.1. Front Panel

- **USB 3.0 Ports (4x):** For connecting shared peripherals like keyboard, mouse, U-disk, or printer. These ports offer data transfer speeds up to 5Gbps.
- **DC/5V Port:** Optional power input for high-power devices.
- **SELECT Button:** For manually switching between connected computers.
- **Wired Controller Port:** For connecting the included wired remote for switching.



Figure 3.2: Front panel with peripheral connections.

3.2. Rear Panel

- **INPUT A1/B1 (PC1):** HDMI inputs for Computer 1 (for dual monitor setup).
- **INPUT A2/B2 (PC2):** HDMI inputs for Computer 2 (for dual monitor setup).
- **USB 3.0 (2x):** USB inputs for connecting to each computer (for keyboard/mouse and shared USB devices).
- **OUT A/B (Monitor):** HDMI outputs for connecting to your two monitors.

4. SETUP INSTRUCTIONS

Follow these steps to connect your AOOCOO KVM Switch:

1. **Power Off Devices:** Ensure all computers and monitors are powered off before making connections.
2. **Connect Monitors to KVM:** Connect your two monitors to the KVM switch's **OUT A** and **OUT B** HDMI ports using HDMI 2.0 cables.
3. **Connect Computers to KVM (Video):** For each computer, connect its two HDMI output ports to the corresponding HDMI input ports on the KVM switch (e.g., PC1's HDMI outputs to **INPUT A1** and **INPUT B1**; PC2's HDMI outputs to **INPUT A2** and **INPUT B2**).
Important: Each computer must have two HDMI output ports and support extended display for dual monitor functionality. The switch is not compatible with DP/DVI/VGA to HDMI converters. If your computer only supports a single display, this product cannot provide dual display functionality.
4. **Connect Computers to KVM (USB):** Connect the USB 3.0 cables from each computer's USB port to the corresponding USB 3.0 input ports on the KVM switch (e.g., PC1's USB to **USB3.0 (PC1)**; PC2's USB to **USB3.0 (PC2)**).
5. **Connect Peripherals:** Plug your keyboard, mouse, and other USB devices into the USB 3.0 ports on the front panel of the KVM switch.
6. **Optional Power:** If connecting high-power USB devices (e.g., docking stations), connect a DC 5V power supply (not included) to the DC/5V port on the KVM switch.
7. **Power On:** Power on your computers and monitors.
8. **Configure Display Settings:** After connecting, you may need to set the screen output mode on your computer. For Windows, press **Windows + P** and select your desired display mode (e.g., Extend or Duplicate) in the pop-up window.

Support: PC1 output to monitor A and B, or PC2 output to monitor A and B.

Not Support Cross Output: PC1 output to monitor A, PC2 output to monitor B, PC1 output to monitor B, PC2 output to monitor A

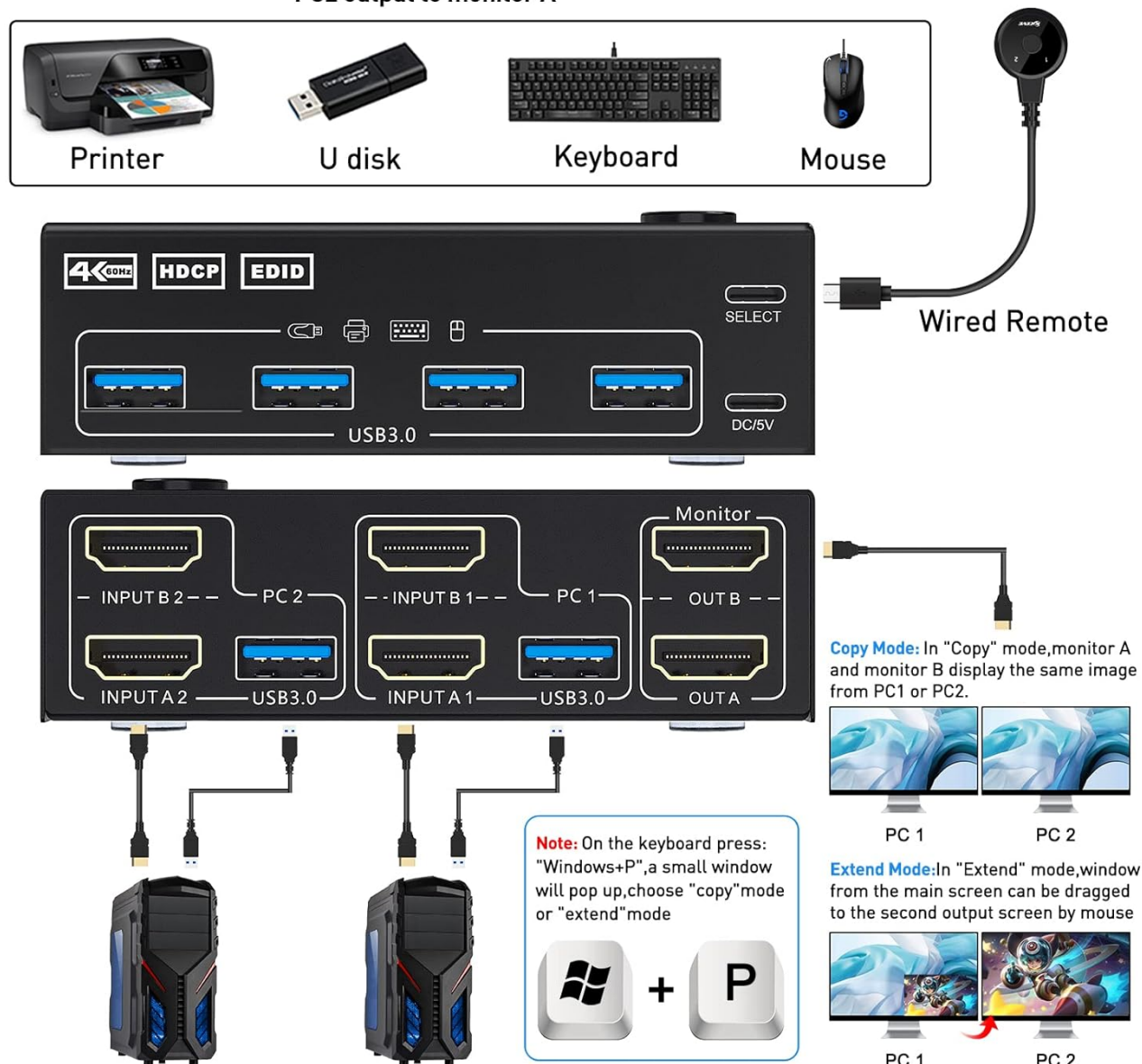

Figure 4.1: Connection diagram for the KVM switch.

5. OPERATING INSTRUCTIONS

5.1. Switching Between Computers

The KVM switch offers two methods for switching between connected computers:

- **Front Panel Button:** Press the "SELECT" button on the front panel of the KVM switch to switch to the next active computer.
- **Wired Controller:** Use the included wired controller to switch between computers. This is convenient if the KVM switch unit is not easily accessible.



Figure 5.1: Two switching methods.

5.2. LED Indicators

The two-color LED indicator on the KVM switch will illuminate to show which computer is currently active.

6. DISPLAY MODES

The KVM switch supports two primary display modes for your dual monitor setup:

- **Extended Display Mode:** Outputs two different screens, allowing you to extend your desktop across both monitors.
- **Copy Display Mode (Mirror Mode):** Outputs two identical screens, duplicating the content on both monitors.



Figure 6.1: Extended vs. Copy Display Modes.

7. USB 3.0 PORTS

The KVM switch is equipped with four USB 3.0 ports, enabling two computers to share various USB 3.0 devices. USB 3.0 offers a faster data transfer speed of up to 5Gbps, which is significantly faster than USB 2.0's 480Mbps. It is also backward compatible with USB 2.0/1.1 devices.

2 PCs Share 4 USB3.0 Devices

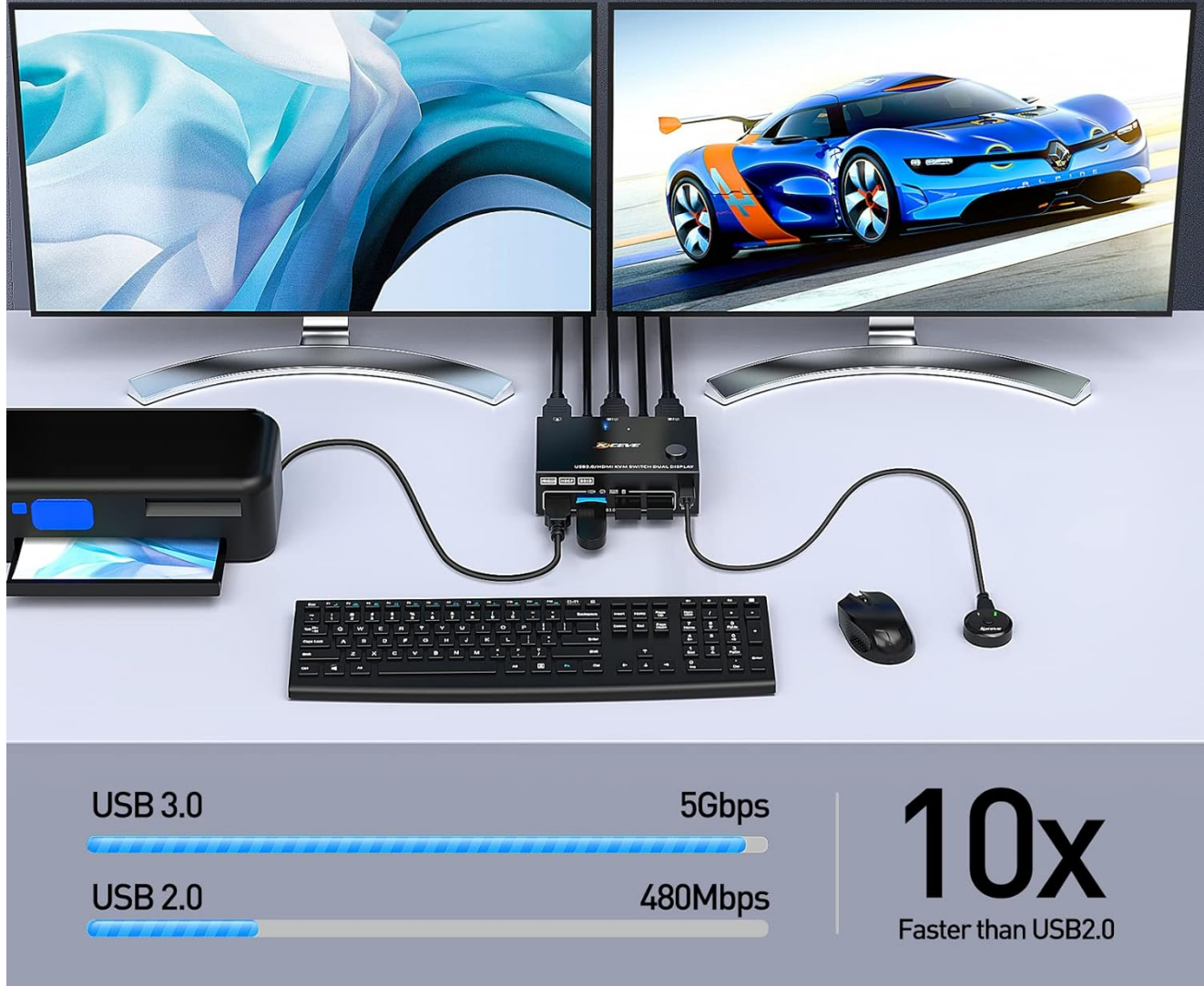

Figure 7.1: Shared USB 3.0 devices.

8. EDID SIMULATION

This KVM switch features EDID (Extended Display Identification Data) emulation. It stores the resolution and refresh rate of your display, ensuring that connected PCs always have correct display information. This prevents issues like scrambled desktop icons or resolution changes when switching between computers, as the system believes the monitor is always connected.

Simulate the EDID of the display the original window order will not be changed

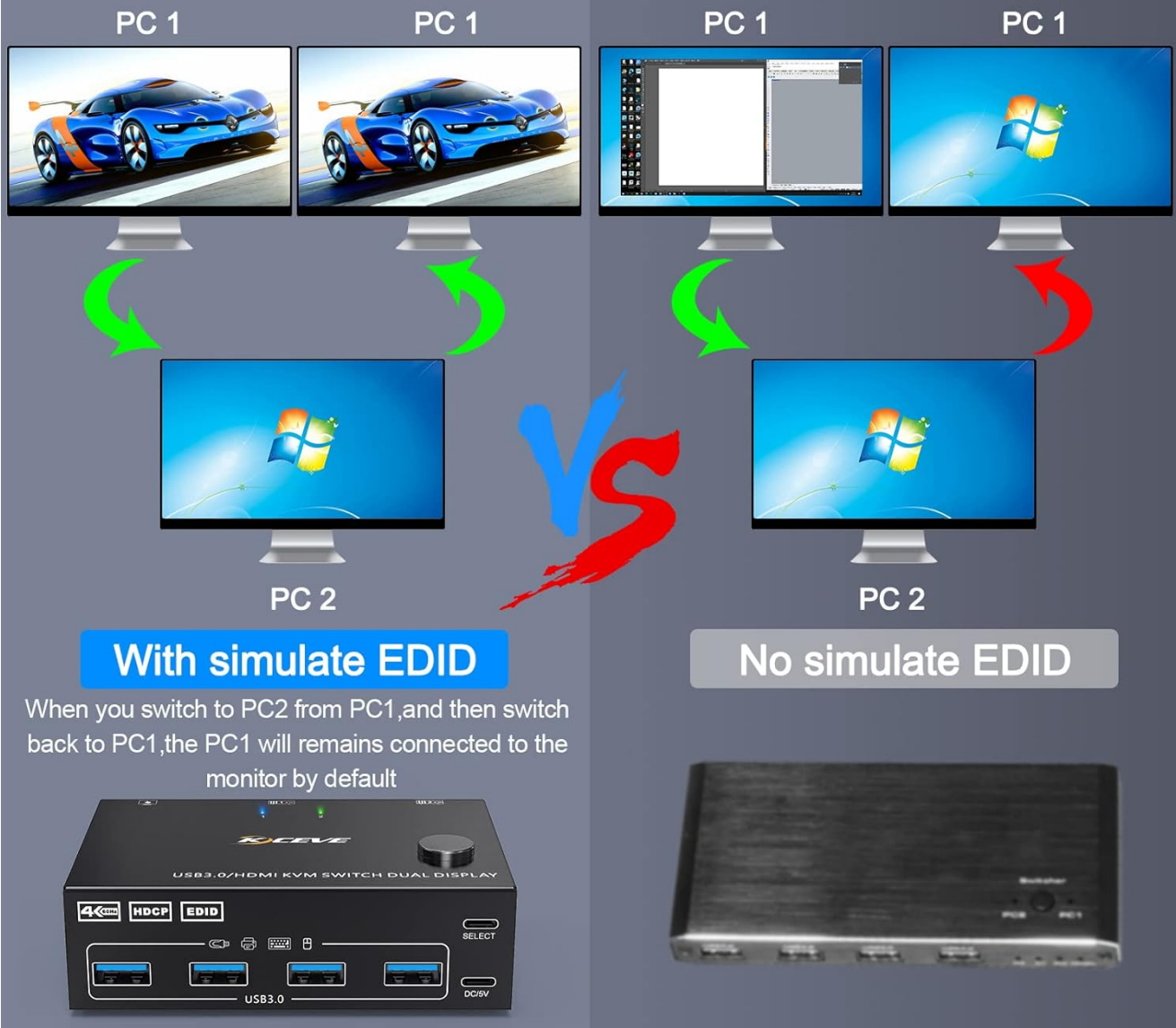

Figure 8.1: EDID Simulation in action.

9. COMPATIBILITY

The AOOCOO KVM Switch is driver-free and plug-and-play. It is compatible with a wide range of operating systems, including Windows 10/8/8.1/7/Vista/XP, Mac OS, and Linux.

Package List

Dual Monitor USB 3.0 HDMI KVM Switch*1



2 PORTS
KVM SWITCH DUAL DISPLAY

USER MANUAL

Model: KVM202A

User Manual*1

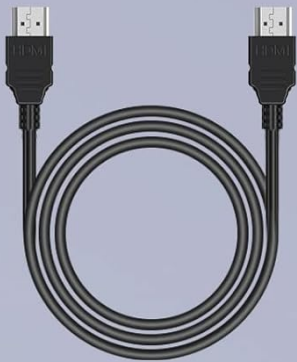

HDMI2.0 Cable(1.5m)*2



Wired Controller*1



USB3.0 Cable(1.5m)*2

Figure 9.1: Operating system compatibility.

10. IMPORTANT NOTES & CONSIDERATIONS

- The KVM switch requires each connected computer to have **two HDMI output ports** and support extended display.
- It supports USB-C to HDMI converters but is **not compatible** with DP/DVI/VGA to HDMI converters.
- If your computer only supports a single display, this product cannot help you achieve dual display functionality.
- For 4K resolution, ensure you use HDMI 2.0 cables and that both your computers and monitors support 4K.
- The switcher typically does not require extra power for normal operation as USB ports can provide power. However, if a high-power docking station or other high-power USB devices are connected, additional power via the DC 5V port may be necessary.

11. TROUBLESHOOTING

- **No Display/Incorrect Resolution:**
 - Verify that each computer has two HDMI output ports and is configured for extended display.
 - Ensure all HDMI cables are HDMI 2.0 compliant, especially for 4K resolution.
 - Check that all connections are secure and correctly plugged into the designated input/output ports on the KVM switch.

- Try restarting the computers and monitors.
 - Confirm your monitors and computers support the desired resolution (e.g., 4K@60Hz).
- **Keyboard/Mouse Not Responding:**
 - Ensure the USB 3.0 cables from each computer are securely connected to the KVM switch.
 - Try connecting the keyboard and mouse directly to the computer to confirm they are functioning.
 - If using wireless peripherals, ensure their receivers are plugged into the KVM's USB 3.0 ports.
 - **Display Issues After Switching:**
 - The EDID simulation feature should prevent most display issues. If problems persist, ensure your computer's display settings are correctly configured for extended or duplicate mode.
 - Try pressing **Windows + P** on the keyboard and re-selecting the output mode.
 - **No Power/Intermittent Power:**
 - If using high-power USB devices, ensure an external DC 5V power supply is connected to the KVM switch.
 - Check all power connections.

12. SPECIFICATIONS

Feature	Specification
Model	B0BMP9G6HB
Brand	AOOCOO
Connector Type	HDMI, USB
Resolution Support	Up to 4K@60Hz, 2K@120Hz
USB Ports	4 x USB 3.0 (5Gbps)
Switching Modes	Button on panel, Wired Controller
EDID Simulation	Yes
Operating Voltage	5 Volts (DC/5V optional power input)
Compatibility	Windows 10/8/8.1/7/Vista/XP, Mac OS, Linux
Dimensions	8.03 x 6.06 x 2.32 inches
Weight	1.41 Pounds

13. WARRANTY AND SUPPORT

For warranty information or technical support, please refer to the contact details provided on the product packaging or visit the official AOOCOO website. Keep your purchase receipt for warranty claims.