

Manuals.plus /

› LAOPAO /

› LAOPAO LED Desk Lamp with Wireless Charger User Manual

LAOPAO led

LAOPAO LED Desk Lamp with Wireless Charger

Model: led

Brand: LAOPAO

INTRODUCTION

Thank you for choosing the LAOPAO LED Desk Lamp with Wireless Charger. This multi-functional desk lamp is designed to provide optimal lighting for various activities while offering convenient charging solutions for your devices. It features adjustable color modes and brightness levels, a night light function, an auto-off timer, and an integrated LCD display for time, date, and temperature. Please read this manual thoroughly before use to ensure proper operation and to maximize the product's lifespan.

SAFETY INSTRUCTIONS

- Ensure the power adapter is compatible with your local power supply (100-240V).
- Do not disassemble, repair, or modify the lamp yourself. Contact qualified service personnel for assistance.
- Avoid placing the lamp in high-temperature, humid, or dusty environments.
- Keep the lamp away from water or other liquids to prevent electric shock.
- Do not use the lamp if the power cord or plug is damaged.
- Place the lamp on a stable, flat surface to prevent it from falling.
- Do not look directly into the LED light source for extended periods to avoid eye strain.

PACKAGE CONTENTS

Please check the box for the following items:

- LAOPAO LED Desk Lamp
- Power Supply Adapter
- User Manual
- Color Box (Packaging)

PRODUCT COMPONENTS

Familiarize yourself with the different parts and controls of your desk lamp.



Figure 1: Overview of the LAOPAO LED Desk Lamp, showing the main light, LCD display, and wireless charging pad.

Big Size Setting Button

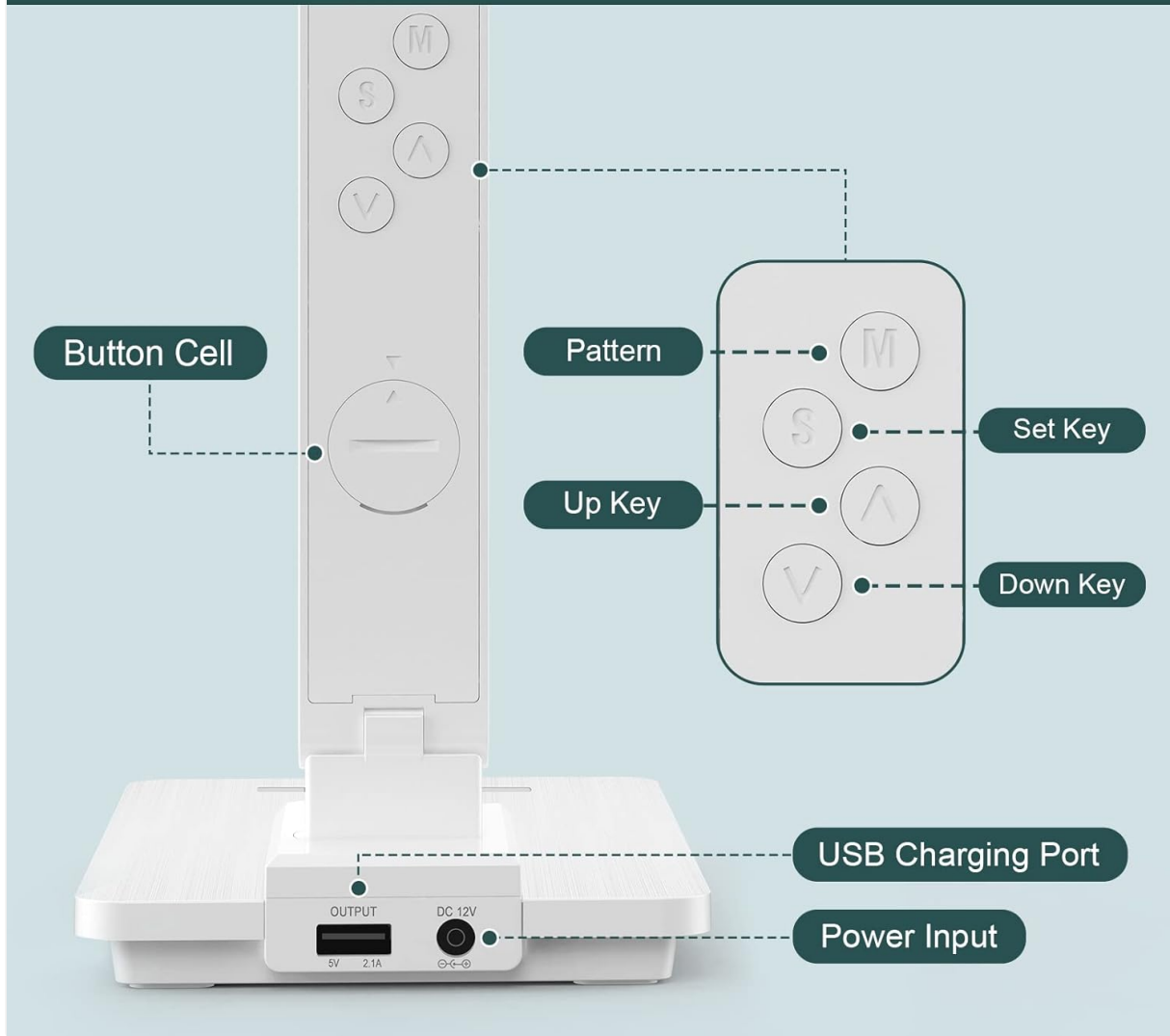

Figure 2: Detailed diagram of the lamp's control panel, including the Pattern (M), Set (S), Up, and Down keys, along with the Button Cell compartment, USB Charging Port, and Power Input.

- **LED Light Panel:** Main light source.
- **Lamp Arm:** Adjustable and foldable for various angles.
- **LCD Display:** Shows time, date, day of the week, and temperature.
- **Control Buttons:** M (Pattern), S (Set), Up (▲), Down (▼) for various settings.
- **Touch Control Panel:** For power, brightness, and color mode adjustments.
- **Wireless Charging Pad:** For compatible devices.
- **USB Charging Port:** For wired device charging.
- **Power Input:** Connects to the power adapter.
- **Button Cell Compartment:** For the clock's backup battery.

SETUP

1. **Unpack:** Carefully remove all components from the packaging.
2. **Position:** Place the lamp base on a stable, flat surface.
3. **Adjust Arm:** Gently unfold the lamp arm to your desired position. The arm can rotate 180 degrees and the

base axis 90 degrees for optimal lighting angles.

4. **Connect Power:** Insert the power adapter into the DC 12V power input port on the back of the lamp base. Plug the adapter into a standard wall outlet.
5. **Initial Power On:** The lamp will power on, and the LCD display will activate.

OPERATING INSTRUCTIONS

1. Power and Light Control

- **Power On/Off:** Touch the power symbol on the base to turn the lamp on or off.
- **Color Modes:** Touch the 'M' (Mode) button on the base to cycle through 5 different color temperature modes (e.g., warm white to cool white, 3000K to 6000K).
- **Brightness Adjustment:** Slide your finger along the brightness control area on the base to adjust the light intensity through 5 brightness levels (0% to 100%).



Figure 3: Illustration of the 5 color modes (3000K to 6000K) and 5 brightness levels, demonstrating the touch-sensitive slide control for adjustment.

2. Charging Functions

- **Wireless Charging:** Place your Qi-compatible device (e.g., smartphone) on the wireless charging pad

located on the lamp base. Ensure the device is centered for optimal charging. The lamp provides 10W wireless charging.

- **USB Charging:** Connect your device's USB charging cable to the USB output port (5V/2.1A) on the back of the lamp base.



Figure 4: The lamp's base showing a smartphone wirelessly charging on the pad and another device charging via the USB port, highlighting the 10W wireless and 5V/2.1A USB charging capabilities.

3. Time and Date Settings

Use the 'S' (Set), Up (▲), and Down (▼) buttons on the side of the lamp to adjust the LCD display.

1. Press 'S' once to enter time setting mode. The hour digit will flash. Use Up/Down to adjust.
2. Press 'S' again to move to minute setting. Use Up/Down to adjust.
3. Continue pressing 'S' to cycle through year, month, and day settings, adjusting each with Up/Down.
4. Press 'S' one last time to confirm and exit setting mode.

4. Alarm Function

1. Press 'M' (Pattern) on the side to cycle through display modes until the alarm icon appears.
2. Press 'S' to enter alarm setting mode. The alarm hour will flash. Use Up/Down to adjust.
3. Press 'S' again to set alarm minutes. Use Up/Down to adjust.

4. Press 'S' to enable/disable the alarm. An alarm icon will appear on the display when enabled.
5. To snooze, press any button when the alarm sounds. The alarm will sound again after 5 minutes.
6. To turn off the alarm completely, press 'S' during the snooze period or when the alarm is sounding.

5. Night Light and Timer

- **Night Light:** Touch the night light symbol on the base to activate the soft night light. There are 2 night light options to choose from.
- **Auto-Off Timer:** This lamp includes a 45-minute automatic switch-off function. To activate, touch the timer symbol on the base. The lamp will automatically turn off after 45 minutes.



Figure 5: The desk lamp operating with its soft night light function, ideal for bedside use.

6. LCD Display Management

- **Turn Off Blue Light:** To turn off the blue backlight of the LCD display, long press the 'M' (Pattern) button on the base for 3 seconds. Repeat to turn it back on.

Long press 3 seconds
to turn off the LCD display
blue light

M

3 seconds



Figure 6: Demonstrates how to turn off the blue backlight of the LCD display by long-pressing the 'M' button for 3 seconds.

CARE AND MAINTENANCE

- **Cleaning:** Disconnect the power before cleaning. Use a soft, dry cloth to wipe the lamp. Do not use abrasive cleaners or solvents.
- **Storage:** If not in use for an extended period, unplug the lamp and store it in a cool, dry place.
- **Button Cell:** The clock function uses a button cell battery for backup. If the time display becomes inaccurate after power disconnection, the battery may need replacement. Refer to Figure 2 for the button cell compartment location.

TROUBLESHOOTING

Problem	Possible Cause	Solution
Lamp does not turn on.	No power connection.	Ensure the power adapter is securely plugged into the lamp and the wall outlet.
Wireless charging not working.	Device not Qi-compatible or not properly aligned.	Check if your device supports Qi wireless charging. Re-position the device on the charging pad to ensure proper alignment. Remove thick phone cases.
USB charging not working.	Cable issue or device not connected properly.	Try a different USB cable. Ensure the cable is fully inserted into both the lamp's USB port and your device.
LCD display is blank or incorrect.	Power interruption or button cell battery depleted.	Check power connection. If time/date is incorrect after power loss, replace the button cell battery and reset the time/date.
Light flickers or is unstable.	Loose connection or power supply issue.	Ensure all connections are secure. Try plugging the lamp into a different power outlet.

SPECIFICATIONS

Feature	Detail
Brand	LAOPAO
Model Name	desk lamp
Item Model Number	led
Light Source Type	LED
Wattage	10 watts
Brightness	680 Lumen
Color Modes	5 (adjustable from 3000K to 6000K)
Brightness Levels	5
Wireless Charging Output	10W
USB Charging Output	5V/2.1A
Special Features	Dimmable, Wireless Charging, Auto-Off Timer, Night Light, LCD Display (Time, Date, Temp, Alarm)
Product Dimensions	7.48"D x 4.53"W x 14"H
Item Weight	0.95 Kilograms (2.1 pounds)
Material	Plastic, Acrylonitrile Butadiene Styrene
Power Source	Corded Electric (12V Adapter)

WARRANTY AND SUPPORT

This LAOPAO product is covered by a standard manufacturer's warranty against defects in materials and workmanship. For specific warranty details, please refer to the documentation included with your purchase or contact LAOPAO customer support.

If you encounter any issues or have questions regarding your LED Desk Lamp, please contact our customer support team. Provide your product model number (led) and a detailed description of the issue for prompt assistance.

For further assistance, please visit the LAOPAO Store on Amazon.