



Manuals.plus /

› LG /

› LG 7 Kg, 5 Star, Direct Drive Technology, Steam Wash, 6 Motion DD, Smart Diagnosis, Fully-Automatic Front Load Washing Machine (FHM1207SDM) User Manual

LG FHM1207SDM

LG 7 Kg Fully-Automatic Front Load Washing Machine User Manual

Model: FHM1207SDM

1. INTRODUCTION

This manual provides essential information for the safe and efficient operation, installation, and maintenance of your LG 7 Kg Fully-Automatic Front Load Washing Machine, model FHM1207SDM. Please read this manual thoroughly before using the appliance and retain it for future reference.



Figure 1.1: Front view of the LG 7 Kg Fully-Automatic Front Load Washing Machine (FHM1207SDM).

2. SAFETY INFORMATION

Always follow basic safety precautions to reduce the risk of fire, electric shock, or injury to persons when using this

appliance.

- Read all instructions before using the appliance.
- Do not wash articles that have been previously cleaned in, washed in, soaked in, or spotted with gasoline, dry-cleaning solvents, or other flammable or explosive substances, as they emit vapors that could ignite or explode.
- Do not allow children to play on or in the appliance. Close supervision of children is necessary when the appliance is used near children.
- Do not reach into the appliance if the tub or agitator is moving.
- Do not install or store this appliance where it will be exposed to the weather or freezing temperatures.
- Do not repair or replace any part of the appliance or attempt any servicing unless specifically recommended in this manual or in published user-repair instructions that you understand and have the skills to carry out.
- Ensure the appliance is properly grounded.
- Unplug the appliance from the power supply before attempting any service or cleaning.

3. PRODUCT FEATURES

The LG FHM1207SDM washing machine incorporates advanced features for efficient and effective laundry care.

- **Direct Drive Technology:** The Inverter Direct Drive motor connects directly to the drum, reducing noise and vibration while enhancing durability and wash performance.
- **6 Motion DD:** This technology utilizes six distinct wash motions (Stepping, Tumble, Filtration, Scrubbing, Rolling, Swing) to optimize washing for various fabric types, ensuring thorough cleaning and reduced fabric damage.
- **Hygiene Steam:** The built-in steam function helps remove allergens and stubborn stains by penetrating fabrics with steam.
- **Smart Diagnosis:** A convenient feature that allows for quick troubleshooting of minor issues via a smartphone application, minimizing service calls.
- **Stainless Steel Drum:** Designed for longevity and hygiene, the stainless steel drum and lifters help maintain a clean washing environment.
- **In-built Heater:** Provides hot water wash options for enhanced cleaning and sanitization.
- **Sensors:** Equipped with a Water Level Sensor, Load Imbalance Sensor, and Laundry Load Sensor for optimized wash cycles.

No Belt, No Pulley

Less Vibration, Less Noise
Better Wash Performance



*Creative Visualization.
*Product Image Shown is for representation purpose only,
Actual Product may vary.

Figure 3.1: Inverter Direct Drive motor technology ensures quiet and powerful operation.



Figure 3.2: Illustration of the 6 Motion DD technology, detailing Stepping, Tumble, Filtration, Scrubbing, Rolling, and Swing motions.



Figure 3.3: Steam technology effectively removes allergens from fabrics.

Long-Lasting Durability

Stainless Steel Drum



**WATER LEVEL
SENSOR**



**LOAD
IMBALANCE
SENSOR**



**LAUNDRY LOAD
SENSOR**



4. SETUP AND INSTALLATION

Proper installation is crucial for the performance and longevity of your washing machine. It is recommended to have the appliance installed by a qualified technician.

4.1 Unpacking

- Carefully remove all packaging materials, including the base packaging and any protective films.
- Remove all transit bolts from the rear of the machine. Keep them for future transportation if needed.

4.2 Location Requirements

- Place the washing machine on a firm, level surface.
- Ensure adequate space around the machine for ventilation and maintenance.
- Avoid direct sunlight or exposure to freezing temperatures.

4.3 Water and Drain Connections

- Connect the cold supply hose to a cold water tap. Ensure connections are tight to prevent leaks.
- Position the drain hose correctly to allow for proper water drainage.
- The recommended water pressure suitability is 50 kPa ~ 800 kPa (0.5 ~ 8.0 kgf/cm²).

4.4 Electrical Connection

- Connect the power cord to a grounded electrical outlet.
- Ensure the voltage (230 Volts) and wattage (1700 Watts) match your household supply.

Included Component

Within / With Box

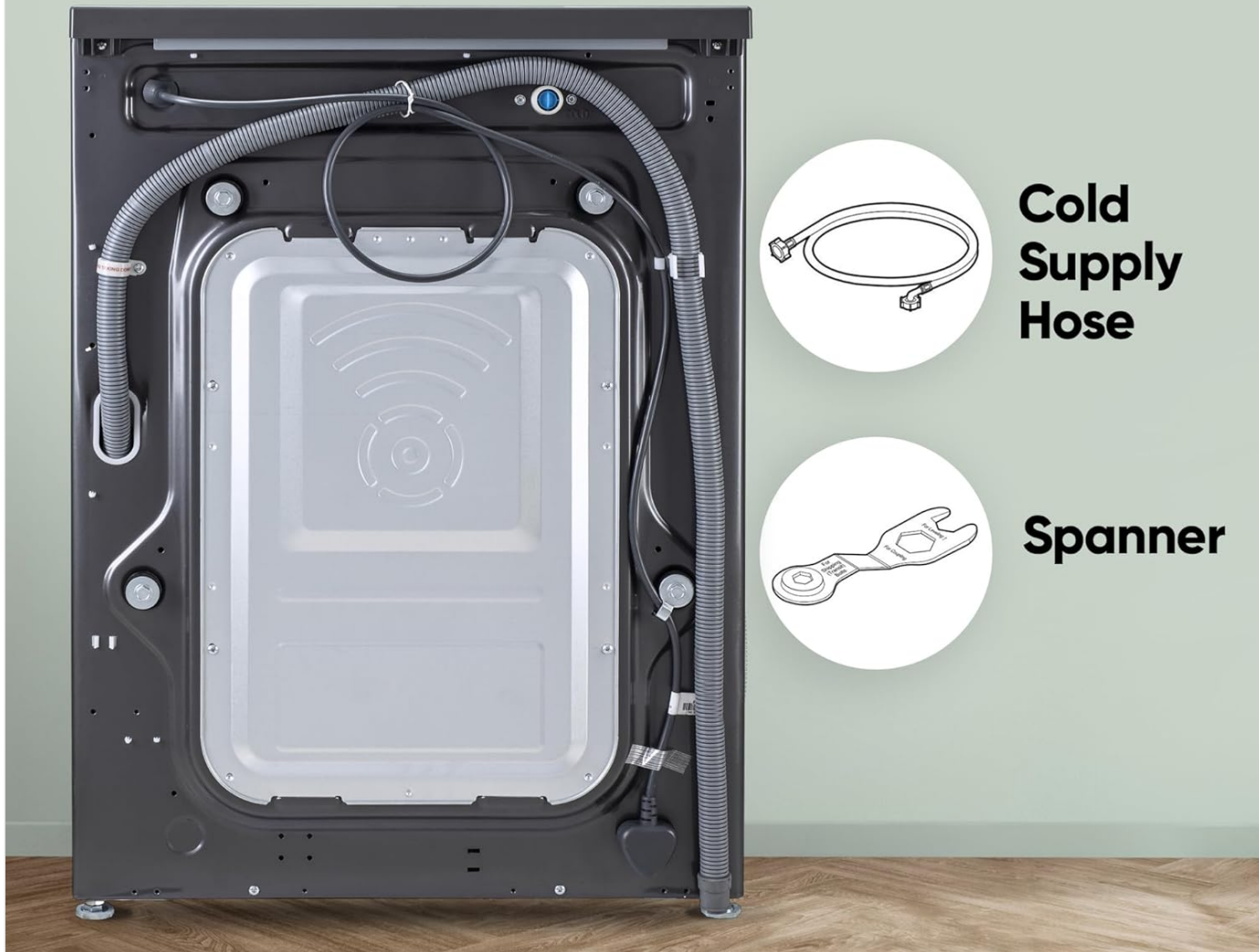

**Cold
Supply
Hose**

Spanner

Figure 4.1: Included components for installation: Cold Supply Hose and Spanner.

5. OPERATING INSTRUCTIONS

Familiarize yourself with the control panel and wash programs for optimal use.

Navigate with Ease

Enhanced Panel For Seamless Washing.



Figure 5.1: Control Panel Overview.

- 1. Power On/Off Button (1):** Press to turn the washing machine on or off.
- 2. Programme Knob (2):** Rotate to select one of the 10 available wash programs.
- 3. Start/Pause Button (3):** Press to start a wash cycle or pause an ongoing one.
- 4. Customizing Washing Programmes Button (4):** Use to adjust settings like temperature, spin speed, or add pre-wash.
- 5. Extra Options and Functions (5):** Select additional features such as Child Lock or Time Delay.
- 6. Display (6):** Shows remaining time, selected options, and error codes.

5.1 Wash Programs

The machine offers 10 wash programs:

- **Cotton:** For soiled cotton clothes.
- **Cotton Large:** Optimized for large amounts of cotton laundry.
- **Mix:** Cleans a variety of different fabrics simultaneously.

- **Easy Care:** For clothes that do not require ironing, such as polyamide, acrylic, and polyester fabrics.
- **Baby Care:** Washes at higher temperatures to eliminate bacteria.
- **Sports Wear:** Specific program for sportswear.
- **Delicate:** For large items like bed covers and pillows.
- **Wool:** Gentle wash for wool garments.
- **Quick 30:** A rapid wash cycle for lightly soiled items.
- **Rinse+Spin:** For rinsing and spinning only.

5.2 Loading Laundry

- Sort laundry by fabric type, color, and degree of soiling.
- Do not overload the machine; the capacity is 7 Kg.
- Close the door firmly before starting a cycle.

6. MAINTENANCE

Regular maintenance ensures the longevity and optimal performance of your washing machine.

6.1 Cleaning the Exterior

- Wipe the exterior with a soft, damp cloth. Do not use abrasive cleaners.

6.2 Cleaning the Drum

- Periodically run a drum clean cycle (if available) or a hot wash with no laundry and a washing machine cleaner.

6.3 Detergent Dispenser

- Clean the detergent dispenser drawer regularly to prevent residue buildup.

6.4 Drain Filter

- Check and clean the drain filter periodically to remove lint and small objects. Refer to the full user manual for specific instructions on accessing the drain filter.

7. TROUBLESHOOTING

Before contacting service, refer to the following common issues and their solutions. The Smart Diagnosis feature can also assist in identifying problems.

Smart Diagnosis™

Easy Deal, Smart Solution



Figure 7.1: Using Smart Diagnosis for quick troubleshooting.

Common Troubleshooting Guide

Problem	Possible Cause	Solution
Machine does not start	Power cord unplugged; Door not closed properly; Start/Pause button not pressed.	Check power connection; Ensure door is latched; Press Start/Pause.
No water supply	Water tap closed; Water inlet hose kinked; Water pressure too low.	Open water tap; Straighten hose; Check household water pressure.
Excessive vibration/noise	Transit bolts not removed; Machine not level; Uneven load.	Remove transit bolts; Adjust leveling feet; Redistribute laundry.
Water not draining	Drain hose kinked or blocked; Drain filter clogged.	Check and clear drain hose; Clean drain filter.
Error code on display	Specific issue detected by the machine.	Refer to the full user manual for specific error code meanings or use Smart Diagnosis.

8. SPECIFICATIONS

Detailed technical specifications for the LG FHM1207SDM washing machine.

Slim Profile, Big Performance

Fits your lifestyle, Fits your home.



1 2 3 4 5

**MORE STARS
MORE SAVINGS**

**POWER SAVINGS
GUIDE**

ENERGY CONSUMPTION
0.05*
kWh/kg/cycle

Label Period : 1st Jan 2024 - 31st Dec 2026

Appliance : Washing Machine
Brand : LG
Model/Year : FHM1207SDM/2023
Type : Front Load
Load Capacity : 7.0 kg
Water Consumption : 7.7 L/kg/cycle

BEEL02100119

*Under test conditions, when tested in accordance with latest IEC 60456 standards
Actual energy consumption will depend on how the appliance is being used.

*T&C Apply

Figure 8.1: Product dimensions and energy efficiency rating.

Specification	Value
Brand	LG
Model	FHM1207SDM
Capacity	7 Kilograms
Energy Efficiency	5 Star
Annual Energy Consumption	0.05 Kilowatt Hours
Maximum Rotational Speed	1200 RPM
Noise Level	54 dB
Installation Type	Freestanding
Colour	Middle Black
Control Console	Knob / Touch Panel
Number of Wash Programs	10
Access Location	Front Load
Voltage	230 Volts
Wattage	1700 Watts
Material	Stainless Steel (Drum)
Item Weight	60 kg
Product Dimensions (LxWxH)	60 x 44 x 85 Centimeters
Included Components	Drain Hose, Fill Hose

9. WARRANTY AND SUPPORT

Your LG washing machine is covered by a comprehensive warranty and dedicated customer support.

- **Manufacturer Warranty:** 2 Years Comprehensive on Product & 10 years on Motor (Terms and Conditions Apply).
- **Manufacturer Contact:** LG Electronics India Pvt. Ltd., Plot no. A-5, MIDC, Ranjangaon, Tal-Shirur Udyog Vihar, Pune (Maharashtra) PIN- 412220.
- **Email:** serviceindia@lge.com
- **Toll-Free Numbers:** 1800 315 9999 / 1800 180 9999
- **WhatsApp Support:** 9711709999
- For further assistance or to schedule a service, please contact LG customer support.