

## Miele Boost CX1

# Miele Boost CX1 Bagless Canister Vacuum Cleaner Instruction Manual

Model: Boost CX1

Brand: Miele

## INTRODUCTION

The Miele Boost CX1 Bagless Canister Vacuum Cleaner combines outstanding performance with compact dimensions. This manual provides essential information for safe and efficient use, assembly, operation, and maintenance of your appliance.

## IMPORTANT SAFETY INSTRUCTIONS

- Read all instructions before using the appliance.
- Do not leave the appliance unattended when plugged in.
- Do not use outdoors or on wet surfaces.
- Do not allow to be used as a toy. Close attention is necessary when used by or near children.
- Use only as described in this manual. Use only manufacturer's recommended attachments.
- Do not use with damaged cord or plug. If appliance is not working as it should, has been dropped, damaged, left outdoors, or dropped into water, return it to a service center.
- Do not pull or carry by cord, use cord as a handle, close a door on cord, or pull cord around sharp edges or corners. Do not run appliance over cord. Keep cord away from heated surfaces.
- Do not unplug by pulling on cord. To unplug, grasp the plug, not the cord.
- Do not handle plug or appliance with wet hands.
- Do not put any object into openings. Do not use with any opening blocked; keep free of dust, lint, hair, and anything that may reduce airflow.
- Keep hair, loose clothing, fingers, and all parts of body away from openings and moving parts.
- Do not pick up anything that is burning or smoking, such as cigarettes, matches, or hot ashes.
- Use extra care when cleaning on stairs.
- Do not use to pick up flammable or combustible liquids, such as gasoline, or use in areas where they may be present.
- Store your appliance indoors in a cool, dry area.

## PACKAGE CONTENTS

---

- Miele Boost CX1 Canister Vacuum Cleaner Unit
- Flexible Suction Hose
- Comfort Telescopic Wand
- Universal Floorhead
- Upholstery Nozzle
- Crevice Nozzle
- Dusting Brush
- Hygiene AirClean Filter (pre-installed or separate)

## SETUP AND ASSEMBLY

---

1. **Attach the Suction Hose:** Insert the end of the flexible suction hose into the suction inlet on the main unit until it clicks securely into place.
2. **Connect the Telescopic Wand:** Attach the Comfort Telescopic Wand to the handle end of the suction hose. Ensure it clicks firmly.
3. **Install the Floorhead:** Connect the Universal Floorhead to the end of the telescopic wand. Press the release button on the wand to adjust its length for comfortable use.
4. **Store Accessories:** The upholstery nozzle, crevice nozzle, and dusting brush can be attached to the VarioClip for easy access during cleaning.

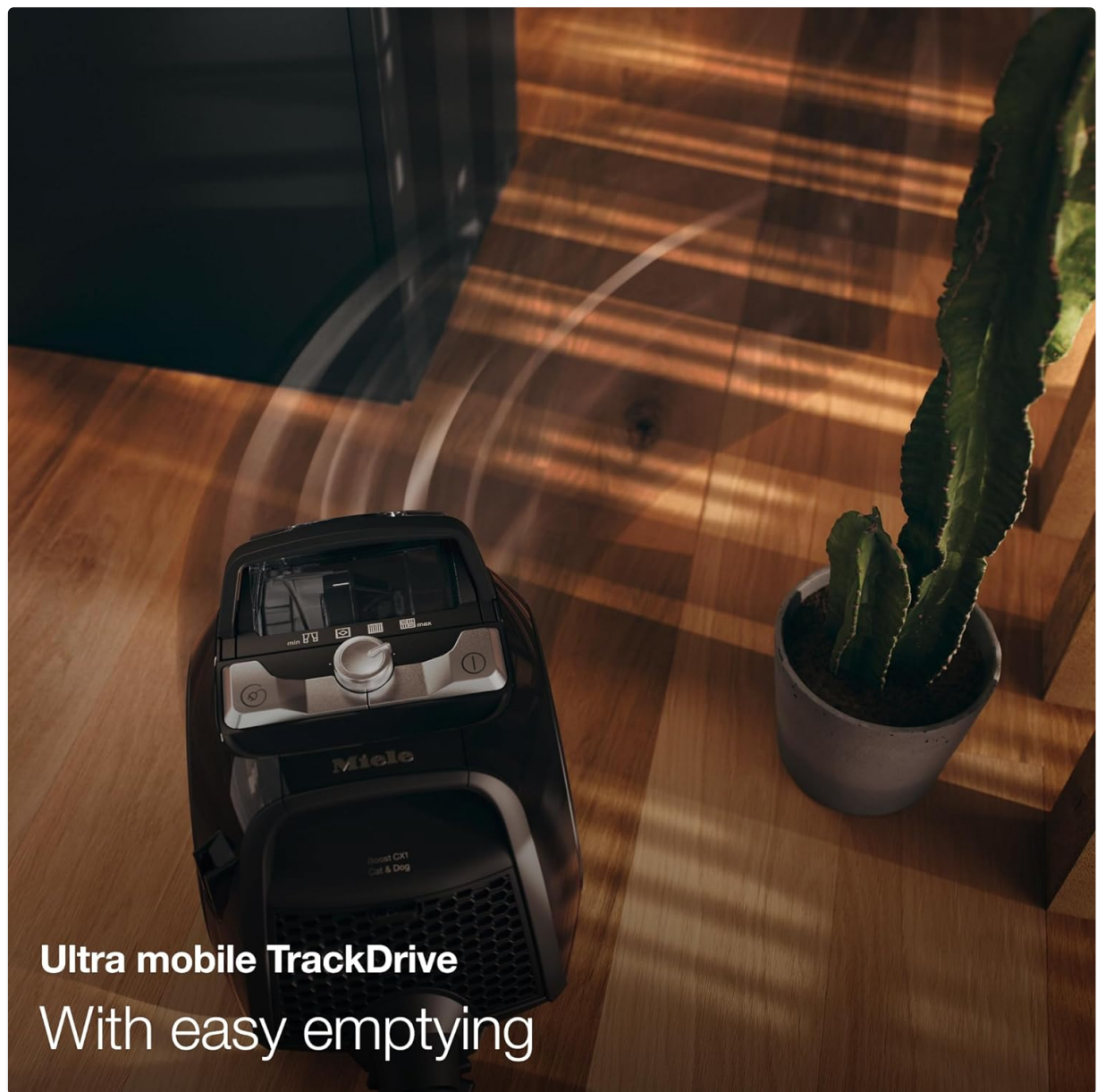

## Ultra mobile TrackDrive

### With easy emptying

The Miele Boost CX1 comes with a flexible hose, telescopic wand, and various attachments for comprehensive cleaning.



The VarioClip keeps essential cleaning accessories like the upholstery nozzle, crevice nozzle, and dusting brush conveniently at hand.

## OPERATING YOUR MIELE BOOST CX1

---

### Powering On/Off

To turn the vacuum cleaner on or off, press the large foot pedal power button located on the main unit.

### Adjusting Suction Power

The Boost CX1 features a rotary dial to adjust suction power across 3 levels, suitable for various surfaces:

- **Min:** For delicate fabrics like curtains or lightweight rugs.
- **Medium:** For upholstery, cushions, or lightly soiled carpets.
- **Max:** For hard floors, heavily soiled carpets, or pet hair removal.

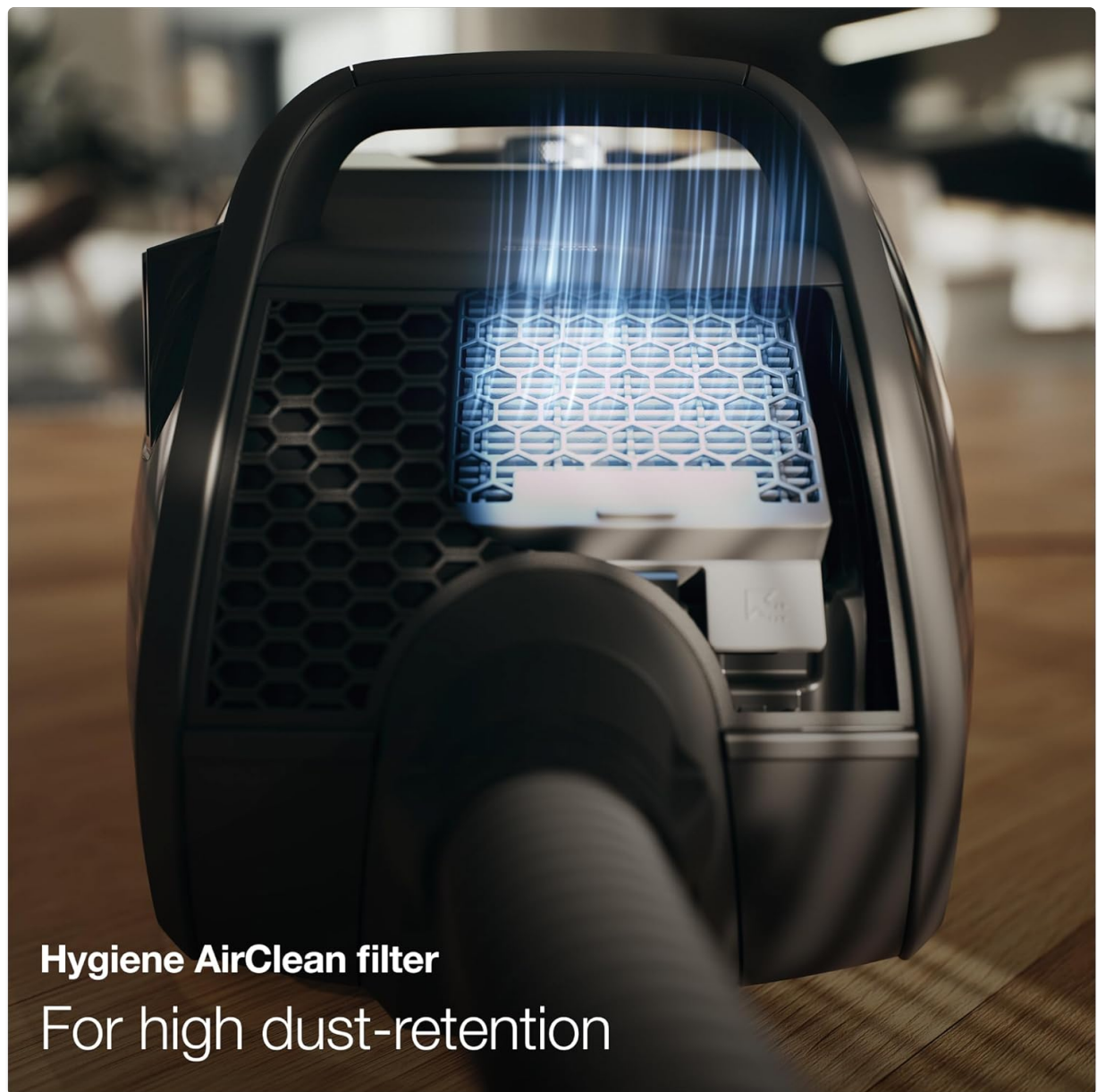

## Hygiene AirClean filter For high dust-retention

The rotary dial on the Miele Boost CX1 allows for easy adjustment of suction power to suit different cleaning needs, from delicate surfaces to deep carpet cleaning.

### Using the Universal Floorhead

The Universal Floorhead is designed for efficient cleaning on both smooth floors and low-pile carpets. Use the foot switch on the floorhead to toggle between settings for hard floors and carpets.

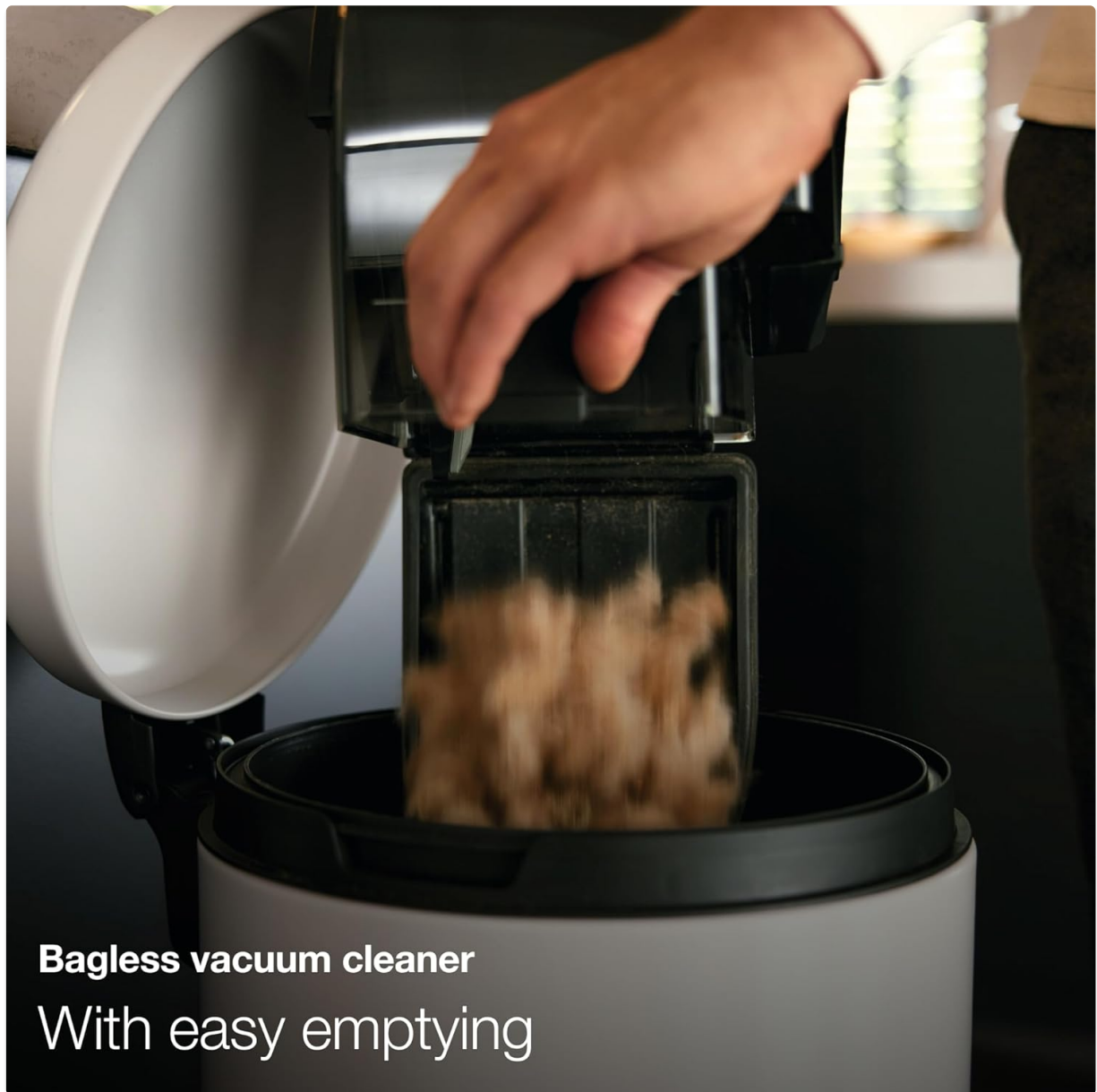

## **Bagless vacuum cleaner** With easy emptying

The universal floorhead transitions seamlessly between hard floors and low-pile carpets, ensuring effective cleaning on various surfaces.

### **Maneuverability (TrackDrive)**

The Boost CX1 is equipped with TrackDrive, featuring two large wheels on the sides and two swivel casters underneath. This design provides stability and allows for agile movement around furniture and obstacles without toppling.

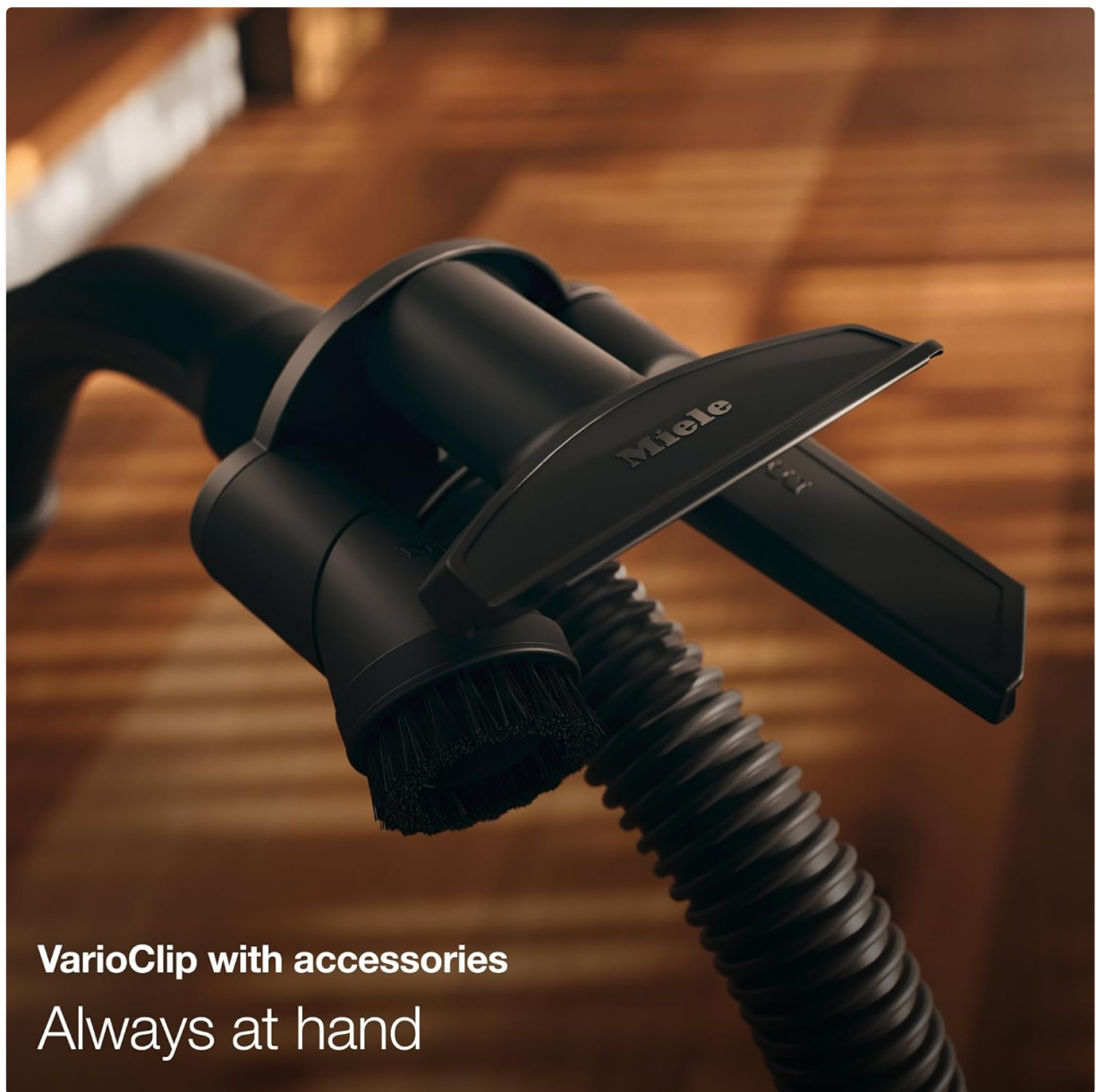

## VarioClip with accessories

### Always at hand

The innovative TrackDrive system ensures the vacuum remains stable and agile, easily navigating around obstacles in your home.

#### Automatic Cord Rewind

To retract the power cord, gently pull the cord until it automatically rewinds into the unit.

#### Product Video

Your browser does not support the video tag.

Official Miele video demonstrating the key features and operation of the Boost CX1 Bagless Canister Vacuum Cleaner.

## MAINTENANCE

#### Emptying the Dust Container

The Boost CX1 features a bagless design for convenient emptying. To empty, simply remove the dust container from the main unit and press the 'Empty' button to release collected debris into a waste bin.



## **Universal floorhead** For carpets and hard floors

The bagless dust container is easily removed and emptied with a single click, simplifying maintenance.

### **Hygiene AirClean Filter**

The multistage filtration system, including the Hygiene AirClean filter, retains even the smallest particles, ensuring excellent air quality. Regularly check and replace the filter as indicated by the appliance or as recommended in the full user manual.

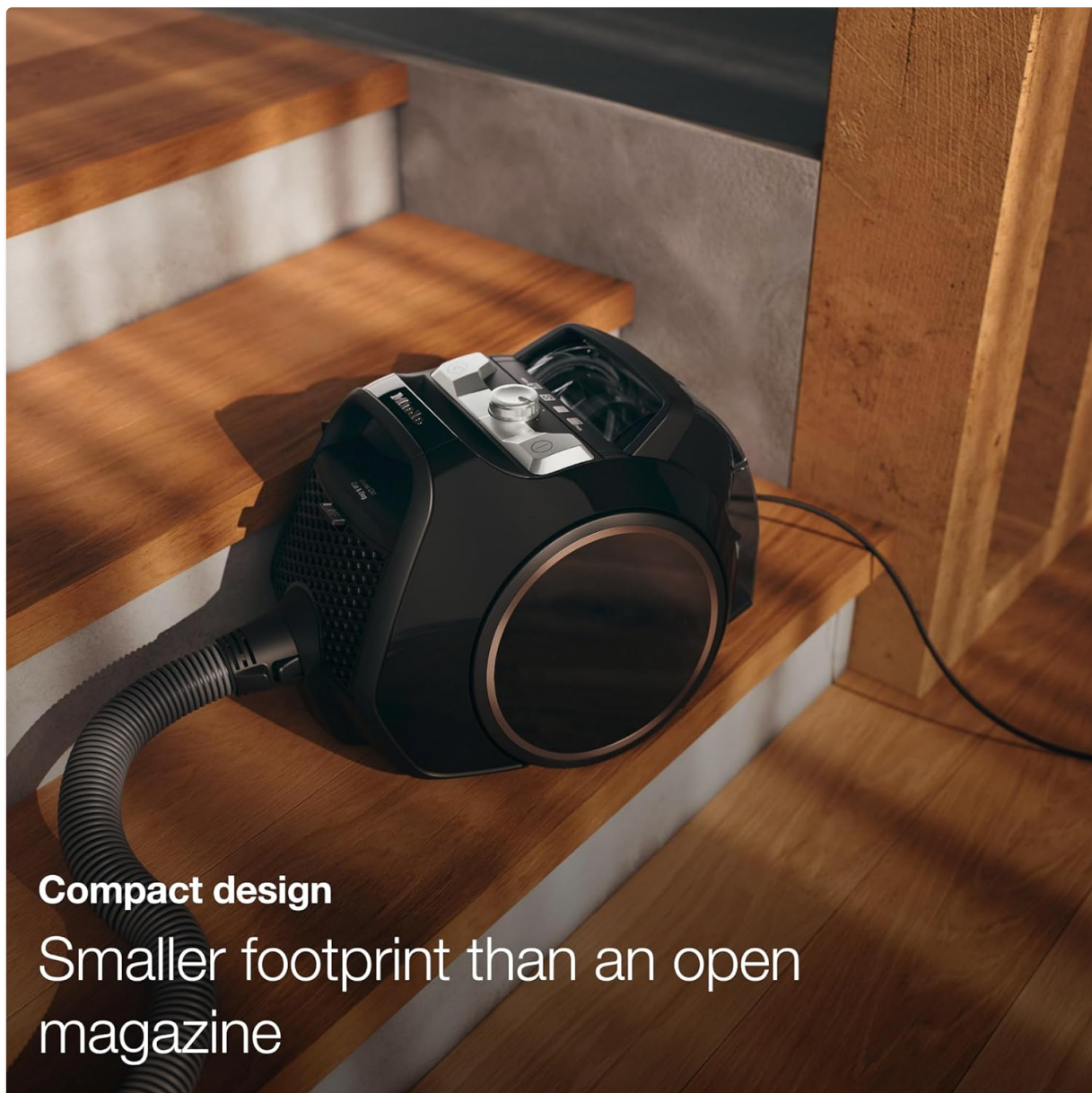

## Compact design

Smaller footprint than an open magazine

The Hygiene AirClean filter is a key component of the multistage filtration system, capturing fine dust particles for cleaner exhaust air.

## TROUBLESHOOTING

- **No Power:** Check if the power cord is securely plugged into a working outlet. Ensure the power button is pressed.
- **Loss of Suction:** Empty the dust container if full. Check for blockages in the hose, telescopic wand, or floorhead. Ensure the Hygiene AirClean filter is clean and correctly installed.
- **Unusual Noise:** Inspect the brush roll for tangled hair or debris. Check for any foreign objects in the hose or attachments.
- **Attachments Not Staying On:** Ensure attachments are clicked firmly into place.

For more detailed troubleshooting, please refer to the complete Miele user manual or contact Miele customer support.

## PRODUCT SPECIFICATIONS

| Feature | Detail |
|---------|--------|
|---------|--------|

|                      |   |
|----------------------|---|
| Brand                | Miele   |
| Model Name           | Boost CX1 Bagless   |
| Model Number         | 11735570  |
| Type                 | Bagless Canister Vacuum   |
| Power Source         | Corded Electric   |
| Motor Horsepower     | 1.6 horsepower  |
| Suction Power Levels | 3   |
| Filter Type          | Hygiene AirClean Filter (Multistage Filtration)                               |
| Special Features     | Automatic Cord Rewind, Bagless, Compact, TrackDrive Wheels, Vortex Technology |
| Product Dimensions   | 15.75"L x 11.02"W x 11.02"H   |
| Item Weight          | 17.2 pounds   |
| Noise Level          | 78 Decibels   |

### WARRANTY AND CUSTOMER SUPPORT

Miele products are known for their quality and durability. For warranty information, product registration, or technical support, please visit the official Miele website or contact their customer service. You can find more information and support at the [Miele Store](#).