

## Manuals+

[Q & A](#) | [Deep Search](#) | [Upload](#)

manuals.plus /

> [ChipPower](#) /

> [ChipPower Chiptuning OBD v4 Instruction Manual for Volvo V70 III 1.6 D/DRIVE/D2](#)

### ChipPower OBD v4 (Model 280019622)

# ChipPower Chiptuning OBD v4 Instruction Manual

Model: OBD v4 (280019622) for Volvo V70 III 1.6 D/DRIVE/D2

## 1. INTRODUCTION

---

The ChipPower Chiptuning OBD v4 is an advanced performance module designed to optimize the engine parameters of your vehicle. This device connects to your vehicle's On-Board Diagnostics (OBD) port to enhance power, torque, and fuel efficiency for compatible diesel engines. This manual provides essential information for the safe and correct installation, operation, and maintenance of your ChipPower OBD v4 module.

## 2. PRODUCT OVERVIEW

---

The ChipPower OBD v4 module is a fully digital, plug-and-play device. It is engineered to increase your car's power and torque by up to 30% and can contribute to fuel savings of up to 15%.

### 2.1. Package Contents

- ChipPower OBD v4 Module
- Special Vehicle Connection Cable (thin and flat design)
- Instruction Manual (available in 12 languages)
- Clamping Straps for securing the module

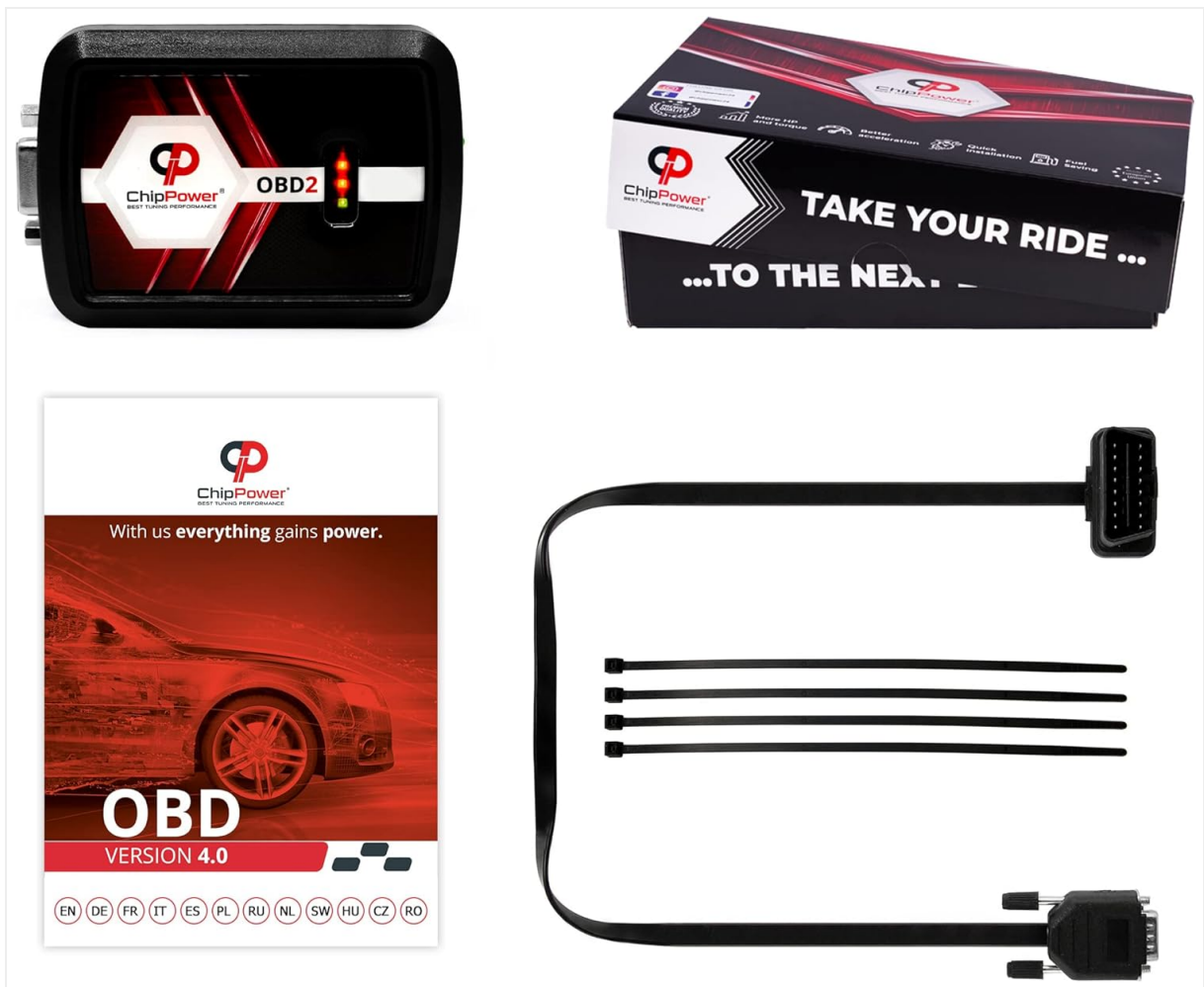

Image 2.1: Contents of the ChipPower OBD v4 package. Shown are the OBD v4 module, the connection cable, the instruction manual, and securing straps.

### 3. COMPATIBILITY

---

This ChipPower OBD v4 module is specifically designed for the following vehicle:

- **Vehicle Model:** Volvo V70 III
- **Engine Type:** 1.6 D/DRIVE/D2 (Diesel engines only)
- **Model Years:** 2007, 2008, 2009, 2010, 2011, 2012, 2013, 2014, 2015, 2016

Ensure your vehicle matches these specifications for proper function and safety.

### 4. SAFETY INFORMATION

---

Your safety and the proper functioning of your vehicle are paramount. Please observe the following safety guidelines:

- The ChipPower OBD v4 module includes an engine protection function, ensuring the device operates safely without causing harm to your vehicle's engine.
- The installation process does not involve permanent modifications to your vehicle's original systems.
- Upon removal, your vehicle will revert to its original factory settings.
- Always ensure the vehicle's ignition is off before connecting or disconnecting the module.
- Do not attempt to open or modify the module casing.

## 5. SETUP AND INSTALLATION

---

The ChipPower OBD v4 module is designed for easy installation into your vehicle's OBD port, typically located in the driver's cabin.

### 5.1. Installation Steps

1. **Locate the OBD Port:** The OBD port is usually found under the dashboard on the driver's side, often near the steering column or footwell. Consult your vehicle's owner's manual if you cannot locate it.
2. **Ensure Vehicle is Off:** Turn off the engine and ensure the ignition is completely off. Remove the key from the ignition if applicable.
3. **Connect the Module:** Carefully plug the ChipPower OBD v4 module's connector into your vehicle's OBD port. Ensure a firm and secure connection.
4. **Secure the Module:** Use the provided clamping straps to secure the module and its cable, preventing them from interfering with pedals or other vehicle controls.
5. **Start the Engine:** Once connected, start your vehicle's engine. The module will begin to optimize engine parameters automatically.



Image 5.1: Proper installation involves connecting the module directly to the vehicle's OBD port inside the cabin (top image). Avoid connecting it directly to engine components (bottom image).



Image 5.2: A close-up view of the ChipPower OBD v4 module being connected to the vehicle's OBD port, typically found under the dashboard.

## 5.2. Initial Adjustment (If Applicable)

Some ChipPower modules may feature a fine-tuning adjustment screw. If your module has this, refer to the detailed 12-language manual included in your package for specific instructions on how to adjust the settings using a small screwdriver. This adjustment allows for personalized optimization of performance or fuel economy.



Image 5.3: Illustrates the potential for fine-tuning the module using a small screwdriver. Refer to your specific manual for adjustment procedures.

## 6. OPERATING INSTRUCTIONS

---

Once correctly installed, the ChipPower OBD v4 module operates automatically. It continuously analyzes engine

data and adjusts parameters in real-time to achieve the advertised improvements in power, torque, and fuel efficiency.

- No further user interaction is typically required after installation.
- The module is designed for continuous operation while connected.
- If you wish to revert to factory settings, simply disconnect the module from the OBD port.

## 7. MAINTENANCE

---

The ChipPower OBD v4 module requires minimal maintenance. Follow these guidelines to ensure its longevity and proper function:

- **Keep Clean:** Periodically wipe the module with a dry, soft cloth to remove dust and debris. Do not use liquid cleaners directly on the module.
- **Avoid Extreme Conditions:** Do not expose the module to extreme temperatures, direct sunlight for prolonged periods, or excessive moisture.
- **Check Connections:** Occasionally verify that the module is securely plugged into the OBD port and that the cable is not damaged or loose.
- **Storage:** If removing the module for an extended period, store it in a dry, cool place away from direct sunlight.

## 8. TROUBLESHOOTING

---

If you encounter any issues with your ChipPower OBD v4 module, consider the following troubleshooting steps:

- **Module Not Functioning:**
  - Ensure the module is securely connected to the OBD port.
  - Verify that your vehicle's ignition is on or the engine is running.
  - Confirm that your vehicle model and engine type are compatible with the module (refer to Section 3).
- **Unexpected Vehicle Behavior:**
  - Disconnect the module from the OBD port. Your vehicle will revert to its original factory settings.
  - If the issue persists after disconnecting the module, it is likely unrelated to the ChipPower device.
- **Check Engine Light:** If a check engine light appears after installation, disconnect the module and consult your vehicle's service manual or a qualified mechanic.

For further assistance, refer to the comprehensive 12-language manual included with your product or contact ChipPower customer support.

## 9. SPECIFICATIONS

---

<b>Brand</b>	ChipPower
<b>Model</b>	OBD v4 (280019622)
<b>Compatibility</b>	Volvo V70 III 1.6 D/DRIVE/D2 (2007-2016), Diesel Engines
<b>Power/Torque Increase</b>	Up to 30%
<b>Fuel Economy Improvement</b>	Up to 15%

<b>Module Dimensions (L x W x H)</b>	92 mm x 63 mm x 27 mm
<b>Cable Length</b>	600 mm

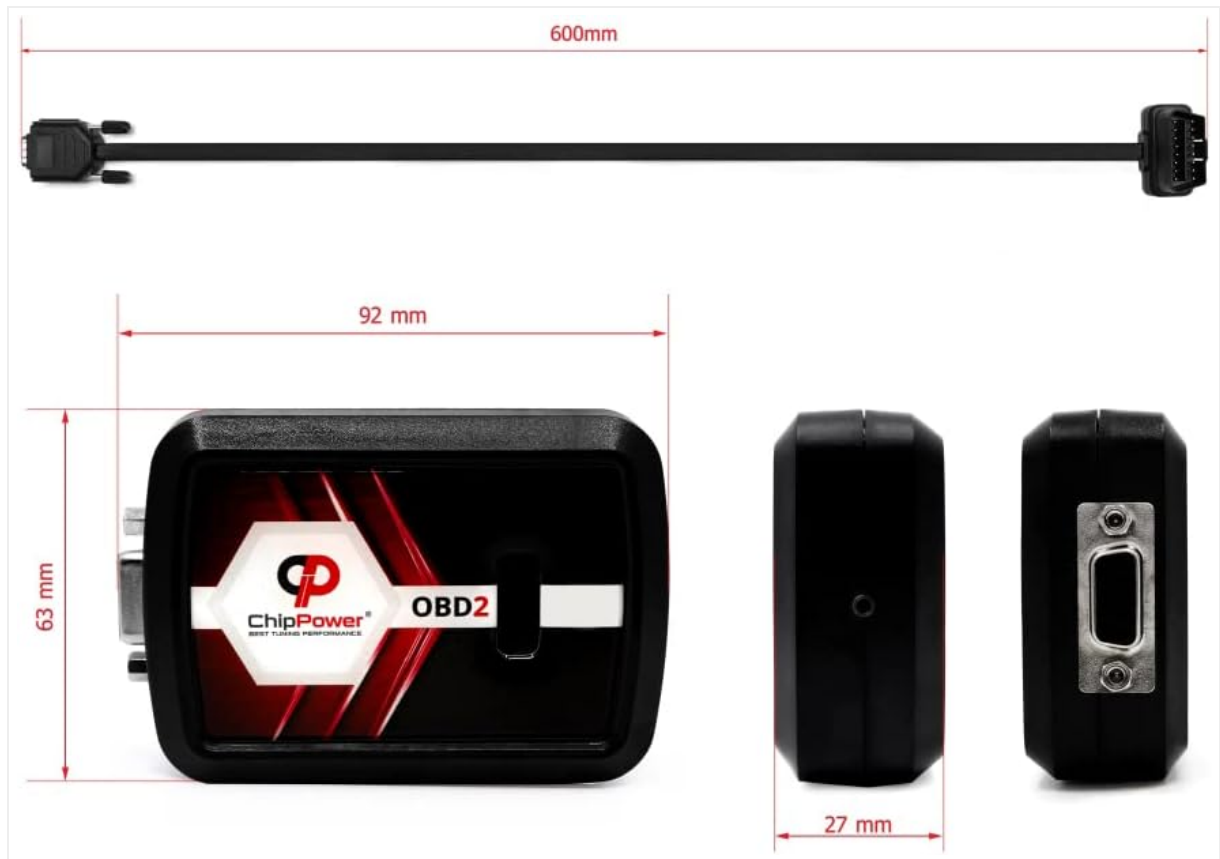

Image 9.1: Dimensional specifications of the ChipPower OBD v4 module and its connecting cable.

## 10. WARRANTY AND SUPPORT

For warranty information, technical support, or any questions not covered in this manual, please refer to the detailed 12-language manual included in your product package. You may also contact ChipPower directly through their official website or the retailer from whom you purchased the product. Please have your product model number (280019622) and vehicle details ready when contacting support.