

[Manuals.plus](#) /

› [JESLED](#) /

› JESLED Solar Security Lights Outdoor Motion Sensor User Manual

JESLED QY-JDEU-108LED

JESLED Solar Security Lights Outdoor Motion Sensor User Manual

Model: QY-JDEU-108LED

Brand: JESLED

1. PRODUCT OVERVIEW

The JESLED Solar Security Light is an advanced outdoor lighting solution featuring 108 high-power LED beads and a motion sensor. Designed for energy efficiency and ease of use, this light provides bright illumination for various outdoor areas such as patios, yards, pathways, and garages. Its adjustable solar panel ensures optimal sunlight absorption for charging, and multiple intelligent modes offer versatile lighting options.



Figure 1.1: Two JESLED Solar Security Lights, showcasing their design with integrated solar panels and motion sensors.

Key Features:

- **High Brightness:** Equipped with 108 LED beads for superior illumination.
- **Adjustable Solar Panel:** The solar panel can rotate and swing 180 degrees for optimal sun exposure.
- **Multiple Intelligent Modes:** Features four distinct lighting modes to suit various needs.
- **Energy Efficient:** Solar-powered design reduces electricity consumption.
- **Easy Installation:** Simple setup with included screws, no electrical wiring required.
- **Durable Design:** Suitable for outdoor use in various weather conditions.

2. PACKAGE CONTENTS AND COMPONENTS

Package Contents:

- Solar-powered LED light fixture (2 units for 2-pack)
- Screws for installation
- Separate battery compartment (integrated)

Component Identification:



Figure 2.1: Detailed view of the light's components, including the 108 LED pieces, USB connector, motion sensor, switch button, indicator lights (charging, turn off, mode 1, mode 2, mode 3), and replaceable battery.

- **108 LED Pieces:** Main light source.
- **USB Connector:** For Type-C charging (cable not included).
- **Motion Sensor:** Detects movement to activate light modes.
- **Switch Button:** For power control and mode selection.
- **Charging Indicator Light:** Indicates charging status.
- **Turn Off Indicator Light:** Shows when the device is off.
- **Mode Indicator Lights:** Displays the currently active lighting mode (Mode 1, 2, or 3).
- **Replaceable Battery:** Internal power source.

3. INSTALLATION AND SETUP

Choosing a Location:

Select a location that receives direct sunlight for at least 6-8 hours daily to ensure optimal charging of the solar panel. Avoid areas under eaves, trees, or other obstructions that might block sunlight. The light is ideal for outdoor walls, gardens, patios, decks, garages, driveways, porches, and fences.

Mounting the Light:

1. Identify the desired mounting surface.
2. Use the included screws to securely attach the light fixture to the wall. Ensure the mounting is stable.
3. Adjust the solar panel to face the direction of maximum sunlight. The panel can be rotated 180 degrees vertically and the base adjusted by 45 degrees for optimal angle.

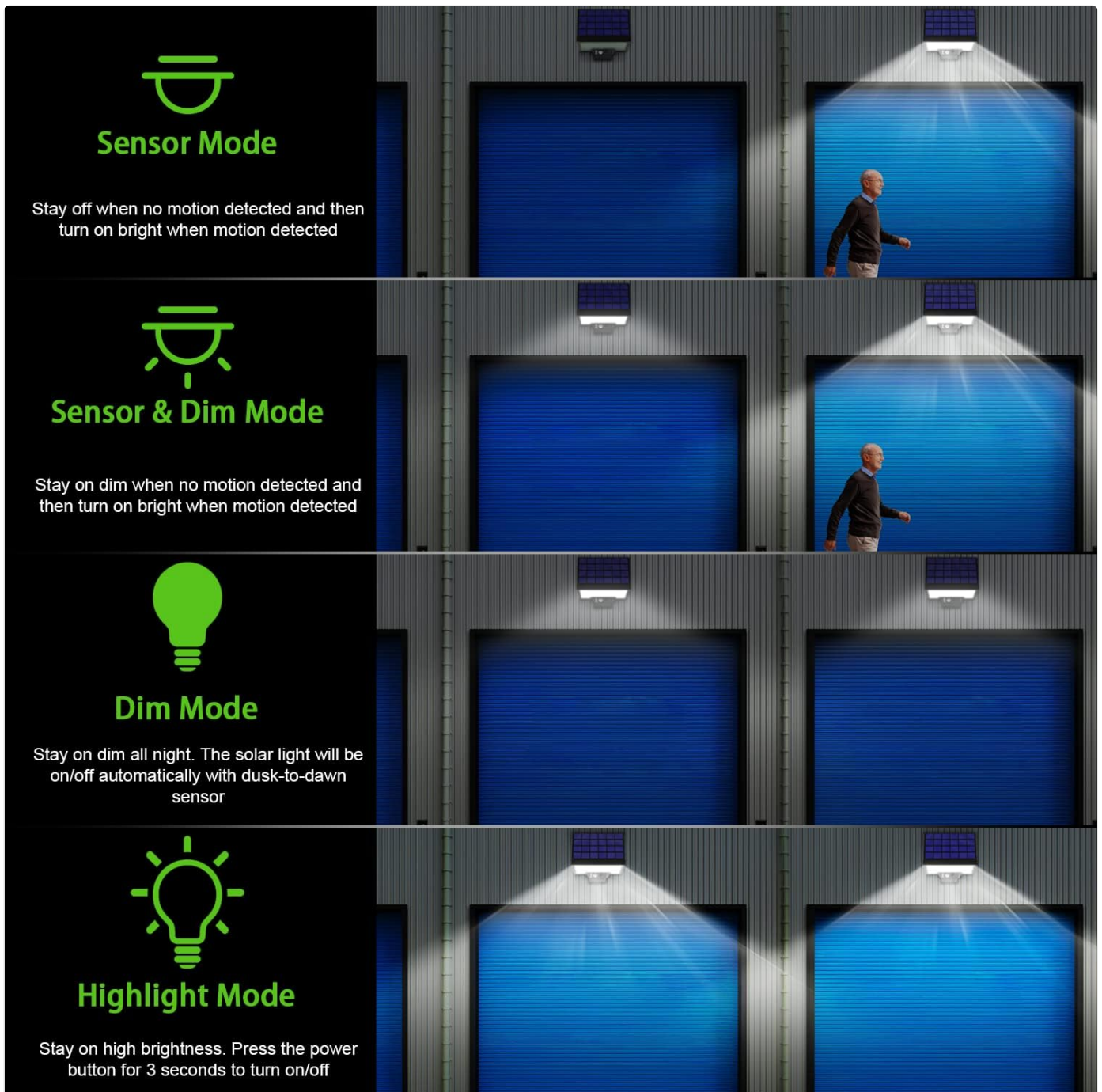

Figure 3.1: The solar panel can be adjusted 180 degrees and the base 45 degrees to optimize sunlight exposure and light direction.

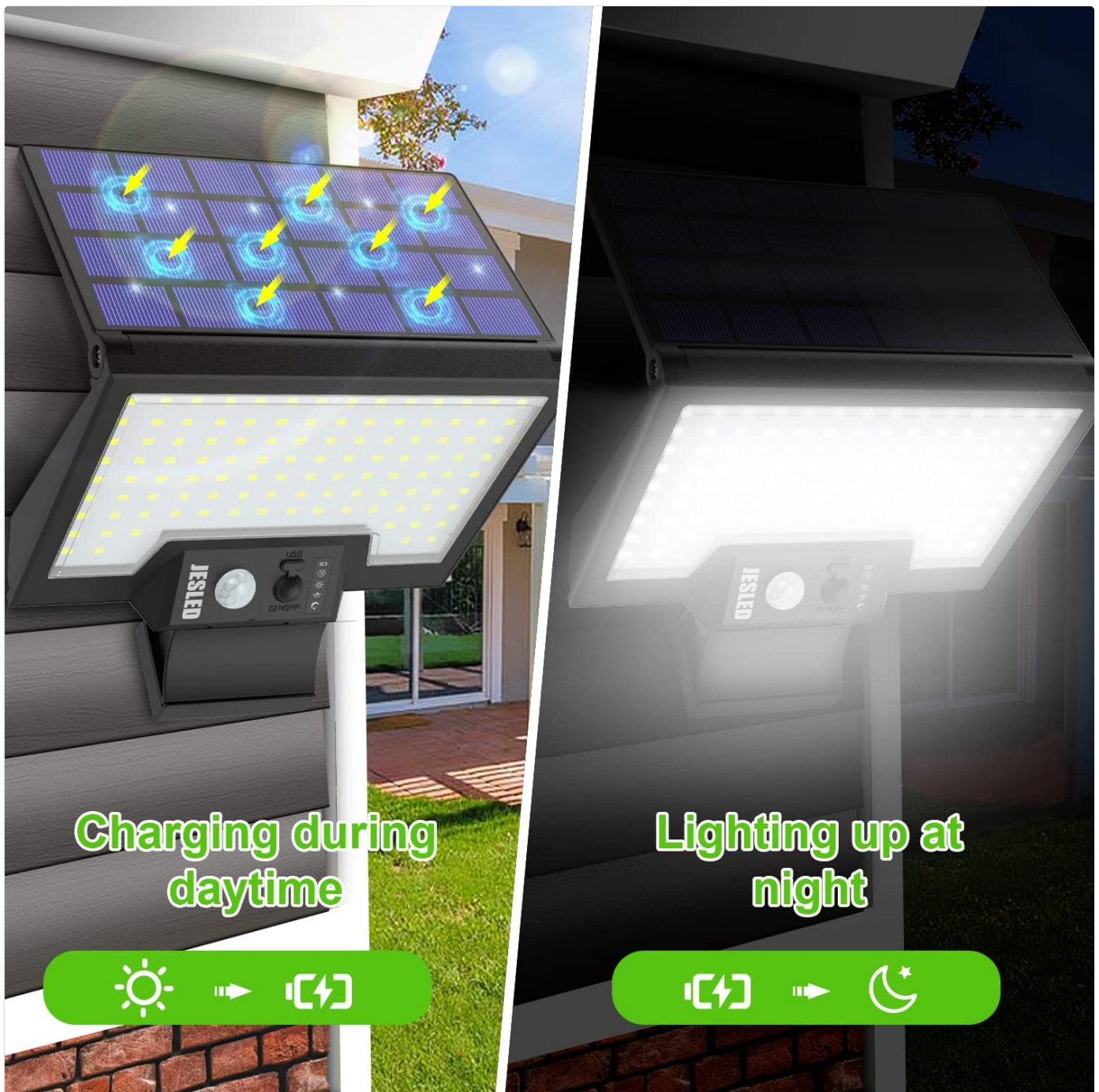

Figure 3.2: The light charges automatically during the day and illuminates at night, demonstrating its energy-saving functionality.

4. OPERATING MODES

The JESLED Solar Security Light features four intelligent operating modes, selectable via the switch button. Press the button repeatedly to cycle through the modes.



Figure 4.1: Visual representation of the four distinct operating modes for the solar light.

1. **Infrared Sensing Mode (Sensor Mode):** The light remains off when no motion is detected. It turns on to full brightness when motion is detected and turns off after a period of no motion.
2. **Infrared Sensing and Dimming Mode (Sensor & Dim Mode):** The light stays on at a dim brightness when no motion is detected. It switches to full brightness when motion is detected and returns to dim mode after a period of no motion.
3. **Dimming Mode (Dim Mode):** The light stays on at a continuous dim brightness throughout the night. It automatically turns on/off with a dusk-to-dawn sensor.
4. **Emergency Mode (Highlight Mode):** The light stays on at high brightness continuously. To activate or deactivate this mode, press and hold the power button for 3 seconds.

Light Coverage:

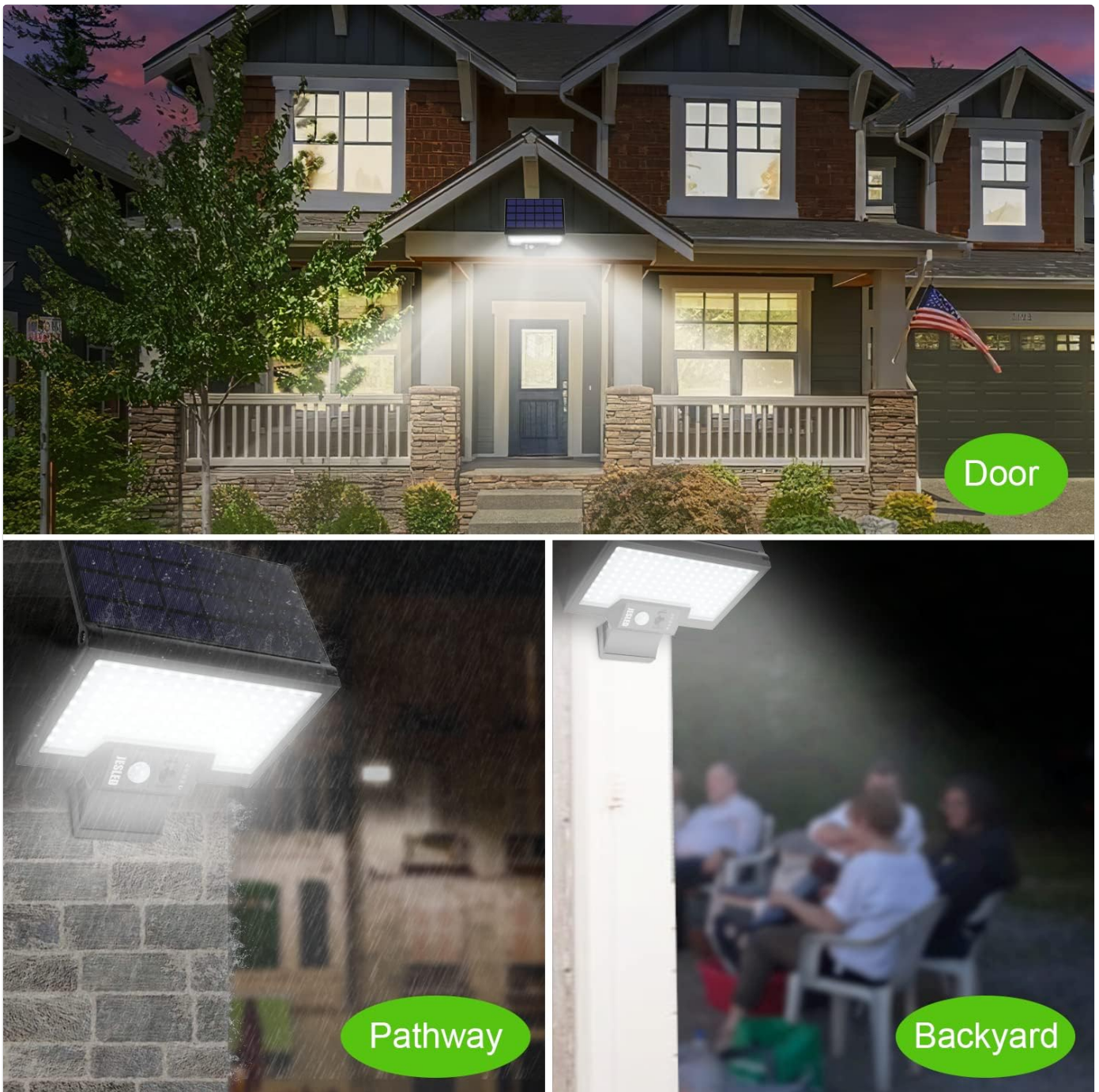

Figure 4.2: The JESLED Solar Security Light provides effective illumination over an area of approximately 160 square feet.

5. MAINTENANCE

To ensure the longevity and optimal performance of your JESLED Solar Security Light, regular maintenance is recommended.

- **Clean the Solar Panel:** Periodically wipe the solar panel with a soft, damp cloth to remove dust, dirt, or debris. A clean panel ensures efficient sunlight absorption and charging.
- **Check for Obstructions:** Ensure no new obstructions (e.g., growing branches, new structures) are blocking direct sunlight to the solar panel.
- **Battery Check:** The light uses a replaceable Lithium Polymer battery. If the light's performance significantly degrades over time, consider checking or replacing the battery as per manufacturer guidelines.
- **Inspect Fixture:** Occasionally check the light fixture and mounting for any signs of wear or damage. Ensure all screws remain tight.

6. TROUBLESHOOTING

If you encounter issues with your JESLED Solar Security Light, refer to the following common problems and solutions:

Problem	Possible Cause	Solution
Light does not turn on at night.	Insufficient charging during the day.	Ensure the solar panel is in a location that receives 6-8 hours of direct sunlight daily. Clean the solar panel surface.
Light is dim or only stays on for a short period.	Battery not fully charged or aging battery.	Allow for more charging time in direct sunlight. If issues persist, the battery may need replacement.
Motion sensor is not detecting movement.	Sensor obstructed or incorrect mode.	Ensure the motion sensor is clean and unobstructed. Verify the light is in a motion-sensing mode (Mode 1 or Mode 2).
Light flickers or behaves erratically.	Loose connection or internal fault.	Check for any visible loose connections. If the problem persists, contact customer service.

7. PRODUCT SPECIFICATIONS

Specification	Detail
Brand	JESLED
Model Number	QY-JDEU-108LED
Product Dimensions	18 x 19 x 12 cm
Item Weight	930 g
Number of LEDs	108
Battery Type	1 Lithium Polymer battery (included)
Voltage	3.7 Volts
Luminous Flux	800 lumen
Wattage	10.8 watts
Colour Temperature	6000 Kelvin
Material	Plastic
Special Features	Energy Efficient, Motion Sensor, Rotatable Solar Panels
Switch Style	Push Button
Installation Type	Wall Mount

8. WARRANTY AND SUPPORT

JESLED is committed to providing high-quality products and customer satisfaction.

- **Warranty:** This product comes with a 2-year warranty, with 1 year specifically covering the battery.
- **Refund Policy:** A 60-day full refund policy is offered.
- **Customer Service:** JESLED provides 24-hour after-sales customer service. For any questions, concerns, or support needs, please contact JESLED customer service directly.