

Manuals+

[Q & A](#) | [Deep Search](#) | [Upload](#)

Manuals.plus /

› [Fosgoit](#) /

› Fosgoit All-Terrain Remote Control Stunt Car User Manual

Fosgoit RC-QST1827

Fosgoit All-Terrain Remote Control Stunt Car User Manual

Model: RC-QST1827

1. INTRODUCTION

Thank you for choosing the Fosgoit All-Terrain Remote Control Stunt Car. This innovative RC car offers exciting features like 4WD drift, 360° rotation, and dual control modes (remote and gesture). Designed for children aged 4-10, it provides endless fun with its lights, music, and ability to conquer various terrains. Please read this manual carefully before operation to ensure safe and optimal performance.



Image 1.1: The Fosgoit All-Terrain Remote Control Stunt Car, showcasing its vibrant design, integrated music features, and both the traditional remote control and the innovative gesture control watch.

2. SAFETY INFORMATION

- Always operate the RC car in open, safe areas away from people, pets, and obstacles.
- Do not operate near water or in wet conditions to prevent electrical damage.
- Keep fingers, hair, and loose clothing away from moving parts, especially the wheels.
- Adult supervision is recommended for young children.
- Use only the specified batteries and charging methods. Improper use can lead to fire or injury.
- Do not disassemble or modify the product.
- Store the car and controllers in a cool, dry place when not in use.

3. PACKAGE CONTENTS

Please check the package to ensure all items are present:

- Fosgoit All-Terrain RC Stunt Car
- 2.4 GHz Remote Control

- Gesture Control Watch
- Rechargeable Lithium-ion Battery (for car)
- USB Charging Cable (for car battery)
- USB Charging Cable (for gesture control watch)
- User Manual (this document)

4. SETUP

4.1 Charging the Car Battery

1. Locate the battery compartment on the side of the RC car.
2. Open the compartment and connect the rechargeable Lithium-ion battery.
3. Connect the USB charging cable to the battery and plug the other end into a USB power adapter (not included) or a computer USB port.
4. The indicator light on the charging cable will show charging status (e.g., red for charging, off for fully charged).
5. A full charge typically takes 2-3 hours and provides over 60 minutes of playing time.

4.2 Installing Batteries in the Remote Control

1. Open the battery compartment on the back of the 2.4 GHz remote control.
2. Insert 2 "AA" batteries (not included) into the compartment, ensuring correct polarity (+/-).
3. Close the battery compartment securely.

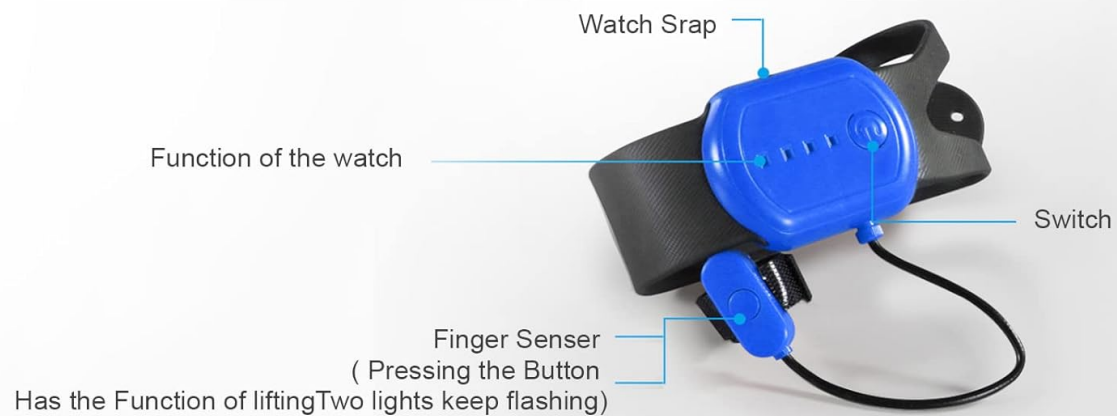
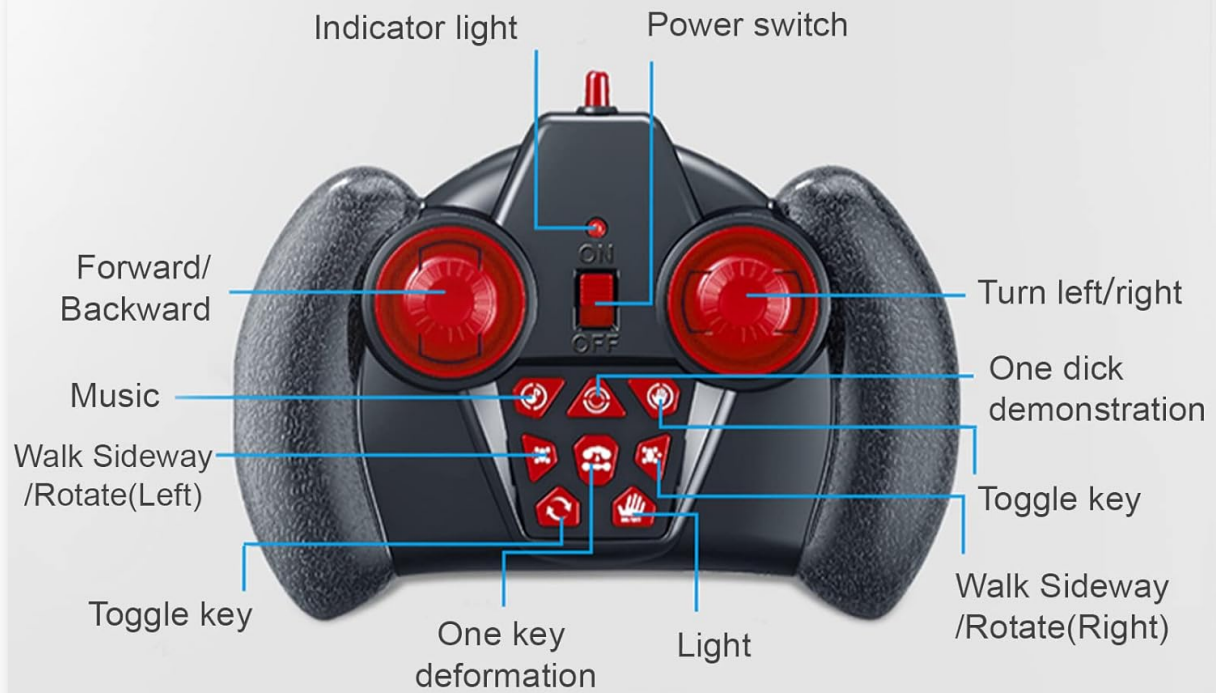

Image 4.1: Detailed diagram showing the buttons and functions of the 2.4 GHz remote control and the gesture control watch, including battery compartments and charging ports.

4.3 Charging the Gesture Control Watch

1. Connect the small USB charging cable to the charging port on the gesture control watch.
2. Plug the other end into a USB power adapter or computer USB port.
3. The indicator lights on the watch will show charging status.

4.4 Pairing the Car with Controllers

1. Ensure the car battery is charged and connected. Turn on the car's power switch.
2. Turn on the remote control or the gesture control watch.
3. The car and controller will automatically pair. If pairing fails, turn off both devices and try again.

5. OPERATING INSTRUCTIONS

5.1 Basic Controls (Remote Control)

- **Forward/Backward:** Use the left joystick to move the car forward or backward.
- **Turn Left/Right:** Use the right joystick to steer the car left or right.

- **Walk Sideway/Rotate (Left/Right):** Use the dedicated buttons for sideways movement or rotation.
- **Light Button:** Toggles the car's integrated lights.
- **Music Button:** Toggles the car's integrated music.
- **One Key Deformation:** Transforms the car between On-Road and Off-Road modes.
- **One Dick Demonstration:** Activates an automatic stunt demonstration sequence.

5.2 Stunt Functions and Deformation



Serpentine Twist



360° Rotation On The Side



45° Incline Climbing



Double-sided Driving

Image 5.1: Visual guide to the car's advanced stunt capabilities, including its ability to perform serpentine twists, 360-degree rotations, climb 45-degree inclines, and drive on both sides.

- **Serpentine Twist:** The car can twist and turn its body for dynamic movements.
- **360° Rotation:** Perform full rotations on the spot for impressive stunts.
- **45° Incline Climbing:** The bionic spine design allows the car to climb obstacles and inclines up to 45 degrees.
- **Double-sided Driving:** The car can continue driving even when flipped upside down, offering continuous play.
- **Two Deformations Switch Freely:** Easily switch between "OFF ROAD" mode for rough terrains and "ON-ROAD" mode for faster, streamlined driving on flat surfaces using the "One Key Deformation" button.

OFF ROAD

*Drive on terrains like rock road,
climb obstacles easily*



**Two Deformations
Switch Freely**



ON-ROAD

Streamlined design for faster speed

Image 5.2: The car's dual deformation modes: "OFF ROAD" for tackling challenging terrains like rock roads and "ON-ROAD" for high-speed performance on smooth surfaces.

5.3 All-Terrain Driving

The powerful design and creative Mecanum wheels allow the Fosgoit RC car to drive on various surfaces:

- Road
- Carpet
- Sand
- Rock
- Grass

All-Terrain Driving Powerful Remote Control Car

Allowing children to enjoy the fun of speed and passion.



Image 5.3: The RC car demonstrating its versatility across different terrains, including paved roads, carpets, sandy areas, rocky paths, and grassy fields.

5.4 Gesture Control (Watch)

The gesture control watch allows for intuitive control through hand movements:

- Wear the watch securely on your wrist.
- Move your hand forward to make the car go forward.
- Move your hand backward to make the car go backward.
- Tilt your hand left or right to steer the car.
- Press the finger sensor button to activate specific stunts or deformation (refer to watch diagram for specific functions).

6. MAINTENANCE

- **Cleaning:** Wipe the car and controllers with a soft, dry cloth after each use. Do not use water or chemical cleaners.
- **Battery Care:**
 - Remove batteries from controllers if not used for extended periods.

- Do not overcharge the car's rechargeable battery.
- Store batteries in a cool, dry place.
- **Storage:** Store the product in a cool, dry environment, away from direct sunlight and extreme temperatures.

7. TROUBLESHOOTING

Problem	Possible Cause	Solution
Car does not respond to controller.	Low battery in car or controller; Not paired; Out of range.	Charge car battery; Replace controller batteries; Re-pair devices; Operate within 200 feet range.
Car moves slowly or inconsistently.	Low car battery; Obstruction in wheels.	Recharge car battery; Check and clear any debris from wheels.
Lights or music not working.	Feature turned off; Low car battery.	Press the respective button on the remote; Recharge car battery.
Car does not deform.	Obstruction; Low battery.	Ensure no physical obstruction; Recharge car battery.

8. SPECIFICATIONS

- **Model:** RC-QST1827
- **Brand:** Fosgoit
- **Dimensions (L x W x H):** 32.5 x 14.5 x 7.3 cm (12.8 x 5.7 x 2.9 inches)
- **Weight:** 700 grams (1.54 lbs)
- **Material:** ABS Plastic
- **Control Frequency:** 2.4 GHz
- **Max Speed:** Up to 20 KM/H (12.4 MPH)
- **Remote Control Distance:** Up to 200 feet (60 meters)
- **Play Time:** 60+ minutes (per charge)
- **Car Battery:** 2 x Lithium-ion (included, rechargeable)
- **Remote Control Battery:** 2 x AA (not included)
- **Special Features:** All-Terrain, High Speed, 360° Rotation, Double-sided Driving, One-Key Deformation, Lights & Music, Gesture Control.

Superior RC Stunt Car Performance and Flexible Reaction

20 KM/H

- ▶ High-Speed

200 Feet

- ▶ Remote control distance

60+ MIN PLAYING TIME

- ▶ 2 Rechargeable Batteries

INSANE STUNTS & ALL ROUND DRIFT

DAZZLING SHOCKING LIGHT AND MUSIC



Image 8.1: Key performance specifications and dimensions of the RC stunt car, highlighting its speed, control distance, play time, and battery information.

9. WARRANTY AND SUPPORT

Fosgoit products are designed for quality and performance. This product comes with a standard manufacturer's warranty against defects in materials and workmanship. For warranty claims, technical support, or any questions regarding your product, please contact Fosgoit customer service through the retailer's platform or the official brand website.

Please retain your proof of purchase for warranty purposes.