

LSLYA RB-7018B

LSLYA RB-7018B Double Din Car Stereo User Manual

Model: RB-7018B

1. INTRODUCTION

This manual provides detailed instructions for the installation, operation, and maintenance of your LSLYA RB-7018B Double Din Car Stereo. Please read this manual thoroughly before using the product to ensure proper function and safety.

2. SAFETY INFORMATION

- Ensure the car stereo is only compatible with a 12V DC car power supply. Incorrect voltage can cause damage.
- Professional installation is recommended for wiring to prevent electrical damage or fire.
- Do not operate the device in a way that distracts you from driving.
- Avoid exposing the unit to extreme temperatures, direct sunlight for prolonged periods, or moisture.
- Always disconnect the car battery's negative terminal before starting any installation or wiring work.

3. PACKAGE CONTENTS

Verify that all items are present in the package:

- LSLYA RB-7018B Car Stereo Unit
- Remote Control
- Rear View Camera
- Power Cable Harness
- User Manual (this document)
- Steering Wheel Control (SWC) Interface
- Microphone

Product List



Power Cable



Rear Camera



User Manual



SWC

Figure 3.1: LSLYA RB-7018B Car Stereo unit with its accessories, including the remote control, rear camera, power cable, user manual, and SWC interface.

4. PRODUCT OVERVIEW

Familiarize yourself with the main components and connections of your car stereo.

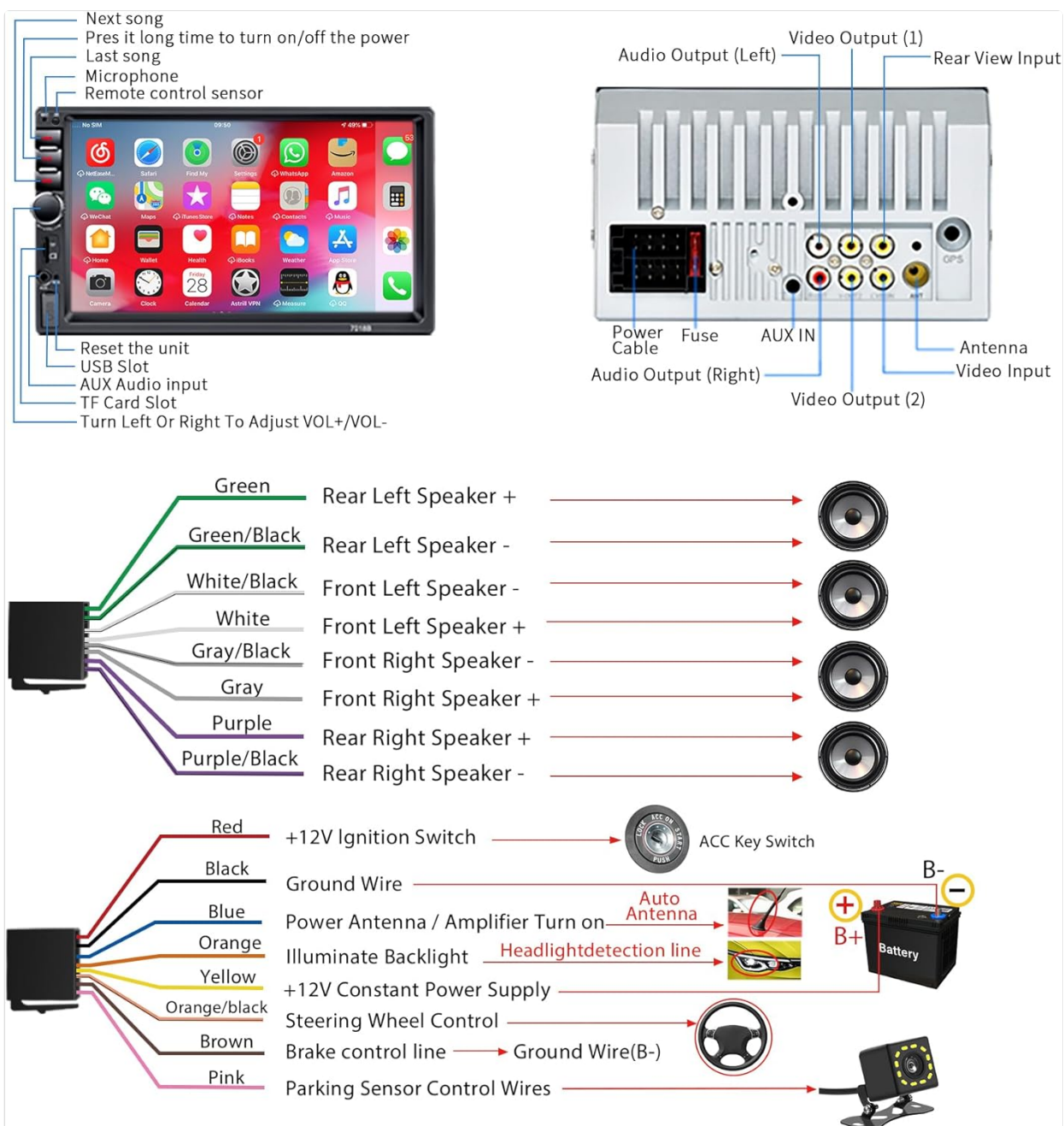

Figure 4.1: Detailed diagram showing the front panel buttons and ports (Next Song, Previous Song, Power/Mute, Microphone, Remote Control Sensor, Reset, USB Slot, AUX Audio Input, TF Card Slot, Volume Knob) and the rear wiring connections (Power Cable, Fuse, AUX IN, Antenna, Video Output, Video Input, Rear View Input).

5. INSTALLATION

5.1 Power Supply Requirements

This car audio system is designed for a **12V DC car power supply only**. Before installation, confirm your vehicle's power supply specifications. Using an incorrect power supply can damage the unit and void the warranty.

5.2 Wiring Diagram

Refer to the following diagram for correct wiring connections. It is highly recommended to have this unit installed by a qualified professional.

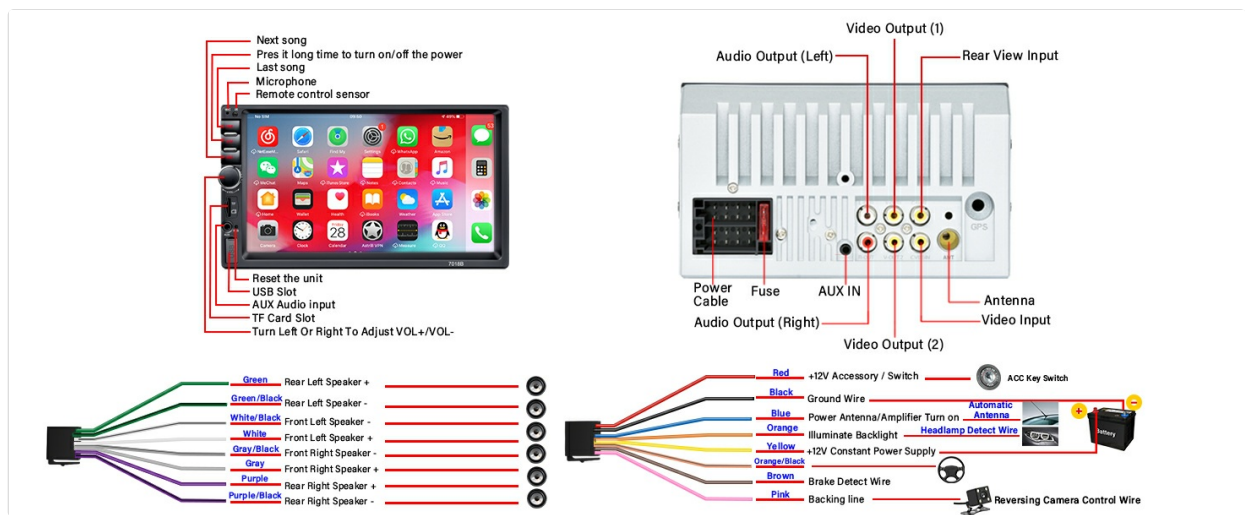

Figure 5.1: Comprehensive wiring diagram illustrating connections for speakers (front/rear, left/right), power (+12V Ignition Switch, Ground Wire, Power Antenna/Amplifier Turn On, Headlight Detection Line, +12V Constant Power Supply), Brake Control Line, and Parking Sensor Control Wires for the reversing camera.

- **Red Wire:** Connect to +12V Ignition Switch (ACC).
- **Black Wire:** Connect to Ground (GND).
- **Yellow Wire:** Connect to +12V Constant Power Supply.
- **Blue Wire:** Connect to Power Antenna or Amplifier Turn On.
- **Orange Wire:** Connect to Headlight Detection Line for backlight illumination.
- **Brown Wire:** Connect to Brake Control Line.
- **Pink Wire:** Connect to Parking Sensor Control Wires for reversing camera trigger.
- **Speaker Wires:** Connect according to the color codes for front and rear, left and right speakers (Green, Green/Black, White, White/Black, Gray, Gray/Black, Purple, Purple/Black).

5.3 Reversing Camera Installation

The included HD night vision rear view camera provides a wide viewing angle and is fully waterproof. Connect it as shown in the diagram below for automatic display when reversing.

Reversing image automatic switching

Full-screen reversing image, intelligently assisting you in reversing safely"

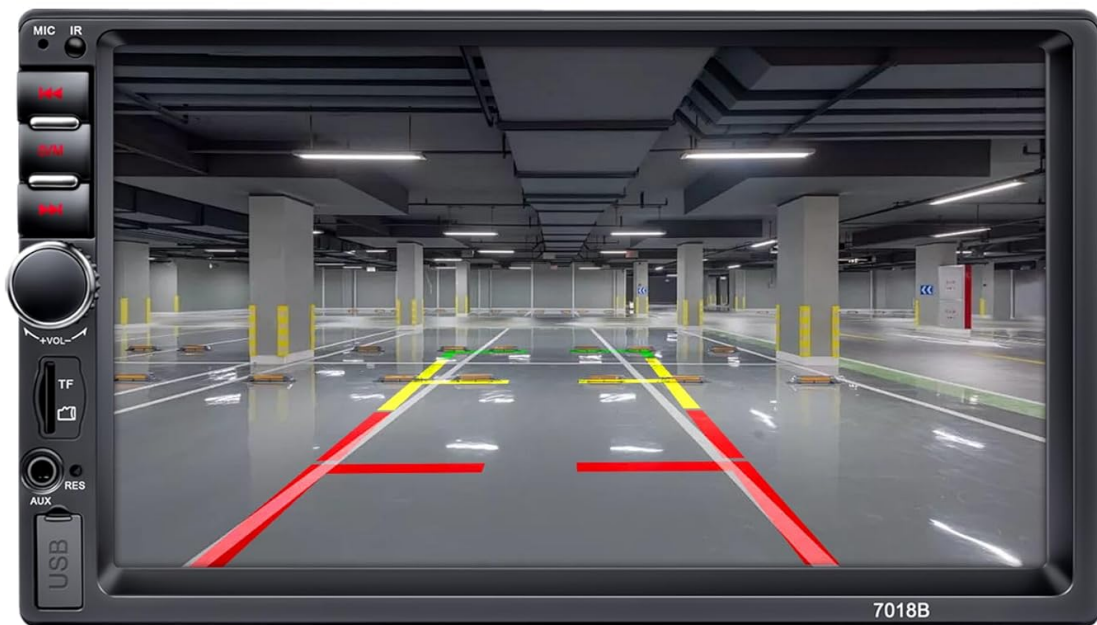

1. Monitor (Not included in the Package)
2. Camera Power Source
3. Camera

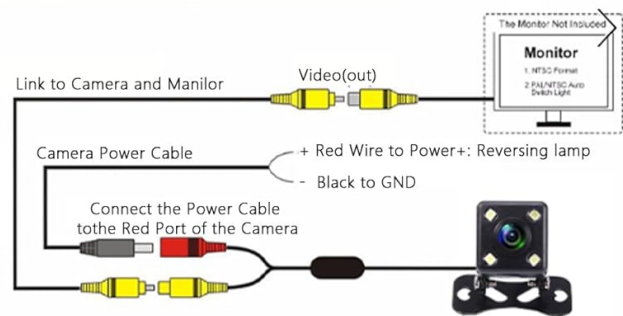

Figure 5.2: Reversing camera connection diagram. The camera's video output connects to the stereo's Rear View Input. The camera's power cable (red wire) connects to the reversing lamp's positive (+) terminal, and the black wire connects to ground (GND).

6. OPERATING INSTRUCTIONS

6.1 Basic Operations

- **Power On/Off:** Press and hold the power button on the front panel. A short press typically mutes/unmutes.
- **Volume Control:** Use the rotary knob on the front panel to adjust the volume.
- **Reset:** A small reset button is available on the front panel (refer to Figure 4.1) for system restarts if needed.

6.2 Bluetooth Connectivity

The stereo supports Bluetooth for hands-free calling and audio streaming.

Bluetooth Connection

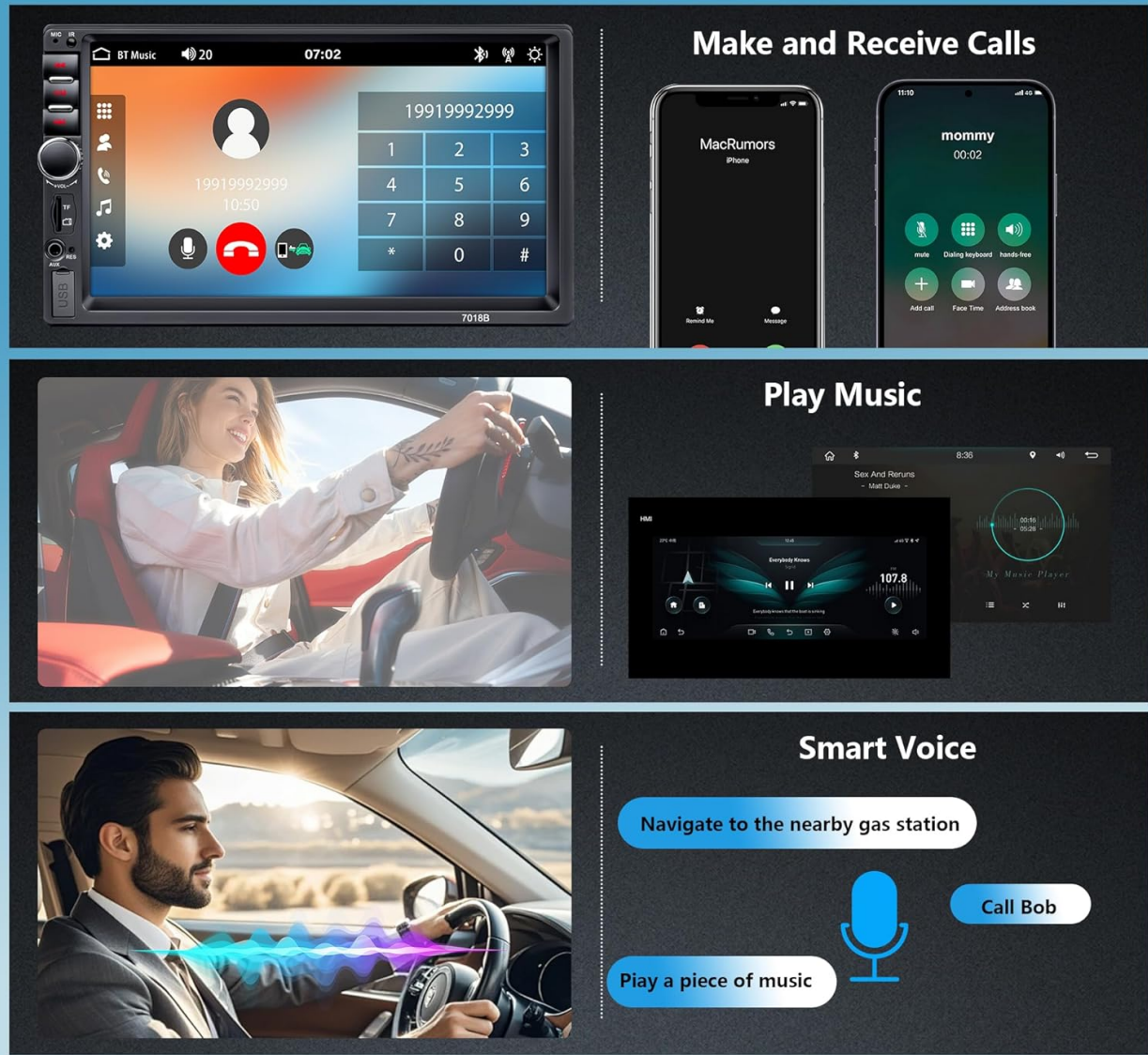

Figure 6.1: Bluetooth interface showing options for making and receiving calls, playing music, and utilizing smart voice assistants for navigation or music control.

1. Enable Bluetooth on your mobile phone.
2. Search for available devices on your phone and select "RB-7018B" (or similar name).
3. Confirm pairing on both devices.
4. Once connected, you can make/receive calls and stream audio wirelessly.

6.3 Mirror Link Function

Mirror Link allows you to display your smartphone's screen on the car stereo. Android phones support two-way connection, while iOS phones support one-way projection.

Mirroring Link

USB the data cable to connect the phone to the machine to achieve interconnection, Android phone Support two-way connection, IOS phone supports one-way projection



Figure 6.2: Mirror Link in action, showing an Android phone and an iPhone mirroring their screens to the car stereo display.

1. Connect your smartphone to the stereo using a USB data cable.
2. Follow the on-screen prompts on the stereo and your phone to establish the connection.
3. Once connected, your phone's screen will be displayed on the stereo.

6.4 FM Radio

Access local radio stations and stay updated with news and music.



Figure 6.3: FM radio interface displaying current frequency, band selection, and search options.

1. Select the FM Radio application from the main menu.
2. Use the "BAND" button to switch between FM bands.
3. Use the search buttons to automatically scan for stations or manually tune to a frequency.

6.5 Media Playback (USB, TF Card, AUX)

The stereo supports multiple media input options for playing audio and video files.



Figure 6.4: Four play modes: USB, TF card, AUX, and Bluetooth. Also illustrates the USB fast charging capability for mobile devices.

- **USB:** Insert a USB drive into the USB slot. The system will automatically detect and play compatible media files. Supports fast charging for mobile phones.
- **TF Card:** Insert a TF (MicroSD) card into the TF card slot. The system will access media files stored on the card.
- **AUX:** Connect an external audio device using a 3.5mm audio cable to the AUX input. Select AUX mode on the stereo to play audio from the connected device.

6.6 Equalizer (EQ) Settings

Customize your audio experience with the built-in equalizer settings.

- Access the EQ settings from the audio menu.
- Choose from preset equalizer modes or manually adjust frequency bands to suit your preferences.

6.7 Steering Wheel Controls (SWC)

If your vehicle supports steering wheel controls, you can connect them to the stereo for convenient operation.



Figure 6.5: Steering wheel controls allow for easy switching between music tracks and answering/ending calls without taking hands off the wheel.

- Connect the SWC wires from your vehicle to the corresponding inputs on the stereo's wiring harness (refer to Figure 5.1).
- Access the SWC learning function in the stereo's settings menu to program the buttons.

7. MAINTENANCE

- Clean the screen with a soft, lint-free cloth. Do not use abrasive cleaners or solvents.
- Keep the unit free from dust and debris.
- Ensure proper ventilation around the unit to prevent overheating.

8. TROUBLESHOOTING

| Problem | Possible Cause | Solution |
|-----------------------------------|--|--|
| No power | Incorrect wiring; Blown fuse; Insufficient power supply. | Check all power connections (Red, Yellow, Black wires). Verify the fuse. Ensure 12V DC power supply. |
| No sound | Speaker wires incorrectly connected; Volume too low; Mute function active. | Check speaker wiring. Increase volume. Deactivate mute. |
| Bluetooth not connecting | Bluetooth not enabled on phone/stereo; Device not in pairing mode; Interference. | Ensure Bluetooth is active on both devices. Try restarting both devices. Move closer to the stereo. |
| Mirror Link issues (iPhone 16/17) | Compatibility challenges with newer iOS versions. | For iPhone 16 & 17 users experiencing issues, please contact customer support directly from your order page for an upgrade guide and assistance. |
| Reversing camera not displaying | Camera not powered; Video cable loose; Pink trigger wire not connected. | Check camera power and video connections. Ensure the pink trigger wire is correctly connected to the reversing lamp. |

9. SPECIFICATIONS

| Feature | Detail |
|---------|--------|
|---------|--------|

| Feature | Detail |
|--------------------------------------|---|
| Model Number | RB-7018B |
| Screen Size | 7 Inch HD Touch Screen |
| Power Supply | 12V DC |
| Connectivity | Bluetooth, USB, AUX, TF Card |
| Special Features | Bluetooth Hands-Free Calling, Mirror Link, FM Tuner, EQ Settings, Reversing Camera Support, USB Fast Charging |
| Audio Output Mode | Stereo |
| Surround Sound Channel Configuration | 4.0 |
| Video Encoding Support | RM, RMVB, AVI, MP4, MKV, 3GP |
| Product Dimensions | 3.94 x 2.56 x 3.94 inches |
| Item Weight | 1.72 pounds |





10. CUSTOMER SUPPORT

If you encounter any issues or have questions regarding your LSLYA RB-7018B Car Stereo, please contact our customer support team. For specific issues like those with iPhone 16 & 17 Mirror Link, reach out directly from your order page for specialized assistance and upgrade guides.

For further assistance, please visit the [LSLYA Store on Amazon](#).

Related Documents - RB-7018B

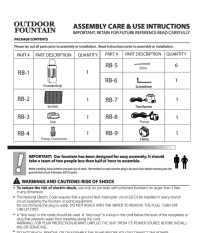
| | |
|---|--|
|  | <p>Podofo Autoradio Android 7018B/7010B - Guida Utente e Specifiche</p> <p>Manuale completo per l'autoradio Podofo 7018B/7010B con schermo touchscreen da 7 pollici, sistema Android, GPS, Bluetooth, Mirror Link e fotocamera posteriore. Include istruzioni di installazione, configurazione e risoluzione dei problemi.</p> |
|---|--|

| | |
|---|---|
|  | <p>BLAUBERG ISO-RB Radial-Rohrventilator mit schallisoliertem Gehäuse - Betriebsanleitung</p> <p>Umfassende Betriebsanleitung für den BLAUBERG ISO-RB Radial-Rohrventilator mit schallisoliertem Gehäuse. Erfahren Sie mehr über technische Spezifikationen, Montageanleitungen, elektrische Anschlüsse, Wartung, Fehlerbehebung und Garantieinformationen.</p> |
|  | <p>Blaubeurg ISO-RB Центробежный Канальный Вентилятор - Руководство Пользователя и Технические Характеристики</p> <p>Полное руководство пользователя и технические характеристики центробежного канального вентилятора Blaubeurg ISO-RB. Информация по установке, эксплуатации, обслуживанию и гарантии.</p> |
|  | <p>Outdoor Fountain Assembly, Care, and Use Instructions</p> <p>Comprehensive guide for assembling, using, and maintaining your outdoor fountain. Includes parts list, troubleshooting, safety warnings, and warranty information.</p> |
|  | <p>Chainway C66 Industrial Handheld Terminal Accessories Guide</p> <p>A comprehensive guide detailing the standard and optional accessories available for the Chainway C66 industrial-grade smart handheld terminal, including power adapters, data cables, batteries, protective cases, charging docks, and more.</p> |



[LED Light Therapy Mask User Manual and Specifications](#)

Comprehensive guide to the Shenzhen Rainbow Technology LED Light Therapy Mask, covering usage, safety, specifications, and electromagnetic compliance.