

## PGST PE523R

# PGST PE523R Solar Outdoor Alarm Siren User Manual

Model: PE523R | Brand: PGST

## 1. INTRODUCTION

This manual provides instructions for the installation, operation, and maintenance of your PGST PE523R Solar Outdoor Alarm Siren. This device is designed to enhance your security system by providing an audible and visual alert in conjunction with compatible alarm panels.

## 2. PRODUCT OVERVIEW

The PGST PE523R is a wireless outdoor siren featuring solar charging, an LED flashing light, and a loud alarm sound. It is compatible with Dadvu PG103, PG107, and PG108 alarm systems.



Figure 2.1: Front view of the PGST PE523R Solar Outdoor Alarm Siren.

## Key Features

- **Solar Powered:** Equipped with a solar panel for continuous charging, reducing the need for external power.
- **High Decibel Siren:** Produces a loud 110 dB alarm sound to deter intruders.
- **LED Flashing Light:** Provides a visual alert during an alarm event.
- **IP65 Waterproof Design:** Suitable for outdoor use, resistant to dust and water jets.
- **433 MHz Wireless Interface:** Connects wirelessly to compatible alarm systems and sensors.
- **Anti-theft Tamper Switch:** Triggers an alarm if the siren is moved or removed from its mounting.
- **Compatibility:** Designed to work with Dadvu PG103, PG107, and PG108 alarm panels.

# Solar Audible And Visual Alarm

Keep Your Home Safe



Acoustic  
Strobe Siren



Powered  
by Solar



Waterproof  
Design



No Wire  
No Worries



Tamper  
Alarm



Low Voltage  
Alarm

Figure 2.2: Overview of the siren's main features including acoustic strobe, solar power, waterproof design, wireless connectivity, tamper alarm, and low voltage alarm.

## 100db Never Miss an Alarm

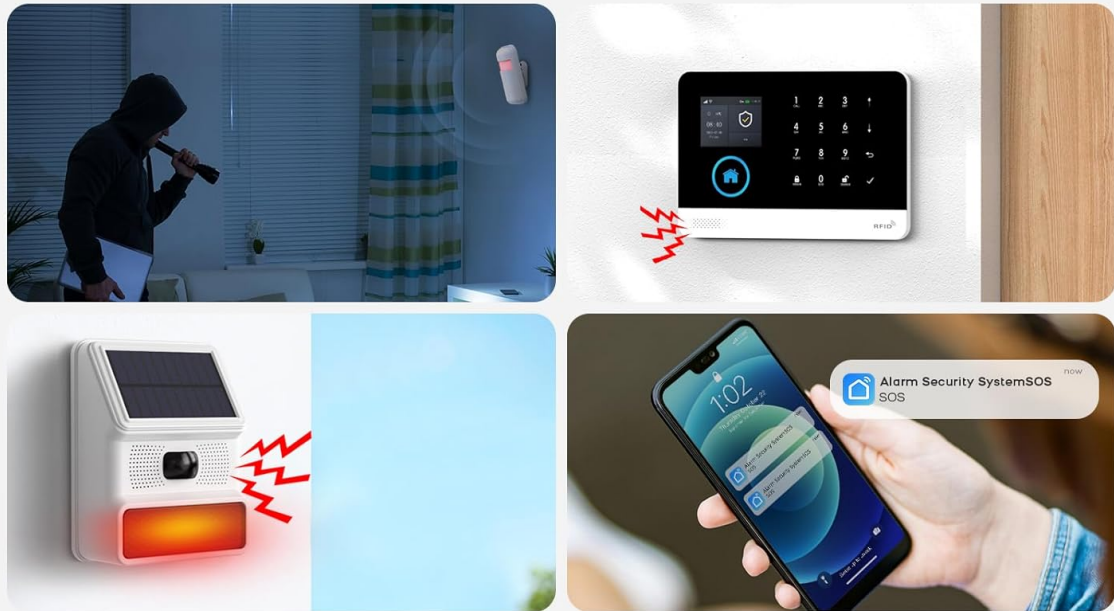

Figure 2.3: The siren's 100dB alarm capability in different security situations, ensuring alerts are not missed.

## Water-Proof Design Don't Be Afraid Of Bad Weather



Figure 2.4: The siren's waterproof design ensures reliable operation in various weather conditions.



# Extensive Use

Widely used in villas, courtyards, farms, orchards, hotels, warehouses and other outdoor places



Villa Courtyard



Orchard



Hotel

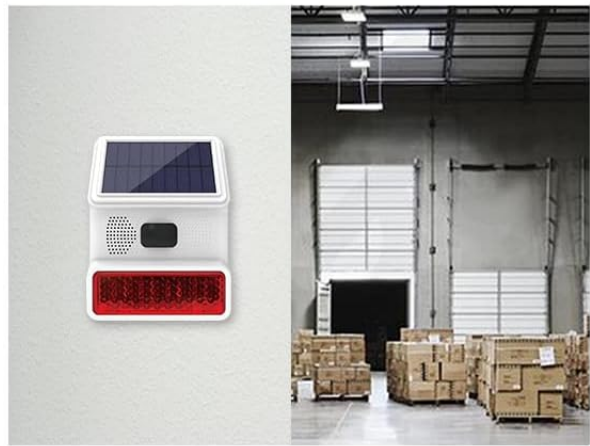

Warehouse

Figure 2.5: The siren is suitable for extensive use in various outdoor settings such as villa courtyards, orchards, hotels, and warehouses.

## 45°solar Panel, High Efficiency Absorption Of Solar Energy, Long Standby.



Figure 2.6: The 45-degree solar panel design ensures high efficiency in absorbing solar energy for long standby times.

### 3. COMPONENTS AND CONTROLS

Familiarize yourself with the different parts and control buttons of your siren.

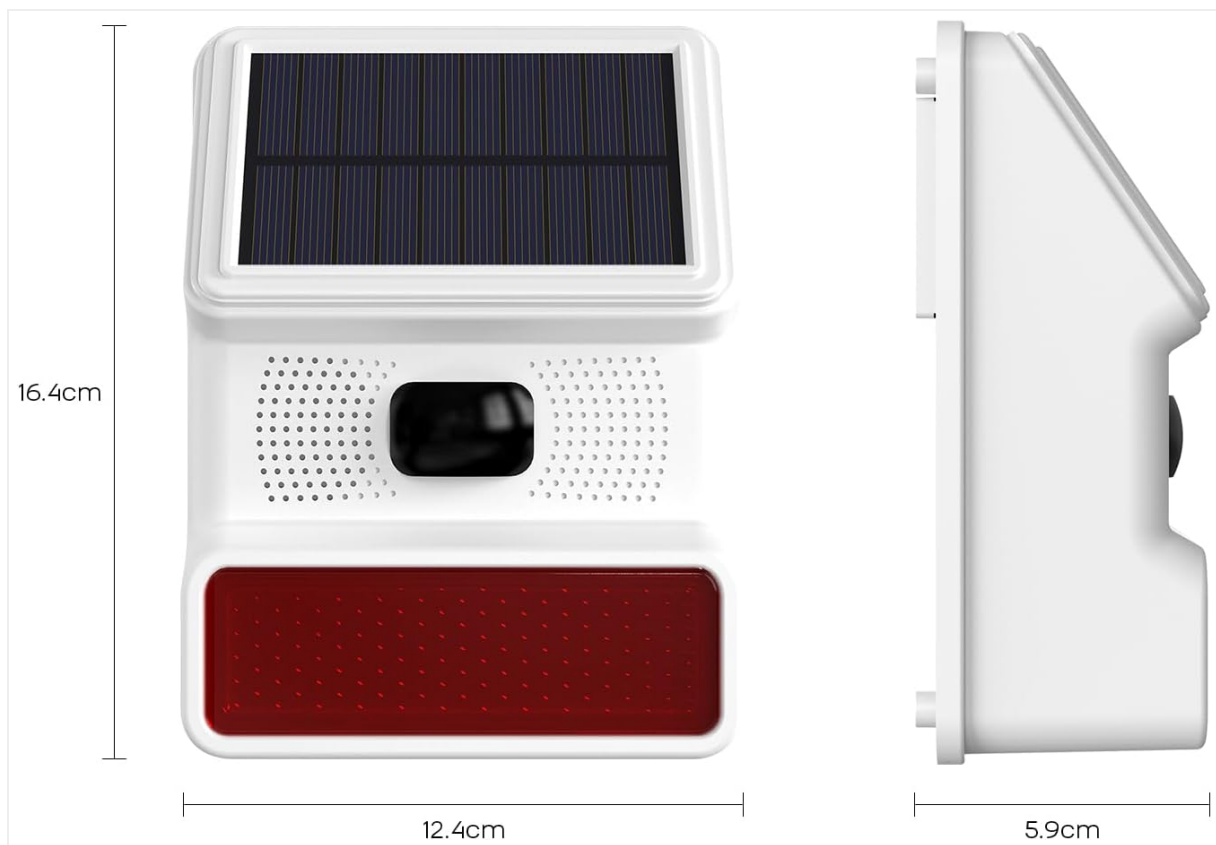

Figure 3.1: Labeled components of the siren, including solar charging panel, speaker, detection windows, indicator light, mounting bracket, Type C power interface, ON/OFF switch, and control buttons.



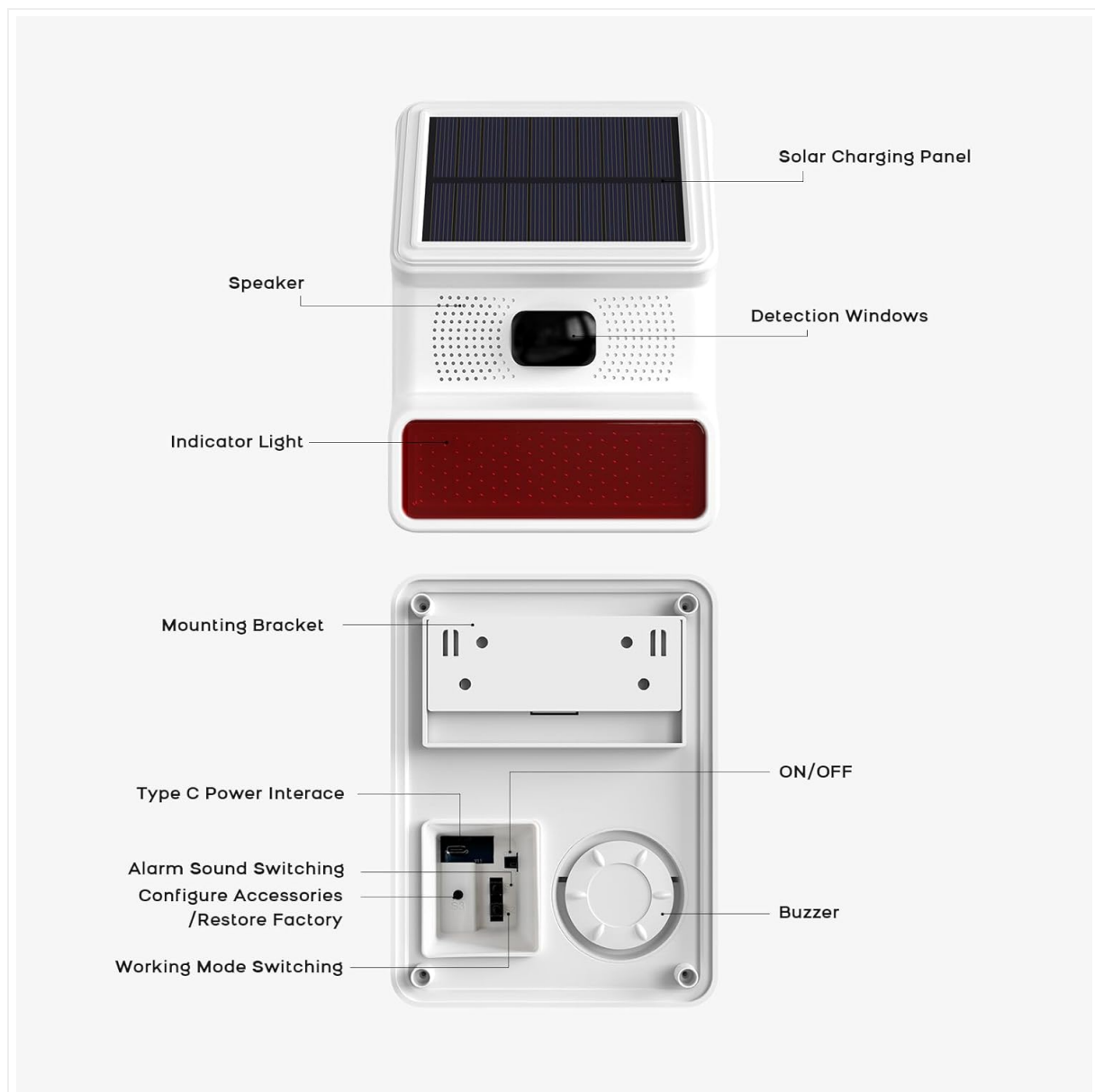

Figure 3.2: Detailed view of the S1, S2, and S3 control buttons on the siren.

- **S1 Button:** Short press to cycle through different alarm voice types.
- **S2 Button:** Short press to cycle through various working modes.
- **S3 Button:**
  - Short press to enter accessory configuration mode for pairing.
  - Long press to restore the siren to factory default settings.

## 4. TECHNICAL SPECIFICATIONS

<b>Power Supply Mode</b>	Solar charging / DC 5V power supply
<b>Alarm Sound Level</b>	≤100dB (at 10cm), up to 110 Decibels
<b>Charging Time</b>	Solar charging: >10 hours (dependent on solar radiation) USB charging: 4-5 hours (DC 5V/1A)
<b>Battery Parameters</b>	3.7V 1000mA polymer lithium battery
<b>Operating Current</b>	<10mA

Alarm Current	<200mA
Receive Frequency	433.92 MHz (1527 protocol)
Receive Distance	≥100m (distance affected by obstruction and interference signal)
Operating Temperature	-20℃ ~ 55℃
Operating Humidity	40%-80% (non-condensing)
Dimensions (L×W×H)	164.3 × 124.3 × 59mm
Item Weight	320 g
Mounting Type	Wall Mount
IP Rating	IP65 (Waterproof)



Figure 4.1: Physical dimensions of the PGST PE523R Solar Outdoor Alarm Siren.

## 5. INSTALLATION

Follow these steps to properly install your outdoor siren.

1. **Choose a Location:** Select an outdoor location that receives ample direct sunlight for optimal solar charging. Ensure the location is within the wireless range of your main alarm panel (up to 100 meters in open areas).
2. **Mount the Bracket:** Use the provided screws and expansion plugs to securely fix the mounting bracket to the wall.
3. **Attach the Siren:** Carefully hang the alarm siren onto the mounted bracket, ensuring it is firmly seated.

## Installation operation

(1) fix the mounting bracket on the wall.

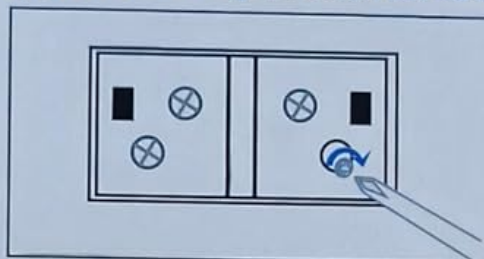

(2) hang the alarm signal on the bracket.

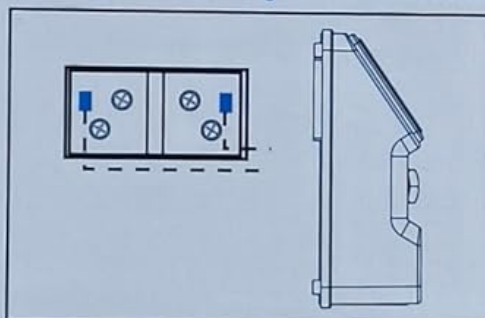

- ☐ Wi-Fi
- ☐ WiFi+Voice
- ☐ Standalone
- ☐ Standalone+Voice
- ☒ Solar Standalone
- ☐ WiFi + Standalone

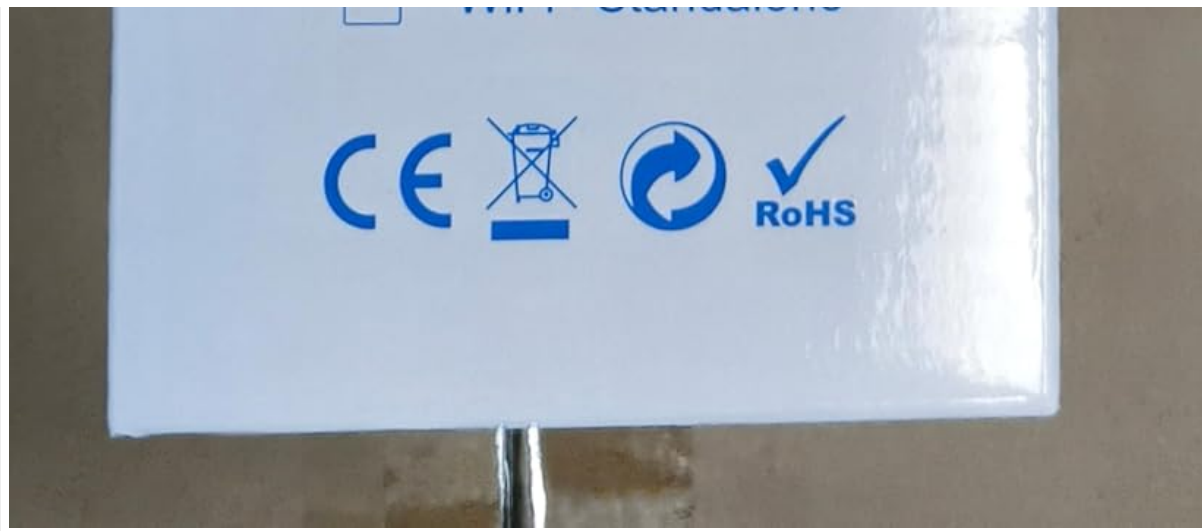

Figure 5.1: Installation procedure: 1) Fix the mounting bracket to the wall. 2) Hang the alarm siren on the bracket.

**Note:** The siren includes an anti-theft tamper switch on the back. If the siren is moved or removed from its mounting, it will trigger an alarm to enhance security.

## 6. OPERATION

### 6.1. Powering On/Off

The siren is primarily solar-powered. For initial setup or if the battery is depleted, you can charge it via the DC 5V power supply (adapter not included). The ON/OFF switch is located on the back of the unit (refer to Figure 3.1).

### 6.2. Button Functions

- **S1 Button (Alarm Voice Cycle):** Short press S1 to switch between different alarm sound types.
- **S2 Button (Working Mode Cycle):** Short press S2 to cycle through available working modes. Refer to your main alarm panel manual for specific mode functionalities and how they interact with the siren.
- **S3 Button (Accessory Configuration / Factory Reset):**
  - **Short press S3:** Enters accessory configuration mode, allowing the siren to be paired with your alarm system or other accessories.
  - **Long press S3:** Restores the siren to its factory default settings. Use this if you encounter pairing issues or wish to clear all previous configurations.

### 6.3. Pairing with Alarm System

The siren operates on a 433MHz wireless frequency and uses the 1527 protocol. It can be connected to wireless sensors and remote controls compatible with this protocol.

To pair the siren with your Dadvu PG103, PG107, or PG108 alarm panel, refer to the specific pairing instructions provided with your main alarm system. Typically, this involves putting the alarm panel into a pairing mode and then activating the siren's configuration mode (short press S3).

**Important:** The siren supports configuration with up to 10 accessories. If this quantity is exceeded, further configurations may not be successful.

## 7. MAINTENANCE

- **Solar Charging:** Regularly inspect the solar panel to ensure it is clean and free from dirt, dust, leaves, or other obstructions that could hinder sunlight absorption. A clean panel ensures optimal charging efficiency.
- **Waterproof Design:** The IP65 rating provides protection against dust ingress and low-pressure water jets. While designed for outdoor use, avoid submerging the device in water or exposing it to high-pressure water streams.
- **Battery:** The siren is equipped with a 3.7V 1000mA polymer lithium battery. Consistent exposure to sunlight helps maintain the battery's charge and prolong its lifespan. If the siren is stored for extended periods, ensure it is fully charged periodically.
- **Cleaning:** Use a soft, damp cloth to clean the exterior of the siren. Do not use abrasive cleaners or solvents.

## 8. TROUBLESHOOTING

---

- **Siren not sounding during an alarm:**
  - Ensure the siren is powered on (check ON/OFF switch).
  - Verify that the siren is properly paired with your alarm system.
  - Check the battery charge level. If low, allow it to charge via solar power or USB.
  - Confirm that the main alarm system is correctly triggering the siren.
- **Siren not charging:**
  - Ensure the solar panel is exposed to direct sunlight for several hours daily.
  - Clean the solar panel if it is dirty or obstructed.
  - If solar charging is insufficient, try charging via the DC 5V USB port.
- **Difficulty pairing with the alarm system:**
  - Ensure the siren is in accessory configuration mode (short press S3).
  - Check the distance between the siren and the alarm panel; reduce interference sources if possible.
  - Confirm you are not exceeding the 10-accessory configuration limit.
  - Try restoring factory settings (long press S3) on the siren and then attempting the pairing process again.

## 9. SAFETY INFORMATION

---

- Do not attempt to disassemble, modify, or repair the device yourself. This may void the warranty and pose safety risks.
- Keep the device away from extreme temperatures, open flames, or highly corrosive environments.
- Dispose of batteries and electronic components according to local environmental regulations.
- Ensure the device is securely mounted to prevent it from falling, which could cause injury or damage.
- The siren produces a loud sound. Avoid prolonged exposure to the siren at close range to prevent hearing damage.

## 10. WARRANTY AND SUPPORT

---



For warranty information or technical support, please contact your retailer or the manufacturer directly. Please refer to the product packaging or the manufacturer's official website for the most current contact details and warranty terms.

**Manufacturer:** PGST

**Model:** PE523R

**Part Number:** PE-523

**ASIN:** B0BGL2YGF3

For additional resources and frequently asked questions, you may visit the PGST official website.

## Related Documents - PE523R

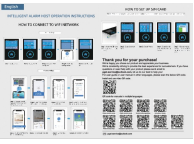
	<p><a href="#">PGST Smart Alarm System - Operating Instructions and Support</a></p> <p>Get started with your PGST Smart Alarm System (PG-103, PG107). This guide provides operating instructions, support contact, and information on multilingual resources for home security.</p>
	<p><a href="#">PGST PG-109 Alarm Host User Manual</a></p> <p>Comprehensive user manual for the PGST PG-109 Alarm Host security system, covering installation, operation, features like remote control, wireless detectors, app integration, and technical specifications.</p>
	<p><a href="#">GSM &amp; WiFi Alarm System User Manual</a></p> <p>User manual for the GSM &amp; WiFi Alarm System, detailing features, setup, operation, and mobile app integration for the PG103 alarm host.</p>
	<p><a href="#">PGST PG-500 GSM 2G/4G/WiFi Alarm System User Manual</a></p> <p>Detailed user manual for the PGST PG-500 GSM 2G/4G/WiFi Alarm System. Covers installation, mobile app setup and operation, system settings, daily use, maintenance, technical specifications, and troubleshooting.</p>
	<p><a href="#">PG-S01 Smoke Alarm User Manual   PGST</a></p> <p>Comprehensive user manual for the PGST PG-S01 Smoke Alarm, covering installation, operation, troubleshooting, and technical specifications. Ensure home safety with this reliable photoelectric smoke detector.</p>
	<p><a href="#">Smart System Alarmowy PG-103 PGST Tuya GSM 4G Instrukcja obsługi</a></p> <p>Instrukcja obsługi systemu alarmowego Smart System Alarmowy PG-103 PGST Tuya GSM 4G. Szczegółowe informacje o funkcjach, instalacji, konfiguracji i codziennej obsłudze urządzenia.</p>

